

revision / date / amendments

- / 26/01/18 / - First Issue
- A / 23/03/18 / 1. Tender Addendum (1). Indication of 4 post truss fixed at stage level for integrated automatic retractable acoustic baffles and integrated lighting rig.
- B / 12/04/18 / 2. Tender Addendum (2). New AHU + Attenuator over stage to be hung to existing relocated secondary beams in Flytower.
- C / 01/06/18 / - Door and window numbers updated  
Listed Building Application  
1. Indication of 4 post truss fixed at stage level for integrated automatic retractable acoustic baffles and integrated lighting rig.  
2. New AHU + Attenuator over stage to be hung to existing relocated secondary beams in Flytower.
- D / 05/07/18 / 1. Updated stage 4 fit interior and kitchen layouts.
- E / 31/07/18 / G.2. Built-out column omitted on retail side  
G.7. Refer to Basement drawing. WCs vents to run through to roof and boxed out as part of joinery.  
G.8. Ventilation grille opening below window WG-26  
G.9. Basement Ventilation plant to Bin Store  
Colour coding added to revised drawing RevE  
Following sub-basement extension there is a requirement for smoke ventilation with a new smoke vent outlet on Bayham Street.
- F / 15/08/18 / G.22/01/19 / 1. Retrospective Planning for Dome Propping up works. Ref: 2019/0695/L  
Proposed Dome Truss LBC Application  
Proposed Dome LBC Application for 1. Permanent Dome Truss.
- H / 29/01/19 / 2. Dome Front Pier PFCs.  
3. Replacement of Dome Copper Roof
- K / 30/10/19 / 1. Following review of PFC location, PFCs to be chased into wall and concealed.  
Retrospective Planning for removal of listed fabric around temporary propping up works for Dome Truss.
- L / 01/11/19 / Retrospective planning application for:  
1. Removal and reinstatement at high level H/L.  
2. Removal and reinstatement of low level L/L.  
3. Removal of and reinstatement of walls  
4. Removal of walls.  
5. Change to consented proposal.  
Refer to colour coded legend and annotations 1-9.
- M / 11/02/2020 /

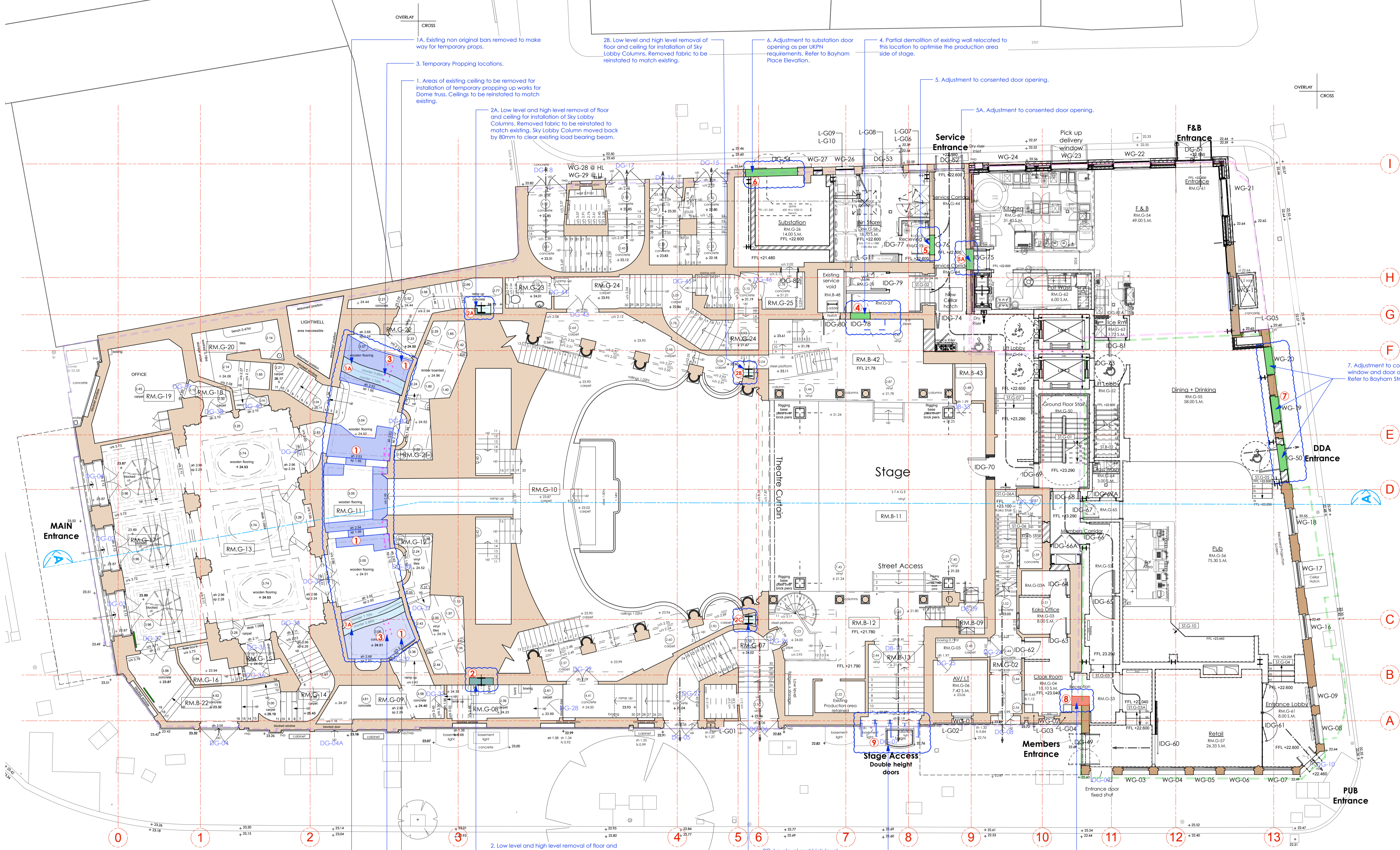

**LEGEND**

- Proposed Works
- Existing Building Fabric KOKO née Camden Palace Theatre (1900)
- Existing Building Fabric Hope & Anchor (approx. 1850)
- Existing Building Fabric Bayham Place (from 1873)
- Existing Modern Building Fabric Bayham Place (from 2006)
- Building Fabric to be demolished
- Demolition of Flooring / Elevation / Wall
- Proposed Excavation
- Remove and retain in alternate location
- Retain and protect existing
- Retain, make good, ease and adjusted
- Means of escape Route
- Private Members Route
- Koko Customer Route
- Public Route
- Artist Route
- Proposed Riser
- Proposed Risers Above
- Room Number
- Door Number
- Window Number
- Hope & Anchor Demise
- Koko Demise
- 1 Bayham Street & 45 Bayham Place Demise

11.02.2020

**PLANNING**

Archer Humphries Architects  
 Basement  
 Central House  
 142 Central Street  
 London, United Kingdom  
 EC1V 8AR  
 T: +44 (0) 20 7251 8555

**Legend for works under Retrospective application**

- Removal and reinstatement of listed fabric at high level (H/L)
- Removal and reinstatement of listed fabric low level (L/L)
- Removal and reinstatement of listed walls
- Removal of listed walls.
- Temporary Propping up for Dome Truss
- Change from consented proposal

project title	KOKO + Hope & Anchor + Bayham Place, Camden, London	scale	1:100	date	13.04.17
drawing title	Proposed Ground Floor Plan	drawn	FR/PC	checked	DA
drawing number	AHA/KCC/GA/100	revision			M