

Copyright: All rights reserved. This drawing must not be reproduced without permission.
 Only the original drawing should be relied upon. Contractors, subcontractors and suppliers must verify all dimensions on site before commencing any work or making any shop drawings.
 All shop drawings to be submitted to the architect for comment prior to fabrication.
 This drawing is to be read in conjunction with the Architect's specification, bills of quantities / schedules, structural, mechanical & electrical drawings and all discrepancies are to be reported to the architect.

revision / date / amendments	
- / 26/01/18 /	- First Issue
A / 02/02/18 /	- Indicative glazing bars and tiers shown on Sky lobby roof.
B / 01/03/18 /	- Roof window numbers updated
C / 01/08/18 /	4.8. Wall extended to rear of WC's by 1.5 bricks 4.9. Wall depth increased to include void for services 5.3. Existing chimney to rise above parapet 5.4. Chimney added from Pavilion
D / 15/08/18 /	Colour coding added to revised drawing RevC
E / 03/08/19 /	Proposed Dome LBC Application for 1. Permanent Dome Truss. 2. Dome Front Pier PFCs. 3. Replacement of Dome Copper Roof 3. Removal of Decorative Dome Ladder
F / 11/02/2020	Retrospective planning application for: 1. Removal and reinstatement at high level H/L 2. Removal and reinstatement at low level L/L 3. Removal and reinstatement of walls 4. Removal of walls. 5. Change to consented proposal. Refer to colour coded legend and annotations 1-5.

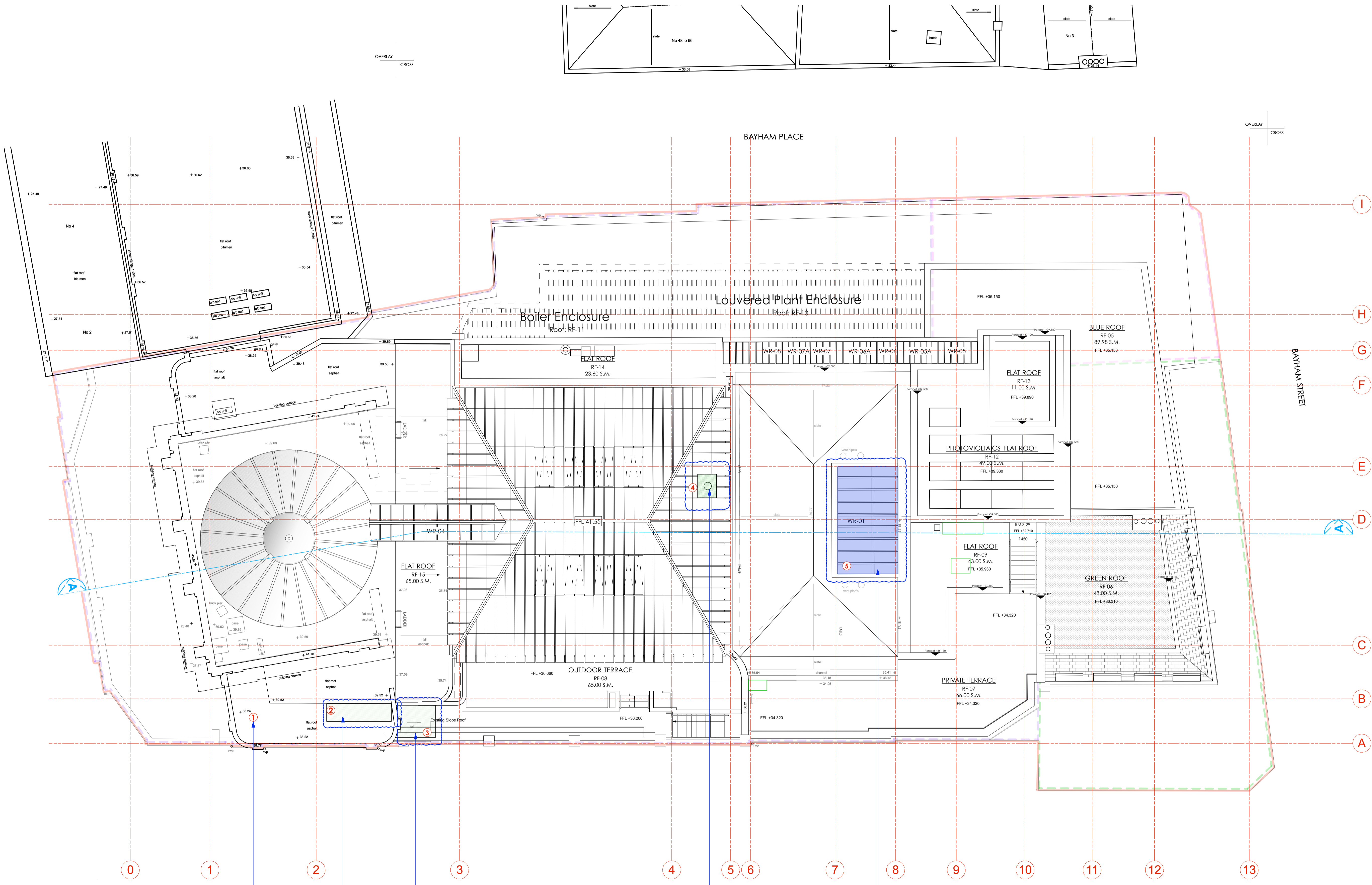

LEGEND

- Proposed Works
- Existing Building Fabric KOKO née Camden Palace Theatre (1900)
- Existing Building Fabric Hope & Anchor (approx. 1850)
- Existing Building Fabric Bayham Place (from 1875)
- Existing Modern Building Fabric Bayham Place (from 2006)

RM-4-06 Room Number
 D4-02 Door Number
 W4-05 Window Number

11.02.2020

PLANNING
 Archer Humphryes Architects
 Basement
 Central House
 142 Central Street
 London, United Kingdom
 EC1V 8AR
 T: +44 (0) 20 7251 8555

project title		KOKO + Hope & Anchor + Bayham Place Camden, London	
drawing title	scale	date	
Proposed Roof Plan	1:100 (A1)	26.05.17	
drawing number	drawn	checked	
AHA/KC/GA/105	FR/PCI	DA	
	revision		
	F		

Legend for works under Retrospective application

- Remove and reinstatement of listed fabric at high level H/L
- Remove and reinstatement of listed fabric low level L/L
- Remove and reinstatement of listed walls
- Removal of listed walls / floors.
- Temporary Propping up for Dome Truss
- Change from consented proposal

1. PV cells omitted from this location as PV cells above core will provide required power/output.
 2. Consented proposed fire escape staircase and door omitted.
 3. Area of existing sloped roof to be retained (not to be demolished) and door way omitted.
 4. Relocated chimney flue
 5. Existing rooflight glazing to be replaced to meet building regulations.