

Product brochure

Bikehangar[®]

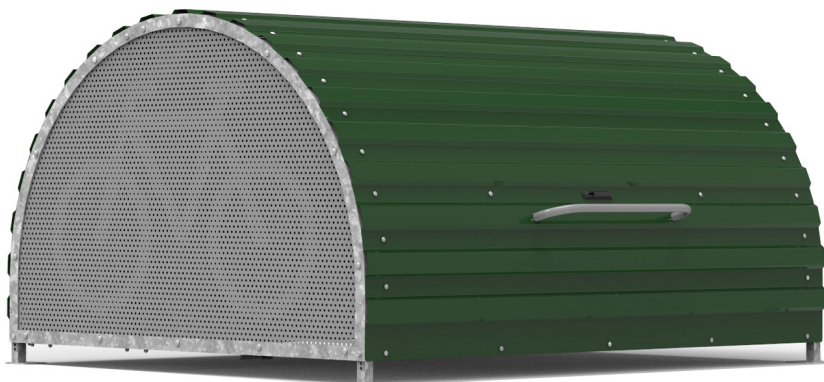

cyclehoop

Cyclehoop Ltd

Email: info@cyclehoop.com

Phone number: +44 (0)20 8699 1338

Opening hours: Monday - Friday 9:00 - 18:00

CONTENTS

1. About
2. Specifications
3. Customisation
4. Case Studies
5. How to use
6. Installation & Delivery
7. O&M
8. Warranty

About



Safe, Secure and Easy to Use

Designed and manufactured by Cyclehoop, the Bikehangar offers a secure solution to long-term cycle parking and an effective way to protect bikes from tough weather conditions and vandalism. This award-winning product stores six bikes within half the space of a car parking bay, making it ideal for areas where outdoor cycle storage space is necessary.

Cyclehoop are the exclusive suppliers of this product in Britain.

Specifications

The Bikehangar has several high security features including a galvanised sheet steel body, perforated side panels, high-density cycle racks and a vandal resistant door.

Features

- Provides a safe and dry storage space for six bicycles
- Two units can fit into a single car parking space
- High-density internal rack with high low configuration allows most types of bicycles to be easily parked without handlebars clashing
- Gas assisted door allowing easy opening by users of all abilities
- Corrosion resistant, tamper proof lock
- Vandal resistant door catch
- Adjustable feet ensure they can be installed on uneven surfaces. When installing on the carriageway the front feet can be installed over the kerb to reduce the Bikehangar's protrusion into the road to under 1.8m. This allows installation in narrow car parking bays
- Open bottom allows leaves and litter to pass through
- Compact size and low height allows the unit to fit into all environments with low visual impact (smaller than a typical car)
- Reflective and high visibility banding on corners to increase visibility

Dimensions

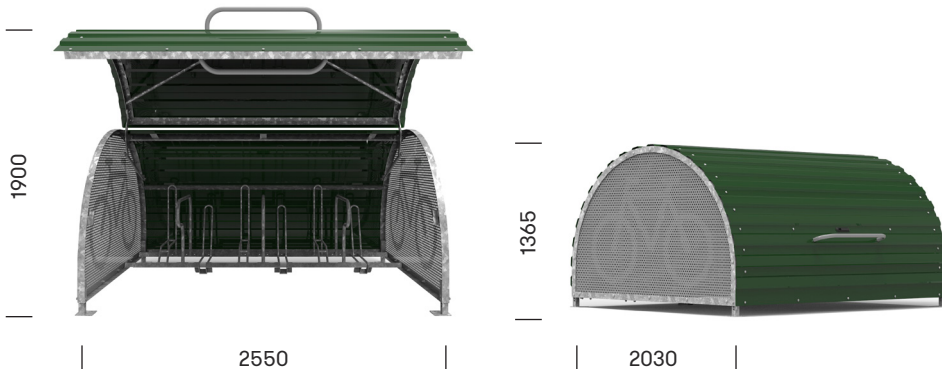

Length 2550mm x Height 1365mm x Depth 2030mm

Weight: 280kg

Options

- Planters
- Branding
- Maintenance Package
- Cycle Parking Rentals Scheme

Other

- Made in Britain
- Design protected by the European Community Design Registration
– Reg. No. 002437897-0001
- The Bikehangar and its services are a registered trademark under the UK Intellectual Property Office.
- Reflective Branding

Materials

- Galvanized Steel
- Galvanized and Powder Duplux Coating
- Stainless Steel

Customisation

The Bikehanger comes with a variety of customisation and branding options, so you can tailor the unit to your needs.

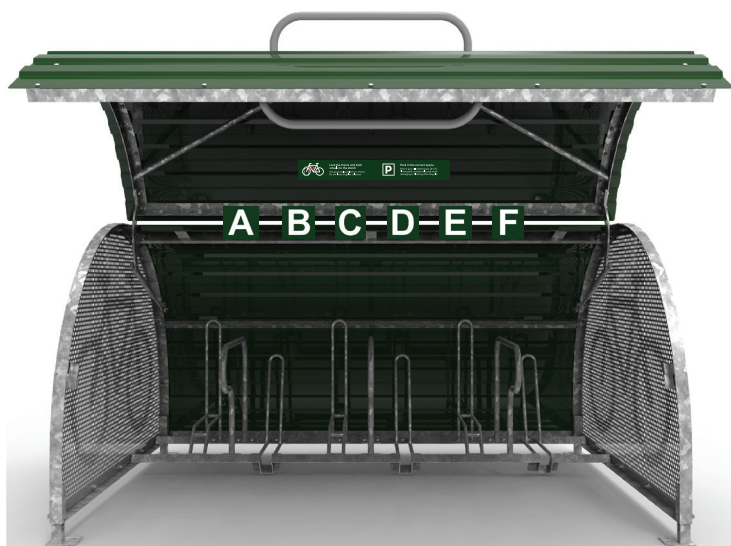

Options

① Vinyl Instructions Sticker (420 × 68mm)

- Option 1. green
- Option 2. dark grey



② Vinyl parking information sticker (270 × 67mm)



③ Identification number (90× 40mm)



④ Logo vinyl sticker (custom size) **Waltham Forest**

- Option 1. die cut vinyl **Waltham Forest**
- Option 2. matt laminated full background

⑤ Vinyl advice sticker

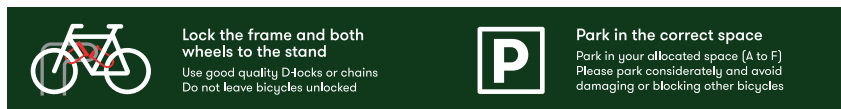

⑥ Vinyl parking advice sticker (533× 62mm)



⑦ Reflectors (custom size)



8 Custom Vinyl



Case studies



The Bikehangar Scheme in the London Borough of Waltham Forest

The London Borough of Waltham Forest jumped onto the Bikehangar Rentals Scheme in 2015 as part of the council's Mini Holland programme. The borough is set to become one of the most cycle-friendly boroughs in London.

In March 2017, we celebrated the installation of the 100th Bikehangar with a special photoshoot with the residents and the local cycling officer.

After a busy year of installations, we reached the 250th Bikehangar in the borough by July 2018. To mark this milestone, our designers at Cyclehoop have customised a very special Bikehangar with an image of the reservoir in the Walthamstow Wetlands.

Find out more here: <https://www.cyclehoop.com/news/july-2018/waltham-forest-celebrates-their-250th-bikehangar-in-the-borough/>



The Bikehangar Scheme in the London Borough of Hackney

Our Bikehangar Rentals Scheme was first taken on by the London Borough of Hackney in July 2013.

Each Bikehangar provides six spaces to securely store bicycles with each space available for residents to rent. The award-winning design is an effective way to protect bikes from theft and tough weather conditions where outdoor storage space is limited. This made the Bikehangar an ideal solution for Hackney Council to offer its residents, where space is at a premium.

To date, we have installed 308 Bikehangars in the London Borough of Hackney (including Hackney Homes) providing 1,848 secure cycle parking spaces.

Find out more here: <https://www.cyclehoop.com/case-studies/2017hackney>

How to use

We have designed the Bikehangar so it is easy to use and a safe place to store your bike. Each unit is supplied with 6 keys for access. Cyclehoop always recommend you lock your bike with a good quality D-lock and a robust chain and padlock.



1. Insert and turn key to release lever



2. Push down on long handle to turn lever
Door will lift automatically

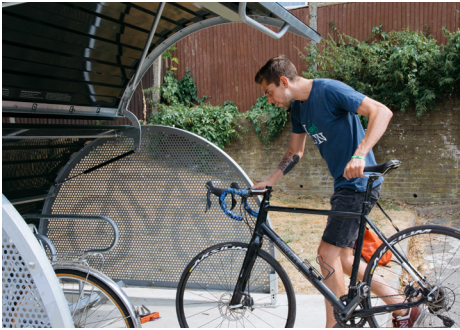

3. Wheel your bike into the racking and lock your bike



4. Close the door and push down on the handle before turning the lever

Installation & Delivery

Cyclehoop have a wealth of experience working with councils, housing officers, highway engineers and traffic planners in delivering and project managing the installation of Bikehangars. If you have any questions regarding your order, email sales@cyclehoop.com.

Cyclehoop can provide the following:

- Drawings, site plans and graphics to support consultations or planning approvals
- Carry out site visits with the client to check the locations prior to installation
- Risk Assessments and Method Statements for installations
- Detailed installation schedules
- Send the client regular installation updates and completed installation reports

Our Bikehangar installations are overseen by our Project Management team. Each project has an assigned project manager who oversees the installation from start to finish including:

- Handover meeting from Sales and Account Management Team
- Scheduling
- Issuing job instructions
- H&S risk assessments
- Team briefings or debriefs
- Client liaison

All of our installers are CSCS trained operatives who are supervised by a SSSTS qualified Project Manager.

Installers are experienced and fully trained in the assembly and installation of Bikehangars and follow our approved procedures and Method Statements.

We use FORS registered hauliers and our operatives have completed Safe Driver training.

O&M

The Bikehanger is supplied with 9 keys. Customers should make a note of their key number. In the case of loss or theft, replacement keys can be ordered through Cyclehoop with authorisation from the original customer.

Operating Instructions

Opening

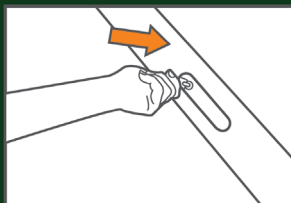

1. Insert key.

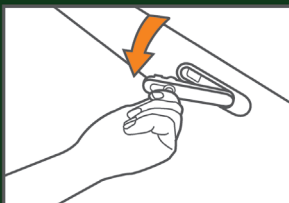

2. Turn key to release lever.



3. Push down on long handle and turn lever. Door will lift automatically.

Closing

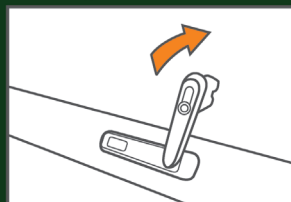

1. Ensure lever is in the open position. Pull the door down to close.

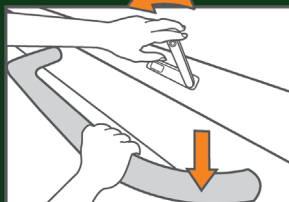

2. Close the door and push down on the handle before turning the lever.

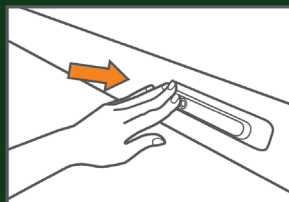

3. Push in the lever and check the door is locked by pulling upwards.

Care & Maintenance

As with many products, regular maintenance will extend the life of the product and retain its appearance. Cleaning should be conducted every six months. In industrial or marine locations, particular attention should be paid to regular maintenance due to the harsher atmosphere.

Inspection

- Regular visual inspections of the product should be performed to ensure it is in safe, working order

- All moving parts should be regularly tested
- All bolting and fixings should be checked annually. Tighten all fixings and replace any that are loose, damaged or missing

Powder Coated Parts

Powder coating parts can provide many years of protection. Regular care can help prolong lifespan of the material, finish and colour.

Cleaning

- Clean with a dilute solution of mild liquid detergent and warm water
- Do not use abrasive products
- Rinse thoroughly with potable water after cleaning to remove all residues

Repair

- Small damage to powder coated surfaces can be repaired. It is recommended seeking professional painting services to achieve best results on large areas
- Ensure damaged area is clean prior to repair
- Abrade damaged area using 240 Grit glass paper ensuring even abrasion around edges
- Apply an even coat of primer to damaged area. Allow to dry thoroughly before applying topcoat
- Apply aerosol topcoat following manufacturer's instructions for an even application
- Parts with damage extending beyond the surface powder coat
- Contact Cyclehoop for technical advice

Galvanised Parts

Parts are hot dip galvanized to BS EN ISO 1461; a sacrificial layer of zinc is bonded to the base metal to protect from corrosion. In rural and urban areas (C1 - C3) this provides many years of protection, in highly corrosive coastal or industrial areas (C4, C5-I, C5-M) lifespan is reduced. Regular care can help prolong lifespan.

Galvanised structures may exhibit a white powdery oxide deposit. This is not detrimental to the structure but the cause should be investigated and a remedy sought as soon as possible as this is an acceleration of the normal process of sacrificial corrosion of galvanised structures.

Cleaning

- Carefully remove any loose surface deposits with a wet sponge
- Clean with a dilute solution of mild liquid detergent and warm water
- Do not use abrasive products
- Rinse thoroughly with potable water after cleaning to remove all residues
- For galvanised products situated in a highly corrosive environment e.g. coastal, heavy industrial (C4, C5-I, C5-M), rinse with potable water on a regular basis, particularly under sheltered conditions (i.e. not exposed to rain and sun)

Repair

- Light damage resulting in removal of the galvanised coating and exposure of raw steel can be repaired using a zinc spray. Parts with heavy damage may need to be replaced
- Ensure damaged area is clean prior to repair
- Abrade damaged area using 240 Grit glass paper ensuring even abrasion around edges
- Apply zinc spray following manufacturer's instructions for an even application.
- Ensure all raw steel is thoroughly coated

Stainless Steel Parts

Stainless steel is corrosion resistant. Surface rust of other metals can lightly adhere to stainless steel parts, this can be prevented through regular care

Cleaning

- Carefully remove any loose surface deposits with a wet sponge
- Clean with a dilute solution of mild liquid detergent and warm water
- Do not use abrasive products.
- Rinse thoroughly with potable water after cleaning to remove all residues
- Products can be cleaned with a stainless steel cleaning agent
- Follow manufacturer's instructions

Repair

Light damage such as surface scratches can be repaired using an emery cloth (240 grit) and a freeing oil such as WD40. Take care to follow the grain direction on brushed parts

Maintenance Schedule

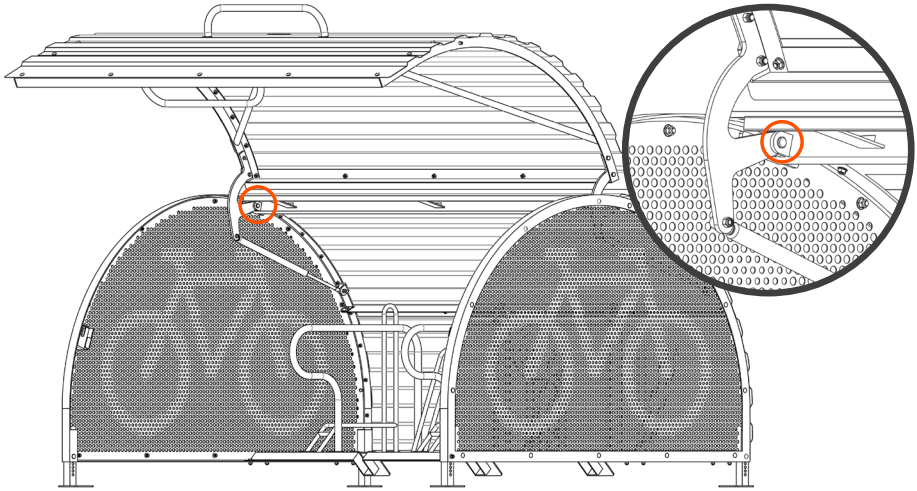

Fig. A

- Spray a silicone lubricant such as Ambersil 40+
- Wipe off any excess
- Check and clean lock and door mechanism when in the open position
- Check grub screws in handles and tighten if required
- Wipe any debris from the stainlesssteel shaft of both the gas springs
- Do not lubricate
- Check the gas springs are lifting the door correctly
- Lubricate the two ball joints on both the gas springs
- Grease the internal hinge using a general-purpose lithium grease. See Fig. A
- Cleaning frequency may be increased in harsher conditions
- Check for debris and leaf matter, especially in autumn
- Annually check structural boltings
- Annually check sheeting fastenings
- Annually check the main structure for wear

Troubleshooting

- Extreme cold weather can affect performance of the Bikehangar. Like any car lock, it is possible for water to freeze inside the barrel, locking up the mechanism. As the day warms up this is likely to thaw. Users can try to gently heat the lock with warm water, however excessive heat (especially open flames) should be

avoided as parts of the mechanism are plastic. To prevent this from happening WD40 can be used to disperse water from the barrel or more ideally a silicon spray such as Ambersil 40+

- Removing graffiti requires a specialist cleaner
- Stickers can be removed using a mild detergent
- Please contact Cyclehoop for detailed information
- Do not use solvents in any case

First Aid

In the event of skin irritation or injury, immediate medical attention should be sought by an appropriately qualified person.

Health Hazard – Ingestion (Not Applicable)

Health Hazard – Exposure Limits (Not Applicable)

Health Hazard – Fire & Explosion Hazards (Not Applicable)

This information is supplied in good faith on the assumption that the person carrying out the task of maintaining this product is experienced or has been fully trained in handling and use of the products contained within the structure. It is also assumed that a suitable risk assessment is made of the task being carried out.

The reader must be satisfied that they or the person carrying out the application are suitably responsible and that these recommendations have been thoroughly read and understood by that person.

Cyclehoop Ltd or its contracted manufacturing partners do not accept responsibility for claims of consequential loss or injury to the user or third party if the recommendations of this safety sheet are not adhered to.

Warranty

Cyclehoop Ltd. warrants the Bikehangar, and components thereof, to the original Purchaser to be free from defects in material, structural integrity and workmanship within a 10 year period from the date of delivery and/or installation and will perform in accordance with provided original operation instructions if properly installed and used. This warranty does not cover, and Cyclehoop Ltd. shall not be liable for, general wear and tear, cosmetic damage, gas springs, lock cylinder and keys. This limited warranty expressly excludes and does not cover damage to the Bikehangar which is caused by improper handling, failure to maintain product in accordance to provided guidelines, alteration, misuse, vandalism, incorrect installations, accidental damage or damage caused by storm, snow, fire, or other force majeure. All aforementioned occurrences will immediately void the warranty.

Any Bikehangar verified to be defective within the warranty period shall upon prompt notice by its Purchaser to our Customer Service Department, be either replaced or repaired at our sole discretion. Any warranty claim will not be processed without authorisation from customer service, a copy of the original invoice documenting date of purchase and/or installation and evidence that the unit has been maintained in accordance to provided guidelines. The Purchaser is responsible for all costs involved in sending any defective parts back to Cyclehoop Ltd. and/or any call-out or labour costs related to a warranted repair.

Cyclehoop Ltd. may reimburse these costs as part of the warranty claim at our sole discretion. Warranty related enquiries should be addressed to the following email:

info@cyclehoop.com

The information in this document is believed to be correct as at the date issued. **HOWEVER, NO WARRANTY OF MERCHANTABILITY, FITNESS FOR ANY PARTICULAR PURPOSE, OR ANY OTHER WARRANTY EXPRESSED OR IS TO BE IMPLIED REGARDING THE ACCURACY OR COMPLETENESS OF THIS INFORMATION. THE RESULTS TO BE OBTAINED FROM THE USE OF THIS INFORMATION OR THE ARTICLE, THE SAFETY OF THIS ARTICLE, OR THE HAZARDS RELATED TO ITS USE.** This information and article are furnished on the condition that the person receiving them make his own determination as to the suitability of the article for a particular purpose and on the condition that he assume the risk of his use thereof.