









Notes

- This drawing package is to Developed Design Stage as defined in BSRIA BG6 2018
- This drawing package is intended to indicate:
  - Approximate locations of horizontal & vertical service runs
  - Sizes and locations of main plant and distribution systems
  - Key principles of systems serving the building through typical room/area details
- Sizes, duties and quantities indicated are provisional only and subject to development during Technical Design Stage
- The indicated design of services entering and leaving risers is based on the limited record information available at the time of design.
- Locations of services entering and leaving risers and the associated builderswork openings are therefore subject to variation and further development at the next design stage.
- All services installations will need to be supported from the existing structure and fixings will need to be made to the existing slab or steelwork to support interim support systems to support the services installation. This is as per the existing installation.

Legend

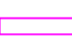
-  Four-pipe cassette fan coil unit
-  Four-pipe fan coil unit
-  Area out of scope
-  Low temperature hot water flow and return pipework
-  Chilled water flow and return pipework
-  Pipework tray
-  Room temperature controller
-  Vertical (concealed) fan coil unit
-  Wall mounted fan coil unit

LTHW and CHW pipework drops from high level to below within riser, runs in floor void. Vertical concealed ducted FCU within bespoke joinery. Pipeworks routes TBA with client and architect.

Vertical concealed ducted FCU within bespoke joinery. Pipeworks routes TBA with client and architect.

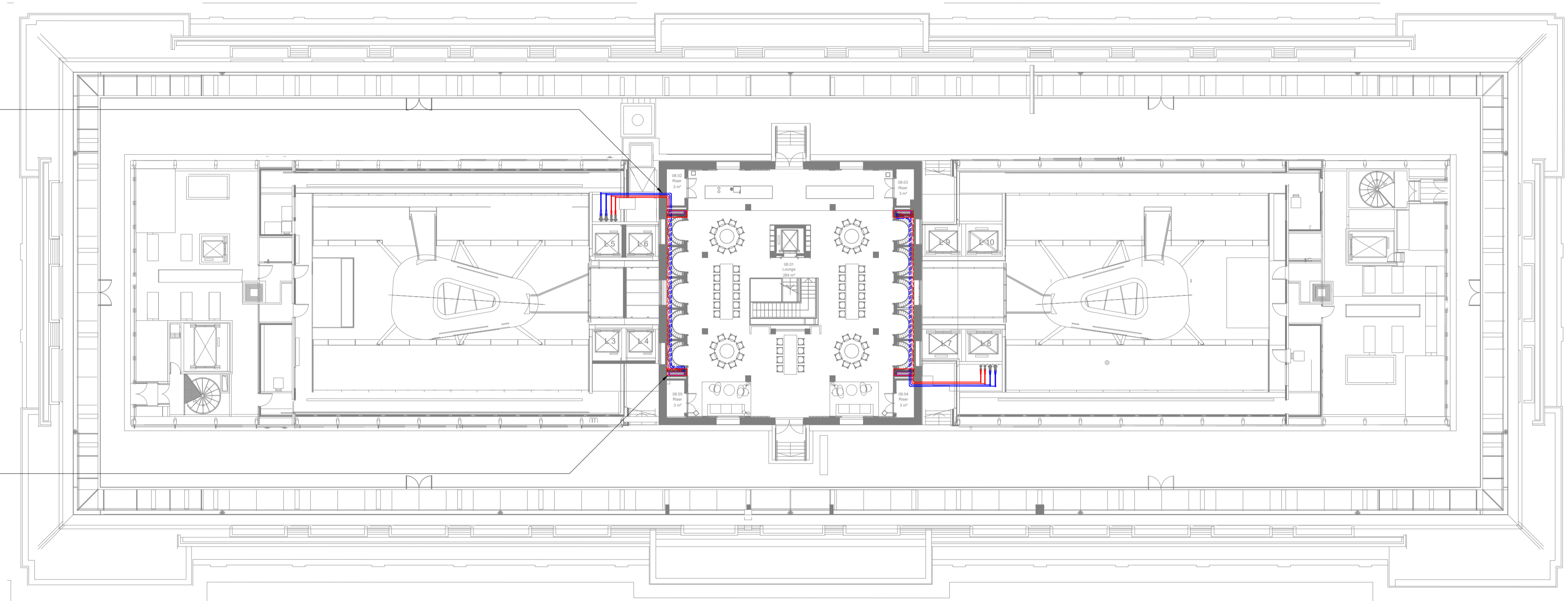

Rev	Date	Description	Card	CHK

Architect  
**HUTCHINSON & PARTNERS**

Client  
**LABTECH**

Project  
**Victoria House Phase 2**

Drawing Title  
**Mechanical Services  
Heating & Cooling  
Layout  
Eighth Floor**



Building Services Engineering | Sustainability | Acoustics  
Scriptor Court  
157 Farringdon Road  
London EC1R 3AD  
020 3544 5400  
www.scotchpartners.com

Copyright reserved. Work to figure dimensions only. Discrepancies to be reported before proceeding.

Issue	Date	Scale	Checked By	Rev

Drawing No. **5228-SP-P2-08-DR-M-420** Rev **P1**