

University College London

Wayfinding & Signage

IOE Strategy

Endsleigh Gardens

March 2020

External Entrances

9–11 Endsleigh Gardens

Site Location Plan

Location: EX10
Sign Type: Special – 340 x 470mm

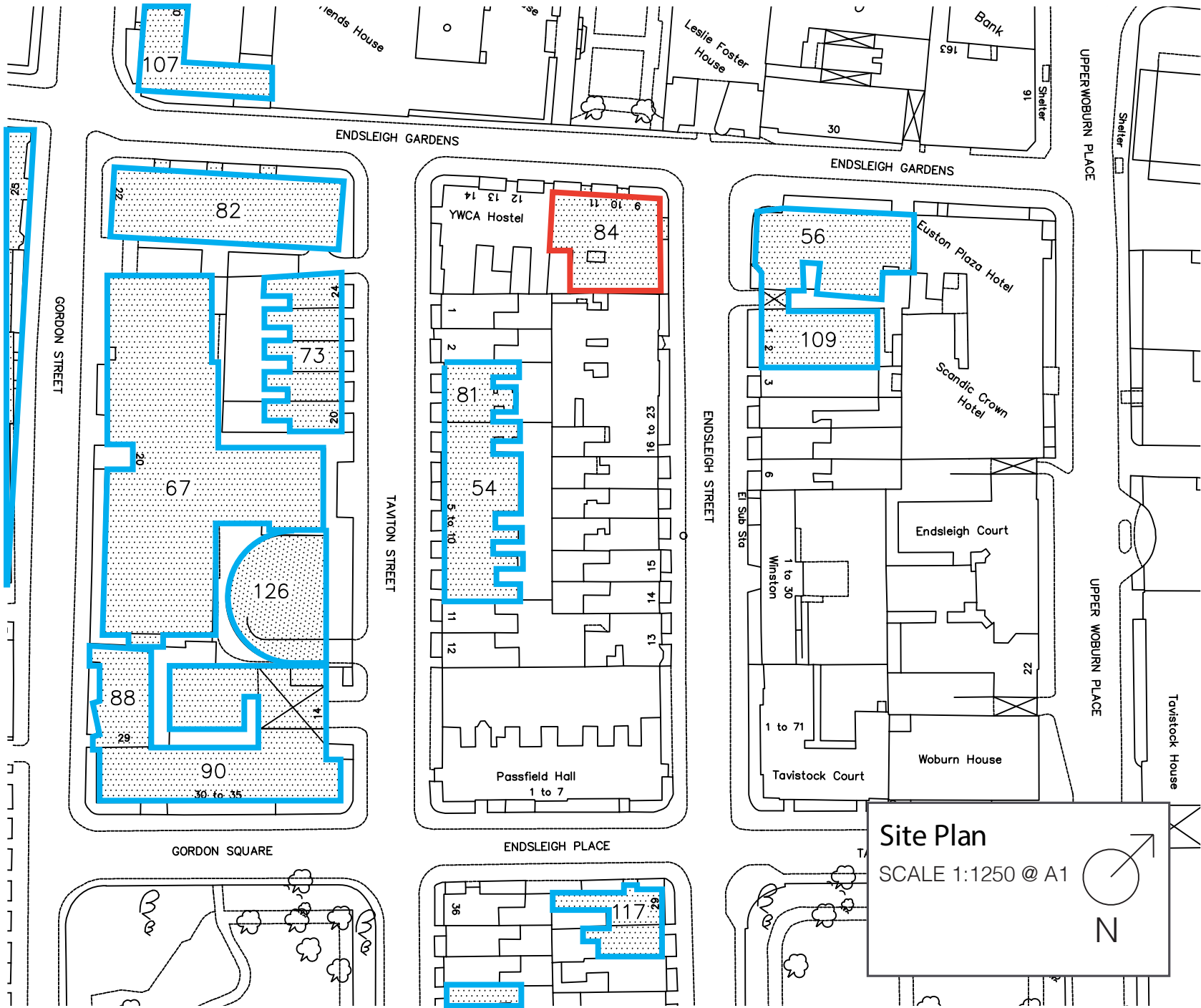

External Entrances

9–11 Endsleigh Gardens

Existing and proposed signage

Location: EX10
Sign Type: Special – 340 x 470mm

Existing Sign



Proposed montage



Proposed montage



External Entrances 9–11 Endsleigh Gardens

Site Location Plan

GORDON STREET

TAVITON STREET

ENDSLEIGH STREET

UPPER WOBURN PLACE

Tavistock Ho

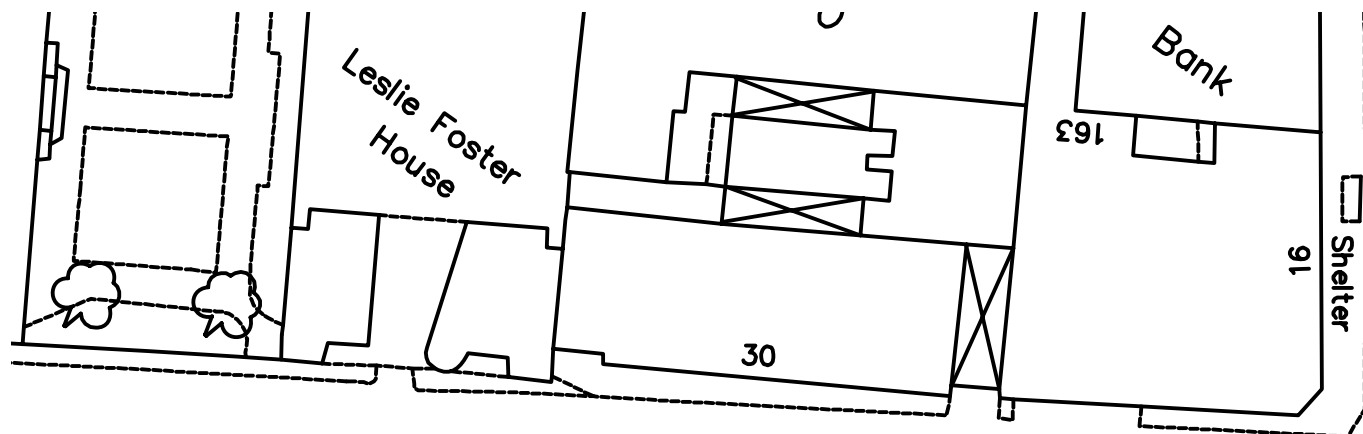
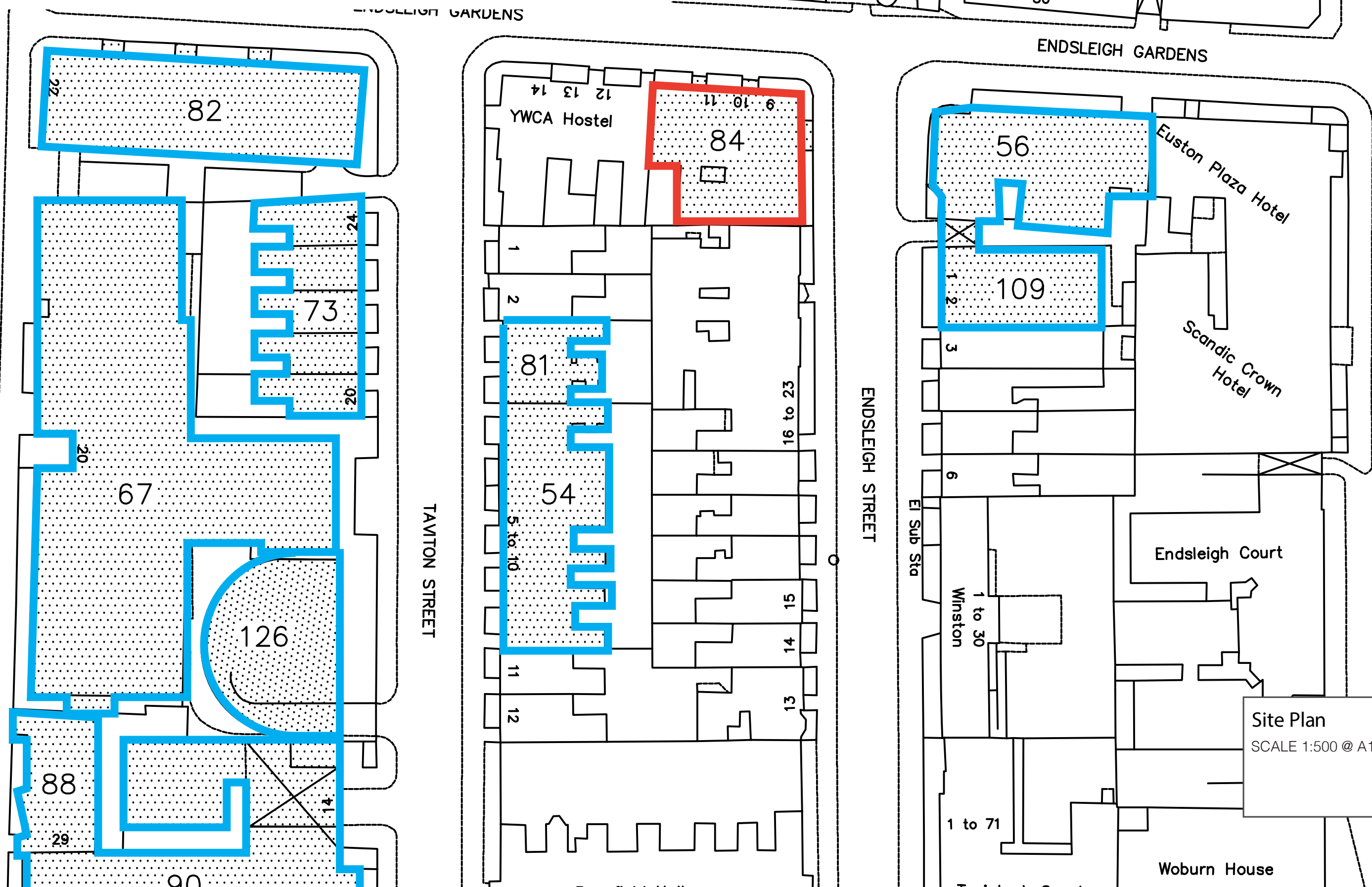

External Entrances

9–11 Endsleigh Gardens

Site Plan

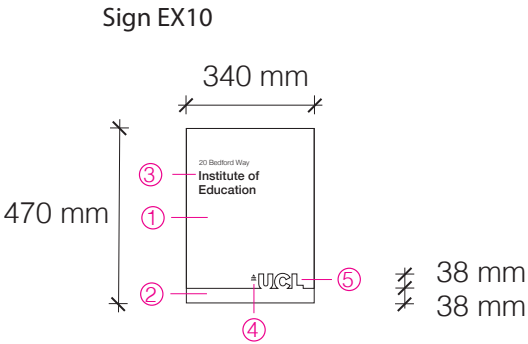
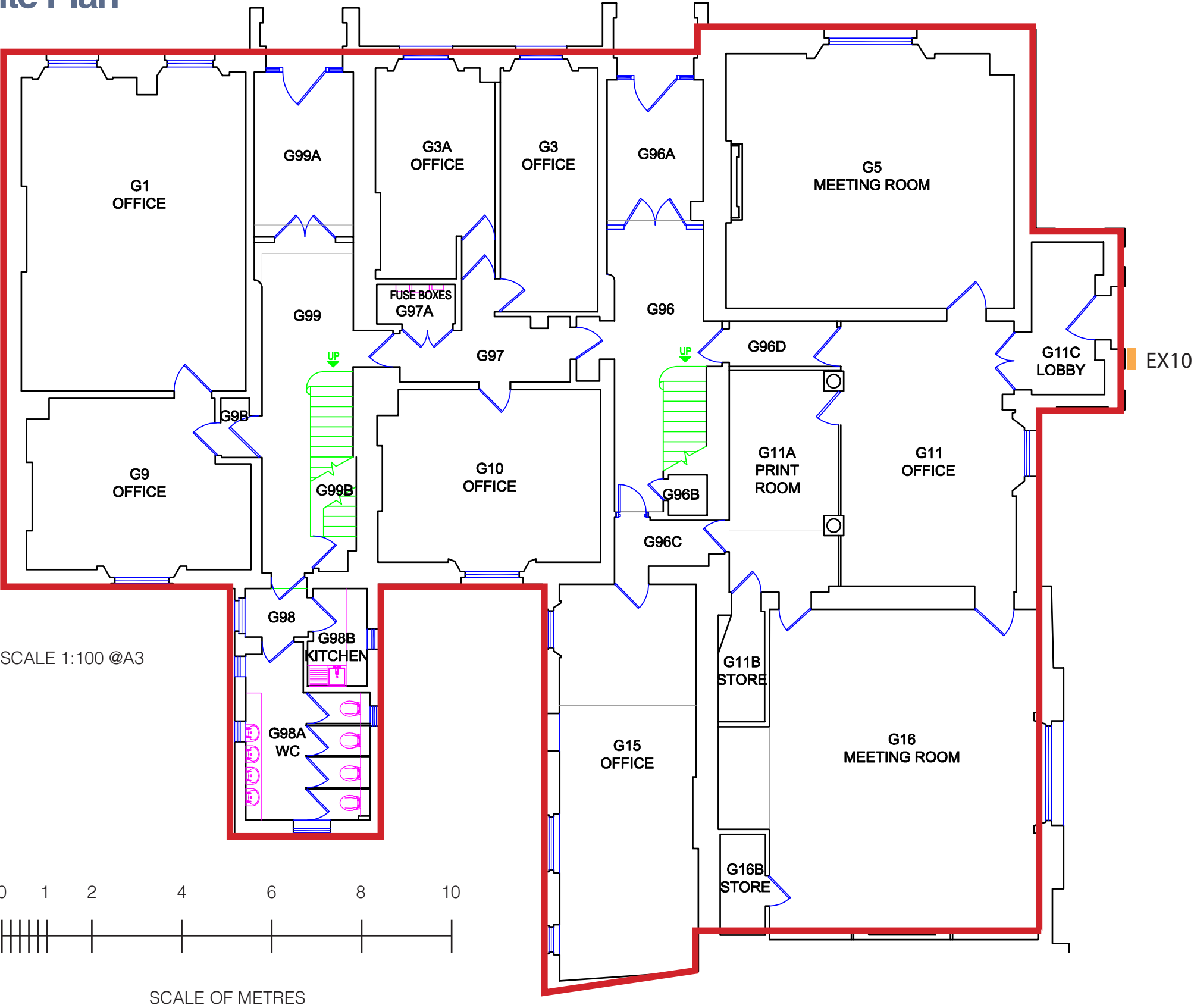

- SCALE 1:20
- ① 3MM ALUMINIUM FRET-CUT UPPER TRAY, POLYESTER POWDER COATED BLACK (GLOSS FINISH), MOUNTED ON TO UNDER-TRAY / CARRIER PANEL.
 - ② 3MM ALUMINIUM UNDER-TRAY / CARRIER PANEL, POLYESTER POWDER COATED TO SPECIFIED COLOUR (MID SHEEN FINISH).
 - ③ SCREEN PRINTED TEXT IN WHITE (TYPICAL SHOWN).
 - ④ SCREEN PRINTED LOGO IN WHITE.
 - ⑤ FRET CUT "UCL" LETTERS IN UPPER TRAY, EXPOSING UNDER-TRAY / CARRIER PANEL UNDERNEATH.

Mid Tone Stone
Pantone 7530
BS 08 B 21

Conservation Areas
default colour

Light Stone
Pantone 7528
BS 08 B 17

Conservation Areas
Portland Stone

External Entrances

Sign Schedule

Schedule of proposed wayfinding signs, with budget costs.

Sign No	Address/location	Sign type	Size	Budget Cost ex. VAT
EX10	9-11 Endsleigh Gardens	Special	340 x 470	tbc