

GENERAL NOTES

- Contractor must ensure that all work on site is carried out in a safe & satisfactory manner, in accordance with Health & Safety At Work Act 1974, COSHH Regulations 2002 & requirements of C.D.M.
- Structural Design shown in abeyance - refer to Structural Engineer's drawings and specifications.
- Mechanical & Electrical shown in abeyance - refer to M&E Engineer's drawings and specifications.
- All dimensions shown are to wall structure (Block/Stud) unless otherwise stated.

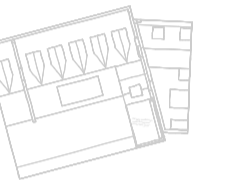

1 KEY PLAN_SECTION-CC EXISTING
1:1000



- 04-Fourth
12300
- 03-Third
9300
- 02-Second
6290
- 01-First
3230
- 00-Ground
0
- B1-Lower Ground
-3000

3 Section CC - Building As Existing
1:100