

**GENERAL NOTES**

1. Contractor must ensure that all work on site is carried out in a safe & satisfactory manner, in accordance with Health & Safety At Work Act 1974, COSHH Regulations 2002 & requirements of C.D.M.
2. Structural Design shown in abeyance - refer to Structural Engineer's drawings and specifications.
3. Mechanical & Electrical shown in abeyance - refer to M&E Engineer's drawings and specifications.
4. All dimensions shown are to wall structure (Block/Stud) unless otherwise stated.

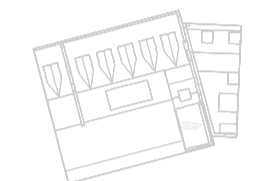

**1** KEY PLAN\_SECTION-AA EXISTING  
1:1000

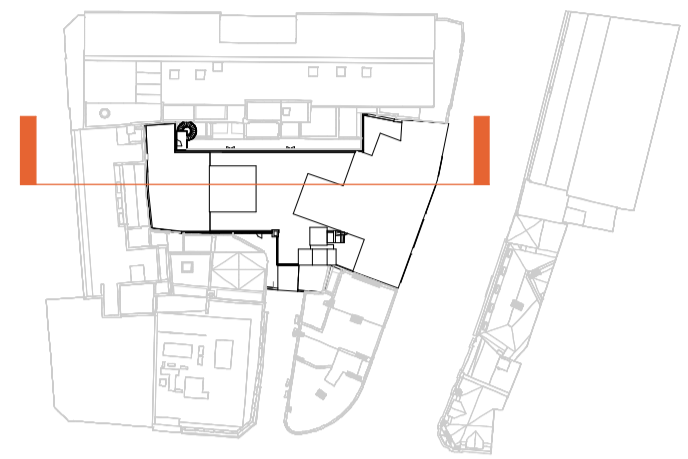

- R1 Proposed Roof  
14700
- 04-Fourth  
12300
- 03-Third  
9300
- 02-Second  
6290
- 01-First  
3230
- 00-Ground  
0
- B1-Lower Ground  
-3000

**3** Section AA - Building As Existing  
1:100