

01 Floor Plan  
101 1:20

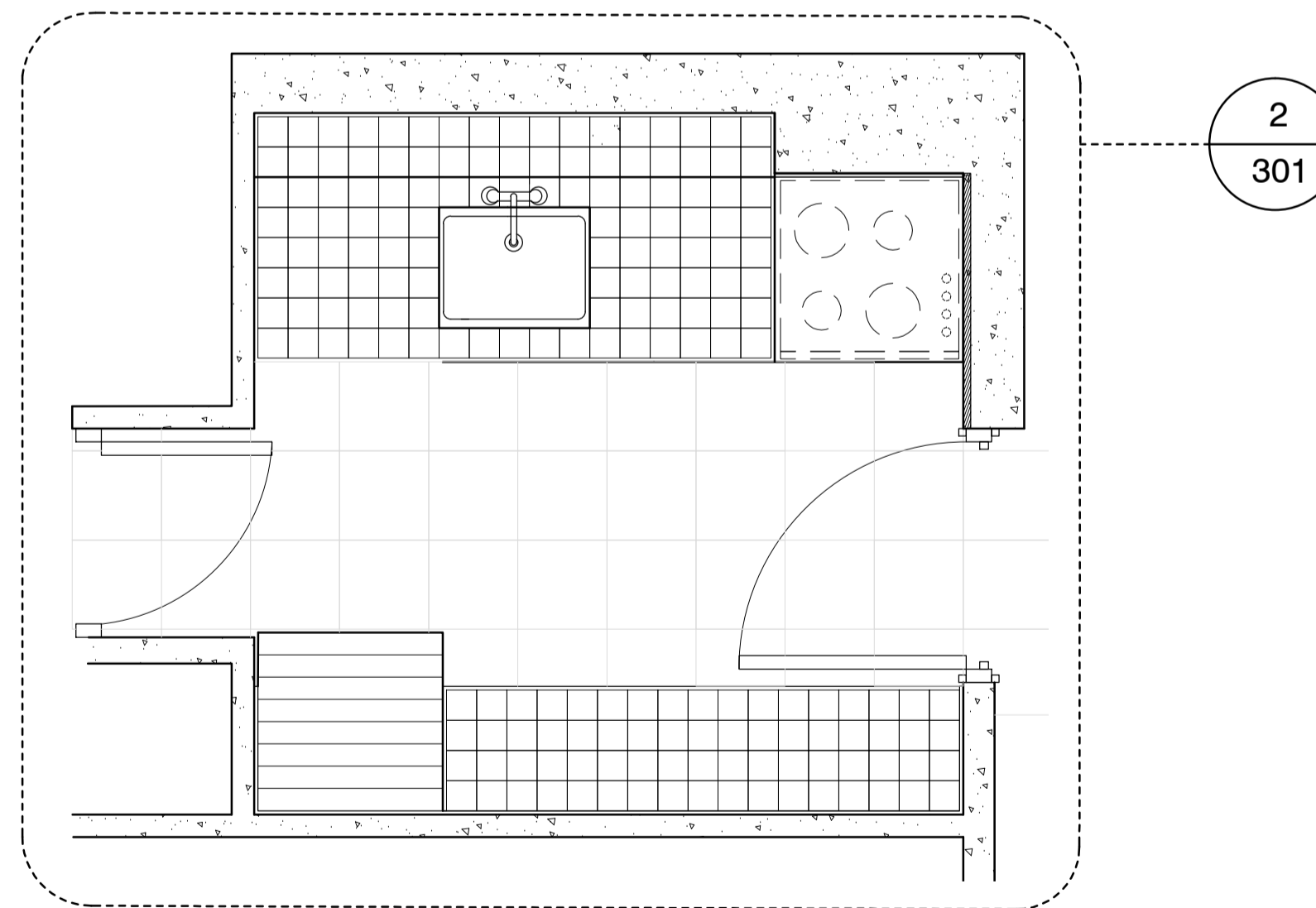

02 Kitchen Plan : Variation 3  
101 1:20

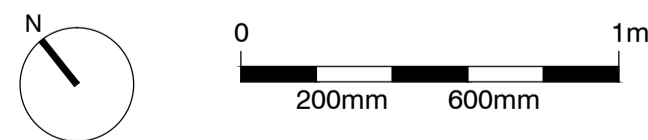

**standard notes**

1. Do not scale this drawing.
2. All dimensions must be checked on site and any discrepancies verified with the architect.
3. Unless shown otherwise, all dimensions are to structural surfaces.

**drawing notes**

1. Note that these drawings show typical dimensions whereas dwellings will vary - in particular, to suit the curvature of the railway line adjacent.
2. Services routes cannot be confirmed until full, invasive surveys are undertaken. Services are therefore shown indicatively.

**revisions**

- |    |            |                                 |
|----|------------|---------------------------------|
| P1 | 27.11.2015 | Draft issue for HPA application |
| P2 | 15.12.2015 | HPA Submission                  |

# Dwelling Type A1

## ALEXANDRA RD. ESTATE

date Nov 2015  
 scale 1:20@A1  
 drawn JA checked JM  
 drawing number 2504\_L\_101  
 rev P2

client LB CAMDEN  
 drawing Original plan: Flat type A1

Levitt Bernstein  
 1 Kingsland Passage  
 London  
 E8 2BB  
 t: 020 7275 7676  
 f: 020 7275 9348  
 w: levittbernstein.co.uk  
 e: post@levittbernstein.co.uk

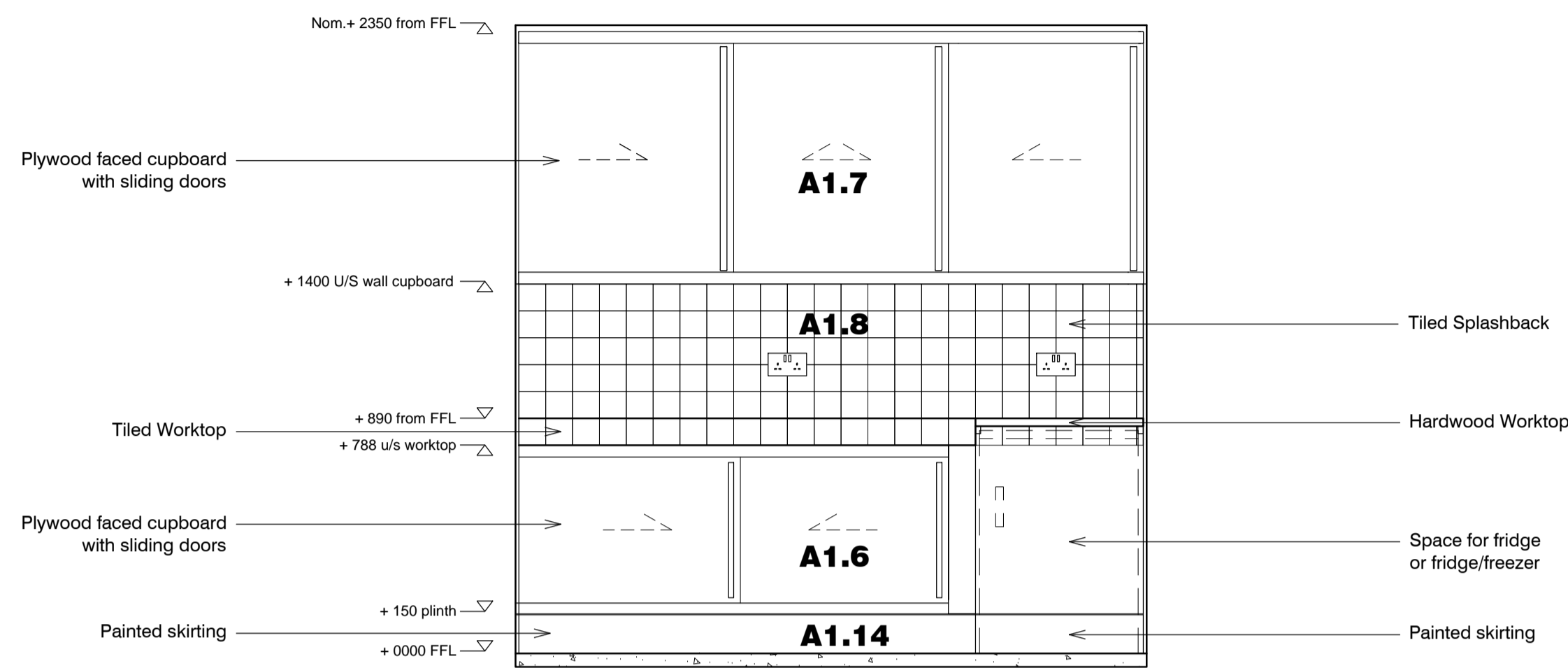

01 Section 01  
301 1:20

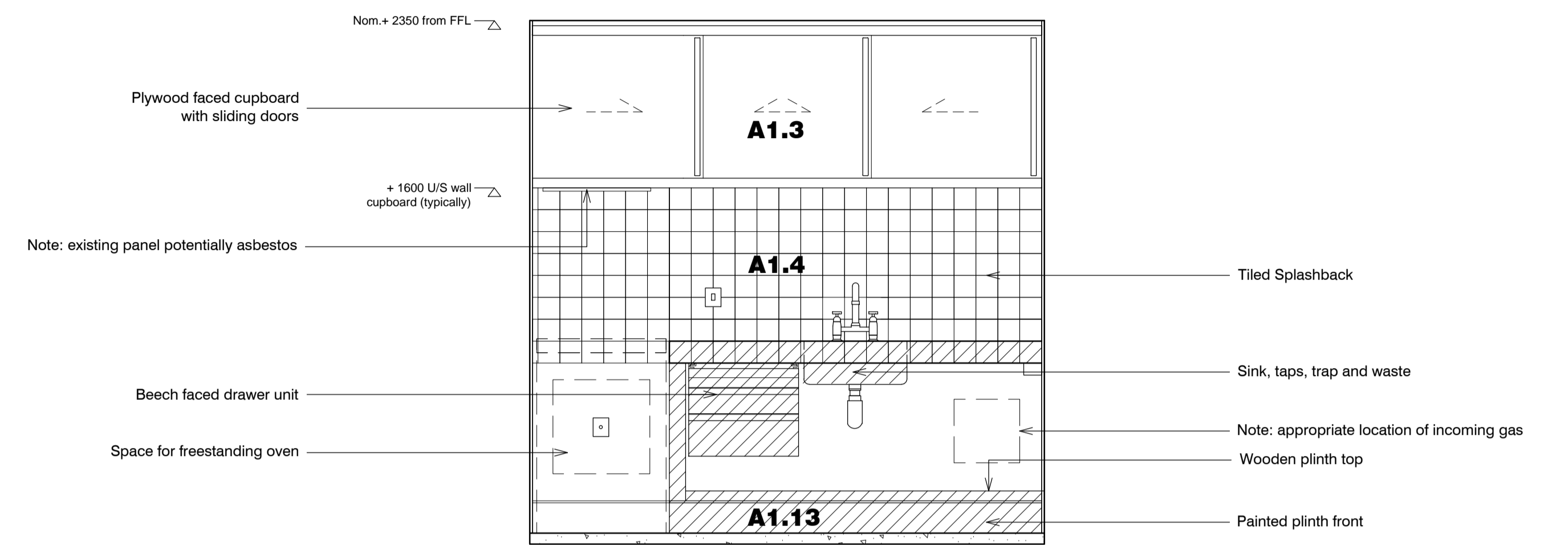

03 Section 03  
301 1:20

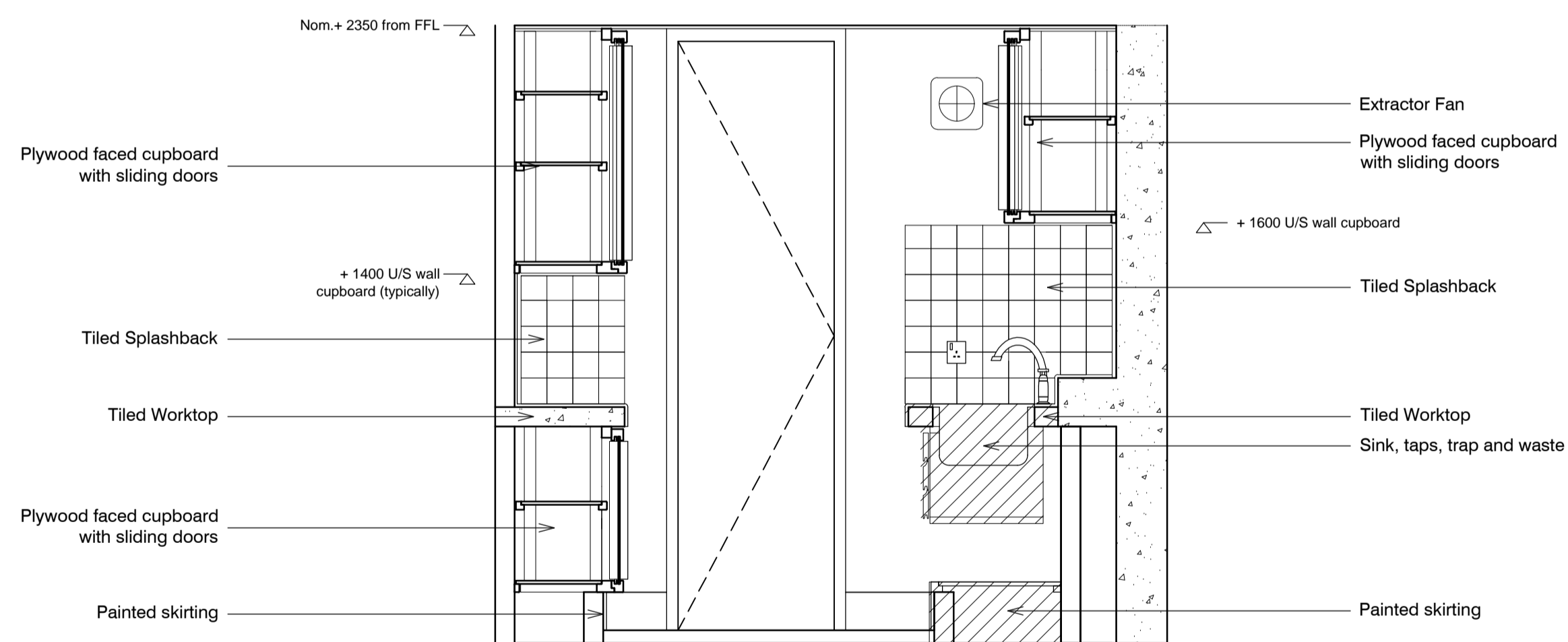

02 Section 02  
301 1:20

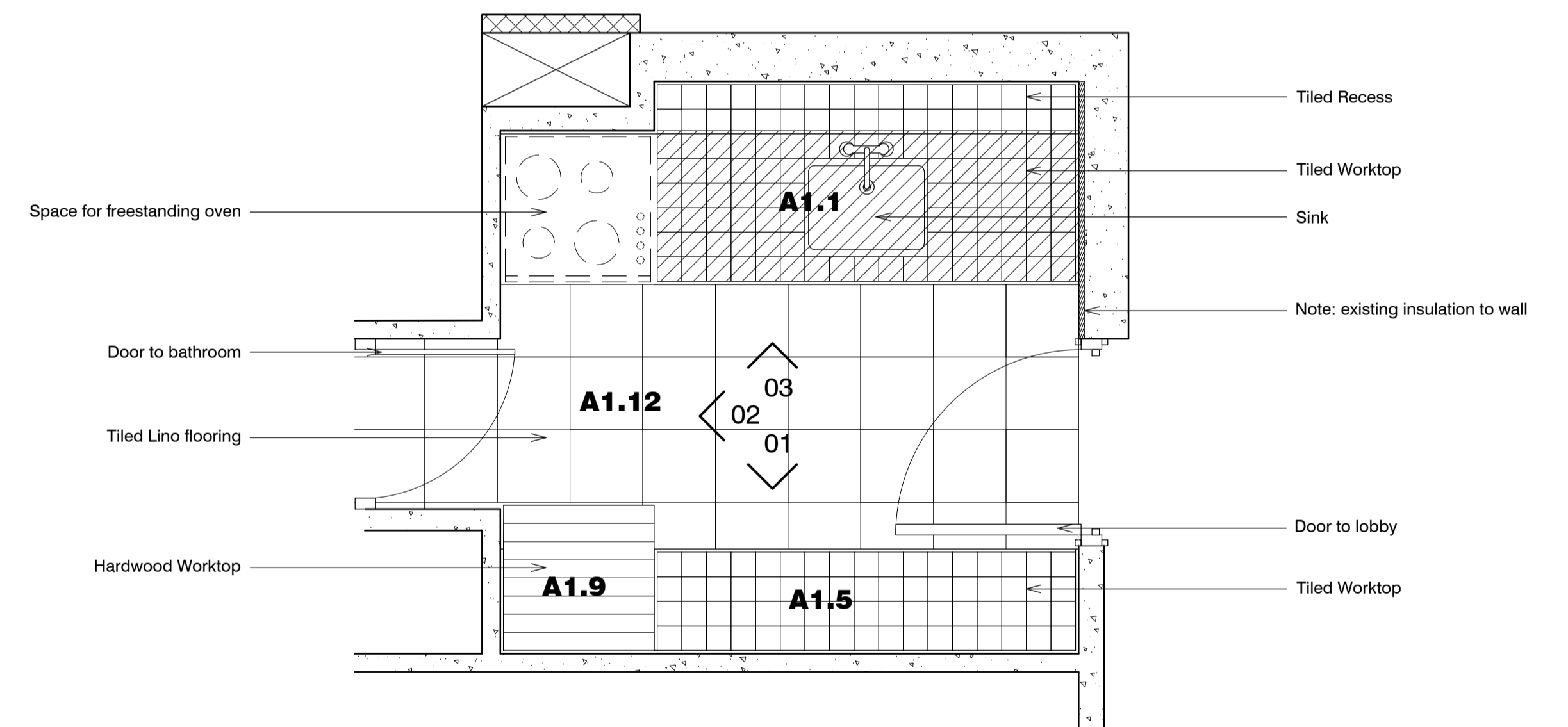

04 Plan  
301 1:20

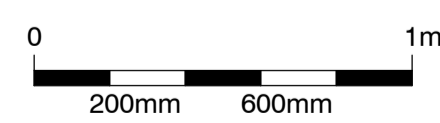

Key:  
Salvage in all cases.  
Refer to C90 specification

**standard notes**

1. Do not scale this drawing.
2. All dimensions must be checked on site and any discrepancies verified with the architect.
3. Unless shown otherwise, all dimensions are to structural surfaces.

THIS IS NOT A CONSTRUCTION DRAWING, IT IS UNSUITABLE FOR THE PURPOSE OF CONSTRUCTION AND MUST ON NO ACCOUNT BE USED AS SUCH.

**drawing notes**

1. Note that these drawings show typical dimensions whereas dwellings will vary - in particular, to suit the curvature of the railway line adjacent.
2. Services routes cannot be confirmed until full, invasive surveys are undertaken. Services are therefore shown indicatively.

**revisions**

- |    |            |                                 |
|----|------------|---------------------------------|
| C1 | 13.11.2015 | Issued for construction         |
| P1 | 27.11.2015 | Draft issue for HPA application |
| P2 | 15.12.2015 | HPA Submission                  |

# Flat Type A1 ALEXANDRA RD. ESTATE

date Dec 2015  
scale 1:20@A1  
drawn KS  
checked JM  
drawing number 2504\_RL\_301  
rev P2

client LB Camden  
drawing Original kitchen: Flat type A1

Levitt Bernstein  
1 Kingsland Passage  
London  
E8 2BB  
t: 020 7275 7676  
f: 020 7275 9348  
w: levittbernstein.co.uk  
e: post@levittbernstein.co.uk

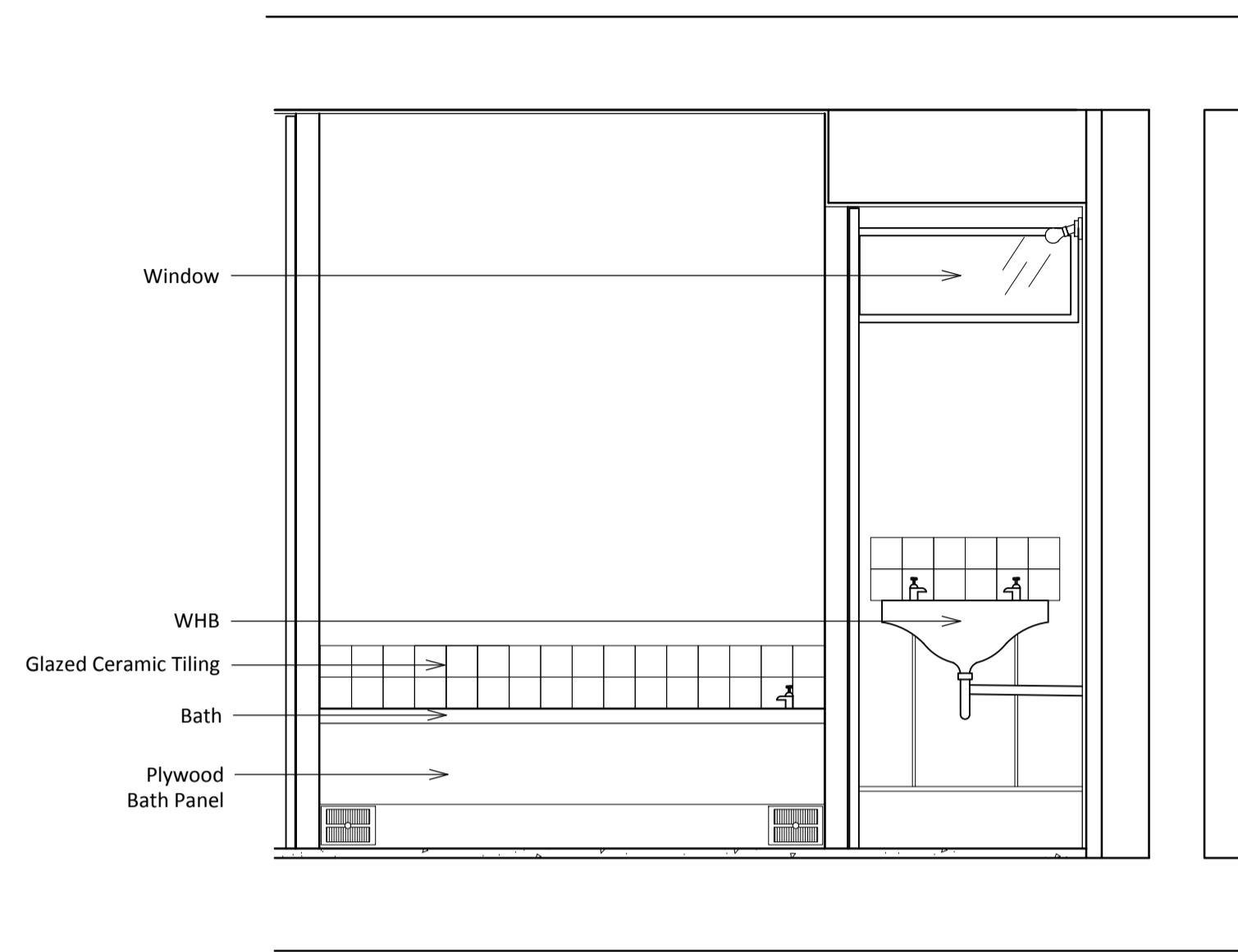

02 Section 02  
201 1:20

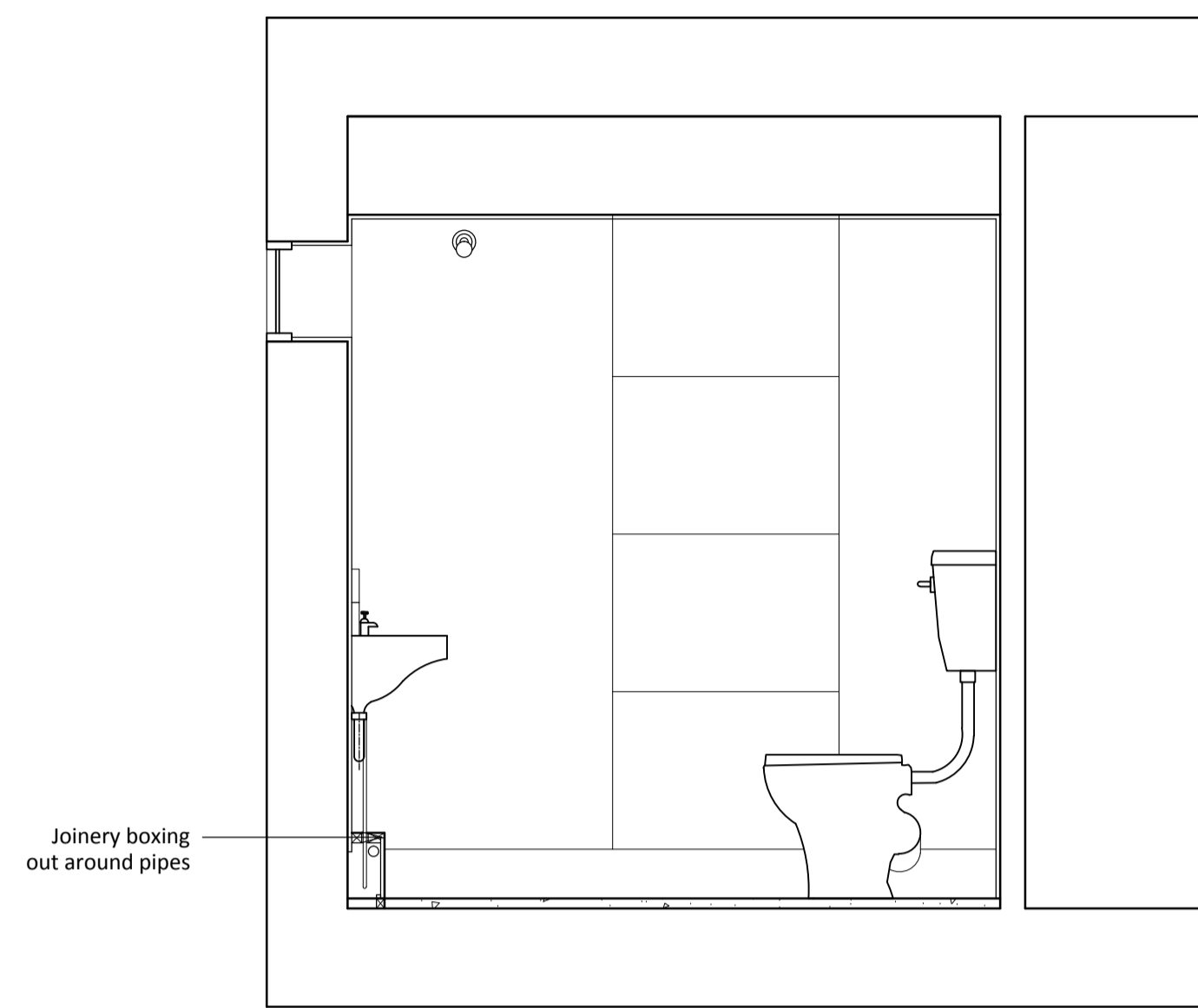

03 Section 03  
201 1:20

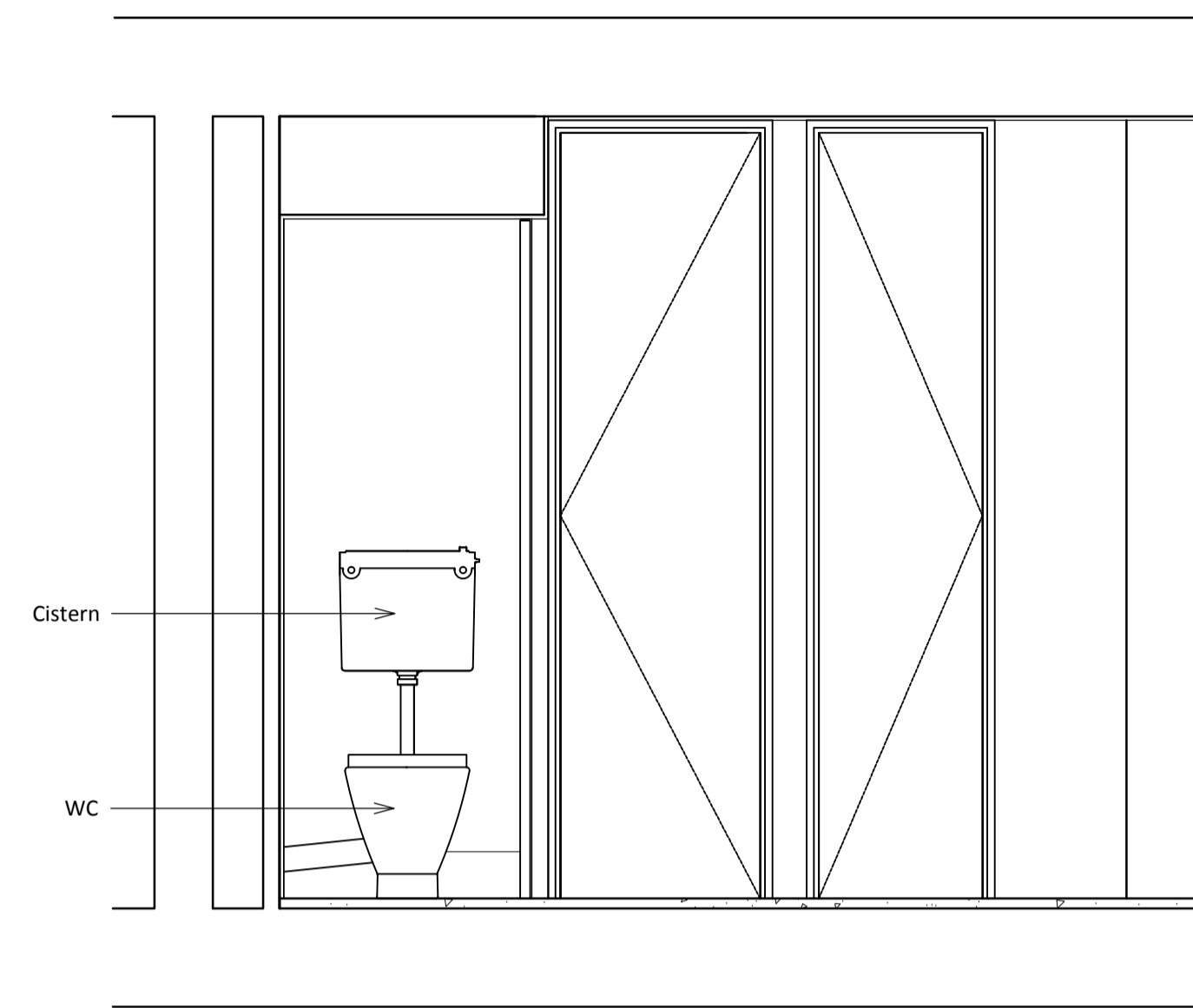

04 Section 04  
201 1:20

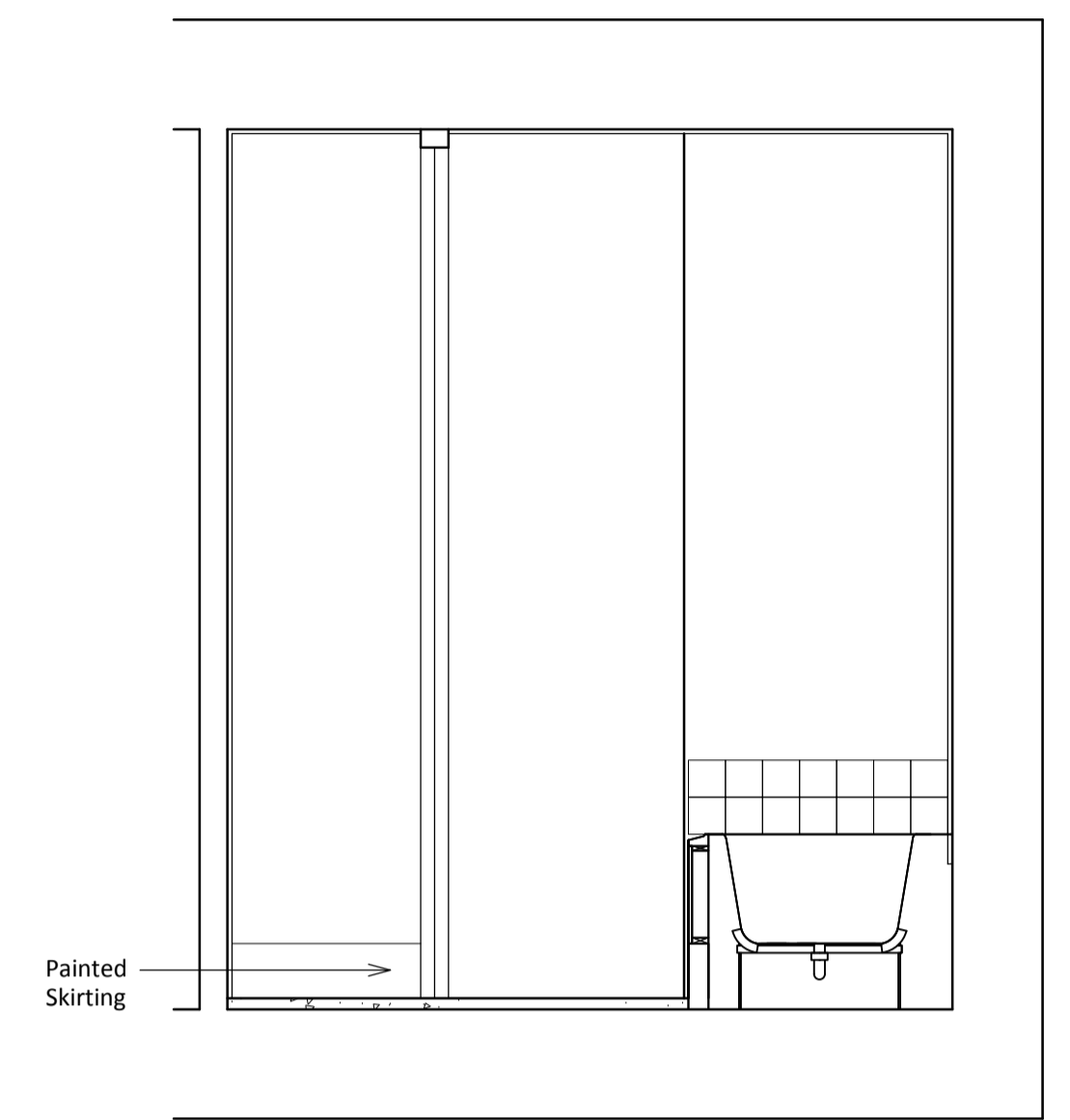

05 Section 04  
201 1:20

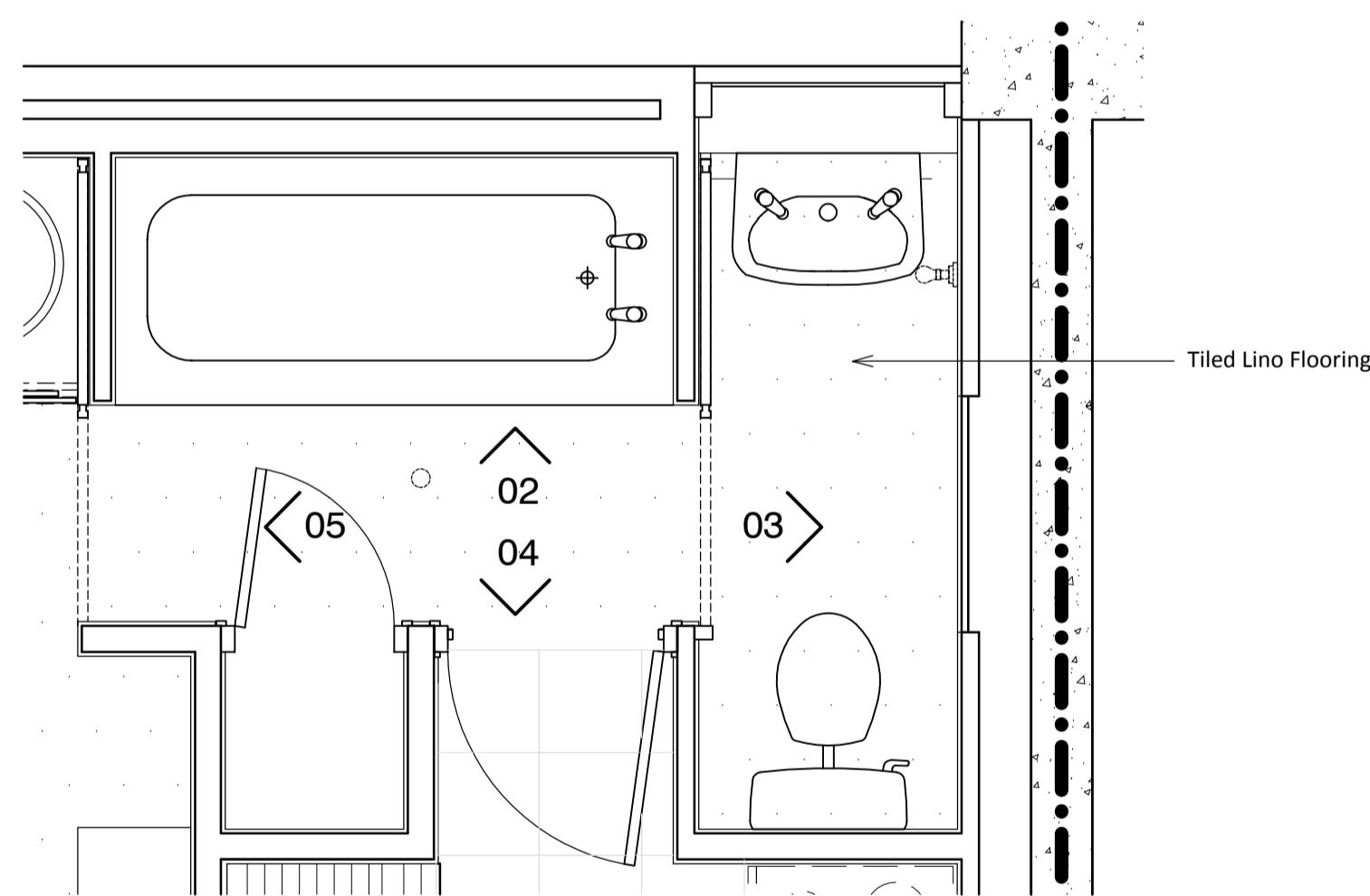

01 Bathroom Plan  
201 1:20

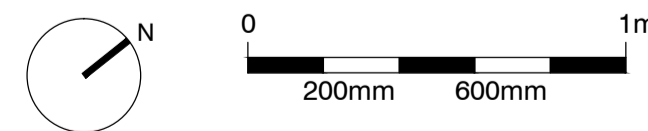

**standard notes**

1. Do not scale this drawing.
2. All dimensions must be checked on site and any discrepancies verified with the architect.
3. Unless shown otherwise, all dimensions are to structural surfaces.

**drawing notes**

1. Note that these drawings show typical dimensions whereas dwellings will vary - in particular, to suit the curvature of the railway line adjacent.
2. Services routes cannot be confirmed until full, invasive surveys are undertaken. Services are therefore shown indicatively.

**revisions**

- |    |            |                                 |
|----|------------|---------------------------------|
| P1 | 27.11.2015 | Draft issue for HPA application |
| P2 | 15.12.2015 | HPA Submission                  |

# Dwelling Type A1

## ALEXANDRA RD. ESTATE

<b>date</b> Dec 2015	<b>client</b> LB CAMDEN	<b>Levitt Bernstein</b> 1 Kingsland Passage London E8 2BB
<b>scale</b> 1:20@A1	<b>drawing</b> Original bathroom: Flat type A1	<b>t: 020 7275 7676</b> <b>f: 020 7275 9348</b> <b>w: levittbernstein.co.uk</b> <b>e: post@levittbernstein.co.uk</b>
<b>drawn</b> JA	<b>checked</b> JM	<b>drawing number</b> 2504_RL_201
		<b>rev</b> P2