

Issued by email only

Our Ref: [REDACTED]

20 January 2020

Treecare (Arboricultural Specialists) Ltd
281 The Vale
London
W3 7QA
[REDACTED]

PBA Consulting

Dear Sirs

Re: **Mr B Romeo**
13A Mornington Place, London NW1 7RW

We are dealing with a subsidence insurance claim at the above property and have established roots to be present beneath the foundations.

We, therefore, recommend that tree maintenance works be undertaken and ask that you carry out a site visit and provide us with a fixed price quotation for the following:-

Remove Blue Atlantic Cedar (T1) and Lawson Cypress (T2) as indicated on the attached plan 19088/TREES. Trees should be cut as close to ground as practicable, and stumps treated to prevent further growth.

Your quotation should include for removal of all removed material and leaving the site clean and tidy.

Access for your inspection should be arranged with Mr Romeo on telephone no [REDACTED] and we ask that your quotation should be forwarded to us by Friday 7 February 2020. Quotations received after this date will not be considered.

Yours faithfully

[REDACTED]
GEOFF SHOEBRIDGE
PBA Consulting

cc Mr B Romeo
IAS Adjusters - [REDACTED]



19088/TREES

NOTE 1: TREES 1 & 2 TO BE REMOVED

TREE 1 = BLUE ATLANTIC CEDAR (H=14m)

TREE 2 = LAWSON CYPRESS (H=12)

NOTE 2: PROPERTY IS IN A CONSERVATION AREA THEREFORE APPROVAL WILL BE REQUIRED FROM L.A.

NOTE 3: ACCESS TO TREE 1 IS RESTRICTED.

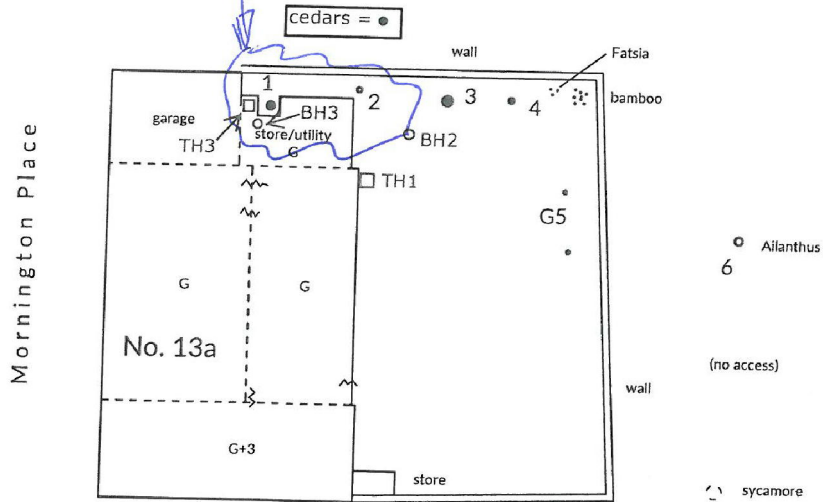

Plan drawn to approx. scale 1:200 @A4

Trees in relation to 13a Mornington Place, London, NW1 7RW
1-38-4952/P

