

Proposed Cycle Storage  
1:50 @A3

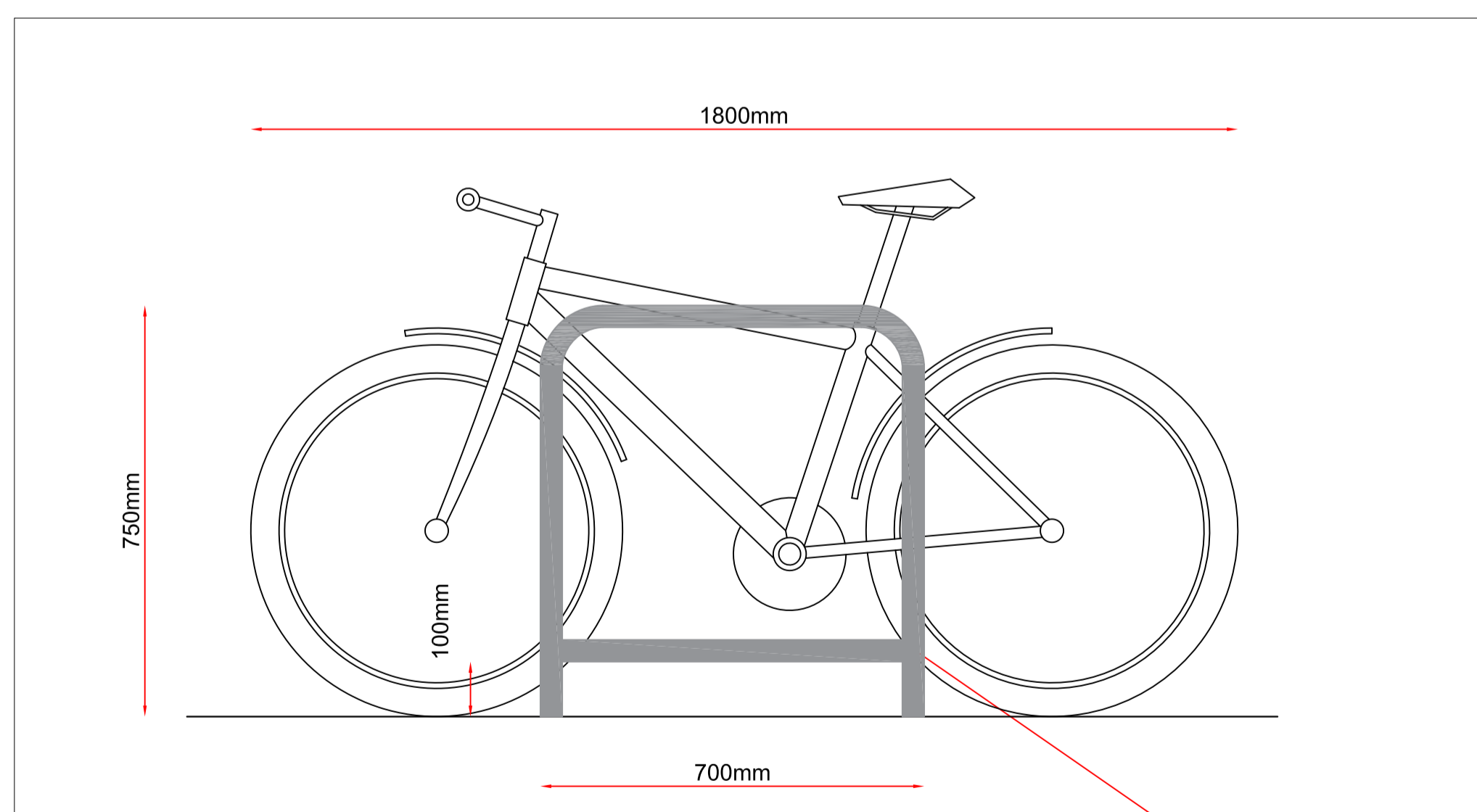

Typical Side Elevation  
1:20 @A3

Proposed Sheffield Cycle Stand

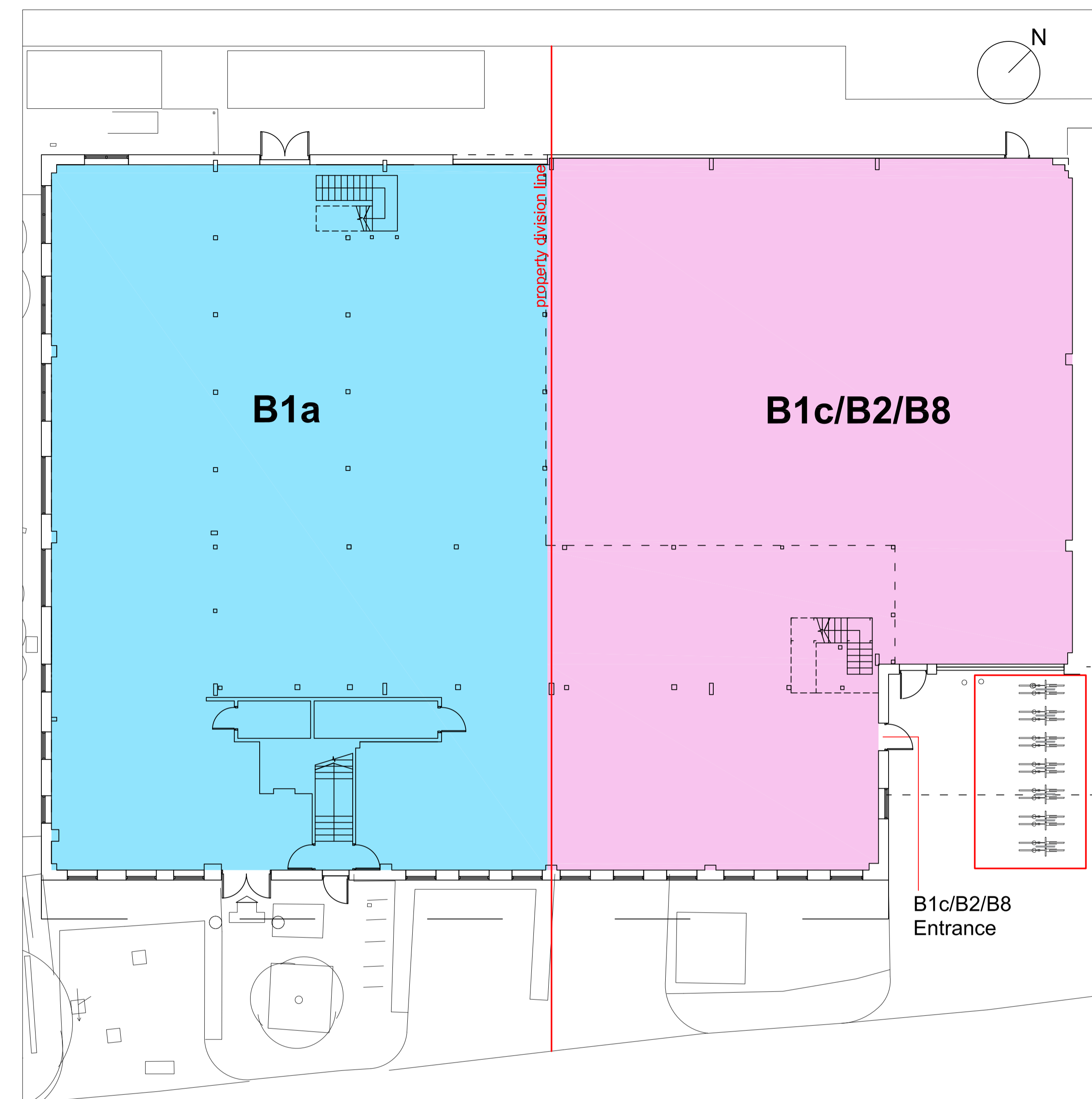

Proposed Cycle Parking  
1:250 @A3

- Cycle Storage Location

**COCI**

3rd Floor  
20 Eastbourne Terrace,  
Paddington,  
London  
W2 6LG

**JML House**  
Regis road  
London, NW5 3EG

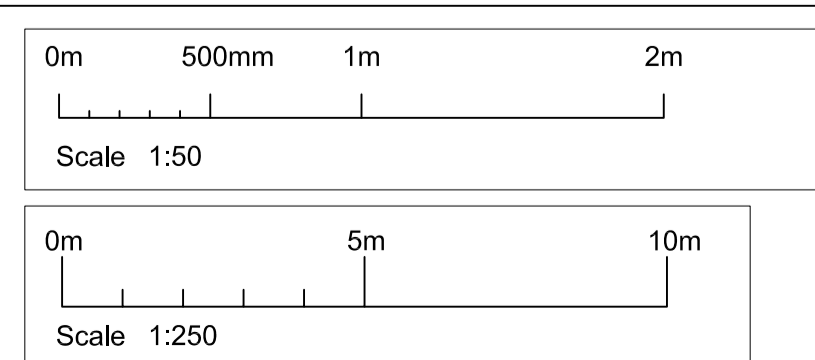

Work Stage:  
**Proposed Cycle Storage**

- Notes:
- Do not scale from this drawing, except for planning purposes
  - Check all dimensions on site
  - Subject to survey
  - Subject to site inspection
  - Site boundary lines are indicative only
  - Subject to structural engineer approval
  - Subject to building control approval

Rev	Date	By	Revisions
A	12.08.19	cf	7x Sheffield stands
B	14.08.19	cf	floorplan revision

Drawing Title:  
**Proposed Cycle Storage**

Scale: 1:250/1:20 | A3 | Date: 02/03/2020

Drawn: Koray Ezel

Drawing No: FS-1934-02 | Rev: F