

**DESIGN NOTE:**  
 FIRE/ACOUSTIC THROUGH SLAB/SOFT SPOT LOCAL BRACKET - NOT PART OF MFL SCOPE

**DESIGN NOTE:**  
 Wind Load Perpendicular: +/- 12kN  
 Wind Load Parallel: +/- 3.0kN  
 Dead Load: +/- 10.5kN

**DESIGN NOTE:**  
 SOLID CERAMIC BORDER FRIT Colour - RAL 9005  
 13X6 STRUCTURAL SILICONE SEALANT (DC 993)  
 HORIZONTAL FIRE STOP & SMOKE BARRIER  
 100mm ROCKWOOL RW3 INSULATION FITTED UNDER 33% COMPRESSION INTO POSITION.  
 HILTI CFS-SP-WB FIRESTOP SPRAY TO BE APPLIED ON TOP SURFACE OF INSULATION.  
 SPRAY 3mm THICK WITH A MINIMUM OF 13mm OVERLAP INTO ADJOINING STRUCTURES.  
**SEE DESIGN NOTES FOR ISSUED TECHNICAL REPORT REFERENCE & NUMBER**  
 2mm GALVANIZED STEEL PRESSING SEALED WITH SILGLAZE N SCREWED BACK TO BACK TO GALVANISED PRESSED WITH D7982/4.8x12mm A4 S/S SCREWS @ 300mm CTS AND FIXED TO STEEL BOX SECTION WITH HILTI HUS\_H6x45mm S/S SCREWS @ 300mm CTS  
 2X12MM THK HIGH DENSITY CALCIUM SILICATE FIRE BOARDS (1200kg/m3)  
 SIDERISE 25MM CW-FB BOARD SUPPORTED WITH 2MM THK STEEL PRESSING SECURED TO INNER SHEET  
 3MM THK ALUMINIUM BULKHEAD FINISH: SILVER ANODISED ~ 25microns  
 25mm THK SIDERISE CW-FB BOARD TO BE RETAINED TO INNER GALV SHEET WITH 2HR FIRE RESISTANT SILICONE SEALANT  
 INFILL WITH NEXUS LAMELLA BOARDS @ 124kg/m3 FIRE CLASSIFICATION - A1  
**SEE DESIGN NOTES FOR ISSUED TECHNICAL REPORT REFERENCE & NUMBER**  
 2mm SILVER ANODISED HEAD PRESSING ~ 25microns  
 25microns DESIGNED WITH 6x100mm SLOTS SPACED ALONG THE GLAZING EDGE FOR GLAZING INTO THE C/WALLING WITH THE USE OF SCHUCO CLIPS  
 CILL BRACKET TO BE FABRICATED FROM 15mm THK MILD STEEL PLATE (GRADE S275). 2No. COATS OF GALVAFROID SHOP APPLIED PRIMER PROVIDES BI-METALLIC SEPARATION OF MATERIALS WITH A ZINC RICH COATING.  
 NOTE: BRACKET IS IN DRY ZONE

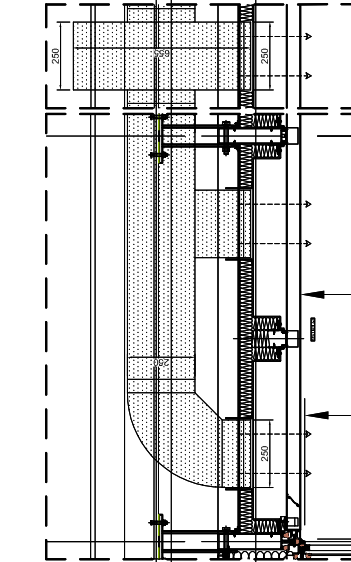

**M.F.L. CONTINUOUS LOUVRE FRAME**  
 FACTORY FABRICATED WITH 3mm THK EV1 SILVER ANODISED ALUM. FRAME WITH NYLON PERIMETER EDGE PACKER DESIGNED TO SUIT THE SCHUCO SYSTEM TOGGLE CLIPS. CONTINUOUS SPL3 BLADE SECURED WITH 30mm WIDE CLIPS. 60mm ALUM BOX SECTION & 102x72x3mm ALUM FLAT SCREW FIXED BETWEEN TRANSOMS FOR ADDITIONAL FRAME SUPPORT BETWEEN MULLIONS. 7mm COMPACT FOAM ISOLATION PACKER USED BETWEEN MULLION SECTION AND LOUVRE FRAME. BESPOKE P.C ALUM INTAKE BOX FITTED & FULLY SEALED TO C/WALL LOUVRE SYSTEM. INTAKE BOX DESIGNED TO TAKE 250x150mm PVC DUCT SYSTEM. S/STEEL FLYMESH (MESH-SFLY3) FITTED TO REAR OF LOUVRE'S OVER FACE OF BOX DURING INSTALL.



Briggs & Forrester  
 Free Area required: 1.159m<sup>2</sup>

0.9mm P.P.C STEEL BACKING SHEET FIXED AROUND SYSTEM WITH D7981/4.2x13mm SCREWS @ 50mm FROM EACH CORNER & APPROX 250mm CTS.  
 Colour: SA803G 60microns CLASS 1 D1036  
 C/WALLING FIXING BRACKET TO BE FABRICATED FROM 10mm THK MILD STEEL PLATE (GRADE S275)  
 2No. COATS OF GALVAFROID SHOP APPLIED PRIMER  
 C/WALLING FIXED TO BRACKET WITH: D933/M16x130mm A4 S/STEEL SET BOLTS D125/M16 & D127/M16 A4 S/STEEL FLAT/SPRING WASHERS  
 D934/M16 FULL HEAD A4 A4 S/STEEL NUTS  
 Tightening Torque for M16 = 140Nm  
 BRACKETS FIXED TO STRUCTURE WITH: 4No. M10x10mm A4 S/S MOLA BOLTS: PA1060\_SS M10 A4 S/S NUT: PA10  
 Tightening Torque for M10 = 33Nm  
 BRACKETS ISOLATED FROM STEEL BEAMS WITH 0.75mm CORTEX 0750 EPDM.

**Slab Details**  
 Scale: 1:5@A3

**CDM Regulations**

Hazards	Date Added	Date Mitigated	Risk Assessment Date
HEAVY GLASS - LOADS INDICATED	05/02/15		

HEALTH & SAFETY REVIEW REQUIRED IN ACCORDANCE WITH CDM REGULATIONS

EAST  
NORTH  
WEST  
SOUTH

**KEY PLAN**

**DESIGN NOTES: Technical Report list:**

DOCUMENT TITLE	Doc Number	CONNECT Number
Facade Design & Glass Risk Assessment	3135-TR003	KXC-S1-001-Y-21-TR003
Glass Technical report	3135-TR004	KXC-S1-001-Y-21-TR004
Technical data for HBI fire stop details	3135-TR005	KXC-S1-001-Y-21-TR005
Material data sheet report	3135-TR006	KXC-S1-001-Y-21-TR006
Door schedule & Operation Information	3135-TR007	KXC-S1-001-Y-21-TR007
Facade Airborne Acoustic report	3135-TR008	KXC-S1-001-Y-21-TR008
Facade Vertical & Horizontal Acoustic report	3135-TR009	KXC-S1-001-Y-21-TR009
Accommodation of structural movement	3135-TR012	KXC-S1-001-Y-21-TR012
Hatten channel & Slab edge design	3135-TR013	KXC-S1-001-Y-21-TR013
Thermal Safety Check on Glass	3135-TR022	KXC-S1-001-Y-21-TR022

**DO NOT SCALE : IF IN DOUBT ASK!**

THIS DRAWING REMAINS THE PROPERTY OF McMULLEN FACADES LTD AND SHOULD NOT BE COPIED NOR ITS CONTENTS DIVULGED WITHOUT PRIOR CONSENT

Signed:	SPATTERSON	Internal Quality Check
Date:	04-05-2018	

No.	Intd	Date	Description	Date	
003	DR	GB	17/04/19	ALL COMMENTS RECEIVED - FOR CONSTRUCTION ISSUE	17/04/19
002	DR	GB	19/12/18	THIRD ISSUE	19/12/18
001	SP	SP	20/07/18	ALL COMMENTS RECEIVED	20/07/18
000	SP	SP	04-05-18	FIRST ISSUE	04-05-18

Revision	Check	Description	Date

Contract: KINGSCROSS S1  
 Architect: MOSSISSIAN  
 Main Contractor: BAM  
 Drawing: WEST ELEV. GND FLOOR BAY STUDY DETAILS  
 Drawn By: SPatterson Date: 04/04/18  
 Scale: 1:5 @ A3 MFL No.: 3135-504  
 DMS Code: KXC-S1-001-Y-3135-21-504 Revison: 003  
 DRAWING ISSUED FOR: STATUS OF PREVIOUS RETURN  
**CONSTRUCTION A (B) C -**

McMullen Facades Limited  
 66 Lurgan Road, Moira,  
 Craigavon, Co. Armagh BT67 0LX  
 Tel: +44 (0) 28 9261 9688  
 Fax: +44 (0) 28 9261 9711  
 Email: design@mcmullenfacades.com