

Drawing Note:

- All bird and bat boxes are to be south facing.

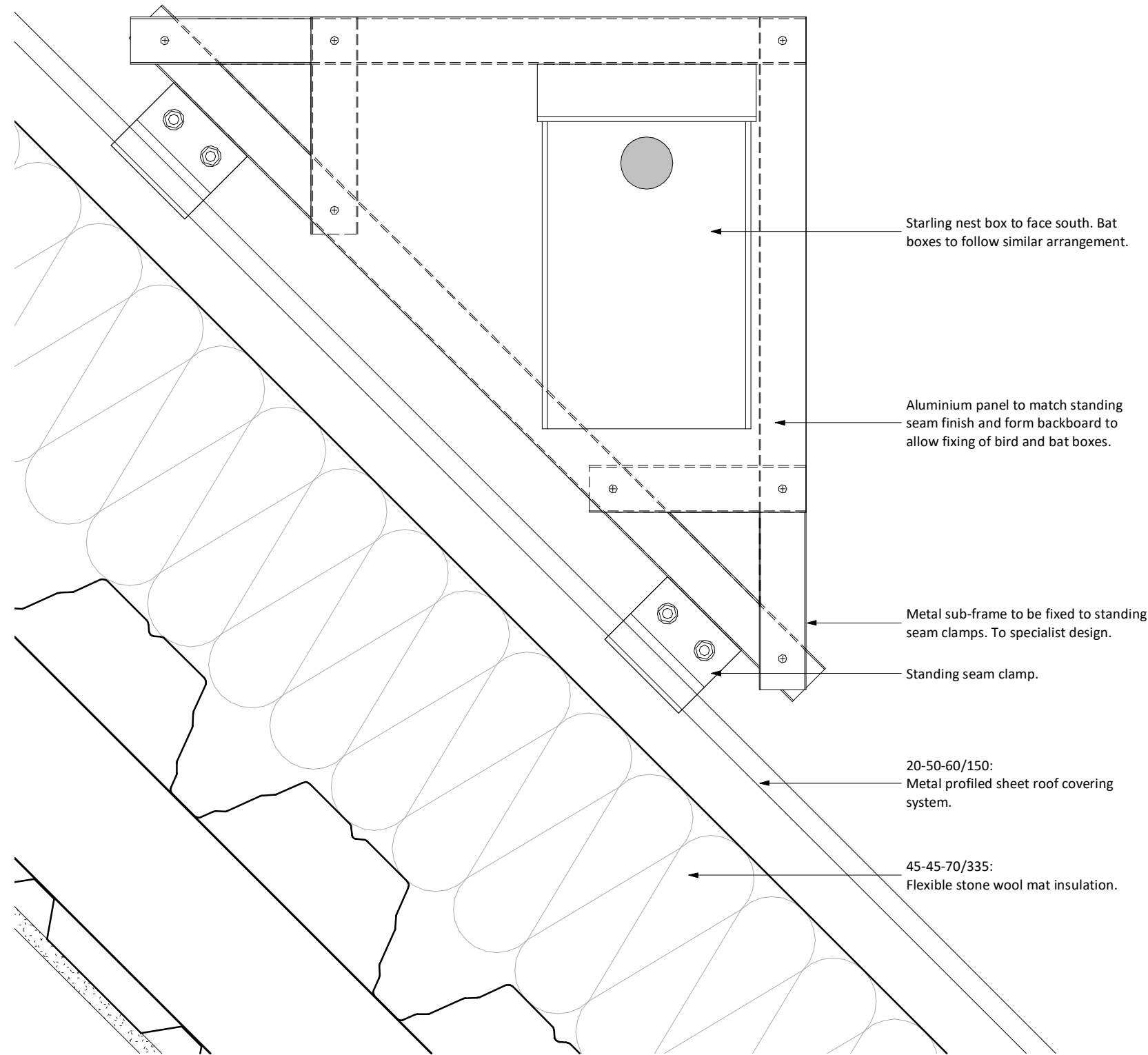

Bird Box Fixing Frame
1 : 5

S2	P157	13.02.20	First Issue	
STATUS	REV	DATE	DESCRIPTION	
CLIENT				REVISED BY
BAM Construction				NV
				CHECKED BY
				CC
				ORIGINATOR NO
				151890

CONSULTANT
STRIDE TREGLOWN
www.stridetreglown.com © Stride Treglown Limited 2017

PROJECT
King's Cross Q1
Handyside Street
King's Cross Central
London N1C 4AL

DRAWING TITLE
Bird and Bat box Fixing Arrangement Detail

SUITABILITY STATUS	SCALE
S2 : SUITABLE FOR INFORMATION	1 : 5 @ A3

SITE PROJ.COLLECT. ZONE PROJ.REF ROLE ORIGIN. CLASS. NUMBER	REVISION
KXC-Q1-ZZ-001-A-STL-27-00110	P157