

Drawing Note:

- 4no. Bat Boxes
- 4no. Bird Boxes
- Please refer to drawing 00110 for fixing arrangement and relevant technical data sheets for product information.
- All bird and bat boxes are to be south facing.

BUILDING Q2

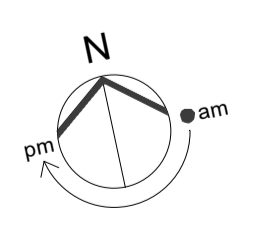
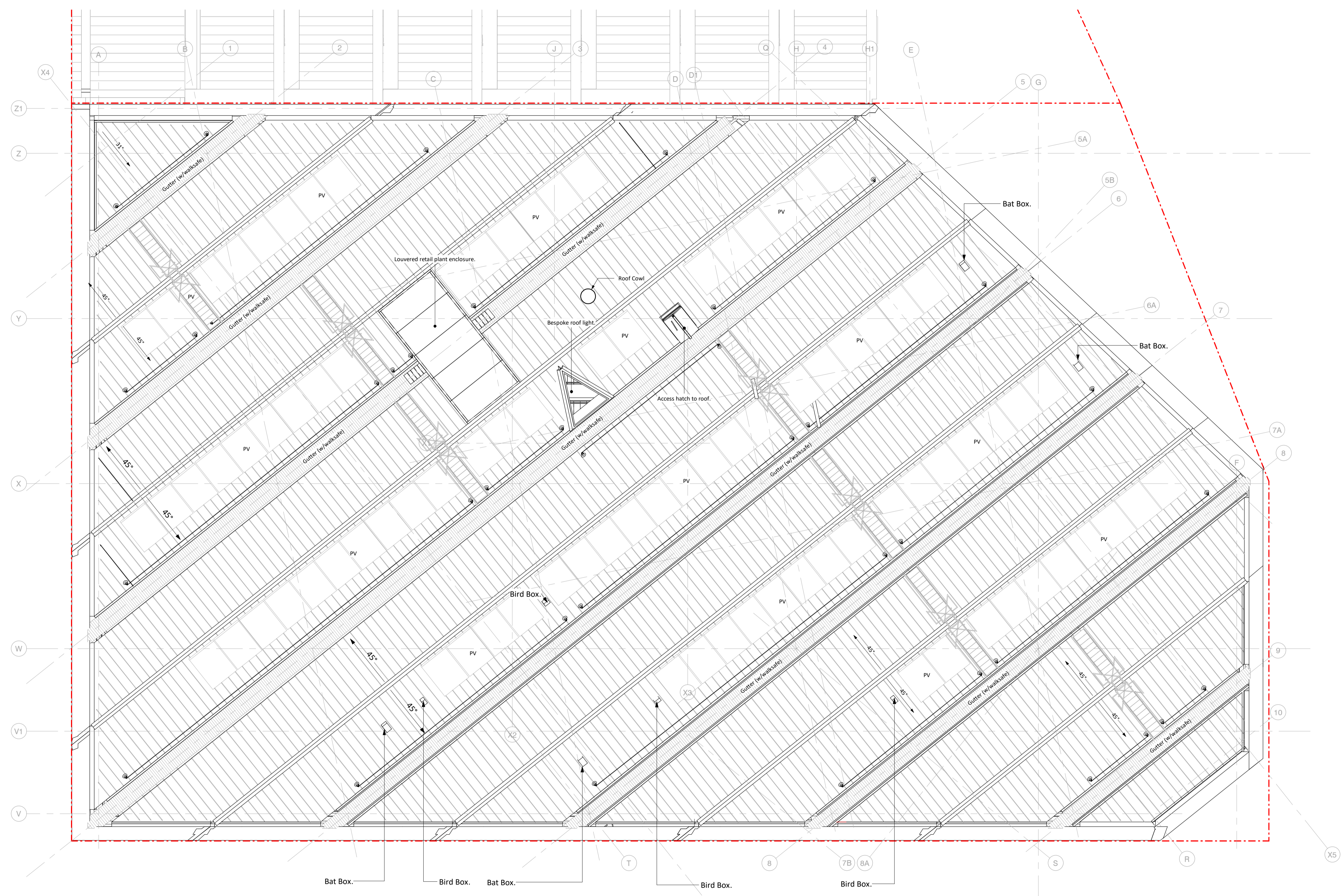

General Arrangement Plan - Roof
1:100

S2	P157	13.02.20	First Issue	
STATUS	REV	DATE	DESCRIPTION	
CLIENT				REVISED BY NV
BAM Construction				CHECKED BY CC
				ORIGINATOR NO 151890

CONSULTANT
STRIDE TREGLOWN
www.stride-treglow.com © Stride Treglow Limited 2018

PROJECT
King's Cross Q1
Handside Street
King's Cross Central
London N1C 4AL

DRAWING TITLE
Roof Plan - Bird and Bat Box Locations

SUITABILITY STATUS	SCALE
S2 : SUITABLE FOR INFORMATION	1 : 100 @ A1

SITE PROJ.COLLECT. ZONE PROJ.REF ROLE ORIGIN. CLASS. NUMBER	REVISION
KXC-Q1-03-001-A-STL-27-00111	P157