

LYNDON
GOODE
ARCHITECTS

© 2019 Lyndon Goode Architects Ltd.
For general enquires: studio@lyndongoode.com

Do not scale from this drawing. Contractor to check and verify all building and site dimensions, levels and sewer invert levels at connection points before work starts.

This drawing is to be read and checked in conjunction with information provided by the engineers and other specialists.

REV.	DATE	DESCRIPTION
------	------	-------------

P01	25/02/20	Issue for Planning
-----	----------	--------------------

KEY PLAN

INFORMATION

Drawing Notes:

- Works to swimming pool to be most carefully carried out with invasive interventions kept to an absolute minimum.
- Existing internal surfaces to be suitably cleaned, dried and protected at all times.
- Demolishing, enlarging and infilling of openings to happen prior to independent lining install.
- New linings to be installed independently and avoid any fixing to existing surfaces.
- Independent linings to be easily removable if required in future.

Key:

- | | |
|--|------------------|
| | To be demolished |
| | To be enlarged |
| | To be filled |

0 0.2 0.4 1 m
Scale (1:20)

PROJECT
35 Templewood Avenue

DRAWING
Existing Listed Building
Plan

SCALE	REV.
1 : 20 at A1	P01

DRAWING NUMBER
TAV- LGA- ZA- ZZ- DR- A- 0190

DRAWING STATUS
PLANNING

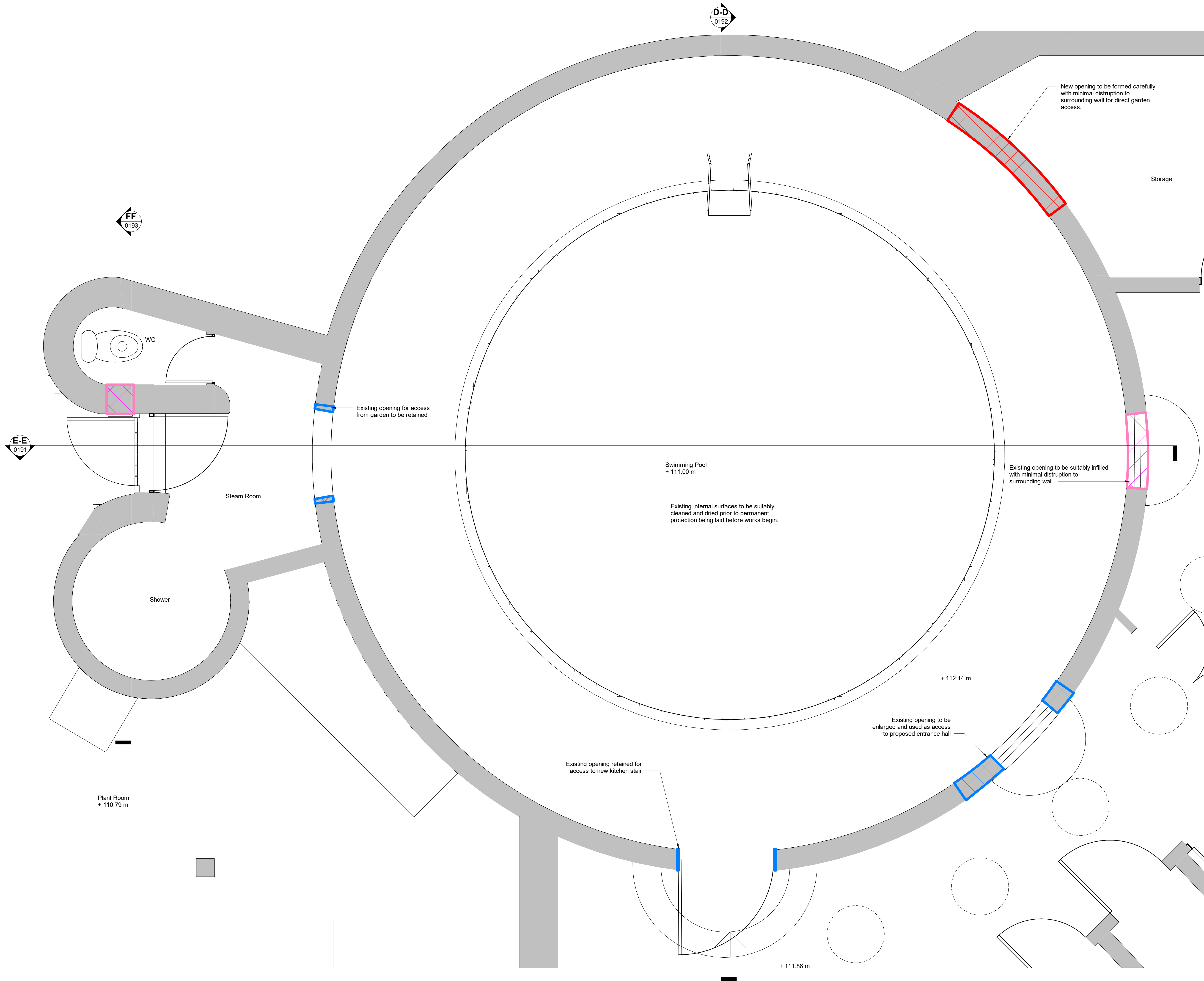

LYNDON
GOODE
ARCHITECTS

© 2019 Lyndon Goode Architects Ltd.
For general enquires: studio@lyndongoode.com

Do not scale from this drawing. Contractor to check and verify all building and site dimensions, levels and sewer invert levels at connection points before work starts.

This drawing is to be read and checked in conjunction with information provided by the engineers and other specialists.

REV.	DATE	DESCRIPTION
P01	25/02/20	Issue for Planning

KEY PLAN

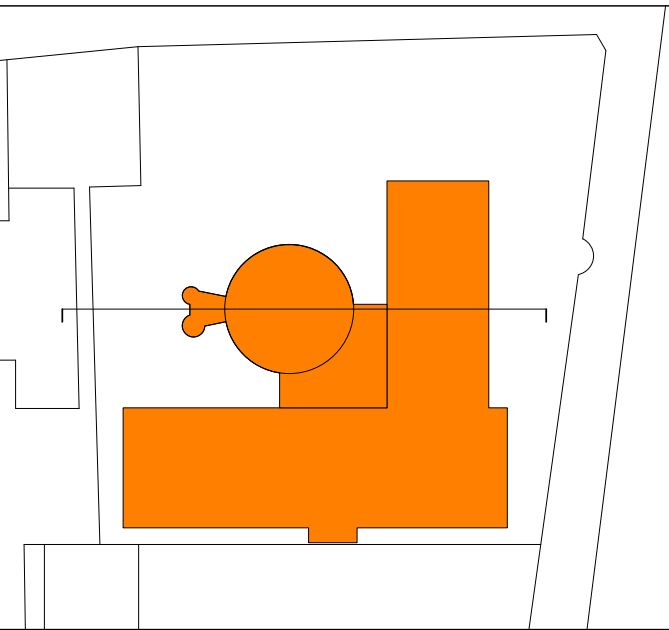



INFORMATION

Drawing Notes:

- Works to swimming pool to be most carefully carried out with invasive interventions kept to an absolute minimum.
- Existing internal surfaces to be suitably cleaned, dried and protected at all times.
- Demolishing, enlarging and infilling of openings to happen prior to independent lining install.
- New linings to be installed independently and avoid any fixing to existing surfaces.
- Independent linings to be easily removable if required in future.

Key:

-  To be demolished
-  To be enlarged
-  To be filled

0 0.2 0.4 1 m
Scale (1:20)

PROJECT
35 Templewood Avenue
DRAWING
**Existing Listed Building
Section EE**

SCALE
1 : 20 at A1
REV.
P01

DRAWING NUMBER
TAV- LGA- ZA- ZZ- DR- A- 0191

DRAWING STATUS
PLANNING

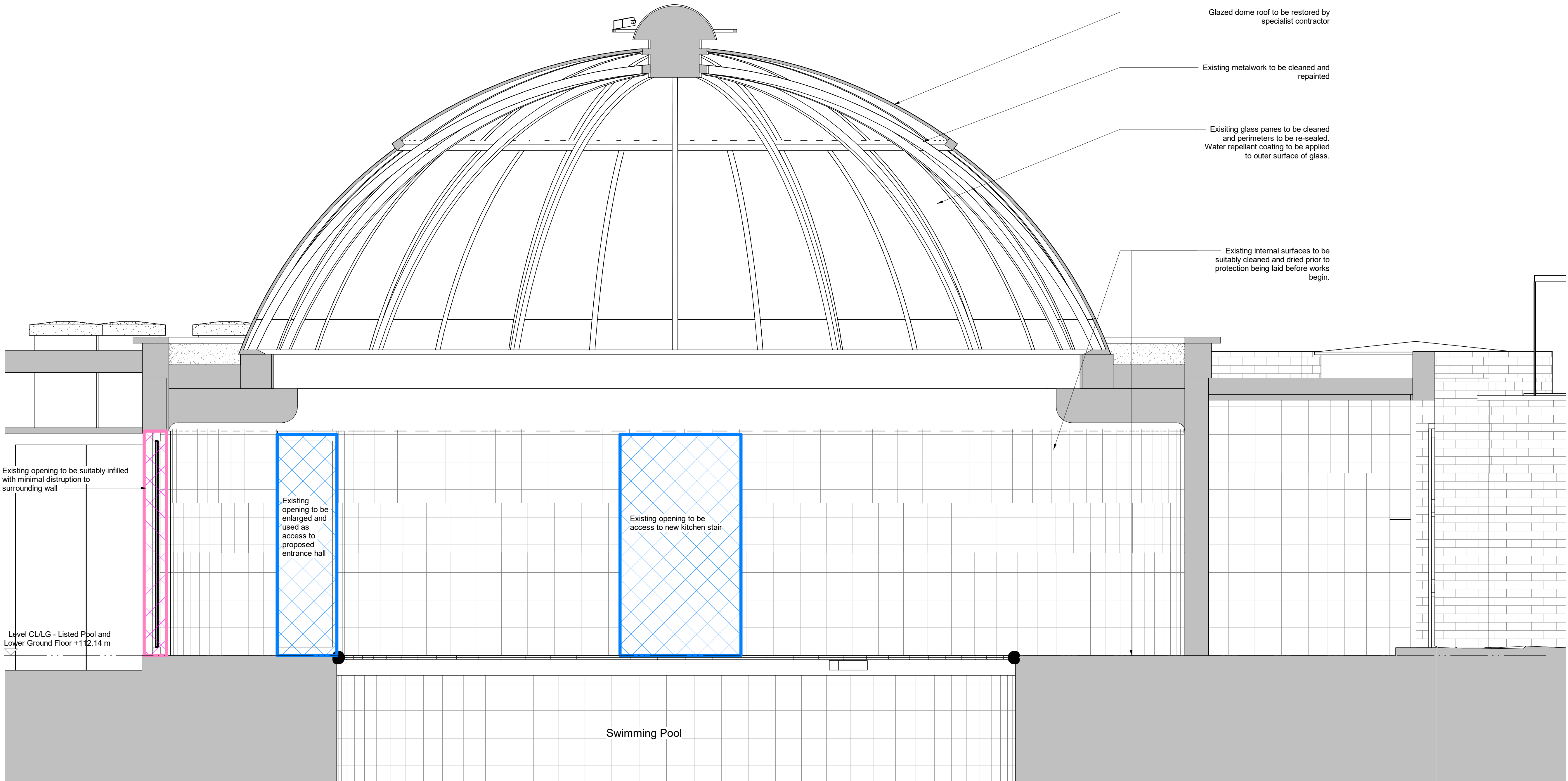

LYNDON
GOODE
ARCHITECTS

© 2019 Lyndon Goode Architects Ltd.
For general enquires: studio@lyndongoode.com

Do not scale from this drawing. Contractor to check and verify all building and site dimensions, levels and sewer invert levels at connection points before work starts.

This drawing is to be read and checked in conjunction with information provided by the engineers and other specialists.

REV.	DATE	DESCRIPTION
P01	25/02/20	Issue for Planning

KEY PLAN

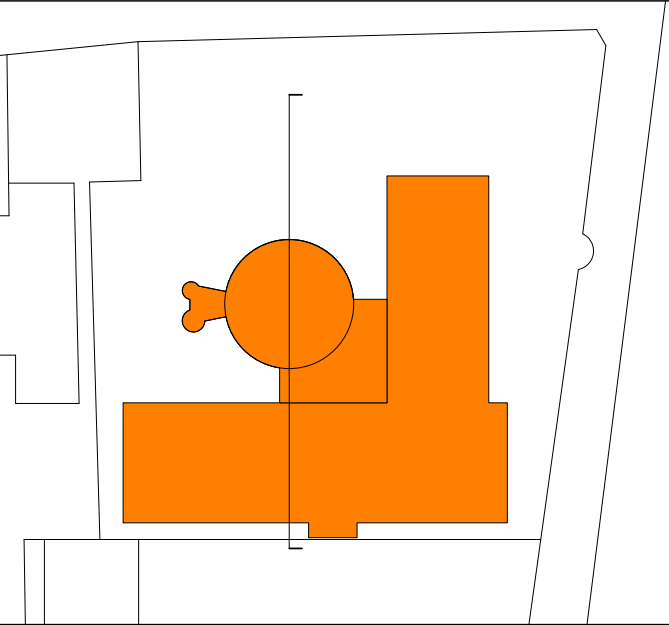

INFORMATION

Drawing Notes:

- Works to swimming pool to be most carefully carried out with invasive interventions kept to an absolute minimum.
- Existing internal surfaces to be suitably cleaned, dried and protected at all times.
- Demoishing, enlarging and infilling of openings to happen prior to independent lining install.
- New linings to be installed independently and avoid any fixing to existing surfaces.
- Independent linings to be easily removable if required in future.

Key:

- To be demolished
- To be enlarged
- To be filled

0 0.2 0.4 1 m
Scale (1:20)

PROJECT
35 Templewood Avenue

DRAWING
Existing Listed Building
Section DD

SCALE
1 : 20 at A1

REV.
P01

DRAWING NUMBER
TAV- LGA- ZA- ZZ- DR- A- 0192

DRAWING STATUS
PLANNING

Glazed dome roof to be restored by specialist contractor

Existing metalwork to be cleaned and repainted

Existing glass panes to be cleaned and perimeters to be re-sealed. Water repellent coating to be applied to outer surface of glass.

Existing internal surfaces to be suitably cleaned and dried prior to protection being laid before works begin.

Grass mound to be reinstated where indicated pending structural engineer input on existing wall integrity

Level CL/LG - Listed Pool and Lower Ground Floor +112.14 m

Swimming Pool

Existing opening to be enlarged and used as access to proposed entrance hall

Existing opening to be access to new kitchen stair

LYNDON
GOODE
ARCHITECTS

© 2019 Lyndon Goode Architects Ltd.
For general enquires: studio@lyndongoode.com

Do not scale from this drawing. Contractor to check and verify all building and site dimensions, levels and sewer invert levels at connection points before work starts.

This drawing is to be read and checked in conjunction with information provided by the engineers and other specialists.

REV.	DATE	DESCRIPTION
------	------	-------------

P01	25/02/20	Issue for Planning
-----	----------	--------------------

KEY PLAN

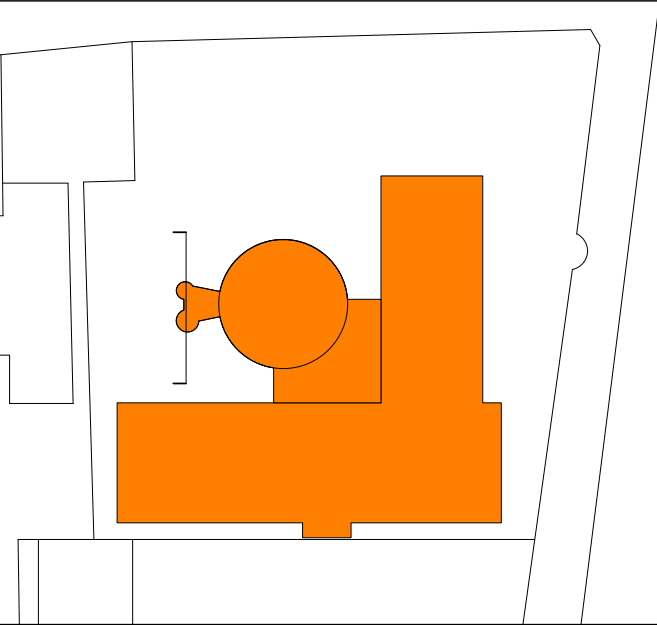



INFORMATION

Drawing Notes:

- Works to swimming pool to be most carefully carried out with invasive interventions kept to an absolute minimum.
- Existing internal surfaces to be suitably cleaned, dried and protected at all times.
- Demolishing, enlarging and infilling of openings to happen prior to independent lining install.
- New linings to be installed independently and avoid any fixing to existing surfaces.
- Independent linings to be easily removable if required in future.

Key:

-  To be demolished
-  To be enlarged
-  To be filled

0 0.2 0.4 1 m
Scale (1:20)

PROJECT
35 Templewood Avenue

DRAWING
Existing Listed Building
Section FF

SCALE	REV.
1 : 20 at A1	P01

DRAWING NUMBER
TAV- LGA- ZA- ZZ- DR- A- 0193

DRAWING STATUS
PLANNING

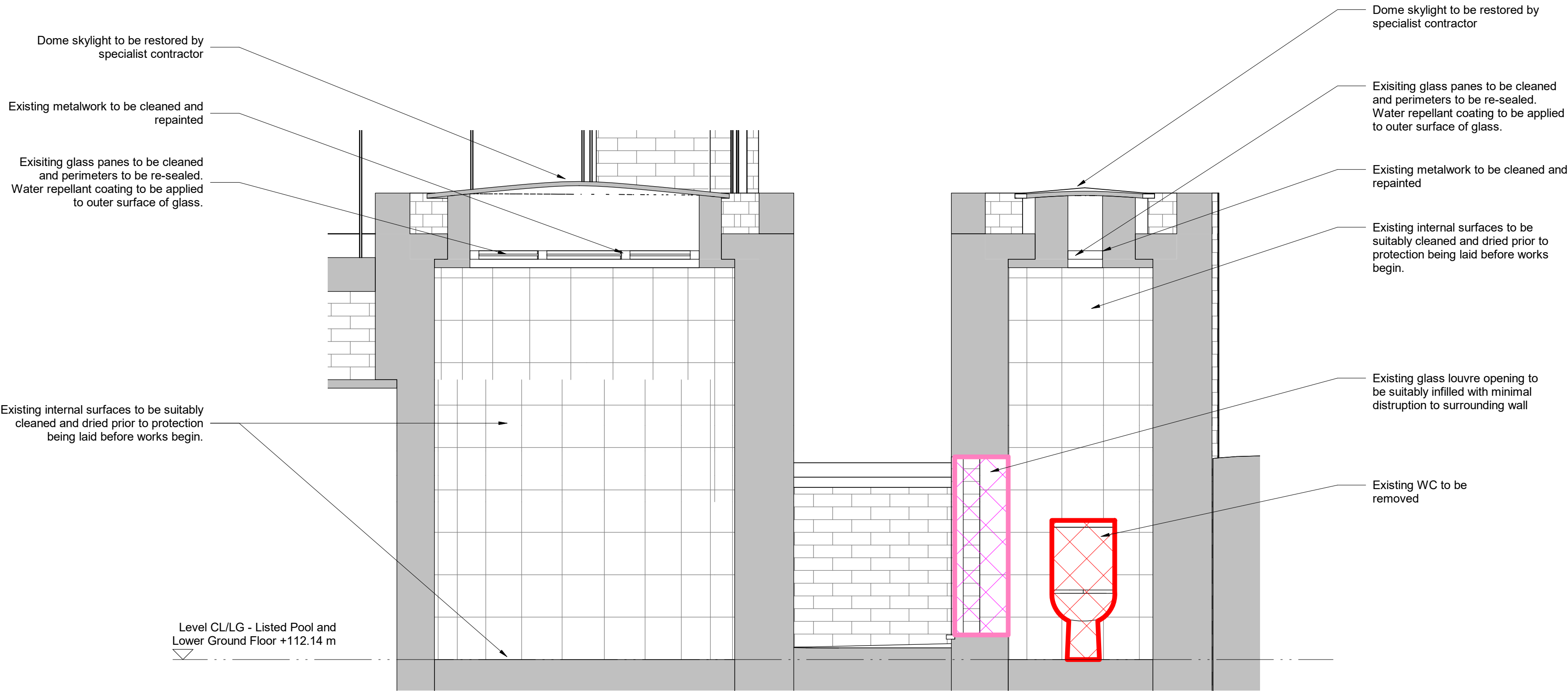

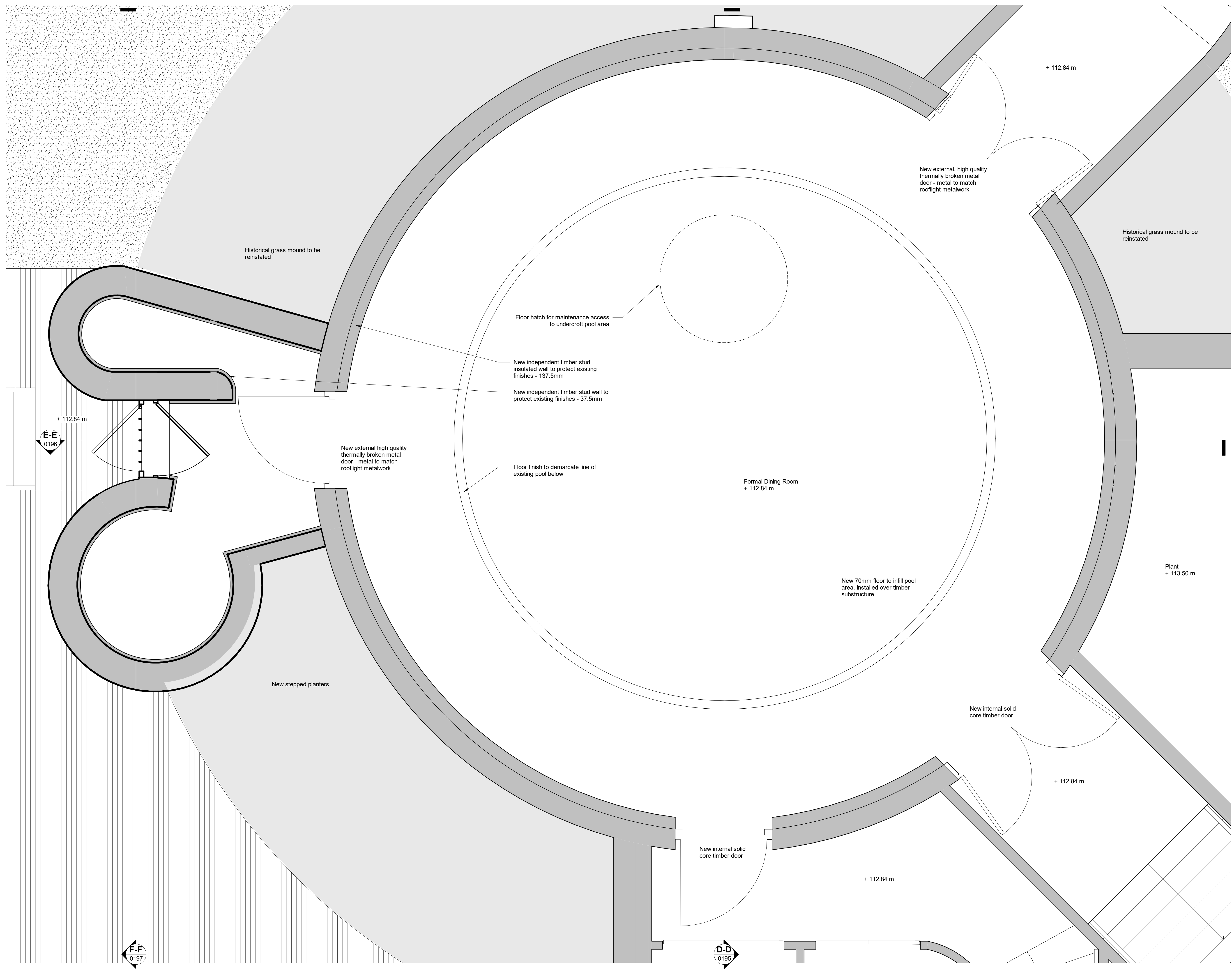

LYNDON
GOODE
ARCHITECTS

© 2019 Lyndon Goode Architects Ltd.
For general enquires: studio@lyndongoode.com

Do not scale from this drawing. Contractor to check and verify all building and site dimensions, levels and sewer invert levels at connection points before work starts.

This drawing is to be read and checked in conjunction with information provided by the engineers and other specialists.

REV.	DATE	DESCRIPTION
P01	25/02/20	Issue for Planning

KEY PLAN

INFORMATION

00.20.41
Scale (1:20)

PROJECT

35 Templewood Avenue

DRAWING

Proposed Listed Building
Upper Ground Floor
Level

SCALE

1 : 20 at A1

REV.

P01

DRAWING NUMBER

TAV- LGA- ZA- ZZ- DR- A- 0194

DRAWING STATUS

PLANNING

LYNDON
GOODE
ARCHITECTS

© 2019 Lyndon Goode Architects Ltd.
For general enquires: studio@lyndongoode.com

Do not scale from this drawing. Contractor to check and verify all building and site dimensions, levels and sewer invert levels at connection points before work starts.

This drawing is to be read and checked in conjunction with information provided by the engineers and other specialists.

REV.	DATE	DESCRIPTION
------	------	-------------

P01	25/02/20	Issue for Planning
-----	----------	--------------------

KEY PLAN

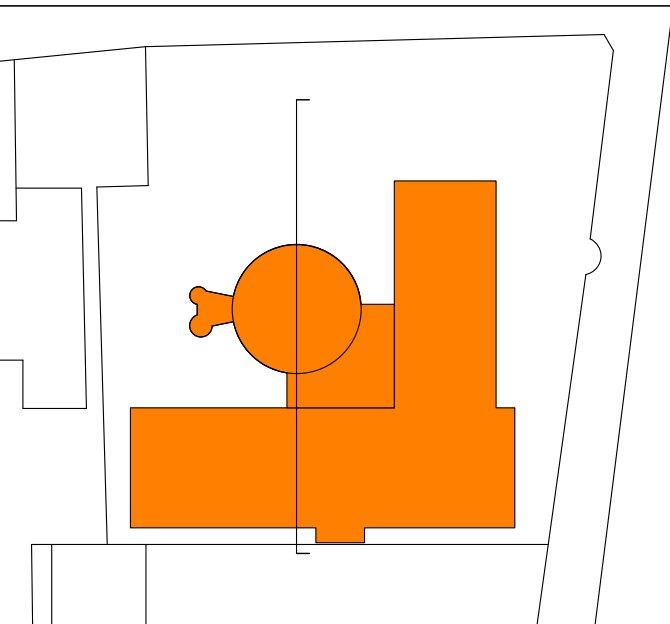

INFORMATION

0 0.2 0.4 1 m
Scale (1:20)

PROJECT
35 Templewood Avenue

DRAWING
Proposed Listed Building
Section DD

SCALE	REV.
1 : 20 at A1	P01

DRAWING NUMBER
TAV- LGA- ZA- ZZ- DR- A- 0195

DRAWING STATUS
PLANNING

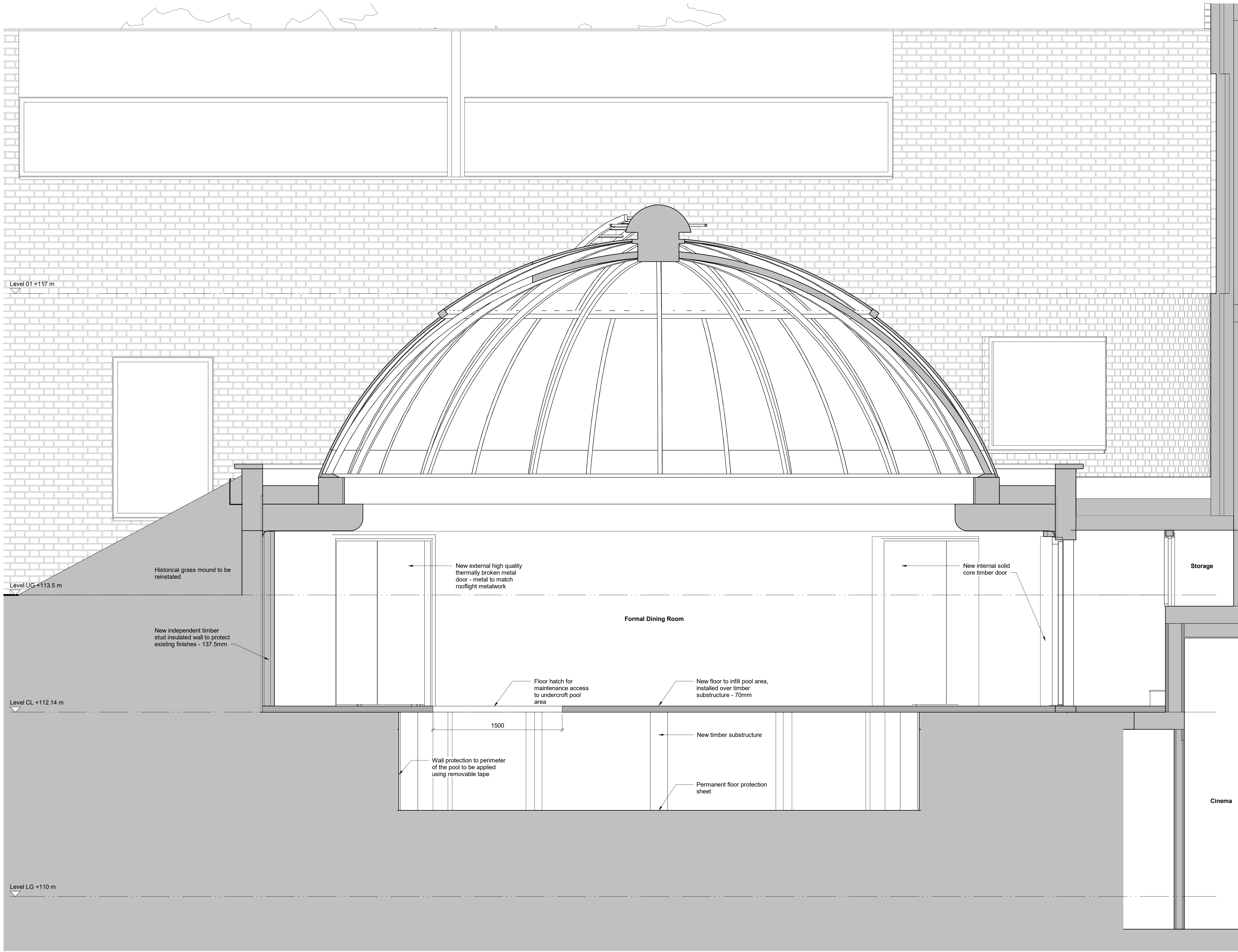

LYNDON
GOODE
ARCHITECTS

© 2019 Lyndon Goode Architects Ltd.
For general enquires: studio@lyndongoode.com

Do not scale from this drawing. Contractor to check and verify all building and site dimensions, levels and sewer invert levels at connection points before work starts.

This drawing is to be read and checked in conjunction with information provided by the engineers and other specialists.

REV.	DATE	DESCRIPTION
------	------	-------------

P01	25/02/20	Issue for Planning
-----	----------	--------------------

KEY PLAN

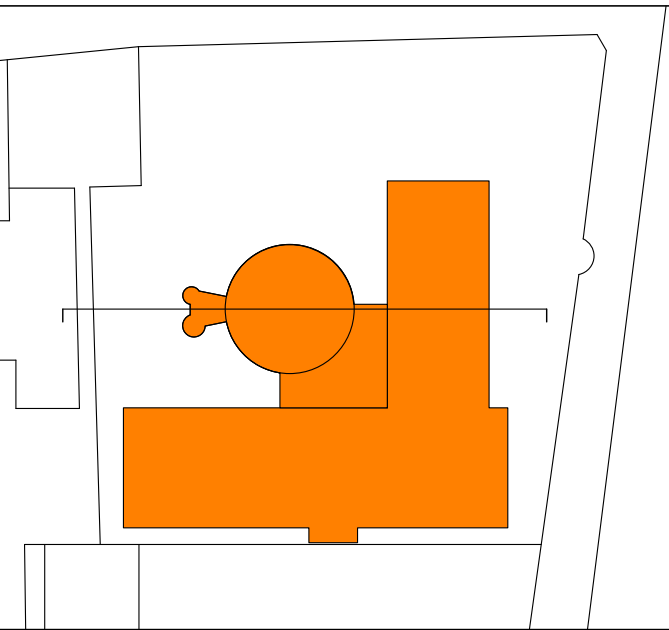

INFORMATION

0 0.2 0.4 1 m
Scale (1:20)

PROJECT
35 Templewood Avenue
DRAWING
**Proposed Listed Building
Section EE**

SCALE	REV.
1 : 20 at A1	P01

DRAWING NUMBER
TAV- LGA- ZA- ZZ- DR- A- 0196

DRAWING STATUS
PLANNING

Level 01 +117 m

Level UG +113.5 m

Level CL +112.14 m

Level LG +110 m

New independent
timber stud
insulated wall to
protect existing
finishes - 137.5mm

New internal solid
core timber door

Formal Dining Room

New floor to infill pool area,
installed over timber
substructure - 70mm

New external high quality
thermally broken metal
door - metal to match
rooflight metalwork

New independent
timber stud wall to
protect existing
finishes - 37.5mm

New 70mm floor installed
over permanent protection
sheet to existing floor

Wall protection to perimeter
of the pool to be applied
using removable tape

New timber substructure

Permanent floor protection
sheet

LYNDON
GOODE
ARCHITECTS

© 2019 Lyndon Goode Architects Ltd.
For general enquires: studio@lyndongoode.com

Do not scale from this drawing. Contractor to check and verify all building and site dimensions, levels and sewer invert levels at connection points before work starts.

This drawing is to be read and checked in conjunction with information provided by the engineers and other specialists.

REV.	DATE	DESCRIPTION
------	------	-------------

P01	25/02/20	Issue for Planning
-----	----------	--------------------

KEY PLAN

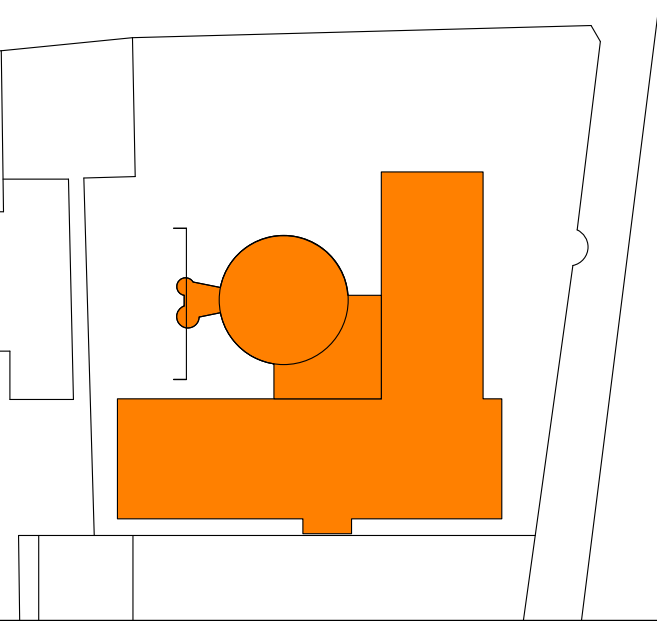

INFORMATION

0 0.2 0.4 1 m
Scale (1:20)

PROJECT
35 Templewood Avenue

DRAWING
Proposed Listed Building
Section FF

SCALE	REV.
1 : 20 at A1	P01

DRAWING NUMBER
TAV- LGA- ZA- ZZ- DR- A- 0197

DRAWING STATUS
PLANNING

