

01 Entrance Cill Detail

Scale: 1:5@A3

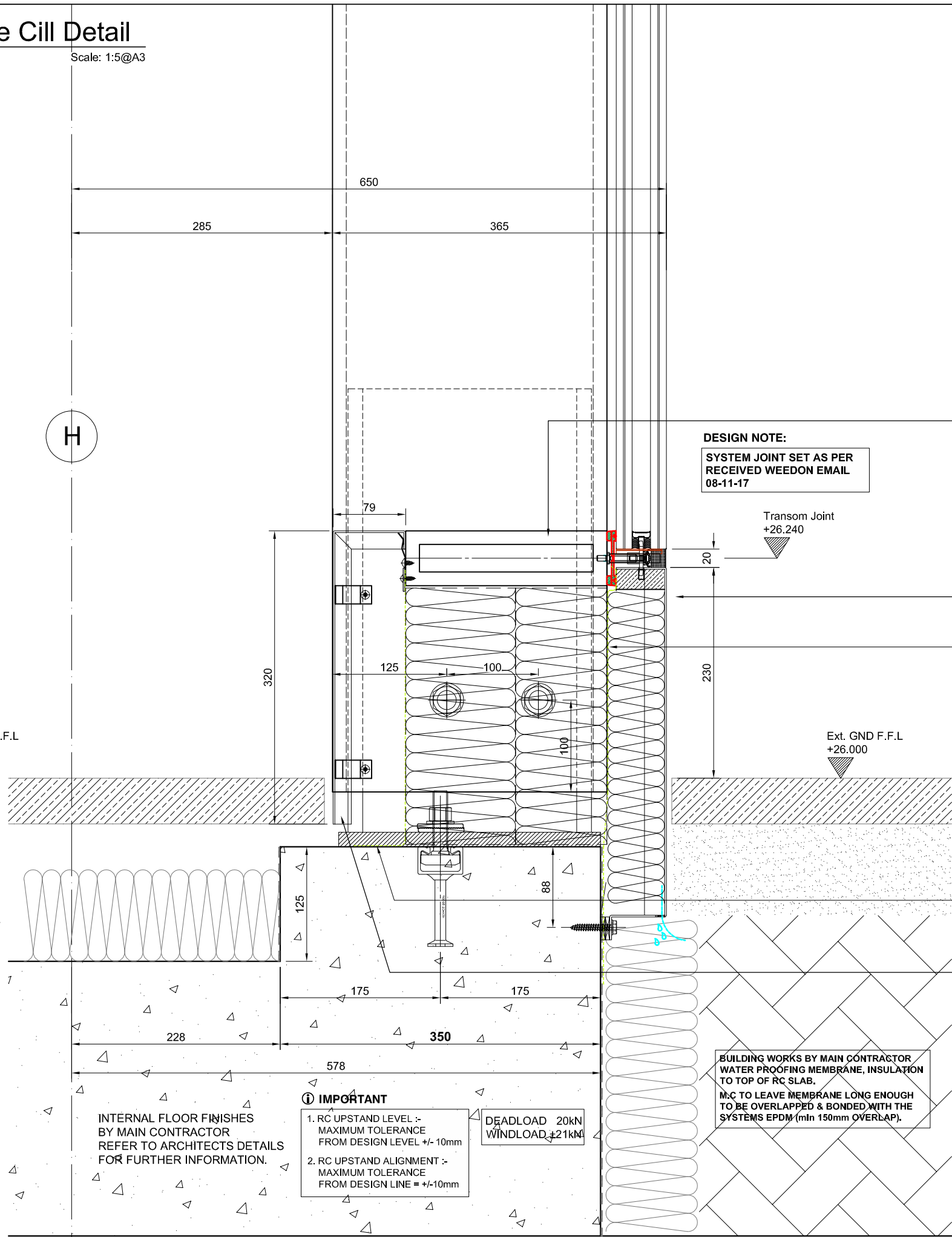

SCHUCO VISS Ixtra LAZER WELDED BESPOKE STEEL C/WALLING S/G SYSTEM:
MULLION & TRANSOM ~ Steel Grade S 275 J2
COLOUR CHANGE TO SL804G RAL 7004 (MATT HR)
ON GROUND FLOOR STICK SYSTEMS -
AS PER RFI-00137/ CRF-034 RESPONSE 505 -
18.03.19

2mm THK STAINLESS STEEL CILL FLASHING
Grade 316 ~ Finish: SATIN
6x100mm SLOTS SPACED ACROSS GLAZING EDGE TO
TAKE SCHUCO CLIPS. FIXED BACK TO UPSTAND WITH
76x38x3mm ALUM ANGLE. FIXED TO CONC. WITH HILTI
HUS_HR 6x35mm SELF DRIVE SCREW ANCHORS (Order
No.: #290005)
INSTALLATION NOTE: ANY FIXINGS THAT PENETRATE
MEMBRANES MUST BE FULLY SEALED WITH SILICONE
SEALANT

0.75mm CORTEX 0750 EPDM MEMBRANE GLAZED INTO BTM
TRANSOM & DRESSED & BONDED OVER UPSTAND MEMBRANE
EPDM NOTE:
ALL JOINT/OVERLAPS TO BE A MIN. 150mm & BONDED
WITH CORTEX 0775 CONTACT ADHESIVE TO
MANUFACTURES RECOMMENDATIONS
**SEE DESIGN NOTES FOR ISSUED TECHNICAL REPORT
REFERENCE & NUMBER**

U/S OF TRANSOM & FACE OF UPSTAND TO BE FITTED
WITH ROCKWOOL RWA45 INSULATION. IF REQ IDP
INSULATION FASTENERS TO BE USED TO
MANUFACTURES RECOMMENDATIONS

0.7mm EPDM VAPOUR BARRIER FIXED & SEALED TO
TRANSOM WITH D7981/4.2x13mm S/S SELF TAPPERS &
25x1.6mm ALUM FLAT. & BONDED TO FACE OF UPSTAND
EPDM OVERLAPS BONDED WITH CORTEX 0775
CONTACT ADHESIVE ~ TO MANUFACTURES
RECOMMENDATIONS.

3mm P.P.C ALUM INTERNAL CILL FLASHING
Colour: SA803G 60microns ~ CLASS 1 D1036
FIXED FROM BACK OF TRANSOM WITH SCHUCO CLIPS
228 650 AND FIXED BACK TO UPSTAND WITH ALUM
ANGLE WITH HILTI HUS_HR 6x35mm SELF DRIVE
SCREW ANCHORS (Order No.: #290005) &

JRL
McMULLEN

CDM Regulations

Hazards	Date Added	Date Mitigated	Risk Assessment Date
HEAVY GLASS ~ LOADS INDICATED	05/02/15		

HEALTH & SAFETY REVIEW
REQUIRED IN ACCORDANCE
WITH CDM REGULATIONS

EAST

NORTH

WEST

SOUTH

KEY PLAN

DESIGN NOTES: Technical Report list:

DOCUMENT TITLE	Doc Number	CONJECT Number
Facade Design & Glass Risk Assessment	3135-TR003	KXC-S1-001-Y-21-TR003
Glass Technical report	3135-TR004	KXC-S1-001-Y-21-TR004
Technical data for HBI fire stop details	3135-TR005	KXC-S1-001-Y-21-TR005
Material data sheet report	3135-TR006	KXC-S1-001-Y-21-TR006
Door schedule & Operation Information	3135-TR007	KXC-S1-001-Y-21-TR007
Facade Airborne Acoustic report	3135-TR008	KXC-S1-001-Y-21-TR008
Facade Vertical & Horizontal Acoustic report	3135-TR009	KXC-S1-001-Y-21-TR009
Accommodation of structural movement	3135-TR012	KXC-S1-001-Y-21-TR012
Halfen channel & Slab edge design	3135-TR013	KXC-S1-001-Y-21-TR013
Thermal Safety Check on Glass	3135-TR022	KXC-S1-001-Y-21-TR022

DO NOT SCALE : IF IN DOUBT ASK!

©

THIS DRAWING REMAINS THE PROPERTY
OF McMULLEN FACADES LTD AND SHOULD
NOT BE COPIED NOR ITS CONTENTS
DIVULGED WITHOUT PRIOR CONSENT

Signed: 002

Date: 04-05-2018

Internal
Quality Check

003

GC

GB

04-04-19

COLOUR CHANGE
ISSUE FOR CONSTRUCTION

04-04-19

002

CC

CC

26-02-19

EXTERNAL LEVEL AMENDED
ISSUE FOR CONSTRUCTION

26-02-19

001

DR

GB

07-12-18

SECOND ISSUE

07-12-18

000

SP

SP

04-05-18

FIRST ISSUE

04-05-18

No.

Intd

Intd

Date

Revision

Check

Description

Date

Contract: KINGSCROSS S1

Architect: MOSSESIAN

Main Contractor: BAM

Drawing: SOUTH ELEVATION GND - 2ND FLOOR
GENERAL SYSTEM DETAILS

Drawn By: SPatterson

Date: 04-05-2018

Scale: 1:5 @ A3

MFL No.: 3135-608

DMS Code: KXC-S1-001-Y-3135-21-608

Revision: 003

DRAWING ISSUED FOR: CONSTRUCTION

STATUS OF
PREVIOUS RETURN
A B C -

McMullen Facades Limited
66 Lurgan Road, Moira,
Craigavon, Co. Armagh BT67 0LX
Tel: +44 (0) 28 9261 9688
Fax: +44 (0) 28 9261 9711
Email: design@mcmmullenfacades.com

M:\Current Contracts - MFL\3135 Kings Cross S1\01 MFL Drawings\1.4 CAD Files\Package B - Ground Floor\02 - South Elevation Ground Floor.dwg : 4/4/2019 2:33 PM : Gary Creaney