

01 Column Bracket Details
Scale: 1:5@A3

1

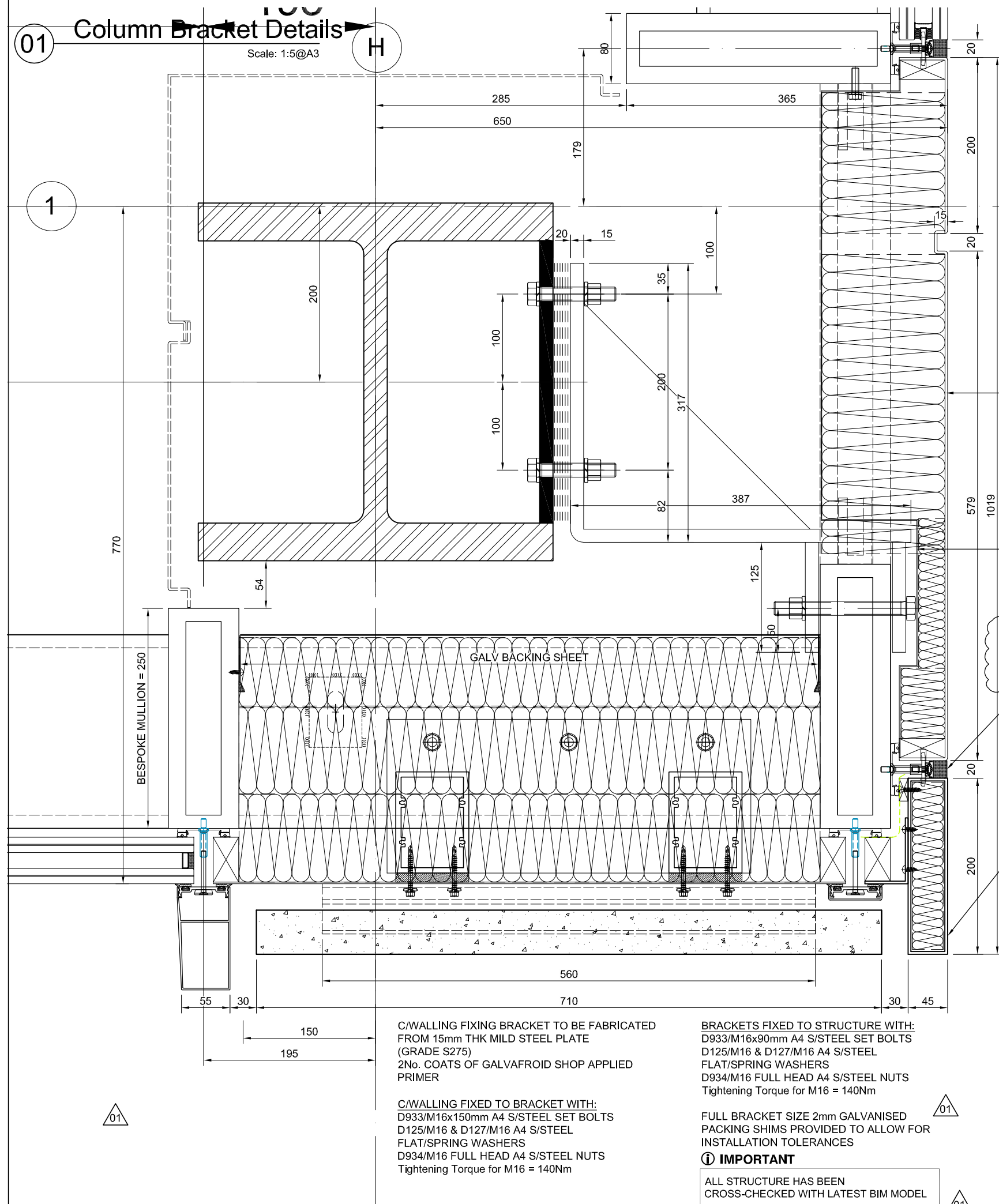

INSULATED P.P.C ALUM PANEL:
External: 3mm P.P.C ALUM SKIN ~ SILVER ANODISED EV1 ~ 25 microns
Core: ROCKWOOL RWA45 INSULATION
Internal: 0.9mm GALVANISED LINER TRAY

PANEL DESIGNED WITH 6x100mm SLOTS SPACED AROUND THE GLAZING EDGE FOR GLAZING INTO THE C/WALLING WITH THE USE OF SCHUCO CLIPS

0.9mm GALVANIZED STEEL BACKING SHEET FIXED AROUND SYSTEM WITH D7981/4.2x13mm SCREWS @ 50mm FROM EACH CORNER & APPROX 250mm CTS.

DESIGN NOTE:
COLUMN JOINTS ALIGN WITH SOFFIT JOINTS

20mm SEALANT JOINT (AS PER S2 DESIGN - SYSTEM JOINT)

200x45x3mm RHS ALUM. BOX. FIXED WITH ALUM. ANGLE
Colour: YN205E 60microns ~ CLASS 2 D2525 (RAL 9005)
GLAZED INTO SYSTEM WITH SOLID PVC EDGE PACKER.
SLOTS CUT IN VERTICAL SIDE TO ALLOW THE SECTION TO BE TOGGLED WITH SCHUCO CLIPS.
SECTION FILLED WITH ROCKWOOL RWA45 INSULATION

0.7mm EPDM GLAZED INTO SYSTEM BETWEEN MULLIONS. MIN 150mm OVERLAPS FULLY BONDED WITH CORTEX 0775 CONTACT ADHESIVE.

C/WALLING FIXING BRACKET TO BE FABRICATED FROM 15mm THK MILD STEEL PLATE (GRADE S275)
2No. COATS OF GALVAFROID SHOP APPLIED PRIMER

C/WALLING FIXED TO BRACKET WITH:
D933/M16x150mm A4 S/STEEL SET BOLTS
D125/M16 & D127/M16 A4 S/STEEL FLAT/SPRING WASHERS
D934/M16 FULL HEAD A4 S/STEEL NUTS
Tightening Torque for M16 = 140Nm

BRACKETS FIXED TO STRUCTURE WITH:
D933/M16x90mm A4 S/STEEL SET BOLTS
D125/M16 & D127/M16 A4 S/STEEL FLAT/SPRING WASHERS
D934/M16 FULL HEAD A4 S/STEEL NUTS
Tightening Torque for M16 = 140Nm

FULL BRACKET SIZE 2mm GALVANISED PACKING SHIMS PROVIDED TO ALLOW FOR INSTALLATION TOLERANCES

IMPORTANT
ALL STRUCTURE HAS BEEN CROSS-CHECKED WITH LATEST BIM MODEL

COLUMN PLATE OUT

THE DWG INDICATES THE REQUIREMENT TO PLATE OUT THE COLUMN TO ACCOMMODATE THE CORNER UN ITS FIXING BRACKETS
MFL PROPOSE 15mm THK STEEL PLATE 250mm DEEP WELDED ACROSS WEB OF COLUMN AS SHOWN.

ALL COLUMNS & PLATE OUT'S TO BE PRE-DRILLED TO SUIT MFL BRACKETS REQUIREMENTS

CDM Regulations

Hazards	Date Added	Date Mitigated	Risk Assessment Date
HEAVY GLASS ~ LOADS INDICATED	05/02/15		

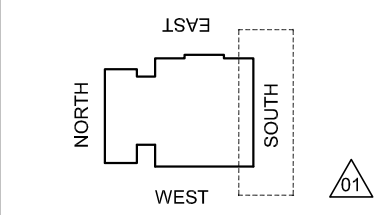
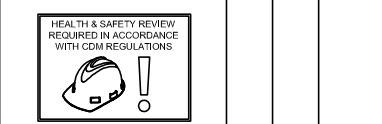

KEY PLAN

DESIGN NOTES: Technical Report list

DOCUMENT TITLE	Doc Number	CONJECT Number
Facade Design & Glass Risk Assessment	3135-TR003	KXC-S1-001-Y-21-TR003
Glass Technical report	3135-TR004	KXC-S1-001-Y-21-TR004
Technical data fr HBI fire stop details	3135-TR005	KXC-S1-001-Y-21-TR005
Material data sheet report	3135-TR006	KXC-S1-001-Y-21-TR006
Door schedule & Operation information	3135-TR007	KXC-S1-001-Y-21-TR007
Facade Airborne Acoustic report	3135-TR008	KXC-S1-001-Y-21-TR008
Facade Vertical & Horizontal Acoustic report	3135-TR009	KXC-S1-001-Y-21-TR009
Accommodation of structural movement	3135-TR012	KXC-S1-001-Y-21-TR012
Hatten channel & Slab edge design	3135-TR013	KXC-S1-001-Y-21-TR013
Thermal Safety Check on Glass	3135-TR022	KXC-S1-001-Y-21-TR022

DO NOT SCALE : IF IN DOUBT ASK!

© THIS DRAWING REMAINS THE PROPERTY OF McMULLEN FACADES LTD AND SHOULD NOT BE COPIED NOR ITS CONTENTS DIVULGED WITHOUT PRIOR CONSENT

Signed: S.Patterson Internal Quality Check
Date: 04-05-2018

THERMAL REPORT FOR GROUND FLOOR SOUTH ISSUED 25/01/2019 (KXC-S1-001-Y-3135-904-TR203)

002	CC	CC	26-02-19	DESIGN NOTE ADDED	26-02-19
001	DR	GB	07-12-18	ISSUE FOR CONSTRUCTION	07-12-18
000	SP	SP	04-05-18	FIRST ISSUE	04-05-18

No.	Intd	Date

Revision	Check	Description	Date

Contract: KINGSCROSS S1

Architect: MOSSISSIAN

Main Contractor: BAM

Drawing: SOUTH ELEVATION GND - 2ND FLOOR

GENERAL SYSTEM DETAILS

Drawn By: SPatterson Date: 04-05-2018

Scale: 1:5 @ A3 MFL No.: 3135-621

DMS Code: KXC-S1-001-Y-3135-21-621 Revision: 002

DRAWING ISSUED FOR: STATUS OF PREVIOUS RETURN

CONSTRUCTION A (B) C -

McMullen Facades Limited
66 Lurgan Road, Moira,
Craigavon, Co. Armagh BT67 0LX
Tel: +44 (0) 28 9261 9688
Fax: +44 (0) 28 9261 9711
Email: design@mcmullenfacades.com