

KEY PLAN

MAIN STEEL STRUCTURE & UPSTAND POSITION VERIFIED VIA BIM MODEL (17/12/18)

THERMAL REPORT FOR GROUND FLOOR NORTH ISSUED 11/01/2019 (KXC-S1-001-Y-3135-904-TR202)

DO NOT SCALE : IF IN DOUBT ASK!

THIS DRAWING REMAINS THE PROPERTY OF McMULLEN FACADES LTD AND SHOULD NOT BE COPIED NOR ITS CONTENTS DIVULGED WITHOUT PRIOR CONSENT

Signed: G. Benson
Date: 17/12/18
Internal Quality Check

002	CC	CC	18-01-19	PVC ANNOTATED	18-01-19
001	CC	CC	11-12-18	UPDATED FOR SCR-05 & COMMENTS	11-12-18
000	MJ	MJ	20-06-18	FIRST ISSUE	20-06-18

No.	Intd	Date

Revision	Check	Description	Date

Contract: KINGS CROSS S1

Architect: MOSSISSIAN

Main Contractor: BAM

Drawing: NORTH ELEVATION GND
ELEVATIONS, SECTIONS, PLANS & DETAILS

Drawn By: M.Jess Date: 20/06/2018

Scale: 1:5 @ A3 MFL No.: 3135-650

DMS Code: KXC-S1-001-Y-3135-21-650 Revision: 002

DRAWING ISSUED FOR: STATUS OF PREVIOUS RETURN

CONSTRUCTION A (B) C -

McMullen Facades Limited
66 Lurgan Road, Moira,
Craigavon, Co. Armagh BT67 0LX
Tel: +44 (0) 28 9261 9688
Fax: +44 (0) 28 9261 9711
Email: design@mcullenfacades.com

INTERNAL CLADDING
PPC RAL 9006

EXTERNAL CLADDING
SILVER ANODISED

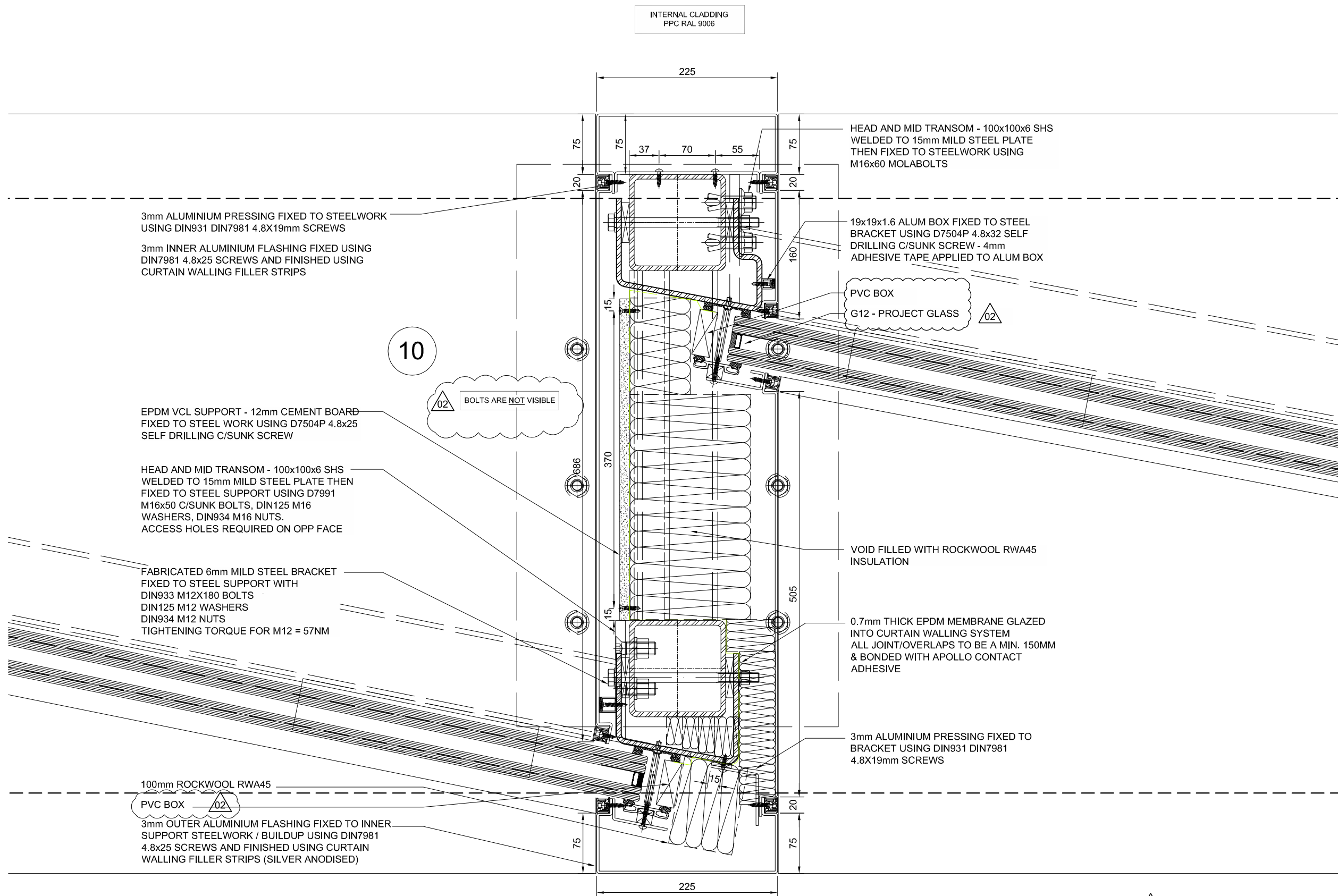

3mm ALUMINIUM PRESSING FIXED TO STEELWORK USING DIN931 DIN7981 4.8X19mm SCREWS
3mm INNER ALUMINIUM FLASHING FIXED USING DIN7981 4.8x25 SCREWS AND FINISHED USING CURTAIN WALLING FILLER STRIPS

EPDM VCL SUPPORT - 12mm CEMENT BOARD FIXED TO STEEL WORK USING D7504P 4.8x25 SELF DRILLING C/SUNK SCREW

HEAD AND MID TRANSOM - 100x100x6 SHS WELDED TO 15mm MILD STEEL PLATE THEN FIXED TO STEEL SUPPORT USING D7991 M16x50 C/SUNK BOLTS, DIN125 M16 WASHERS, DIN934 M16 NUTS. ACCESS HOLES REQUIRED ON OPP FACE

FABRICATED 6mm MILD STEEL BRACKET FIXED TO STEEL SUPPORT WITH DIN933 M12X180 BOLTS DIN125 M12 WASHERS DIN934 M12 NUTS TIGHTENING TORQUE FOR M12 = 57NM

100mm ROCKWOOL RWA45
PVC BOX
3mm OUTER ALUMINIUM FLASHING FIXED TO INNER SUPPORT STEELWORK / BUILDUP USING DIN7981 4.8x25 SCREWS AND FINISHED USING CURTAIN WALLING FILLER STRIPS (SILVER ANODISED)

HEAD AND MID TRANSOM - 100x100x6 SHS WELDED TO 15mm MILD STEEL PLATE THEN FIXED TO STEELWORK USING M16x60 MOLABOLTS

19x19x1.6 ALUM BOX FIXED TO STEEL BRACKET USING D7504P 4.8x32 SELF DRILLING C/SUNK SCREW - 4mm ADHESIVE TAPE APPLIED TO ALUM BOX

PVC BOX
G12 - PROJECT GLASS

VOID FILLED WITH ROCKWOOL RWA45 INSULATION

0.7mm THICK EPDM MEMBRANE GLAZED INTO CURTAIN WALLING SYSTEM ALL JOINT/OVERLAPS TO BE A MIN. 150MM & BONDED WITH APOLLO CONTACT ADHESIVE

3mm ALUMINIUM PRESSING FIXED TO BRACKET USING DIN931 DIN7981 4.8X19mm SCREWS

01

TYPICAL INTERFACE DETAIL - NORTH ELEVATION

Scale: 1:5@A3