

02

Lift/Slide Door Head Detail

Scale: 1:5@A3

UNITISED TYPE 1 FRAMING PANEL.

SYSTEM JOINT EPDM GLAZED INTO UNITISED SECTION WITH GASKET 931028, TO BE LEFT LONG TO ALLOW IT TO BE GLAZED & FULLY SEALED INTO C/WALLING SYSTEM.

HUECK VOLATO M LIFT & SLIDE DOOR SYSTEM

DOOR HARDWARE:

- 1No. LIFT /SLIDE FITTING KIT 996537 00.0001
- 2No. S/S HANDLES 917508 00.0001
- 2No. BUFFER STOP (SILVER) 996281 02.0001
- 1No. PROFILE CYLINDER 35 918287 00.0001
- 4No. LOCKING BOLT 917496 00.0001

FRAME COLOUR:

EXTERNAL: EV1 SILVER ANODISED 25microns
 INTERNAL: Ral 9003 INTERPON D1036 SA803G 60MICRONS.

DOOR REF: L7-D21

SLIDING DOOR FRAME GLAZED INTO PERIMETER CURTAIN WALLING FRAME.
ALL DOOR FRAME EDGE ADAPTORS FACTORY FITTED.

System Joint +56.680

TRAN' CTR' +56.641

001

FIXINGS
 D933 M12x50 BOLT.
 D934 M12 NUT.
 D125 M12 WASHER.
 D127 M12 SPRING WASHER.

MIDSPAN TRANSOM BRACKET ABOVE SLIDING DOOR.
 3No BRACKETS PER' TRANSOM SPACED AT 1500mm CTRS'
 BRACKETS FINISHED RAL 9003 INTERPON D1036 SA803G 60mic'.
 BRACKET FABRICATED FROM MILD STEEL (GRADE S275)

SECTION A-A (NTS)

PLAN VIEW - CROSS SECTION THRO' BRACKET FOR INFORMATION.
 BRACKET AT 1500mm CTRS' ACROSS TRANSOM ABOVE SLIDING DOOR.

OUTLINE OF SLIDING DOOR STRUCTURAL MULLION.

SLIDING DOOR REVEAL C/WALLING MULLIONS FIXED WITH DOMEHEAD S/STEEL STARLOCKS WHEN VISIBLE.

0.7mm EPDM MEMBRANE FIXED & SEALED TO THE U/S OF DOOR FRAME BETWEEN 25x19x3mm ALUM' ANGLE & CILL FLASHING. EPDM DRESSED DOWN & BONDED TO FACE OF UPSTAND MEMBRANE.

3mm ALUM' FLASHING - EV1 SILVER ANODISED 25mic'. FLASHING INSULATED WITH SEMI RIGID ROCKWOOL INSULATION.

EXT FFL. +53.550

001

DOOR FRAME SUPPORT BRACKET FABRICATED FROM CONT' MILD STEEL PFC 180x75x20 (GRADE S275)
 LOCAL 8mm & 10mm MILD STEEL BASE PLATES (GRADE S275)
 ALL STEEL ITEMS GALVANISED
 SLIDING DOOR BASE RAIL FIXED TO TOP OF PFC WITH A CONT' 8mm ALUM' FLAT PLATE.
 8mm ALUM' PLATE FIXED TO U/S OF FRAME WITH D7982 5.5x25mm C/S SCREWS & FIXED TO PFC WITH D7981 5.5x25mm PAN HEAD SCREWS. FIXING CTRS' 3No AT 100mm AT MULLION CTRS THEN AT A MAX' OF 250mm CTRS'

PFC PLATFORM BRACKETS FIXED INTO HALFEN HTA-CE 50/30 450mm LONG CAST-IN CHANNELS WITH 3No HS50/30 FV8.8 M16x60 T HEAD BOLTS - TIGHTENING TORQUE 185Nm.
 FULL WD GALVANISED PACKER SHIMS TO BE USED WERE REQUIRED

LEVEL 07 FFL +53.550

OUTLINE OF RC UPSTAND TO EITHER SIDE OF SLIDING DOOR.

INTERNAL FLOOR FINISHES BY MAIN CONTRACTOR REFER TO ARCHITECTS DETAILS FOR FURTHER INFORMATION.

SSL +53.400

RC TOLERANCE +/-15mm FROM DESIGN LINE & LEVELS.

SSL +53.270

01

Lift/Slide Door Cill Detail

Scale: 1:5@A3

BUILDING WORKS BY MAIN CONTRACTOR WATER PROOFING MEMBRANE, INSULATION TO TOP OF RC SLAB.
 M.C TO LEAVE MEMBRANE LONG ENOUGH TO BE OVERLAPPED & BONDED WITH THE SYSTEMS EPDM (MIN' 150mm OVERLAP).

CDM Regulations

Hazards	Date Added	Date Mitigated	Risk Assessment Date
HEAVY GLASS - LOADS INDICATED	05/02/15		

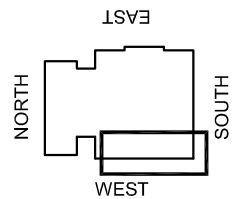

KEY PLAN

DO NOT SCALE : IF IN DOUBT ASK!

THIS DRAWING REMAINS THE PROPERTY OF McMULLEN FACADES LTD AND SHOULD NOT BE COPIED NOR ITS CONTENTS DIVULGED WITHOUT PRIOR CONSENT

Signed:	GB-JW	Internal Quality Check
Date:	22.02.19	

001	JW	GB	22.02.19	SECOND ISSUE - REVISIONS CLOUDED ISSUED FOR CONSTRUCTION.	22.02.19
000	SP	SP	28-05-18	FIRST ISSUE	28-05-18

No.	Intd	Date	Description	Date

Contract: KINGSCROSS S1

Architect: MOSSISSIAN

Main Contractor: BAM

Drawing: LVL 07 WEST ELEV. TERRACE BAY STUDY TYPICAL DETAILS

Drawn By: SP-JW Date: 17-06-2018

Scale: 1:5 @ A3 MFL No.: 3135-769

DMS Code: KXC-S1-001-Y-3135-21-769 Revision: 001

DRAWING ISSUED FOR: STATUS OF PREVIOUS RETURN

CONSTRUCTION A B C (-)

McMullen Facades Limited
 66 Lurgan Road, Moira,
 Craigavon, Co. Armagh BT67 0LX
 Tel: +44 (0) 28 9261 9688
 Fax: +44 (0) 28 9261 9711
 Email: design@mcmullenfacades.com