

01 Terrace Corner
Scale: 1:5@A3

B

HALFEN HTA-CE 50/30
CAST-IN CHANNELS
HS50/30 FV8.8 M16x60 T HEAD
BOLTS.
TIGHTENING TORQUE 185 Nm.

UNITISED FIXING BRACKET TO
BE FABRICATED FROM 10mm
THK MILD STEEL PLATE WITH
WELDED ON SERRATED
WASHERS - STEEL GRADE
S275 - BRACKETS TO BE
GALV'.

BRACKETS ISOLATED FROM
CONCRETE WITH 0.7mm EPDM.

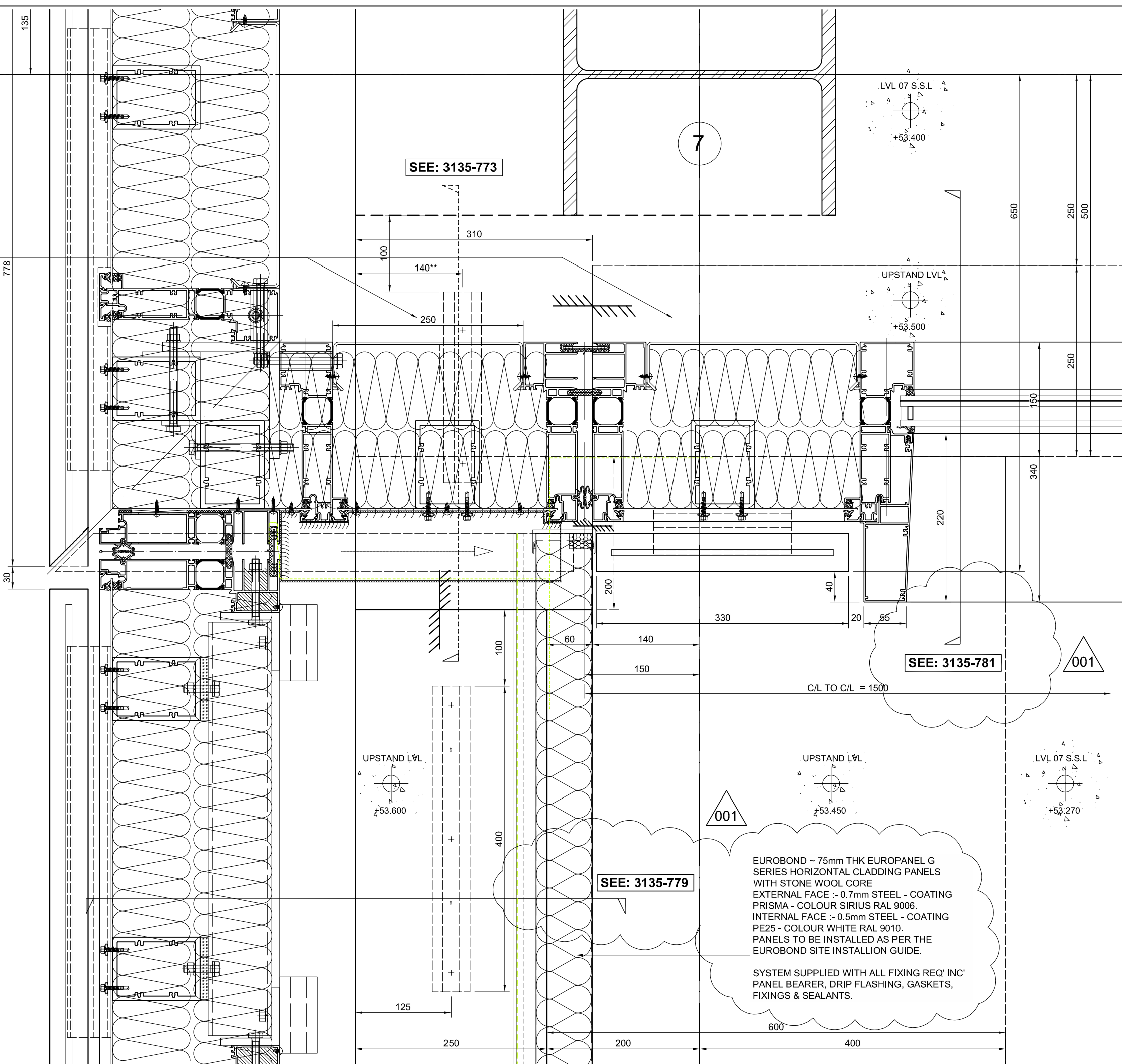

CDM Regulations

Hazards	Date Added	Date Mitigated	Risk Assessment Date
HEAVY GLASS - LOADS INDICATED	05/02/15		

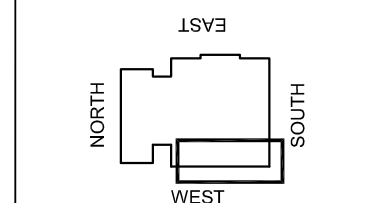

KEY PLAN

DO NOT SCALE : IF IN DOUBT ASK!

THIS DRAWING REMAINS THE PROPERTY OF McMULLEN FACADES LTD AND SHOULD NOT BE COPIED NOR ITS CONTENTS DIVULGED WITHOUT PRIOR CONSENT

Signed:	GB-JW	Internal Quality Check
Date:	22.02.19	

No.	Intd	Date	Description	Date	
001	JW	GB	22.02.19	SECOND ISSUE - REVISIONS CLOUDED ISSUE FOR CONSTRUCTION.	22.02.19
000	SP	28-05-18	FIRST ISSUE	28-05-18	

Revision	Check	Description	Date

Contract: KINGSCROSS S1

Architect: MOSSISSIAN

Main Contractor: BAM

Drawing: LVL 07 WEST ELEV. TERRACE BAY STUDY TYPICAL DETAILS

Drawn By: SP-JW Date: 17-06-2018

Scale: 1:5 @ A3 MFL No.: 3135-772

DMS Code: KXC-S1-001-Y-3135-21-772 Revision: 001

DRAWING ISSUED FOR: STATUS OF PREVIOUS RETURN

CONSTRUCTION A B C (-)

McMullen Facades Limited
66 Lurgan Road, Moira,
Craigavon, Co. Armagh BT67 0LX
Tel: +44 (0) 28 9261 9688
Fax: +44 (0) 28 9261 9711
Email: design@mcmullenfacades.com