

01

Unitised Glazed Cill Section

Scale: 1:5@A3

B

GLAZING SPECIFICATION - TYPE G2

TYPE 1 THERMALLY BROKEN UNITISED FRAME
 DUAL COLOUR SECTIONS:
 INTERNAL: SL804G 60microns (RAL 7004 HR)
 CLASS 1 D1036
 EXTERNAL: YN205E 60microns ~ CLASS 2 D2525
 FACE CAPS: Silver Anodised ~ 25 microns

001

CORTEX / EPDM INSTALLATION NOTE:
 ALL JOINT/OVERLAPS TO BE A MIN' 150mm & BONDED
 WITH CORTEX 0775 CONTACT ADHESIVE TO
 MANUFACTURES RECOMMENDATIONS

0.75mm CORTEX 0750 MEMBRANE GLAZED INTO
 SYSTEM WITH GASKET 931111 DRESSED & BONDED
 OVER UPSTAND MEMBRANE

3mm ALUM' FLASHING - EV1 SILVER ANODISED 25mic'.
 FLASHING INSULATED WITH SEMI RIGID ROCKWOOL
 INSULATION.

EXT FFL +53.550

340 690 350

HALFEN CAST-IN CHANNEL
 50 / 30 GV M16x60 HTA, T HEAD BOLTS
 TIGHTENING TORQUE 60 Nm.

UNITISED FIXING BRACKET TO BE FABRICATED
 FROM 10mm THK MILD STEEL PLATE, DESIGNED
 WITH USE OF WELDED ON SERRATED WASHERS
 HW-01 TO ALLOW FOR HILTI CHANNEL
 TOLERANCE
 STEEL GRADE S275 ~ GALVANIZED TO BS EN ISO
 1461

BRACKETS ISOLATED FROM CONCRETE WITH
 0.7mm EPDM.

INTERNAL FINISHES
 BY MAIN CONTRACTOR
 REFER TO ARCHITECTS DETAILS
 FOR FURTHER INFORMATION.

LEVEL 07 FFL
 +53.550

UPSTAND LVL
 +53.500
 SSL +53.400

SSL +53.270

RC TOLERANCE +/-15mm
 FROM DESIGN LINE &
 LEVELS.

500 TO FACE OF UPSTAND

BUILDING WORKS BY MAIN CONTRACTOR
WATER PROOFING MEMBRANE, INSULATION
TO TOP OF RC SLAB.

M.C TO LEAVE MEMBRANE LONG ENOUGH
TO BE OVERLAPPED & BONDED WITH THE
SYSTEMS EPDM (min 150mm OVERLAP).

JRL
McMULLEN

CDM Regulations

Hazards	Date Assessed	Date Reviewed	Risk Assessment Date
HEAVY GLASS - LOADS INDICATED	05/02/15		
HEALTH & SAFETY REVIEW REQUIRED IN ACCORDANCE WITH CDM REGULATIONS			

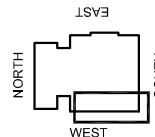

KEY PLAN

DO NOT SCALE ; IF IN DOUBT ASK!

THIS DRAWING REMAINS THE PROPERTY
 OF McMULLEN FACADES LTD AND SHOULD
 NOT BE COPIED NOR ITS CONTENTS
 DIVULGED WITHOUT PRIOR CONSENT

Signed: GB-JW
 Date: 01-04-2019
**Internal
 Quality Check**

001 JW GB 01-04-19 SECOND ISSUE - REVISIONS
 CLOUDED
 ISSUE FOR CONSTRUCTION

001 SP SP 28-05-18 FIRST ISSUE
 No. Intro Date

Revision: Check Description Date

Contract: KINGSCROSS S1

Architect: MOSSESSIAN

Main Contractor: BAM

Drawing: LVL 07 WEST ELEV. TERRACE
 BAY STUDY TYPICAL DETAILS

Drawn By: SP-JW Date: 17-06-2018

Scale: 1:5 @ A3 MFL No.: 3135-781

DMS Code: KXC-S1-001-Y-3135-21-781 Revision: 001

DRAWING ISSUED FOR: STATUS OF
 PREVIOUS RETURN

CONSTRUCTION (A) B C -

McMullen Facades Limited
 66 Lurgan Road, Moira,
 Craigavon, Co. Armagh BT67 0LX
 Tel: +44 (0) 28 9261 9688
 Fax: +44 (0) 28 9261 9711
 Email: design@mcmmullenfacades.com