

01 Existing Ground Floor Layout  
1:50 @ A1

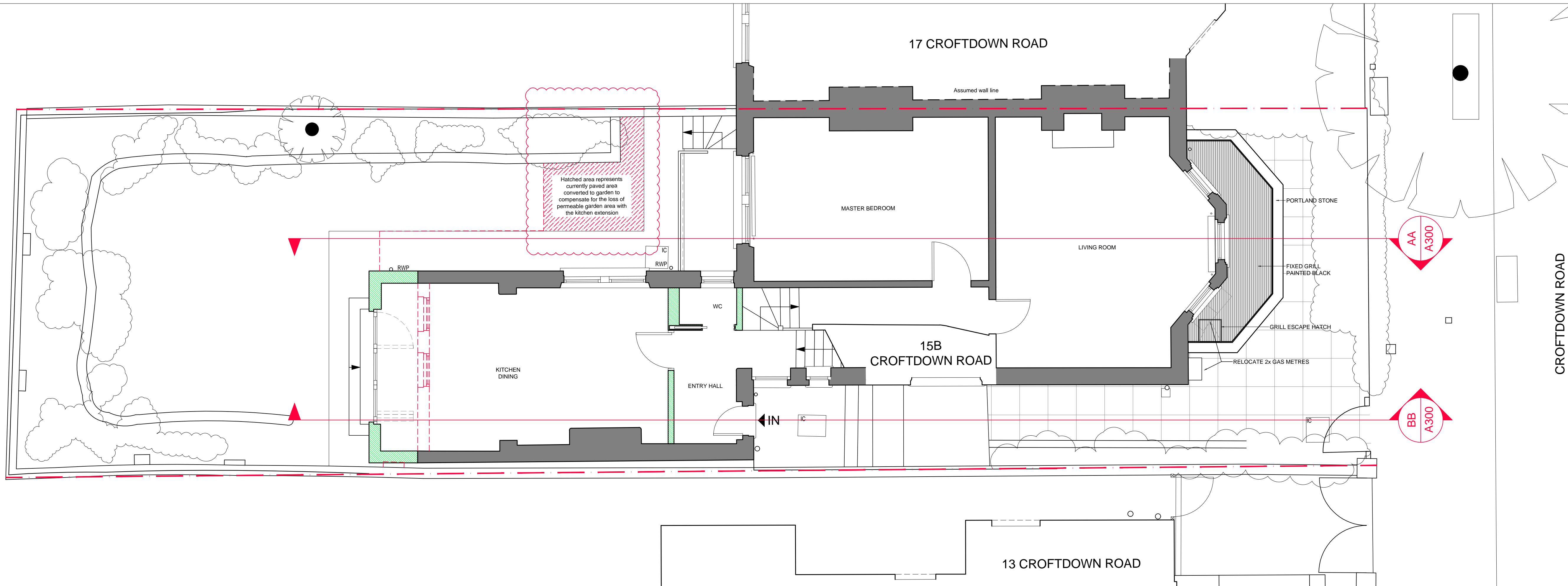

02 Proposed Ground Floor Layout  
1:50 @ A1

GENERAL NOTES:

All Dimensions and conditions to be checked and confirmed on site by the contractor. The contractor should inform the architect of any discrepancies before proceeding with the work.

All elements of work and materials are to comply with Building Regulations and British Standards, good industry practice and the recommendations of material and component manufacturers.

All products are to be suitable for their purpose. The contractor is to install all products where noted in accordance with manufacturers' recommendations/specifications and inform the architect of any discrepancies or changes in the specification before proceeding with the work.

This drawing is to be read in conjunction with all other relevant documentation including that produced by other consultants, subcontractor and suppliers.

Refer to Structural Engineer's drawings and specifications for all information on structural frame/elements

© All rights reserved. All drawings and written material appearing herein constitute original and unpublished work of the Architect and may not be duplicated, used or disclosed without written consent of the Architect.

SPECIFIC NOTES:

NEW CONSTRUCTION

EXISTING TO BE DEMOLISHED

KEY PLAN:

Status:

PLANNING

P03	Permeable area to garden	20.02.2020
P02	Issued for Planning	02.02.2019
P01	Issued for Pre-Planning	08.10.2018
Rev.	Comment	Date

KIMA  
15 Bury Walk  
London, SW3 6QD  
info@kima-uk.com  
+44(0)2074870761

Client:

Project:

15 CROFTDOWN ROAD

Title:

EXISTING & PROPOSED  
GROUND FLOOR PLAN

Job No.:	Drawn by.:	Checked by.:
1808	CR	CR
Date.:	Scale.:	
20.02.2020	1:50 @ A1	
Drawing No.:	Revision.:	
A101	P03	