

[01] APPROVED SECOND FLOOR PLAN : 2019/1010/P @1:100

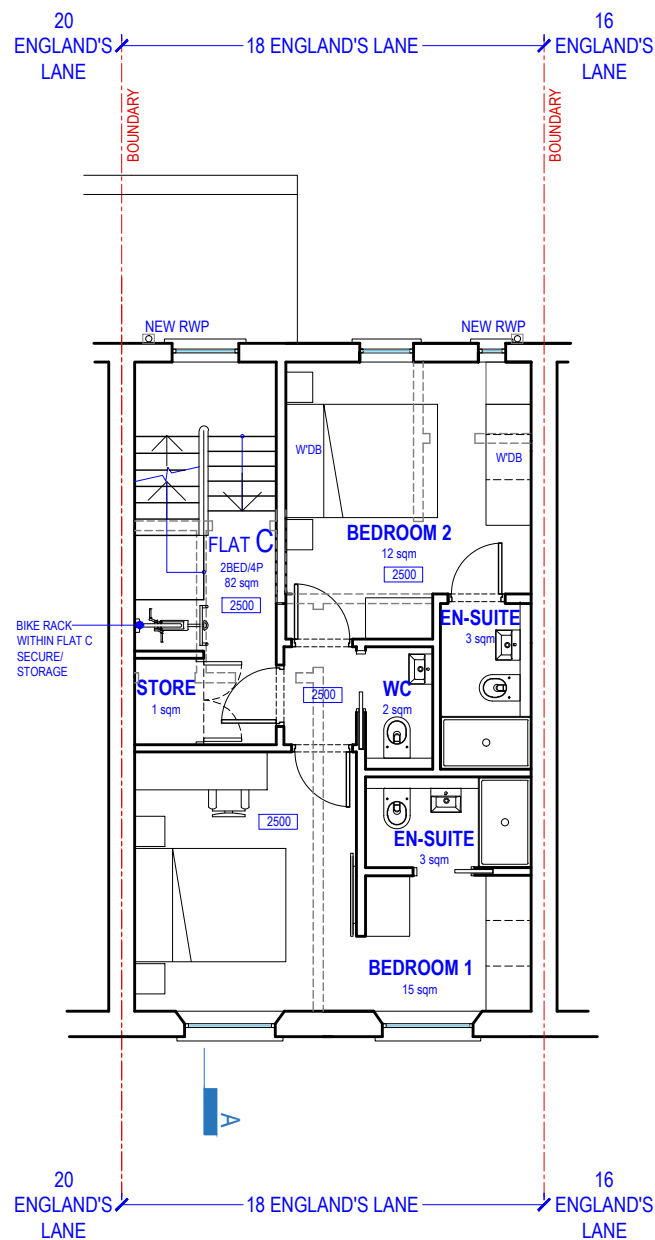

[02] APPROVED THIRD FLOOR PLAN : 2019/1010/P @1:100

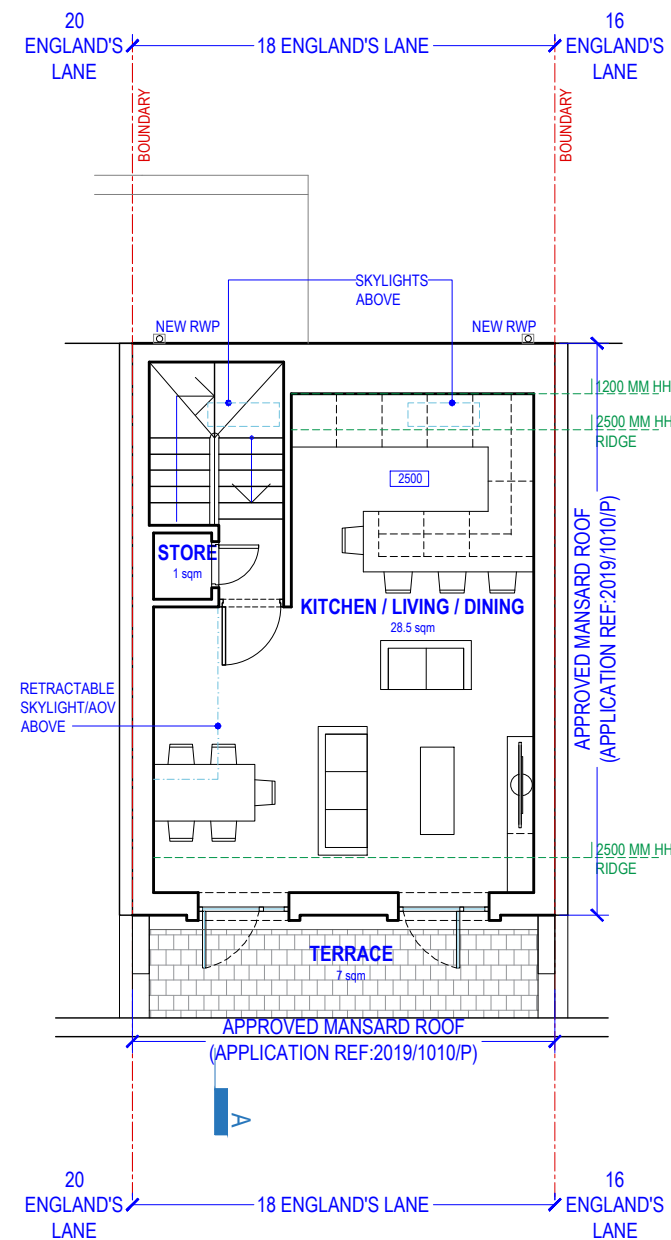

[03] APPROVED FOURTH FLOOR PLAN : 2019/1010/P @1:100

NOTE:
DO NOT SCALE FROM DRAWINGS - EXCEPT FOR PLANNING PURPOSES.
ALL DISCREPANCIES TO BE REPORTED TO ARCHITECT IMMEDIATELY.
ALL DIMENSIONS TO BE VERIFIED BY CONTRACTOR ON SITE PRIOR TO THE COMMENCEMENT OF ANY WORKS.

P1 14/02/20 Issue For Planning



VIVENDI ARCHITECTS LTD
Unit E3U, Bounds Green Industrial Estate, Ringway, London N11 2UD
Tel/Fax +44 (0)20 3232 4000 - email: info@vivendiarchitects.com
© VIVENDI ARCHITECTS LTD 2009
All rights reserved, including but not limited to The Copyright, Designs and Patents Act 1988

ISO-A3

PROJECT TITLE:
18 ENGLAND'S LANE, LONDON NW3 4TG

DRAWING TITLE:
Approved Second, Third & Fourth Floor Plans : 2019/1010/P

CLIENT:
LXE INVESTMENTS LTD.

DRAWN:
AP

CHECKED:
GK

ISSUED BY:
GK

STATUS:
PLA

SCALE AT A3:
1:100

REVISION:
P1

JOB AND DRAWING NO:
1772-AP02-00