

Disclaimer:
 This drawing should not be scaled.
 The contractor is to check all dimensions on site and inform the contract administrator/project manager of any discrepancies.
 All work is to comply in every aspect with the Building Regulations, Codes of Practice and British Standards.
 This drawing is to be read in conjunction with all other contract drawings and specifications.
 This drawing is copyrighted and must not be reproduced in any format or disclosed to any third party without the written consent of Tuffin Fenaby Taylor LLP.

rev	date	details	by
1	09.01.19	Female W.C's omitted, Cleaners Store relocated.	bd
2	13.09.19	Existing Electrical cupboard retained.	CG
3	23.01.20	Drawings updated	bd
		Heating added.	bd

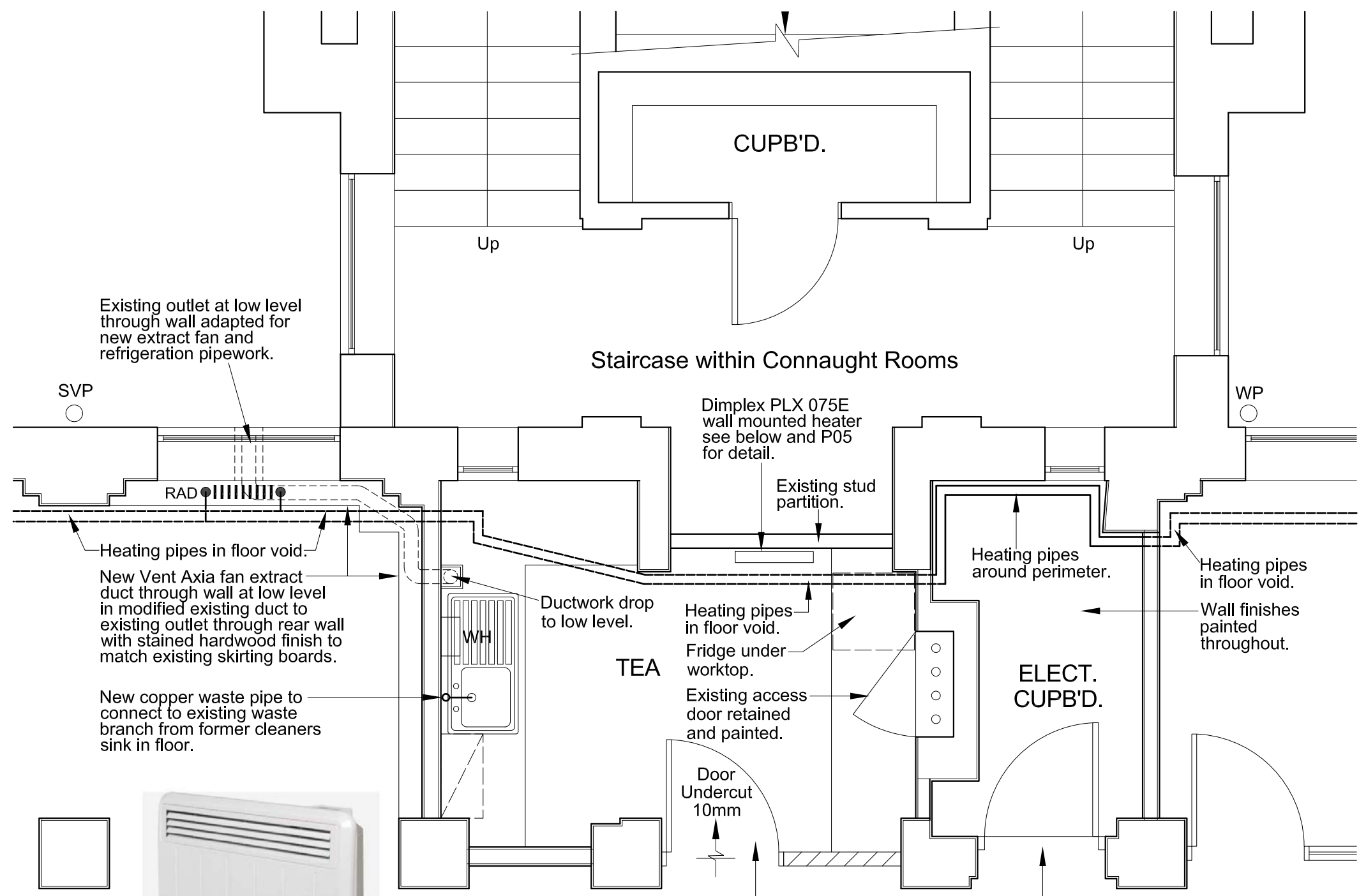

Existing outlet at low level through wall adapted for new extract fan and refrigeration pipework.

SVP

RAD

Heating pipes in floor void.

New Vent Axia fan extract duct through wall at low level in modified existing duct to existing outlet through rear wall with stained hardwood finish to match existing skirting boards.

New copper waste pipe to connect to existing waste branch from former cleaners sink in floor.

Staircase within Connaught Rooms

Up

Up

Dimplex PLX 075E wall mounted heater see below and P05 for detail.

Existing stud partition.

WP

Heating pipes around perimeter.

Heating pipes in floor void.

Wall finishes painted throughout.

Ductwork drop to low level.

Heating pipes in floor void.

Fridge under worktop.

Existing access door retained and painted.

ELECT. CUPB'D.

Door Undercut 10mm

Re-use salvaged 1/2 glazed hardwood door and frame.

Existing half glazed hardwood timber door and frame retained and French polished.



TEA POINT HEATER

- New wall and base units within Kitchen to be 'Howdens Clerkenwell White'.
- Wall tiles - 150x150mm white wall tiles between worktop and underside of wall units including external wall.
- Floor - Altro Reliance 25 laid over existing cork tiles.
- Refer to detail on drawing 171027-P10