

IMPORTANT NOTE: When installing VELFAC windows and accessories, please ensure compliance with national building regulations and British/European standards where necessary. This drawing is for guidance only and the customer must be satisfied that the principles outlined in this drawing are effectively transposed to suit specific project requirements and site conditions.

All dimensions are in millimetres where shown. Do not scale.

NOTES:

1. External weather seal to be either Tremco-Ilbruck joint sealing tape sized to suit finished joint size or ARBOSIL 1090 silicone seal and polyethelene backing rod.
2. Fixings and lugs to be installed strictly in accordance with VELFAC installation guidance.
3. Fixing grounds must be able to withstand all loads transmitted from and through the VELFAC system.

~~~~~ primary weather line  
 - - - - - primary air barrier line

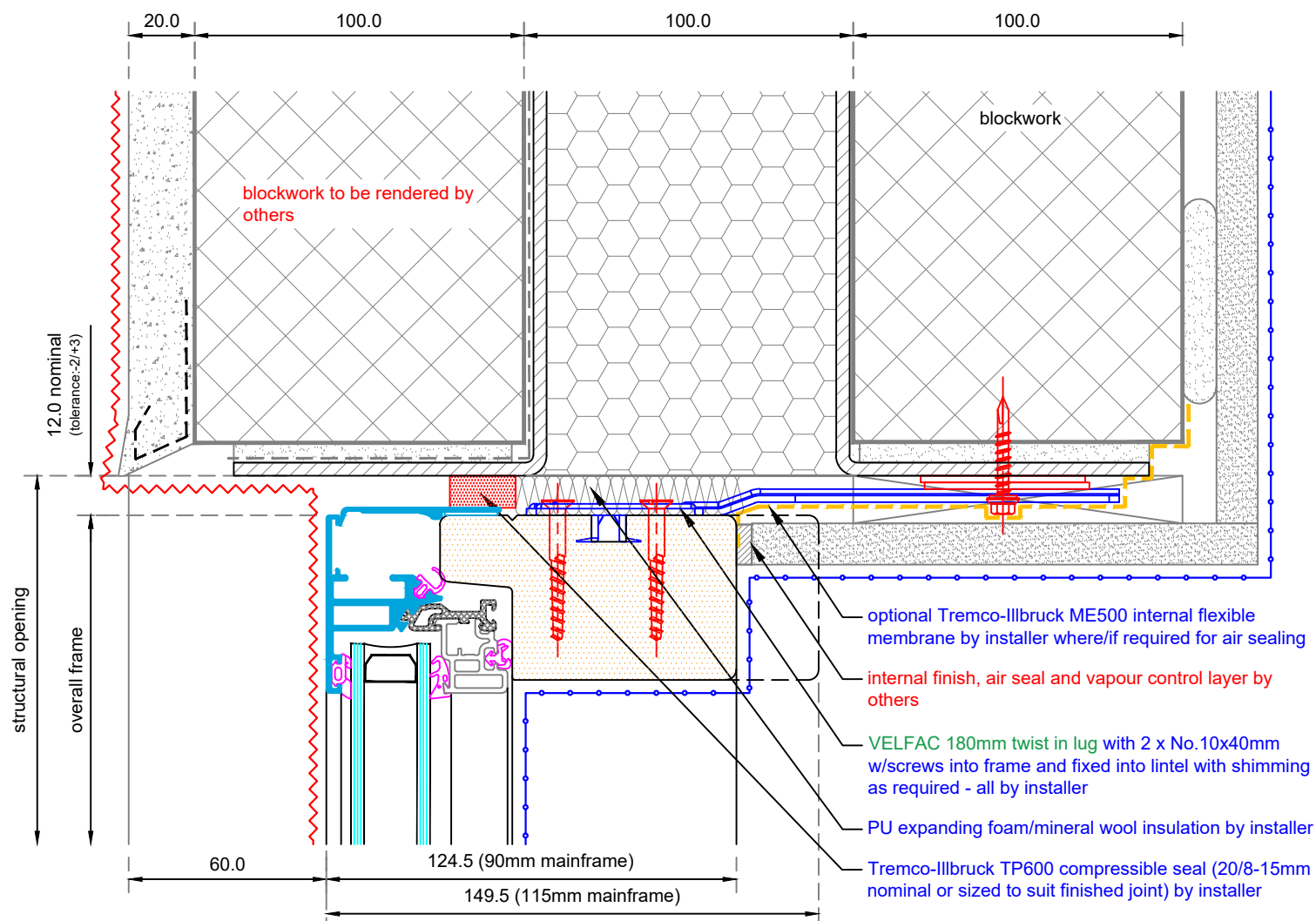

| Rev | Date | By | Description |
|-----|------|----|-------------|
|     |      |    |             |
|     |      |    |             |
|     |      |    |             |
|     |      |    |             |



STANDARD  
INTERFACE  
DRAWING

Title:

VELFAC 200i SYSTEM  
TYPICAL HEAD DETAIL  
rendered block/block masonry

|                         |                     |
|-------------------------|---------------------|
| Scale: 1:2 approx. @ A4 | Drawing no:         |
| Date: January 2017      | V200i.W1.03.A.H.001 |
| Drawn: Studio62         |                     |
| Status: approved        | Revision:           |

© VELFAC Ltd. This drawing must not be copied, reproduced or published in whole or in part for commercial gain without prior written permission of VELFAC