

PROPOSED SITE LAYOUT PLAN

CSID	15120320
VFID	89552_0
CSR	N/A
CELL No.	89552VF

Notes:

- 1.1 All dimensions are in mm unless otherwise specified.
- 1.2 All dimensions to be verified on site.
- 1.3 This drawing is to be read in conjunction with all other relevant drawings.

Rev	Description	Draw	Chkd	Date
G	Structural design changed	PO	PO	28.01.20
F	Cable tray size changed	PO	PO	30.10.19
E	GRP Handrail installed	PO	PO	29.09.19
D	Delta frame installed	PO	PO	06.09.19
C	MAFI 4601 for all sectors	PO	PO	07.05.19

Site Address:

TRAVELODGE COVENT GARDEN EXT  
10 DRURY LANE  
HIGH HOLBORN  
LONDON  
GREATER LONDON 3  
WC2B 5RE

Site Name:

TRAVELODGE COVENT GARDEN EXT

Project No:	209840
Arqiva Ref:	78138-22-HF
Sheet Detail:	SITE LAYOUT PLAN
Dwg no:	200
Scale:	AS SHOWN
Drawn by:	BCL
Date:	28.01.20
Revision:	G
Sheet size:	A3



Comms





design services Ltd.

NOTE:  
BEAMS TO BE PAINTED BLACK &  
YELLOW TO HIGHLIGHT TRIP HAZARD

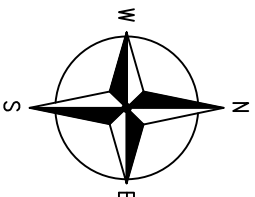

PROPOSED 1No. CTIL (VF) CSC CABINET  
WITH 7U SPACE AVAILABLE TO BE INSTALLED  
ON PROPOSED STEELWORK WITH FRONT  
AND BACK MOUNTING PLATES, FIXING  
POINTS TO BE DRILLED ON SITE

PROPOSED STEELWORK, REF TO  
DRAWING 279 FOR DETAILS TO BE  
INSTALLED ON TO BE INSTALLED ON HIGH  
DENSITY FOUNDATION INSULATION  
BOARDS & RUBBER MATTING. EACH END  
OF THE STEEL TO BE PAINTED BLACK AND  
YELLOW TO HIGHLIGHT TRIP HAZARD

PROPOSED CTIL DISTRIBUTION BOARD  
FIXED TO PROPOSED STEELWORK  
WITH UNISTRUT BARS

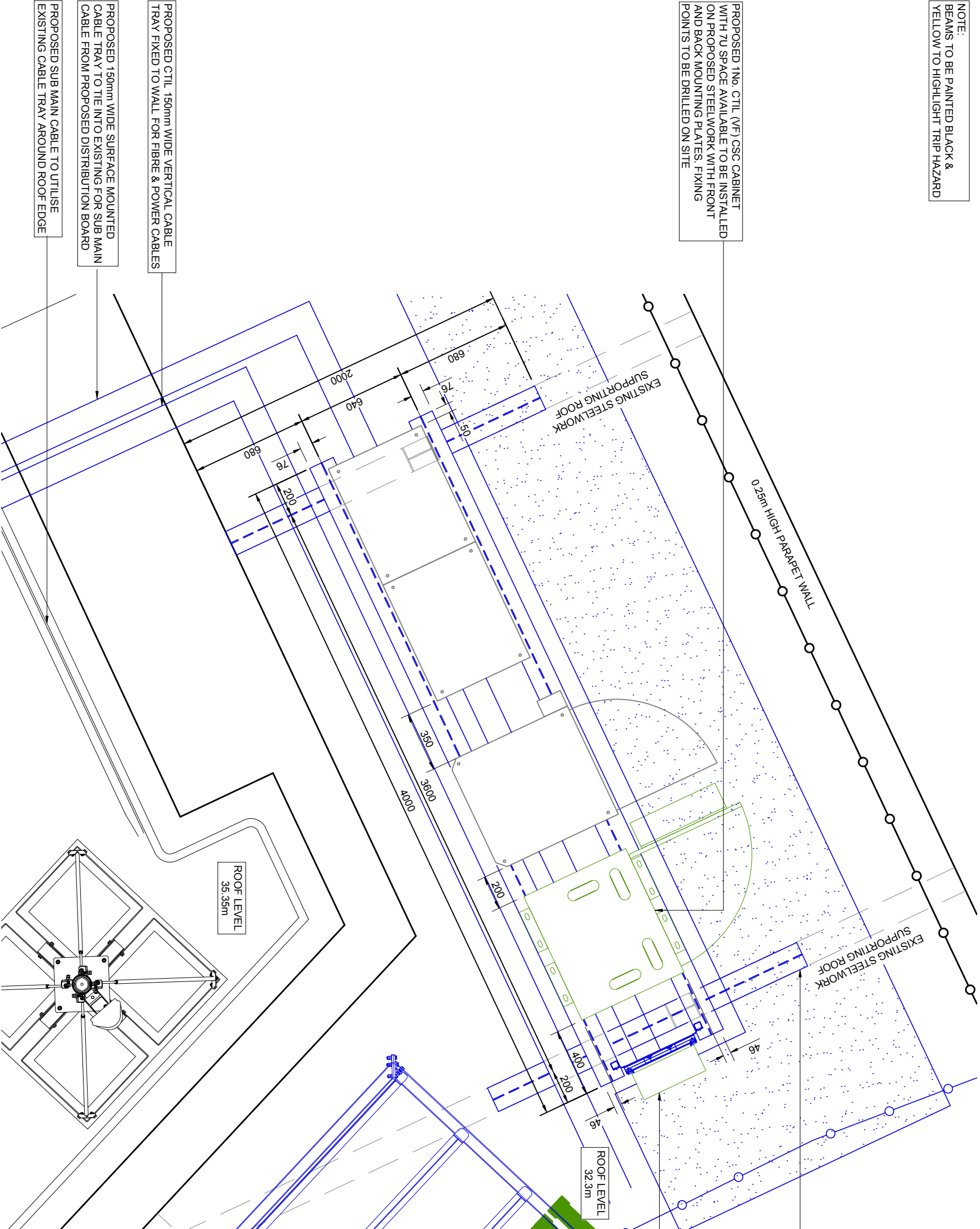

CTIL EQUIPMENT PLAN

SCALE 1:25

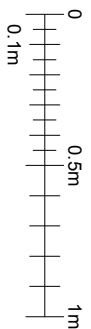

Comms



Notes:

- 1.1 All dimensions are in mm unless otherwise specified.
- 1.2 All dimensions to be verified on site.
- 1.3 This drawing is to be read in conjunction with all other relevant drawings.

Rev	Description	Draw Chkd	Date
A	Issued for approval	AVR	16.08.19
B	Delta frame installed	PO	06.09.19
C	Structural design changed	PO	28.01.20

Site Address:

TRAVELODGE COVENT GARDEN EXT  
10 DRURY LANE  
HIGH HOLBORN  
LONDON  
GREATER LONDON 3  
WC2B 5RE

Site Name:

TRAVELODGE COVENT GARDEN EXT

Project No: 209840

Arqiva Ref: 78138-22-HF

Sheet Detail: EQUIPMENT PLAN

Dwg no:	201	Scale:	AS SHOWN	Revision:	C
Drawn by:	BCL	Date:	28.01.20	Sheet size:	A3

CSID	15120320
VFID	89552_0
CSR	N/A
CELL No.	89552VF

PROPOSED 2No. CTIL (VF) COMMSCOPE RVVPX308.14R3 ANTENNAS AT 41.1m MEAN, BEARING 230° E.T.N. ID No.'s 389912 & 392120 FIXED TO PROPOSED MAFI 4601 WITH 2No. CHS114.3Øx5mm, 4.0m LONG SUPPORT POLES.

PROPOSED CTIL 4No. RRU's ID No.'s 389919, 392123 TO BE FIXED TO ERS RAIL, MOUTED ON MAFI 4601 BEHIND ANTENNAS. PROPOSED 2No. DC BOB'S TO BE INSTALLED ON VERTICAL ANCILLARY MOUNTING POLES SUPPLIED BY MAFI

PROPOSED CTIL (VF) 3No. MULTICORE FIBRE & DC CABLES TO BE INSTALLED

PROPOSED 150mm WIDE SURFACE MOUNTED CABLE TRAY

PROPOSED CTIL 2No. RRU's ID No. 389918 & 1No. DC BOB TO BE FIXED TO BESPOKE TRIPOD VIA FLA SLOPING POLE MOUNT

PROPOSED 1No. CTIL (VF) COMMSCOPE RVVPX308.14R3 ANTENNA AT 32.8m MEAN, BEARING 130° E.T.N. ID No. 392119 FIXED TO PROPOSED BESPOKE TRIPOD WITH 1No. CHS114.3Øx5mm, 4.0m LONG SUPPORT POLE.

PROPOSED CTIL 2No. RRU's ID No. 392122 & 1No. DC BOB TO BE FIXED TO BESPOKE TRIPOD VIA FLA SLOPING POLE MOUNT

PROPOSED 1No. CTIL (VF) COMMSCOPE RVVPX308.14R3 ANTENNA AT 32.8m MEAN, BEARING 130° E.T.N. ID No. 389911 FIXED TO PROPOSED BESPOKE TRIPOD WITH 1No. CHS114.3Øx5mm, 4.0m LONG SUPPORT POLE.

NOTE:  
FOR SECTOR 1 AND 3: MAFI 4601 FRAME REQUIRES 56No. 500mm x 500mm x 50mm CONCRETE BALLAST BLOCKS FOR STABILITY.  
FOR SECTOR 2: THE FREE STANDING FRAMES REQUIRE 24No. 600mm x 600mm x 50mm CONCRETE BALLAST BLOCKS FOR STABILITY

NOTE:  
ACCESS TO ROOFTOP DIFFICULT THROUGH BUILDING AND WILL NOT BE ABLE TO TAKE MATERIALS THROUGH BUILDING. CRANE AND ROAD CLOSURE WILL BE REQUIRED FOR SET UP LOCATION.

PROPOSED 150mm WIDE SURFACE MOUNTED CABLE TRAY

PROPOSED 2No. CTIL (VF) COMMSCOPE RVVPX308.14R3 ANTENNAS AT 35.0m MEAN, BEARING 50° E.T.N. ID No.'s 389910 & 392118 FIXED TO PROPOSED MAFI 4601 WITH 2No. CHS114.3Øx5mm, 4.0m LONG SUPPORT POLES.

PROPOSED CTIL 1No. GPS MODULE AT 36.22m I.D. No. 423752 TO BE FIXED TO MAFI FRAME

PROPOSED CTIL 4No. RRU's ID No.'s 389917, 392121 TO BE FIXED TO ERS RAIL, MOUTED ON MAFI 4601 BEHIND ANTENNAS. PROPOSED 2No. DC BOB'S TO BE INSTALLED ON VERTICAL ANCILLARY MOUNTING POLES SUPPLIED BY MAFI

36.22m

35.0m

32.3m

PROPOSED CTIL DISTRIBUTION BOARD FIXED TO PROPOSED STEELWORK WITH UNISTRUT

PROPOSED 1No. CTIL (VF) CSC CABINET WITH 7U SPACE AVAILABLE TO BE INSTALLED ON PROPOSED STEELWORK

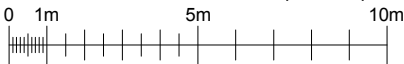

G.L 0.0m

PROPOSED NORTH - EAST ELEVATION  
SCALE 1:200

CSID	15120320
VFID	89552_0
CSR	N/A
CELL No.	89552VF



Notes:

- 1.1 All dimensions are in mm unless otherwise specified.  
1.2 All dimensions to be verified on site.  
1.3 This drawing is to be read in conjunction with all other relevant drawings.

G	Structural design changed	PO	PO	28.01.20
F	Cable tray size changed	PO	PO	30.10.19
E	GRP Handrail installed	PO	PO	29.09.19
D	Delta frame installed	PO	PO	06.09.19
C	Mafi 4601 for all sectors	PO	PO	07.05.19
Rev	Description	Draw	Chkd	Date

Site Address: TRAVELODGE COVENT GARDEN EXT  
10 DRURY LANE  
HIGH HOLBORN  
LONDON  
GREATER LONDON 3  
WC2B 5RE

Site Name: TRAVELODGE COVENT GARDEN EXT  
Project No: 209840  
Arqiva Ref: 78138-22-HF  
Sheet Detail: NORTH EAST ELEVATION

Dwg no:	202	Scale:	AS SHOWN	Revision:	G
Drawn by:	BCL	Date:	28.01.20	Sheet size:	A3



PROPOSED 2No. CTIL (VF) COMMSCOPE RVVPX308.14R3 ANTENNAS AT 41.1m MEAN, BEARING 230° E.T.N. ID No.'s 389912 & 392120 FIXED TO PROPOSED MAFI 4601 WITH 2No. CHS114.3Øx5mm, 4.0m LONG SUPPORT POLES.

PROPOSED CTIL 4No. RRU's ID No.'s 389919, 392123 TO BE FIXED TO ERS RAIL, MOUTED ON MAFI 4601 BEHIND ANTENNAS. PROPOSED 2No. DC BOB'S TO BE INSTALLED ON VERTICAL ANCILLARY MOUNTING POLES SUPPLIED BY MAFI

PROPOSED CTIL (VF) 3No. MULTICORE FIBRE & DC CABLES TO BE INSTALLED

PROPOSED CTIL 2No. RRU's ID No. 389918 & 1No. DC BOB TO BE FIXED TO BESPOKE TRIPOD VIA FLA SLOPING POLE MOUNT

PROPOSED 1No. CTIL (VF) COMMSCOPE RVVPX308.14R3 ANTENNA AT 32.8m MEAN, BEARING 130° E.T.N. ID No. 392119 FIXED TO PROPOSED BESPOKE TRIPOD WITH 1No. CHS114.3Øx5mm, 4.0m LONG SUPPORT POLE.

PROPOSED CTIL 2No. RRU's ID No. 392122 & 1No. DC BOB TO BE FIXED TO BESPOKE TRIPOD VIA FLA SLOPING POLE MOUNT

PROPOSED 1No. CTIL (VF) COMMSCOPE RVVPX308.14R3 ANTENNA AT 32.8m MEAN, BEARING 130° E.T.N. ID No. 389911 FIXED TO PROPOSED BESPOKE TRIPOD WITH 1No. CHS114.3Øx5mm, 4.0m LONG SUPPORT POLE.

NOTE:  
FOR SECTOR 1 AND 3: MAFI 4601 FRAME REQUIRES 56No. 500mm x 500mm x 50mm CONCRETE BALLAST BLOCKS FOR STABILITY.  
FOR SECTOR 2: THE FREE STANDING FRAMES REQUIRE 24No. 600mm x 600mm x 50mm CONCRETE BALLAST BLOCKS FOR STABILITY

NOTE:  
ACCESS TO ROOFTOP DIFFICULT THROUGH BUILDING AND WILL NOT BE ABLE TO TAKE MATERIALS THROUGH BUILDING. CRANE AND ROAD CLOSURE WILL BE REQUIRED FOR SET UP LOCATION.

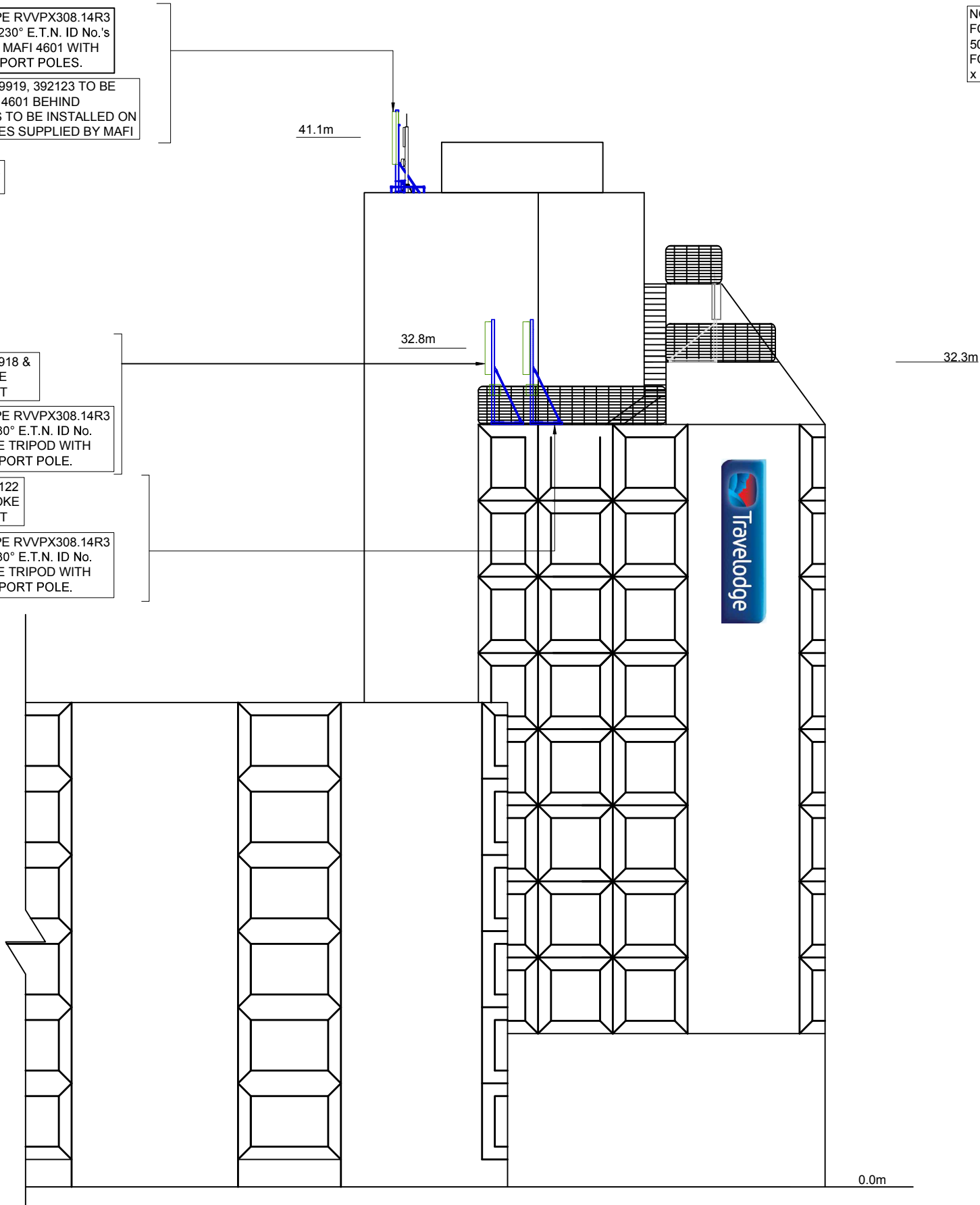

PROPOSED SOUTH - EAST ELEVATION  
SCALE 1:200

CSID	15120320
VFID	89552_0
CSR	N/A
CELL No.	89552VF



arqiva

blueclarity  
design services Ltd.

Notes:

- 1.1 All dimensions are in mm unless otherwise specified.  
1.2 All dimensions to be verified on site.  
1.3 This drawing is to be read in conjunction with all other relevant drawings.

Rev	Description	Draw	Chkd	Date
B	Structural design changed	PO	PO	28.01.20
A	Issued for approval	AVR	PO	16.08.19

Site Address: TRAVELODGE COVENT GARDEN EXT  
10 DRURY LANE  
HIGH HOLBORN  
LONDON  
GREATER LONDON 3  
WC2B 5RE

Site Name: TRAVELODGE COVENT GARDEN EXT  
Project No: 209840  
Arqiva Ref: 78138-22-HF  
Sheet Detail: SOUTH EAST ELEVATION

Dwg no:	203	Scale:	AS SHOWN	Revision:	B
Drawn by:	BCL	Date:	28.01.20	Sheet size:	A3

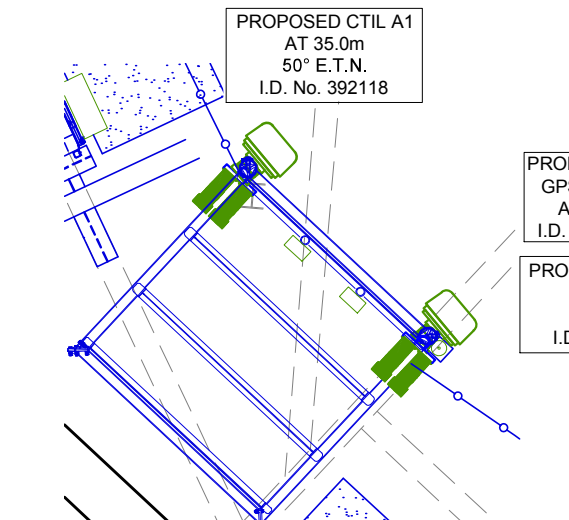
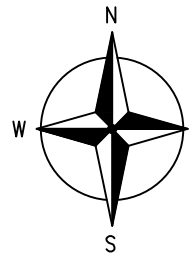

VF S1 ANTENNA PLAN AT 35.0m  
SCALE 1:50

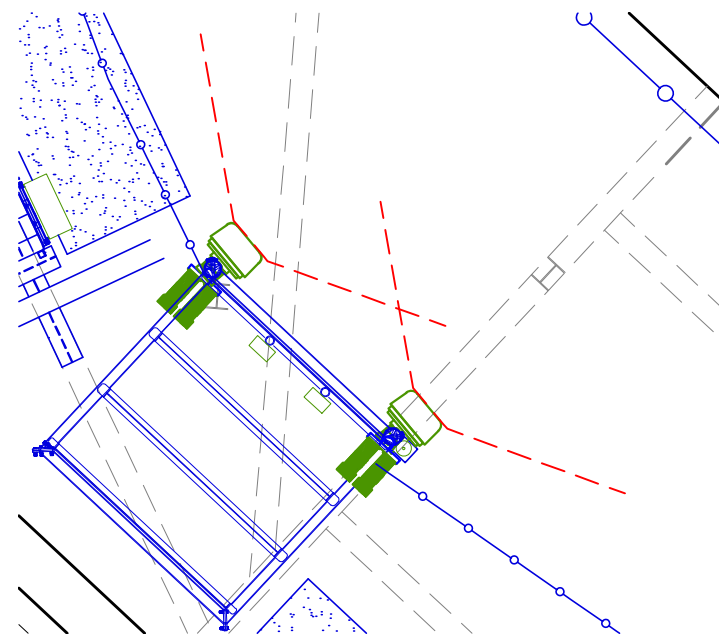

VF S1 SPLAY PLAN AT 35.0m  
SCALE 1:50

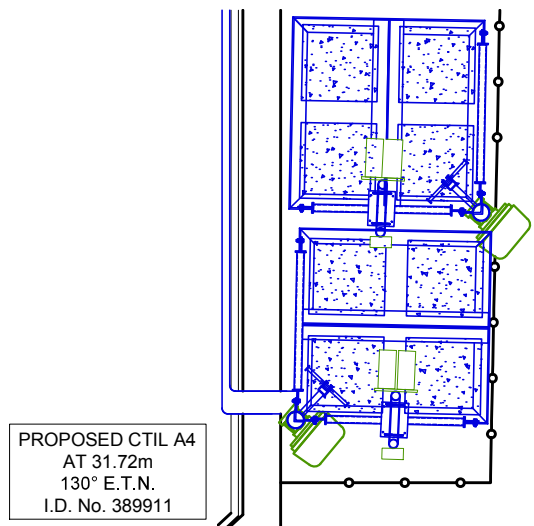

VF S2 ANTENNA PLAN AT 32.8m  
SCALE 1:50

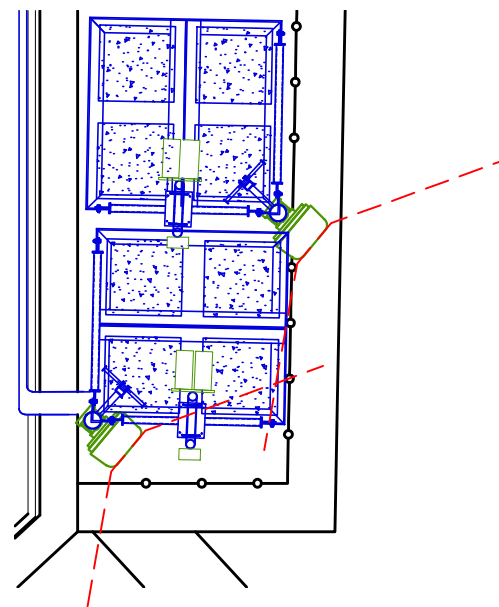

VF S2 SPLAY PLAN AT 32.8m  
SCALE 1:50

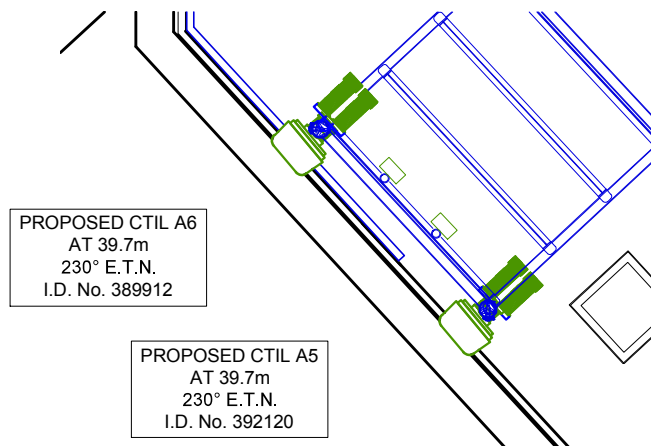

VF S3 ANTENNA PLAN AT 41.1m  
SCALE 1:50

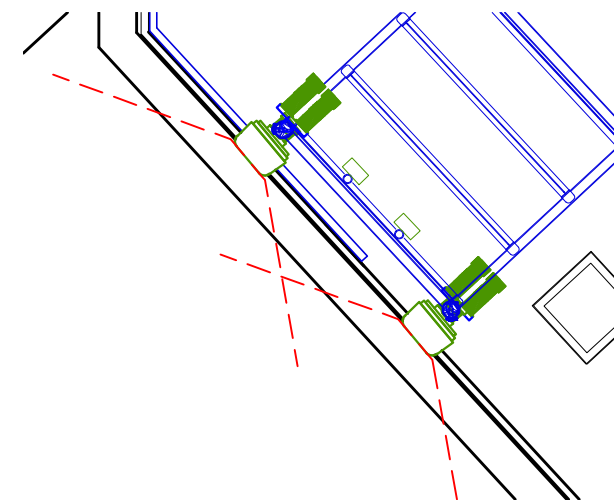

VF S3 SPLAY PLAN AT 41.1m  
SCALE 1:50

NOTE:  
FOR SECTOR 1 AND 3: MAFI 4601 FRAME REQUIRES 56No. 500mm x 500mm x 50mm CONCRETE BALLAST BLOCKS FOR STABILITY.  
FOR SECTOR 2: THE FREE STANDING FRAMES REQUIRE 24No. 600mm x 600mm x 50mm CONCRETE BALLAST BLOCKS FOR STABILITY

CSID	15120320
VFID	89552_0
CSR	N/A
CELL No.	89552VF



Notes:

- 1.1 All dimensions are in mm unless otherwise specified.
- 1.2 All dimensions to be verified on site.
- 1.3 This drawing is to be read in conjunction with all other relevant drawings.

Rev	Description	Draw	Chkd	Date
F	Structural design changed	PO	PO	28.01.20
E	GRP Handrail installed	PO	PO	29.09.19
D	Delta frame installed	PO	PO	06.09.19
C	Mafi 4601 for all sectors	PO	PO	07.05.19
B	Minor amendment	PO	PO	13.04.19

Site Address: TRAVELODGE COVENT GARDEN EXT  
10 DRURY LANE  
HIGH HOLBORN  
LONDON  
GREATER LONDON 3  
WC2B 5RE

Site Name: TRAVELODGE COVENT GARDEN EXT  
Project No: 209840  
Arqiva Ref: 78138-22-HF  
Sheet Detail: ANTENNA PLAN

Dwg no:	204	Scale:	AS SHOWN	Revision:	F
Drawn by:	BCL	Date:	28.01.20	Sheet size:	A3