

Ground Floor Layout  
SCALE 1:50

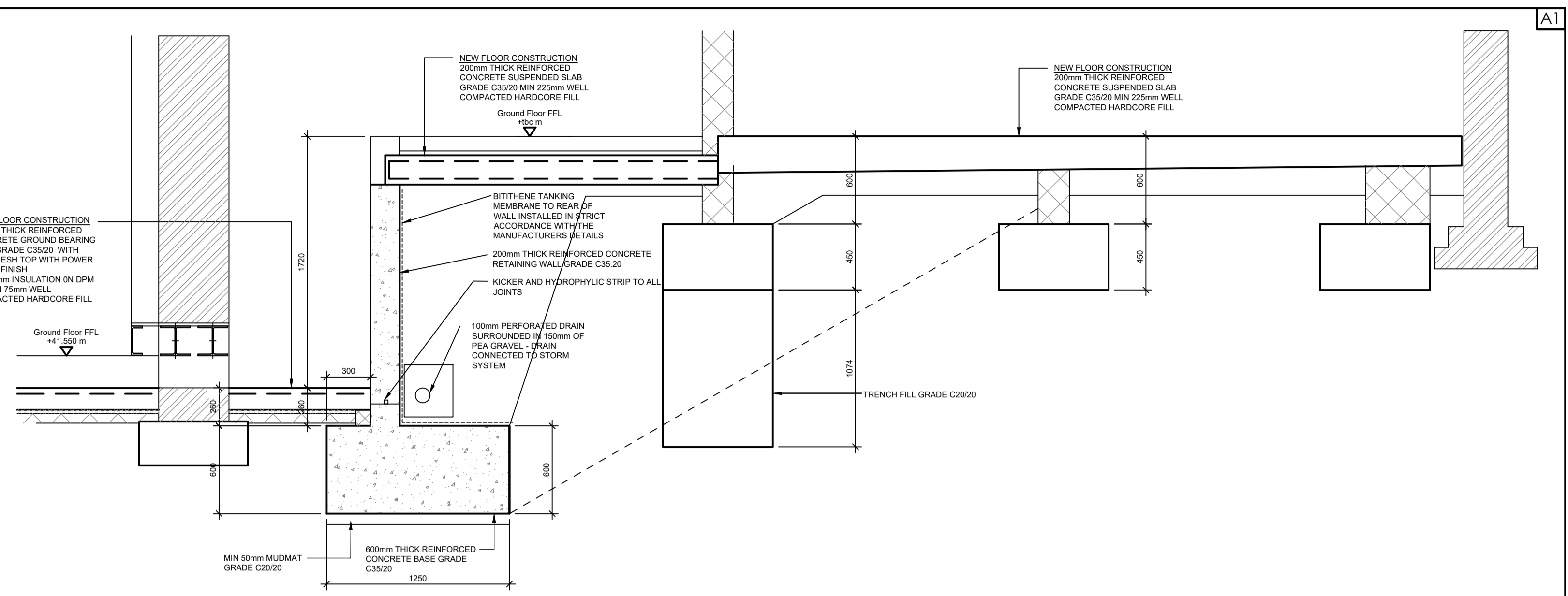

SECTION 1-1  
SCALE 1:20

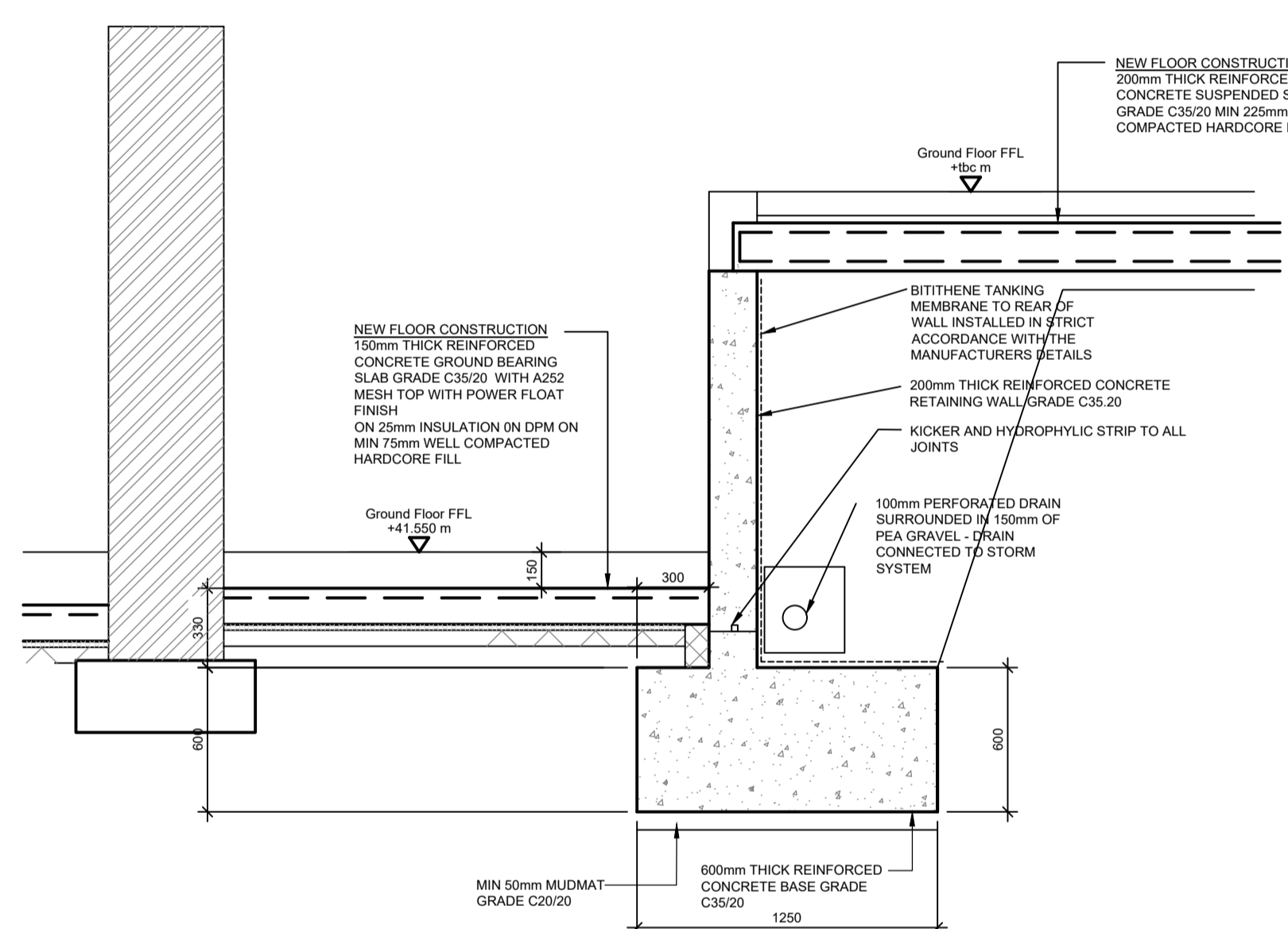

SECTION 2-2  
SCALE 1:20

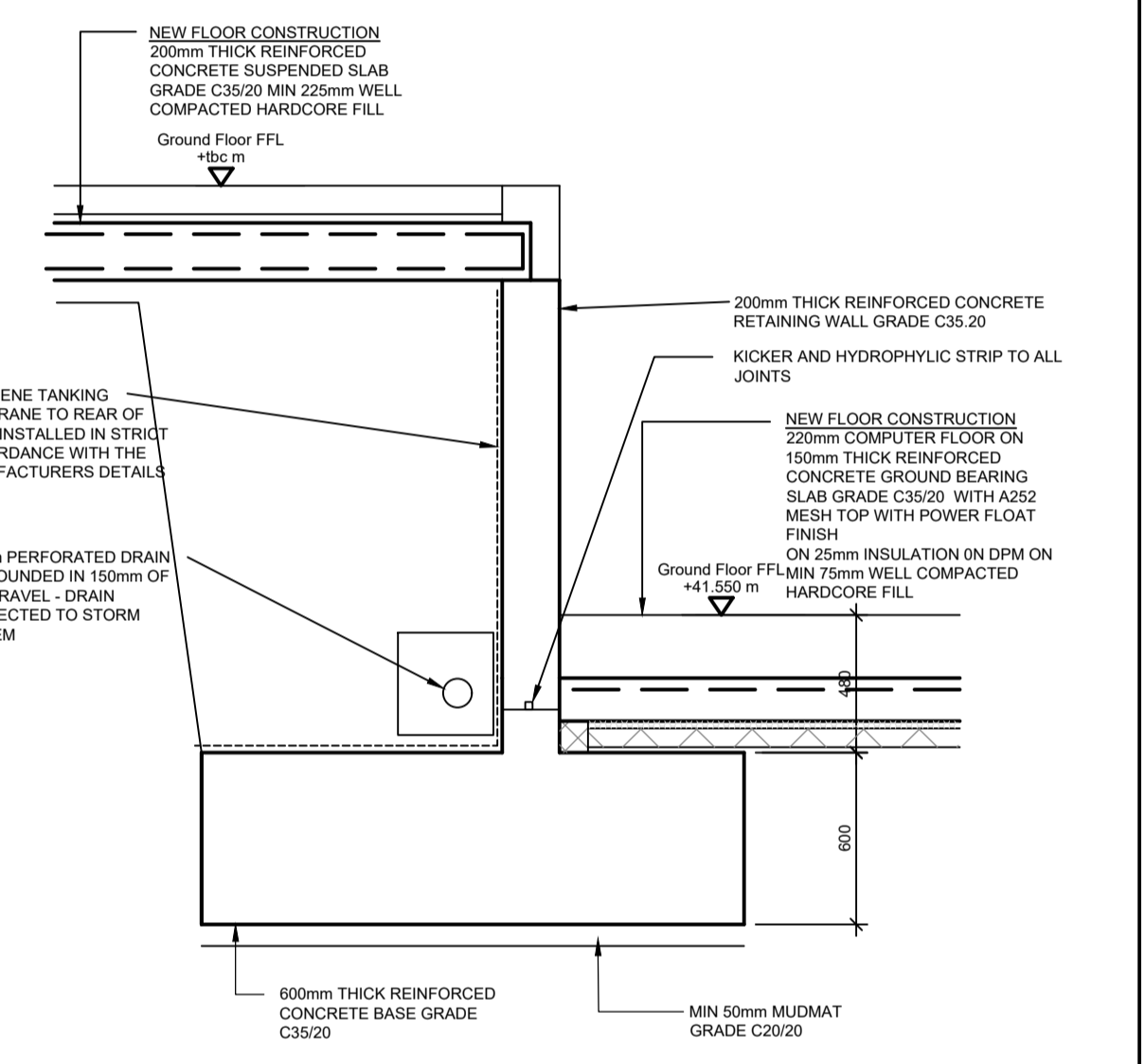

SECTION 7-7  
SCALE 1:20

**NOTES**

- FOUNDATIONS TO BE TAKEN DOWN TO LEVELS INDICATED ON THE DRAWINGS OR AS DIRECTED BY THE ENGINEER OR BUILDING CONTROL INSPECTOR ON SITE.
- CONCRETE GENERALLY SHALL BE MINIMUM C35/20 FOR REINFORCED AND C30/20 UNREINFORCED AND C20/20 FOR BLINDING ELEMENTS.
- EVERY EFFORT SHALL BE MADE TO ENSURE THAT EXCAVATIONS ARE KEPT DRY ALL TIMES. WHEN CONDITIONS ARE INCLEMENT THE BASE OF THE EXCAVATIONS SHALL BE TAKEN OUT JUST PRIOR TO BACKFILLING WITH CONCRETE.
- UNEXPECTED FOUNDATION CONDITIONS AND FORMATION DEPTHS SHALL BE REFERRED IMMEDIATELY TO THE ENGINEER.
- COVER TO MAIN REINFORCEMENT TO BE 40mm MIN. FOR ALL ELEMENTS OF SUBSTRUCTURE.
- ALL FOUNDATIONS TO BE CENTERED UNDER WALLS UNLESS NOTED OTHERWISE. REFER TO THE ARCHITECTS LAYOUTS FOR WALL SETTING OUT DIMENSIONS.
- FOUNDATION WIDTHS AND FORMATION DEPTH TO BE AGREED WITH BUILDING CONTROL SURVEYOR.
- FOUNDATIONS INDICATED ASSUME FIRM TO STIFF CLAYS OR DENSE GRAVELS WITH AN ALLOWABLE BEARING PRESSURE OF 120kN/m<sup>2</sup>.
- GROUND SLABS INDICATED AS GROUND BEARING ON UNDISTURBED FIRM SUBSOILS WITH A MAXIMUM DEPTH OF HARD CORE NOT TO EXCEED 600mm. IF HARD CORE DEPTHS EXCEED 600mm GROUND SLABS SHALL BE SUSPENDED

COLUMN SCHEDULE	
C1	203x203x60 UC
C2	120x120x6.3 SHS
C3	203x203x46 UC
C4	152x152x30 UC

Rev	Revision Details	Des. By	Chk. By
		Date	Date
 <b>cranston consulting</b> Structural & Civil Engineers <small>Skelrick House          Jubilee Road          Newborough          51221 4470</small>			
Client		UK Developments Ltd	
Architect		Buckley Gray Yeoman	
Project		Fortress Grove	
Drawing		Railey Mews Foundation Layout	
Date	Scale	Drawing No.	Rev.
Aug 17	A1@1:50		
Drawn by	Checked by	170110-S75	
KSC	AT		