

1 Proposed Plan
Scale: 1:100

Non-original
joinery removed

Low level joinery
reinstated to
entrance

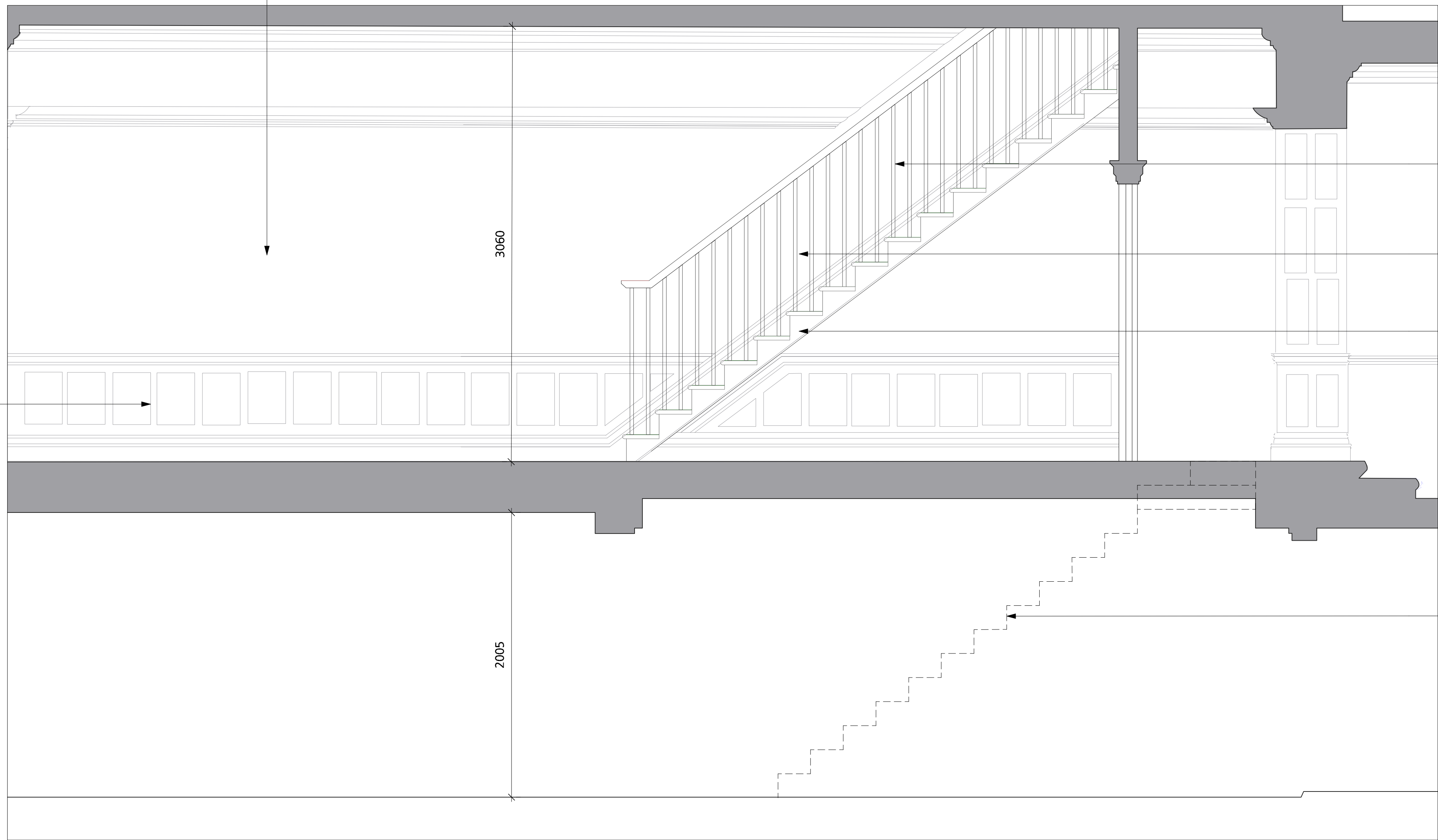

2 Proposed Stair Elevation
Scale: 1:20

Timber handrail

Painted
softwood square
section spindles
to match
existing stair

Runner detail to
match existing
stair above

New basement
stair

GENERAL NOTES.

All dimensions to be checked on site prior to commencement of any works, and/or preparation of any shop drawings.

Sizes of and dimensions to any structural elements are indicative only. See structural engineers drawings for actual sizes / dimensions.

Sizes of and dimensions to any service elements are indicative only. See service engineers drawings for actual sizes and dimensions.

This drawing to be read in conjunction with all other Architect's drawings, specifications and other Consultants' information.

All proprietary systems shown on this drawing are to be installed strictly in accordance with the Manufacturers/Suppliers recommended details.

Any discrepancies between information shown on this drawing and any other contract information or manufacturers/suppliers recommendations is to be brought to the attention of the Architect

DO NOT SCALE FROM THIS DRAWING.

NOTES.

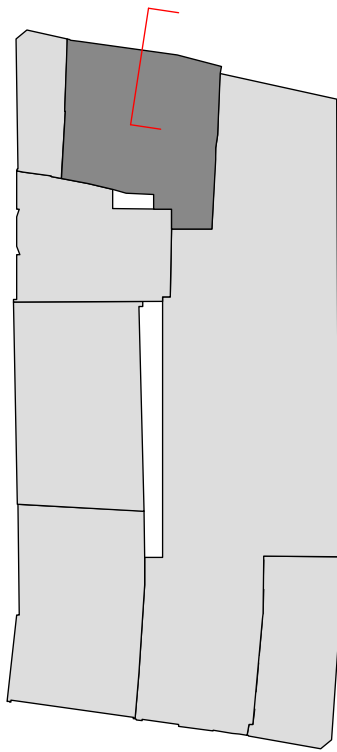

Key Plan



A	PLANNING	05/02/2020
REVISION		DATE

Buckley Gray Yeoman

Studio 4.04 The Tea Building 56 Shoreditch High Street
London E1 6JJ T: 020 7033 9913 F: 020 7033 9914

CLIENT
SRG Holborn Limited

PROJECT
46-48 Bedford Row

DRAWING
**Proposed New Stair Detail
47 Bedford Row**

SCALE 1:20 @ A1 1:40 @ A3	
DATE JAN. 2020	DRAWN BY WSO
DWG No. 1092-ID-101	REVISION A
DRAWING STATUS PLANNING	