

REV	DATE (dd.mm.yy)	DESCRIPTION
-	22.01.20	Draft Issue
A	06.02.20	Issued for Planning

DO NOT SCALE FROM THIS DRAWING. ALL DIMENSIONS ARE TO BE CHECKED ON SITE. ALL OMISSIONS AND DISCREPANCIES TO BE REPORTED TO THE ARCHITECT IMMEDIATELY. THIS DRAWING IS TO BE READ IN CONJUNCTION WITH ALL CONSULTANTS INFORMATION. QUINN ARCHITECTS LTD RETAIN COPYRIGHT OF ALL INFORMATION IN THIS DRAWING

Items hatched / outlined in red proposed for demolition or strip-out

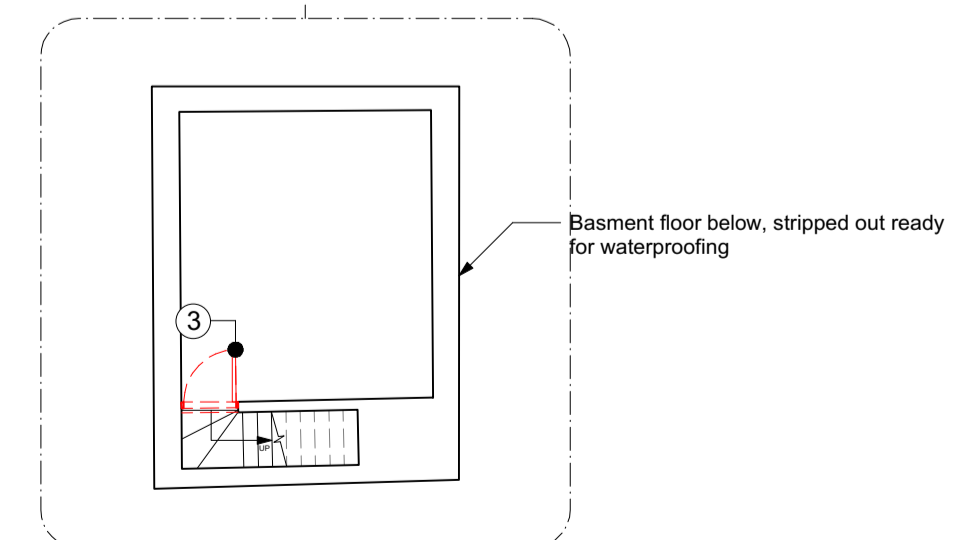
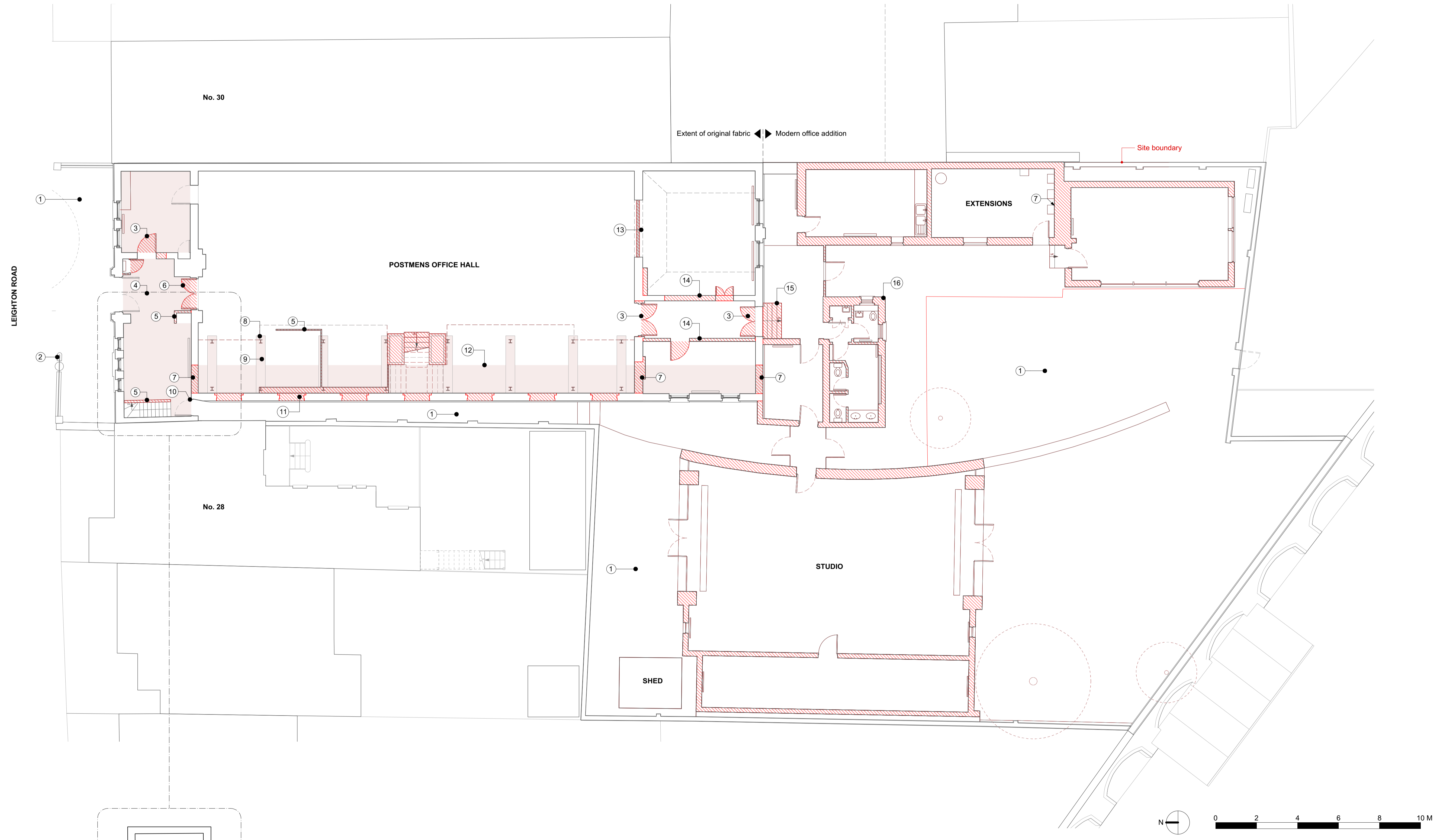

PROPOSED DEMOLITIONS BASEMENT PLAN

Notes

- External floor finishes, services covers and landscaping to be removed
- Railings and postbox to remain in position. Refurbishment, including removal of concrete covering existing brickwork at base, to be ascertained by specialist
- Non-original door removed
- Non-original floor finishes removed
- Non-original partition and finishes removed
- Heavily modified door to be removed, modern additions stripped off and doors refurbished. Doors re-hung to swing outwards.
- Section of wall carefully demolished to create opening into proposed corridor
- Non-original mezzanine, stair and structure to be removed.
- Steel spreader plates in flooring removed. Areas of missing flooring to be infilled with salvaged pine flooring, laid in herringbone pattern to match existing.
- Fire escape door to be removed and replaced
- Window openings above extended downward. Masonry carefully removed and salvaged for brick repairs elsewhere.
- Section of floor lowered to allow for ramped corridor. Existing pine flooring carefully lifted and re-laid elsewhere in hall to fill in areas exposed after removal of the existing mezzanine.
- Non-original partition and glazing removed
- Partition wall carefully removed
- Non-original stairs to be stripped out with external finishes
- All modern additions to the site (studio, outbuildings and extensions) to be demolished.

Quinn Architects

Rochelle School Arnold Circus London E2 7ES
+44 (0)20 7613 3843 www.quinnuk.com

DRAWING TITLE

**Demolition Drawings
Ground & Basement Plans**

SCALE 1:100 @ A1 / 1:200 @ A3	DRAWN BY CE
	CHECKED BY LQ

DRAWING STATUS
PLANNING

PROJECT NO. QA183	DRAWING NO. P061	REV. A
-----------------------------	----------------------------	------------------