

PROPOSED SECTION AA SIDE EXTENSION

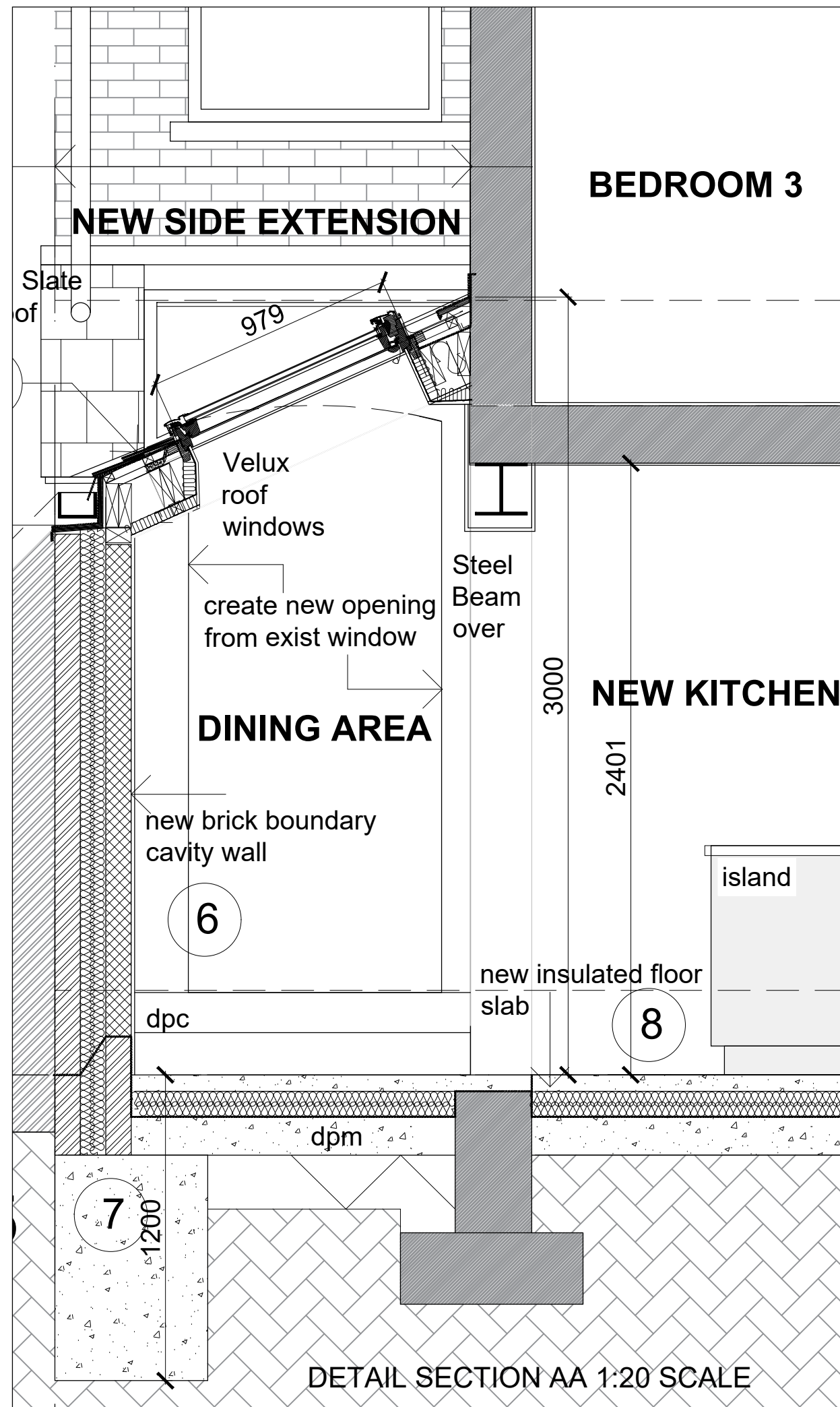

DETAIL SECTION AA 1:20 SCALE

- 1 Natural slate vertical wall hanging with Tyvek breathable membrane on 150x50 timber stud framed load-bearing frames. 150 insulation between studs underlined 50 insulation & foil faced plasterboard linings.
- 2 Dormer flat roof - 3 layer Icopol bit felt membrane on firings on 150x50 joists. 150 insulation between rafters underlined 50 insulation & foil faced plasterboard ceiling. Roof Lead capping to stud/ply formed upstand parapet.
- 3 Antracite Grey aluminium double glazed full height casement & fixed windows.
- 4 Sliding Folding Doors - Aluminium PPC Grey toughened double glazed safety glass sliding folding doors with hinged pass door. U value 1.6 w/m2degC. PC concrete continuous 150mm subcill to threshold.
- 5 Velux Roof window: double glazed u value 1.12 w/m2 degC. Loft - type GGL PK08 1398 x 942mm. Kitchen - type GL PK04 Size 942x978mm. Dormer roof Velux Flat access rooflight CFP 060060- 600x600mm.
- 6 300mm cavity brick / blockwork external wall - 100mm full fill cavity insulation. U value 0.18 w/m2degC
- 7 600mm wide Concrete strip foundations to Structural engineers detail min. depth 1000mm below external ground level
- 8 150mm concrete slab insulated 100mm Celotex with 65mm screed
- 9 22.5 deg Pitched roof to side extension - Blue/black Natural slate on counterbattens on Tyvek breathable membrane 150mm Celotex insulation between & 50mm under rafters. 150 x 50mm C16 rafters @ 400 cts. U value 0.14 w/m2degC
- 10 UPVC double glazed casement & Sash windows U value 1.6 w/m2degC.
- 11 New loft suspended timber floor structure as Struct. Engineer details. 200x50 C24 joists @ 400 cts. Acoustic quilt insulation. 20x150mm SW floor board finish.
- 12 Stud partition 100mm acoustic insulated 75x50 studs @ 400cts plasterboard lined both sides.
- 13 Loft Staircase - SW treads & risers for carpet finish to comply with part K Building regs. 700mm clear width with HW moulded handrails & newel cappings & square balusters @ 100mm cts.
- 14 Frameless fixed double glazed toughened rooflight U value 1.6w/m2degC

Do not scale from this drawing  
All dimensions are to be checked on site  
Any discrepancies are to be reported immediately to the Architect or Main Contractor

COPYRIGHT © 2014  
ALL RIGHTS DESCRIBED IN THE CHAPTER IV OF THE COPYRIGHT DESIGN AND PATENTS ACT 1988, HAVE BEEN GENERALLY ASSERTED

Notes:

P4	11.02.20	Loft elevation revised for side extension Planning App	FB
P3	22.01.20	Building Regs Application	FB
P2	10.12.19	Planning Application	FB
P1	06.12.19	1st Client issue.	FB

Rev.	Date	Comment	By

Client  
Kavita Wali

Project  
**Kitchen & Loft Extensions**  
73 Broomsleigh Street., London NW6 1QQ

Drawing  
Proposed Drawings  
Section AA Side Extension

Project No.	Drawing No.	Issue	Status
KW2019 SK08	P4	1	

Scale	Date	Drawn By	Checked By
1:50/20 @A3	Oct 2019	FB	FB