

- notes
1. Do not scale from this drawing
 2. Work to figured dimensions where shown
 3. Confirm dimensions on site before fabrication or construction - report any discrepancies to CA

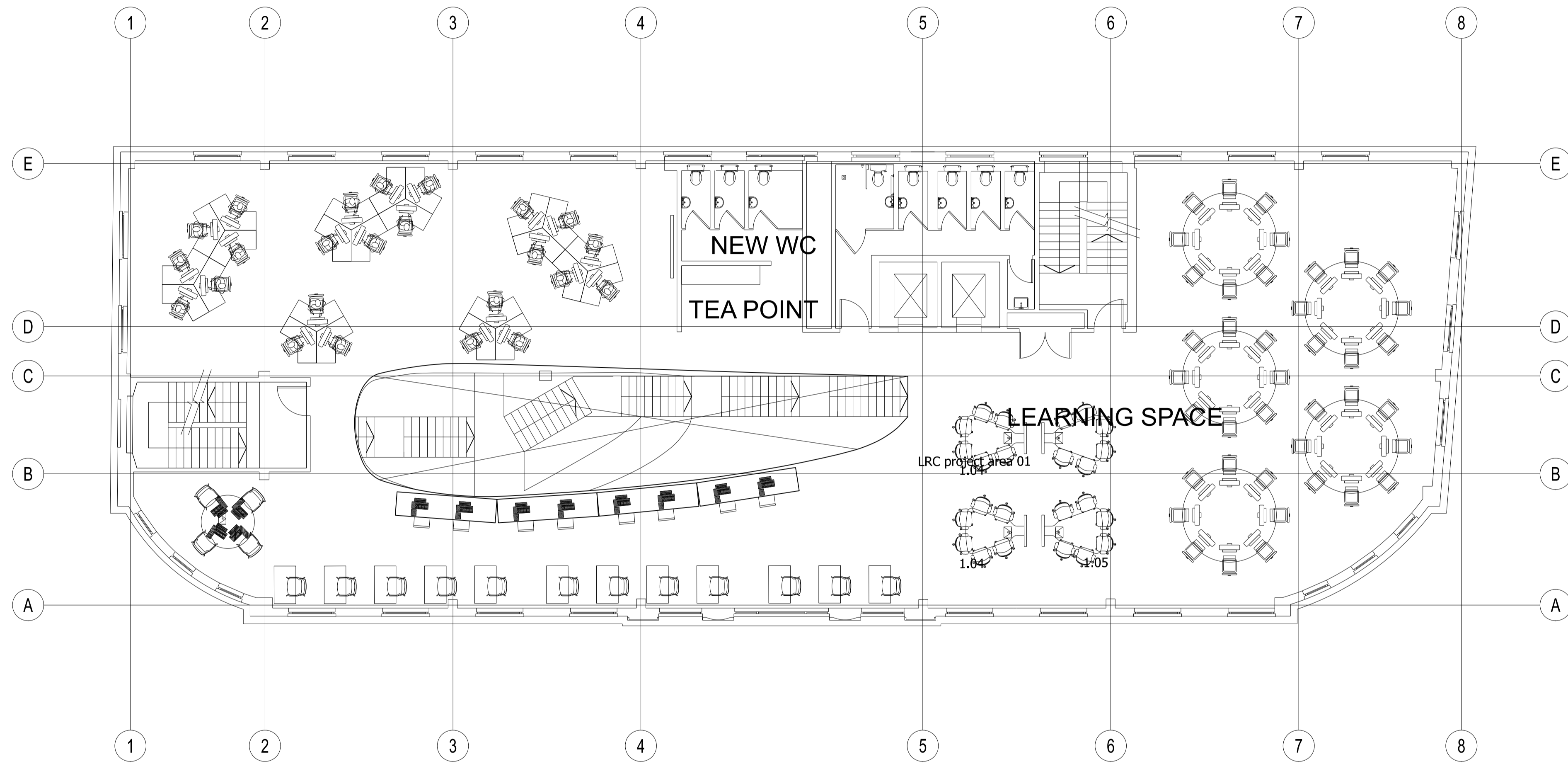

Second floor

P3	Scale bar added, colour key omitted	06/02/20
P2	Updated following fire engineer's comments	16/09/19
P1	Drawing originated	11/07/19
VERSION	DESCRIPTION	DATE

SUITABILITY DESCRIPTION
(SX) Document_Suitability_Description

Shepherd Epstein Hunter
architecture planning landscape

Phoenix Yard, 65 Kings Cross Road, London WC1X 9LW
tel: 020 7841 7500 fax: 020 7841 7575
email: architecture@seh.co.uk web: www.seh.co.uk

PROJECT
70 Grays Inn road

CLIENT
University of Lincoln

TITLE
Second floor proposal

SCALE
1 : 100

SIZE
A1

SEH PROJECT NUMBER	DRAWN BY	CHECKED BY
19059	AL	CHK
DRAWING NUMBER	STATUS CODE	VERSION
0004	S0	P3

FILE NAME
PROJECT CODE -ORIGINATOR -ZONE -LEVEL -TYPE -ROLE -SHEET NO.
19049-SEH-00-02-DR-A-0004