

Key Site Plan 1:250

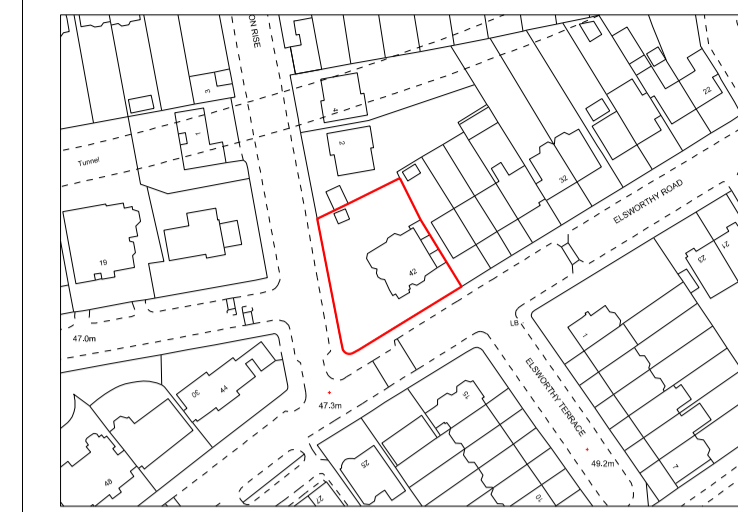

Key:

	Existing structure / earth		Existing Brickwork
	Proposed structure		Existing Slate Roof
	Permeable granite Setts		Portland Stone

- Proposed Notes
- 01 New Balustrade
  - 02 New metal railings (Painted black)
  - 03 New pedestrian metal entrance gate (Painted black)
  - 04 New automated vehicular metal entrance gate (Painted black)
  - 05 New panelled timber entrance door (Painted black)
  - 06 New brick pier to match existing brick wall
  - 07 Existing drop-kerb
  - 08 New bike store
  - 09 Permeable granite paving
  - 10 Proposed planting to obscure view of lightwell
  - 11 Horizontal slatted timber frame
  - 12 Proposed brick extension
  - 13 Proposed lightweight timber extension
  - 14 Slate roof
  - 15 Timber "mews style" door/window
  - 16 Timber faced aluminum windows
  - 17 Traditionally detailed timber door / window
  - 18 Structural glazing infill extension
  - 19 Frosted glazing to prevent overlooking
  - 20 Existing timber windows replaced with lowered sill height
  - 21 Proposed brick infill extension
  - 22 Openable flat rooflight

Rev C	08.11.2019	Issued For Planning
Rev B	08.10.2019	Issued For Planning
Rev A	31.07.2019	Issued For Planning

7. Balustrade moved back to align with rear elevation of main house

6. Building line moved in towards main house

1. Height of parapet reduced by 200mm
2. Extension centred between chimney breasts
3. Window centred between chimney breasts & reduced in height
4. Roof design amended
5. Terrace design + extent of associated excavation removed to accommodate existing tree roots

# PLANNING

Project No. **16092**

Client **Forty Two Point Five Elsworth Ltd**

Date **July 2018**

Scale **1:200 @ A3 / 1:100 @ A1**

Project **42 Elsworth Road, NW3**

Drawing Title: **Proposed First Floor Plan**

Drawing No.	<b>P_04</b>	Rev.	<b>C</b>
Drawn	<b>RP</b>	Approved	<b>MW</b>
		Signed	<b>-</b>



66-68 Margaret Street, W1W 8SR T. 020 7580 9336 www.mw-a.co.uk

Copyright Marek Wojciechowski Architects Limited. No implied license exists. This drawing should not be used to calculate areas for the purposes of valuation. All dimensions to be checked on site by the contractor and such dimensions to be their responsibility. Do not scale drawings. All work must comply with relevant British Standards and Building Regulations requirements. Drawing errors and omissions to be reported to the architect.

