

© Crown copyright. All Rights Reserved. Licence Number 100022432.

# Envirocheck®

LANDMARK INFORMATION GROUP®

## VectorMap Local

Published 2019

Source map scale - 1:10,000

VectorMap Local (Raster) is Ordnance Survey's highest detailed 'backdrop' mapping product. These maps are produced from OS's VectorMap Local, a simple vector dataset at a nominal scale of 1:10,000, covering the whole of Great Britain, that has been designed for creating graphical mapping. OS VectorMap Local is derived from large-scale information surveyed at 1:1250 scale (covering major towns and cities), 1:2500 scale (smaller towns, villages and developed rural areas), and 1:10 000 scale (mountain, moorland and river estuary areas).

## Map Name(s) and Date(s)

TQ28NW 2019 Variable	TQ28NE 2019 Variable
TQ28SW 2019 Variable	TQ28SE 2019 Variable

## Historical Map - Slice A

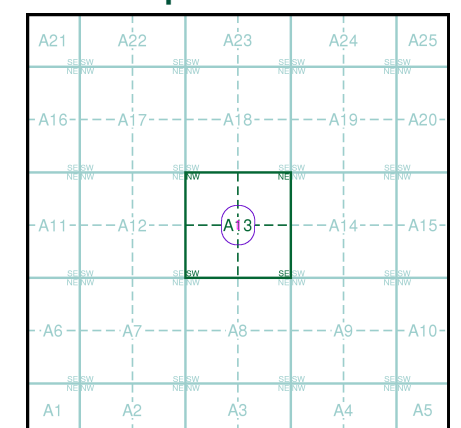

## Order Details

Order Number: 225619993\_1\_1  
Customer Ref: 19/31225  
National Grid Reference: 525800, 184320  
Slice: A  
Site Area (Ha): 0.07  
Search Buffer (m): 1000

## Site Details

111, Canfield Gardens, LONDON, NW6 3DY

**Landmark®**  
LANDMARK INFORMATION GROUP

Tel: 0844 844 9952  
Fax: 0844 844 9951  
Web: www.envirocheck.co.uk



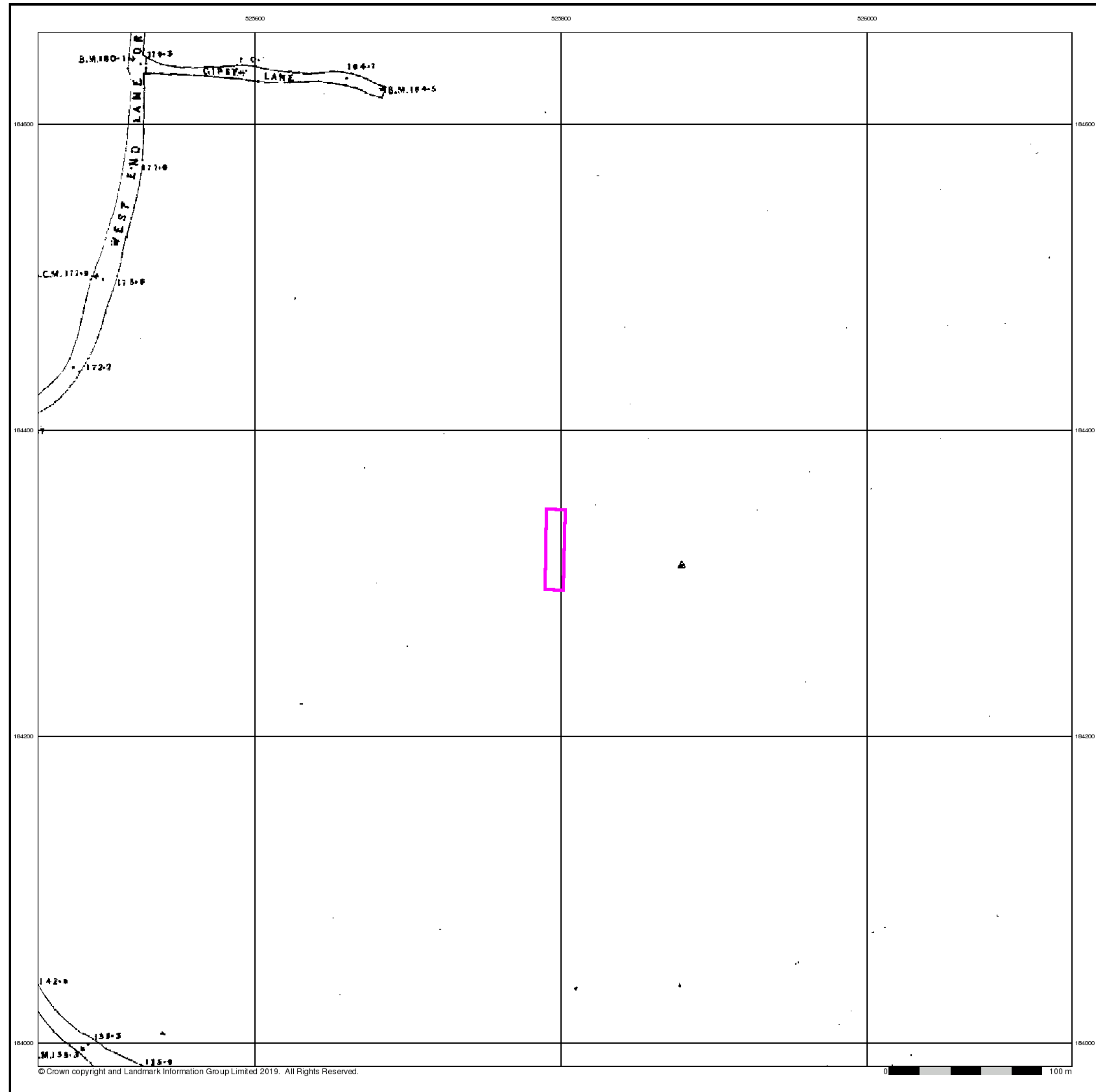

# Envirocheck<sup>®</sup>

LANDMARK INFORMATION GROUP<sup>®</sup>

## London

### Published 1850

### Source map scale - 1:5,280

The historical town plans shown derive from Ordnance Survey mapping from the early to mid 1850s. The 1:2640 scale was introduced in the early 1850s, to survey districts covered by the Local Boards of Health and for a map of the Osborne Estate of Queen Victoria. The general style is similar to that of the early 1:2500s published shortly afterwards.

1:5280 scale was surveyed shortly afterwards in the mid 1850s as general purpose mapping with a standard of content similar to the more contemporary 1:10,560 mapping. The scale was also used for a reduction of the 1:1056 'skeleton survey' of London that was undertaken between 1848 and 1850.

Please note: Due to the partial coverage of Historical Town Plans, it is possible that not all segments within an order will contain mapping. Only the segments that have Town Plan coverage will be generated.

### Map Name(s) and Date(s)

006\_00\_000\_NE

1850

1:5280

### Historical Town Plan - Segment A13

A21A22A23A24A25

A16A17A18A19A20

A11A12A13A14A15

A6A7A8A9A10

A1A2A3A4A5

N

### Order Details

Order Number:	225619993_1_1
Customer Ref:	19/31225
National Grid Reference:	525800, 184320
Slice:	A
Site Area (Ha):	0.07
Search Buffer (m):	0

### Site Details

111, Canfield Gardens, LONDON, NW6 3DY

Landmark<sup>®</sup>

INFORMATION GROUP

Tel: 0844 844 9952

Fax: 0844 844 9951

Web: [www.envirocheck.co.uk](http://www.envirocheck.co.uk)

A Landmark Information Group Service v50.0 19-Nov-2019

Page 1 of 1

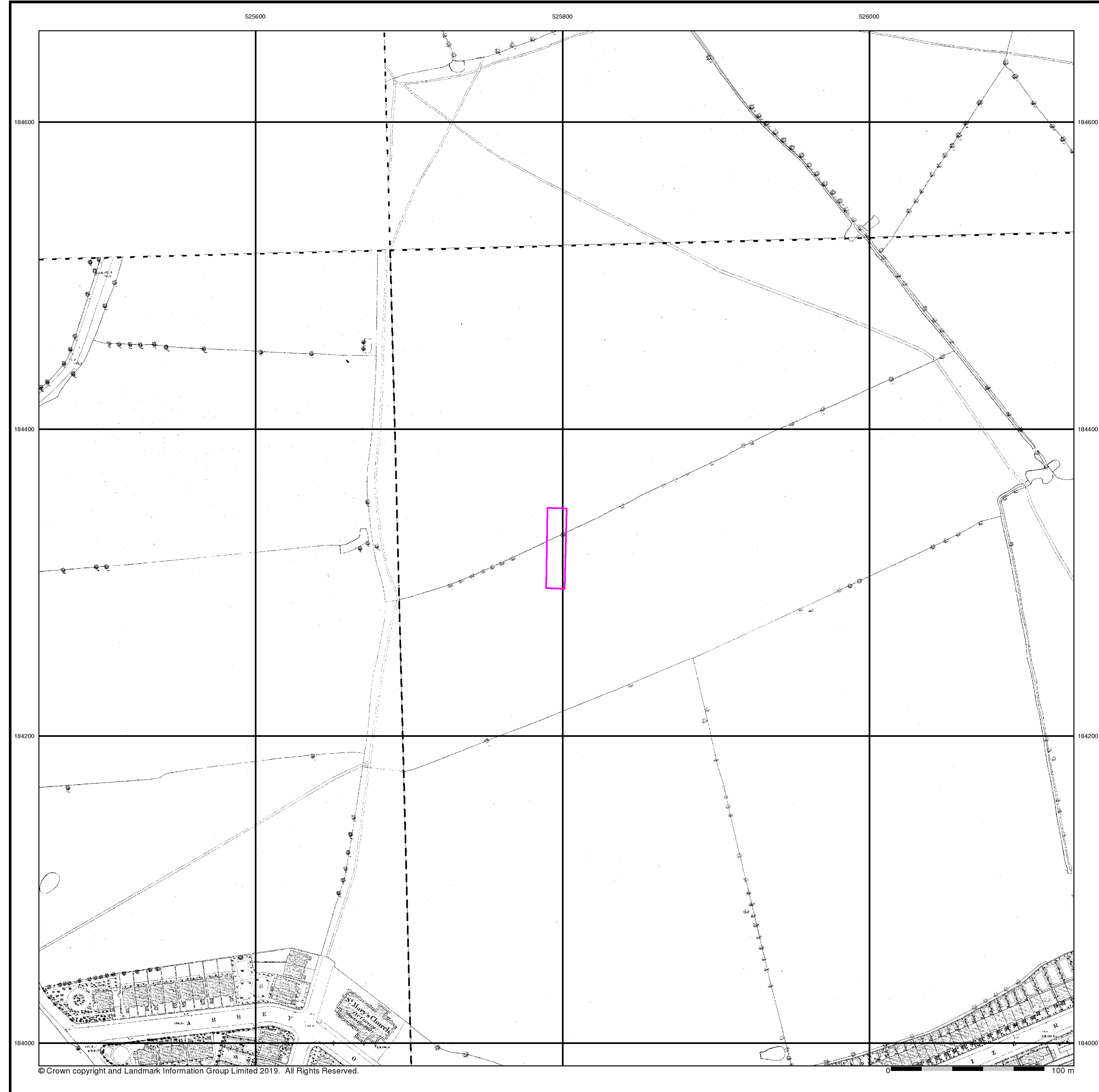

# Envirocheck®

LANDMARK INFORMATION GROUP®

## London

### Published 1871 - 1872

### Source map scale - 1:1,056

The 1:1056 scale of Ordnance Survey mapping was adopted from Ireland in 1848 and was used to survey towns with a population of over 4000, plus county towns of lesser population, in those counties mapped at the six-inch scale in 1841-55. The scale was the largest scale at which London was mapped by the Ordnance Survey and a 'skeleton' survey of the capital, showing little more than streets, street names, frontages and altitudes, was undertaken between 1848 and 1850. The majority of the 1:1056 surveys were later replaced by 1:500 surveys; although almost all the remainder were revised at this scale, sometimes more than once before 1895. The type of detail shown on the 1:1056 scale is broadly similar to that on 1:500; the apparent omission of minor details such as sewer access points and street lights may be as much a reflection of the generally earlier date of these plans, as of the specification of the map.

Please note: Due to the partial coverage of Historical Town Plans, it is possible that not all segments within an order will contain mapping. Only the segments that have Town Plan coverage will be generated.

### Map Name(s) and Date(s)

006_00_009	1871	1:1,056
006_00_018	1871	1:1,056
006_00_019	1872	1:1,056

### Historical Town Plan - Segment A13

A21	A22	A23	A24	A25
A16	A17	A18	A19	A20
A11	A12	A13	A14	A15
A6	A7	A8	A9	A10
A1	A2	A3	A4	A5

N

### Order Details

Order Number: 225619993\_1\_1  
Customer Ref: 19/31225  
National Grid Reference: 525800, 184320  
Slice: A  
Site Area (Ha): 0.07  
Search Buffer (m): 0

### Site Details

111, Canfield Gardens, LONDON, NW6 3DY

## Landmark®

INFORMATION GROUP

Tel: 0844 844 9952  
Fax: 0844 844 9951  
Web: [www.envirocheck.co.uk](http://www.envirocheck.co.uk)

© Crown copyright and Landmark Information Group Limited 2019. All Rights Reserved.

A Landmark Information Group Service v50.0 19-Nov-2019 Page 1 of 3



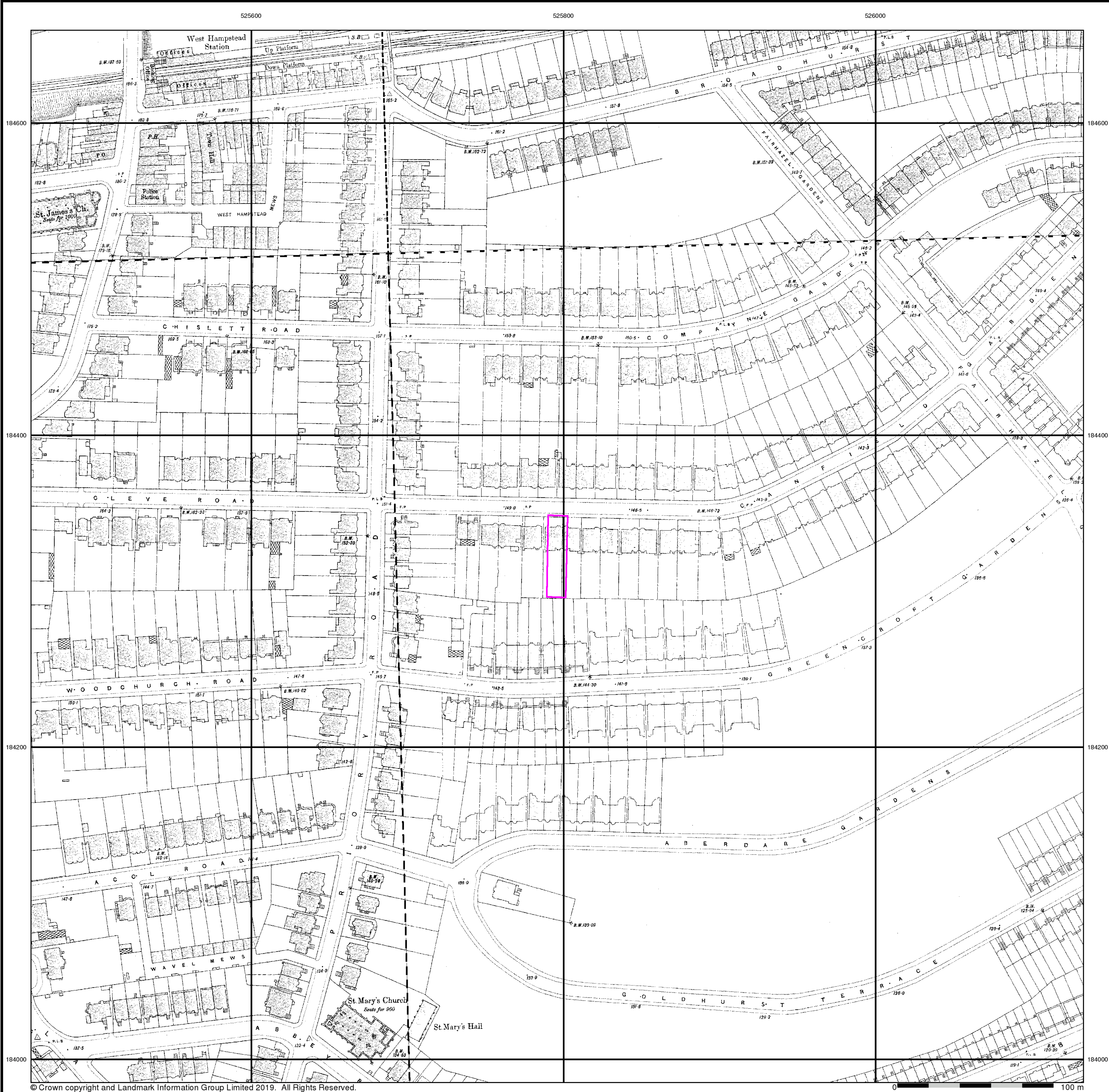

London

Published 1894 - 1895

Source map scale - 1:1,056

The 1:1056 scale of Ordnance Survey mapping was adopted from Ireland in 1848 and was used to survey towns with a population of over 4000, plus county towns of lesser population, in those counties mapped at the six-inch scale in 1841-55. The scale was the largest scale at which London was mapped by the Ordnance Survey and a 'skeleton' survey of the capital, showing little more than streets, street names, frontages and altitudes, was undertaken between 1848 and 1850. The majority of the 1:1056 surveys were later replaced by 1:500 surveys; although almost all the remainder were revised at this scale, sometimes more than once before 1895. The type of detail shown on the 1:1056 scale is broadly similar to that on 1:500; the apparent omission of minor details such as sewer access points and street lights may be as much a reflection of the generally earlier date of these plans, as of the specification of the map.

Please note: Due to the partial coverage of Historical Town Plans, it is possible that not all segments within an order will contain mapping. Only the segments that have Town Plan coverage will be generated.

Map Name(s) and Date(s)

006_00_008	006_00_009
1894	1895
1:1,056	1:1,056
006_00_018	006_00_019
1895	1895
1:1,056	1:1,056

Historical Town Plan - Segment A13

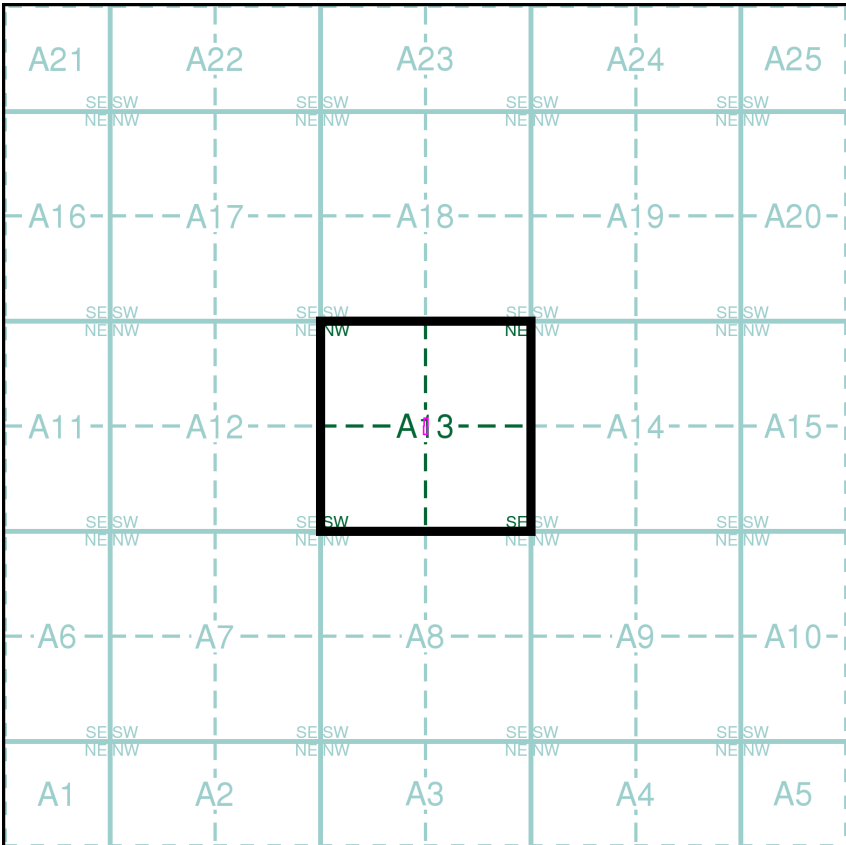

Order Details

Order Number: 225619993\_1\_1  
Customer Ref: 19/31225  
National Grid Reference: 525800, 184320  
Slice: A  
Site Area (Ha): 0.07  
Search Buffer (m): 0

Site Details

111, Canfield Gardens, LONDON, NW6 3DY



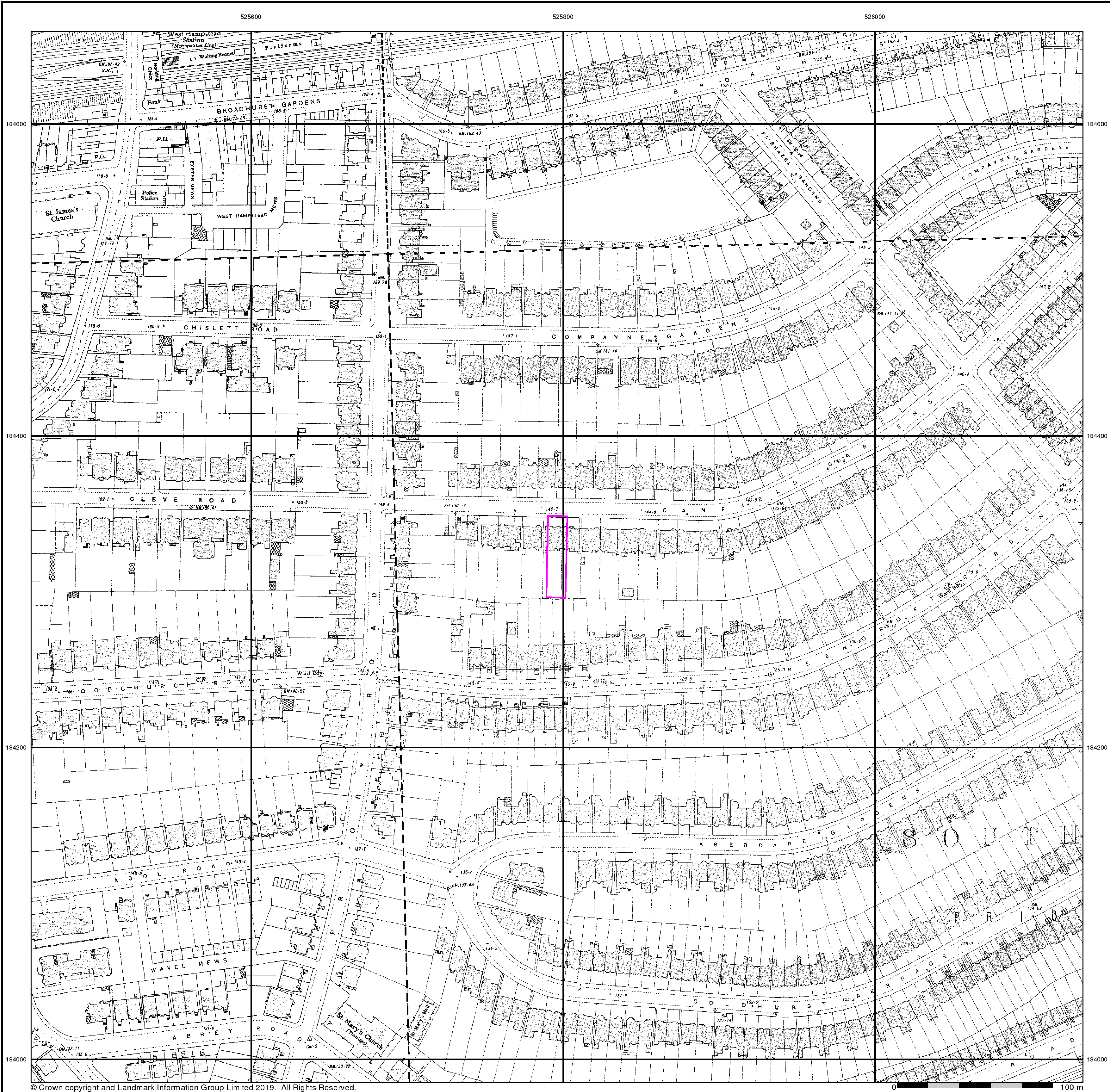

# Envirocheck®

LANDMARK INFORMATION GROUP®

London

Published 1936 - 1939

Source map scale - 1:1,056

The 1:1056 scale of Ordnance Survey mapping was adopted from Ireland in 1848 and was used to survey towns with a population of over 4000, plus county towns of lesser population, in those counties mapped at the six-inch scale in 1841-55. The scale was the largest scale at which London was mapped by the Ordnance Survey and a 'skeleton' survey of the capital, showing little more than streets, street names, frontages and altitudes, was undertaken between 1848 and 1850. The majority of the 1:1056 surveys were later replaced by 1:500 surveys; although almost all the remainder were revised at this scale, sometimes more than once before 1895. The type of detail shown on the 1:1056 scale is broadly similar to that on 1:500; the apparent omission of minor details such as sewer access points and street lights may be as much a reflection of the generally earlier date of these plans, as of the specification of the map.

Please note: Due to the partial coverage of Historical Town Plans, it is possible that not all segments within an order will contain mapping. Only the segments that have Town Plan coverage will be generated.

## Map Name(s) and Date(s)

006_00_008	006_00_009
1937	1936
1:1,056	1:1,056
006_00_018	006_00_019
1937	1939
1:1,056	1:1,056

## Historical Town Plan - Segment A13

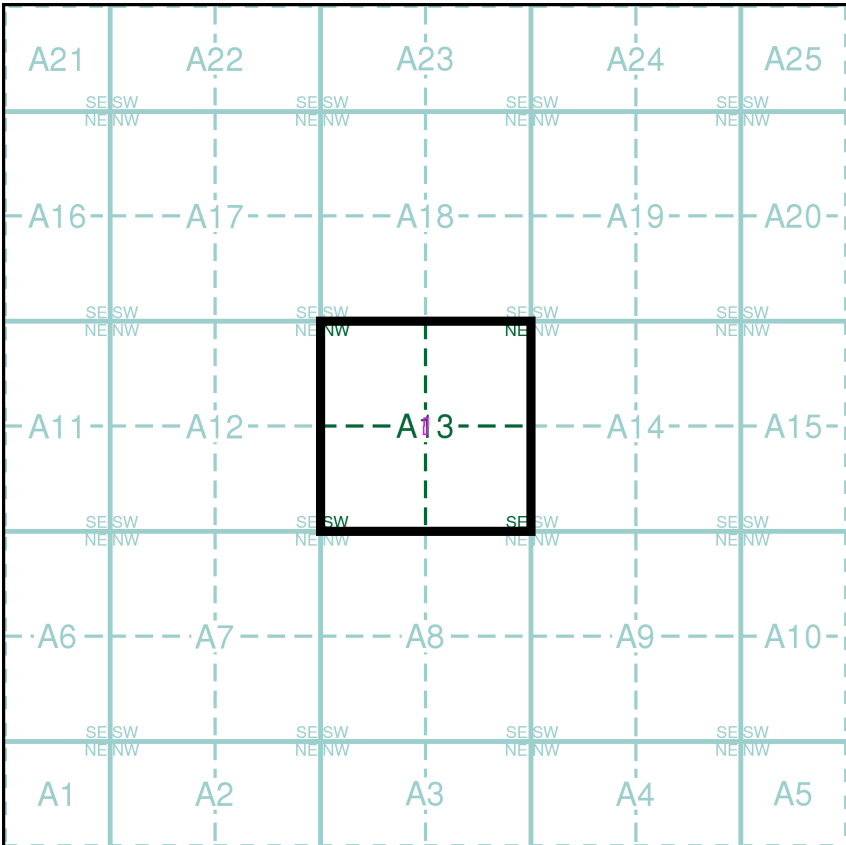

## Order Details

Order Number: 225619993\_1\_1  
Customer Ref: 19/31225  
National Grid Reference: 525800, 184320  
Slice: A  
Site Area (Ha): 0.07  
Search Buffer (m): 0

## Site Details

111, Canfield Gardens, LONDON, NW6 3DY

Landmark®  
INFORMATION GROUP

Tel: 0844 844 9952  
Fax: 0844 844 9951  
Web: www.envirocheck.co.uk



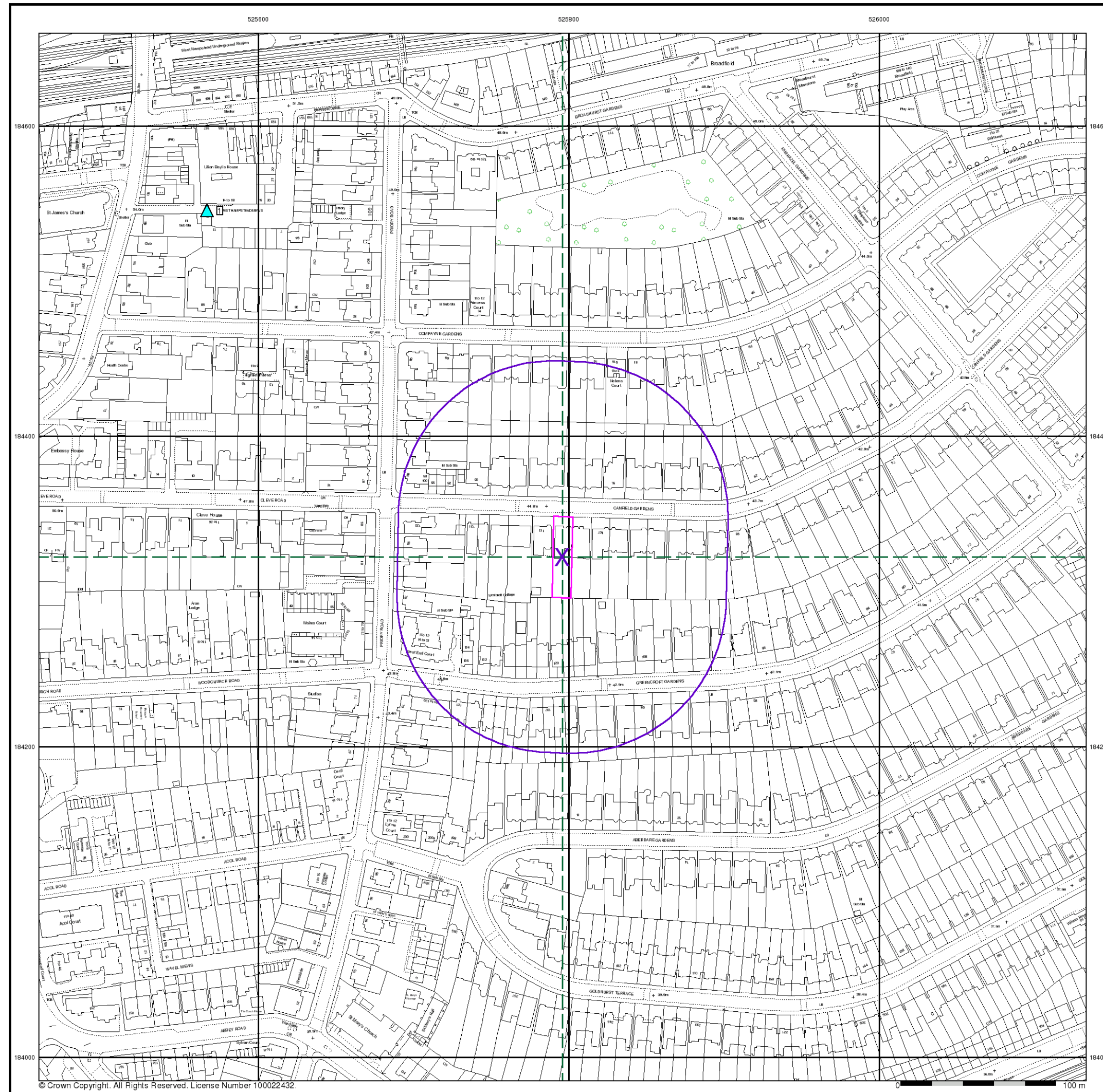

© Crown Copyright. All Rights Reserved. License Number 100022432.

# Envirocheck®

LANDMARK INFORMATION GROUP®

- ### General

  - Specified Site
  - Specified Buffer(s)
  - Bearing Reference Point
  - Map ID
  - Several of Type at Location
  - Pylon
  - Overhead Transmission Line
- ### Agency and Hydrological

  - Contaminated Land Register Entry or Notice (Location)
  - Contaminated Land Register Entry or Notice
  - Discharge Consent
  - Enforcement or Prohibition Notice
  - Integrated Pollution Control
  - Integrated Pollution Prevention Control
  - Local Authority Integrated Pollution Prevention and Control
  - Local Authority Pollution Prevention and Control
  - Local Authority Recorded Landfill Site
  - Pollution Incident to Controlled Waters
  - Prosecution Relating to Authorised Processes
  - Prosecution Relating to Controlled Waters
  - Registered Radioactive Substance
  - River Network or Water Feature
  - River Quality Sampling Point
  - Substantiated Pollution Incident Register
  - Water Abstraction
  - Water Industry Act Referral
- ### Waste

  - BGS Recorded Landfill Site (Location)
  - BGS Recorded Landfill Site
  - EA Historic Landfill (Buffered Point)
  - EA Historic Landfill (Polygon)
  - Integrated Pollution Control Registered Waste Site
  - Licensed Waste Management Facility (Landfill Boundary)
  - Licensed Waste Management Facility (Location)
  - Local Authority Recorded Landfill Site (Location)
  - Local Authority Recorded Landfill Site
  - Potentially Infilled Land (Non-water)
  - Potentially Infilled Land (Non-water)
  - Potentially Infilled Land (Non-water)
  - Potentially Infilled Land (Water)
  - Potentially Infilled Land (Water)
  - Potentially Infilled Land (Water)
  - Registered Landfill Site
  - Registered Landfill Site (Location)
  - Registered Landfill Site (Point Buffered to 100m)
  - Registered Landfill Site (Point Buffered to 250m)
  - Registered Waste Transfer Site (Location)
  - Registered Waste Transfer Site
  - Registered Waste Treatment or Disposal Site (Location)
  - Registered Waste Treatment or Disposal Site
- ### Hazardous Substances

  - COMAH Site
  - Explosive Site
  - NIHHS Site
  - Planning Hazardous Substance Consent
  - Planning Hazardous Substance Enforcement
- ### Geological

  - BGS Recorded Mineral Site

## Site Sensitivity Map - Segment A13

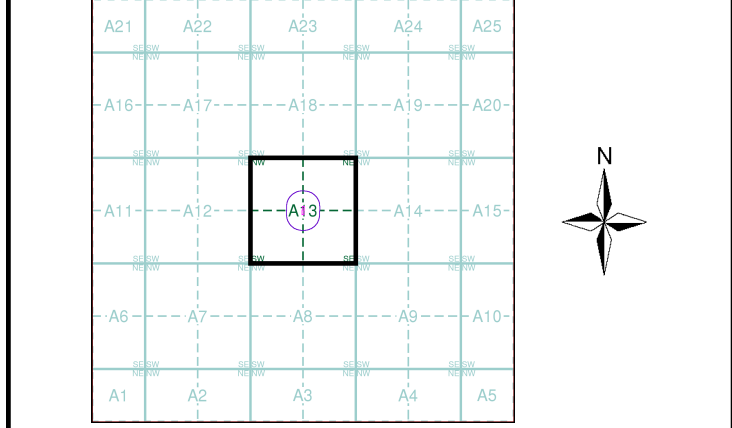

**Order Details**  
Order Number: 225619993\_1\_1  
Customer Ref: 19/31225  
National Grid Reference: 525800, 184320  
Slice: A  
Site Area (Ha): 0.07  
Plot Buffer (m): 100

**Site Details**  
111, Canfield Gardens, LONDON, NW6 3DY

**Landmark®**  
INFORMATION GROUP  
Tel: 0844 844 9952  
Fax: 0844 844 9951  
Web: www.envirocheck.co.uk





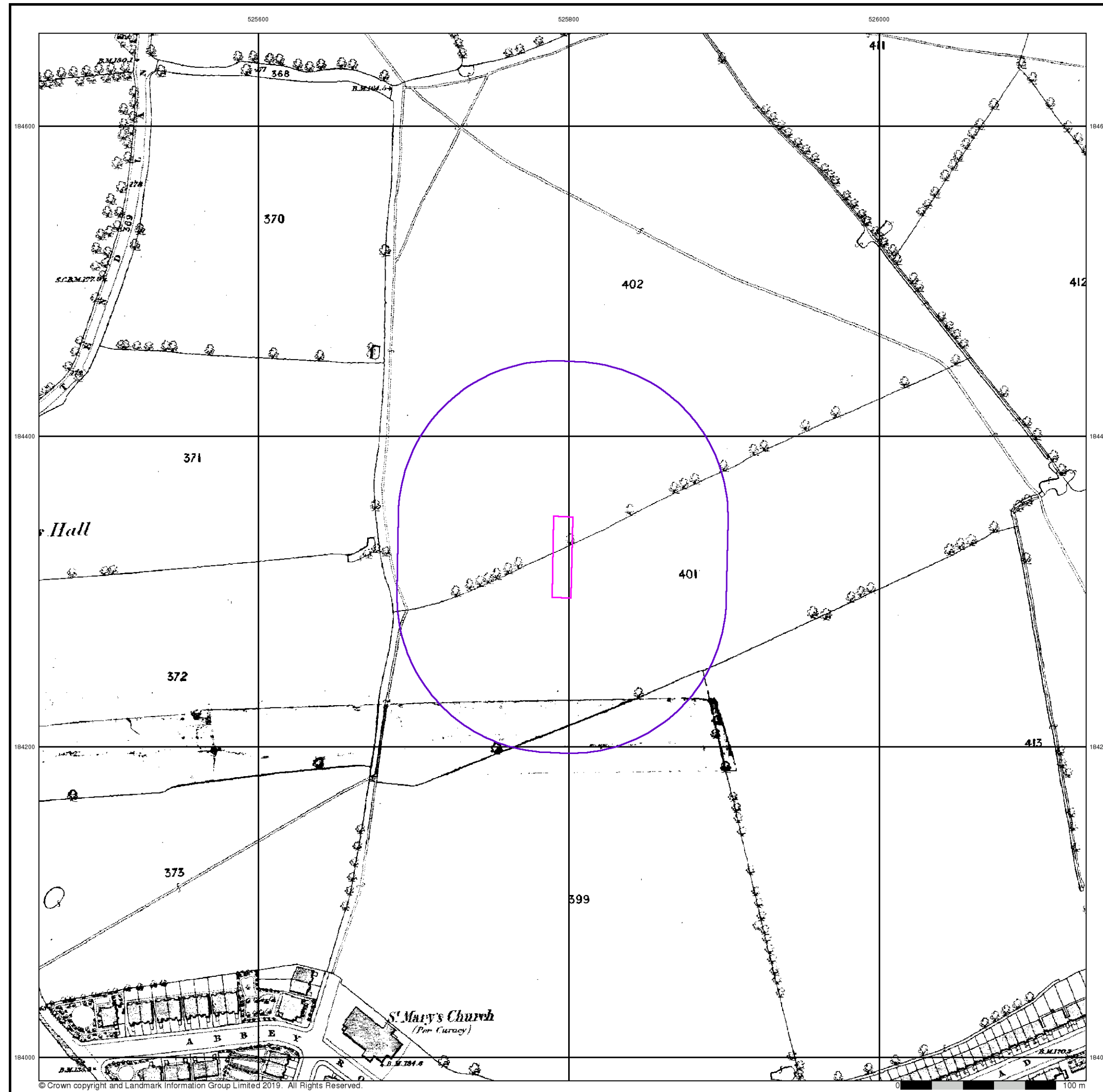

# Envirocheck<sup>®</sup>

LANDMARK INFORMATION GROUP<sup>®</sup>

## London

**Published 1871**

**Source map scale - 1:2,500**

The historical maps shown were reproduced from maps predominantly held at the scale adopted for England, Wales and Scotland in the 1840's. In 1854 the 1:2,500 scale was adopted for mapping urban areas and by 1896 it covered the whole of what were considered to be the cultivated parts of Great Britain. The published date given below is often some years later than the surveyed date. Before 1938, all OS maps were based on the Cassini Projection, with independent surveys of a single county or group of counties, giving rise to significant inaccuracies in outlying areas.

### Map Name(s) and Date(s)

015\_00  
1871  
1:2,500

### Historical Map - Segment A13

A21A22A23A24A25  
A16A17A18A19A20  
A11A12A13A14A15  
A6A7A8A9A10  
A1A2A3A4A5

### Order Details

Order Number:	225619993_1_1
Customer Ref:	19/31225
National Grid Reference:	525800, 184320
Slice:	A
Site Area (Ha):	0.07
Search Buffer (m):	100

### Site Details

111, Canfield Gardens, LONDON, NW6 3DY

## Landmark<sup>®</sup>

INFORMATION GROUP

Tel: 0844 844 9952  
Fax: 0844 844 9951  
Web: [www.envirocheck.co.uk](http://www.envirocheck.co.uk)

A Landmark Information Group Service v50.0 19-Nov-2019 Page 2 of 21