

P1 & P2 Permeable Block Paving - Herringbone pattern  
1 : 10

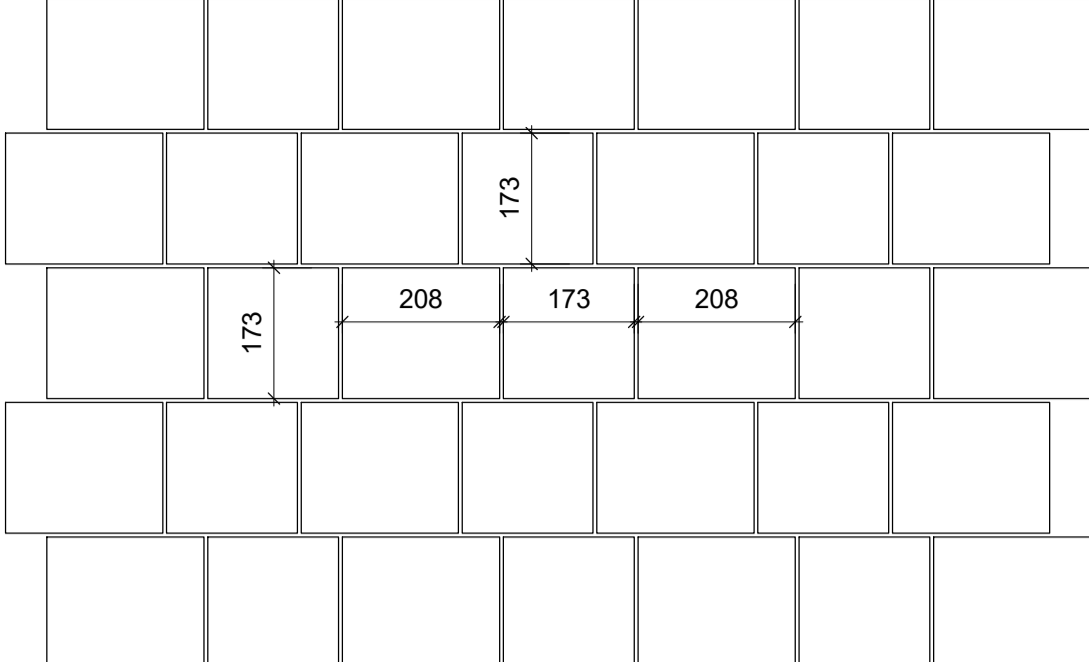

P3 & P5 Permeable Block Paving - Stretcher bond  
1 : 10

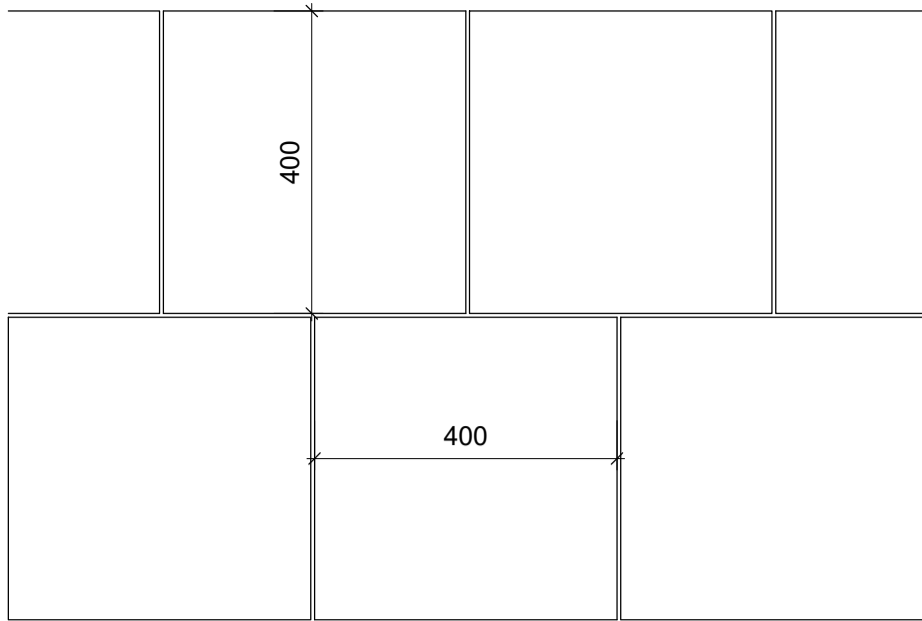

P4 - Permeable Flag Paving - Stretcher bond  
1 : 10

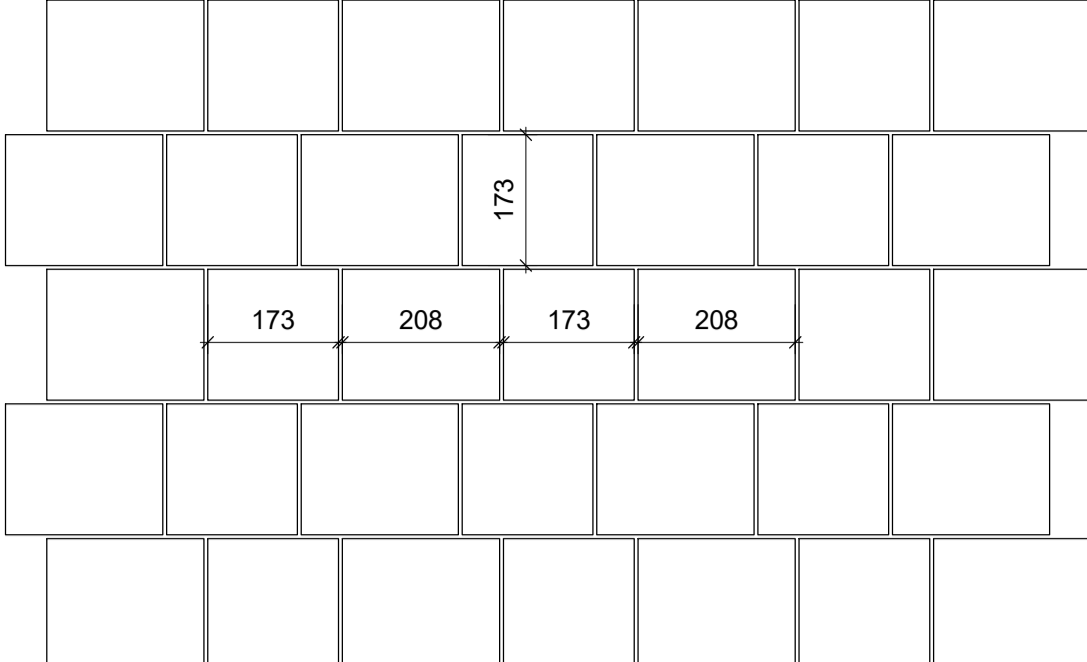

P6 - Block Paving - Stretcher bond  
1 : 10

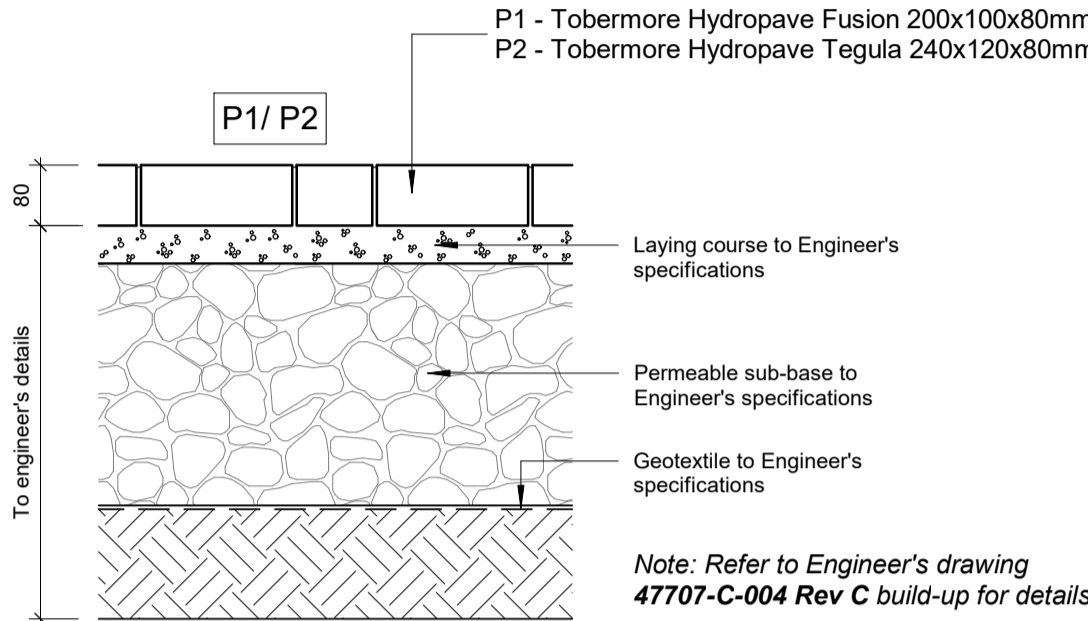

1 | P1 & P2 - Typical Detail  
1 : 10

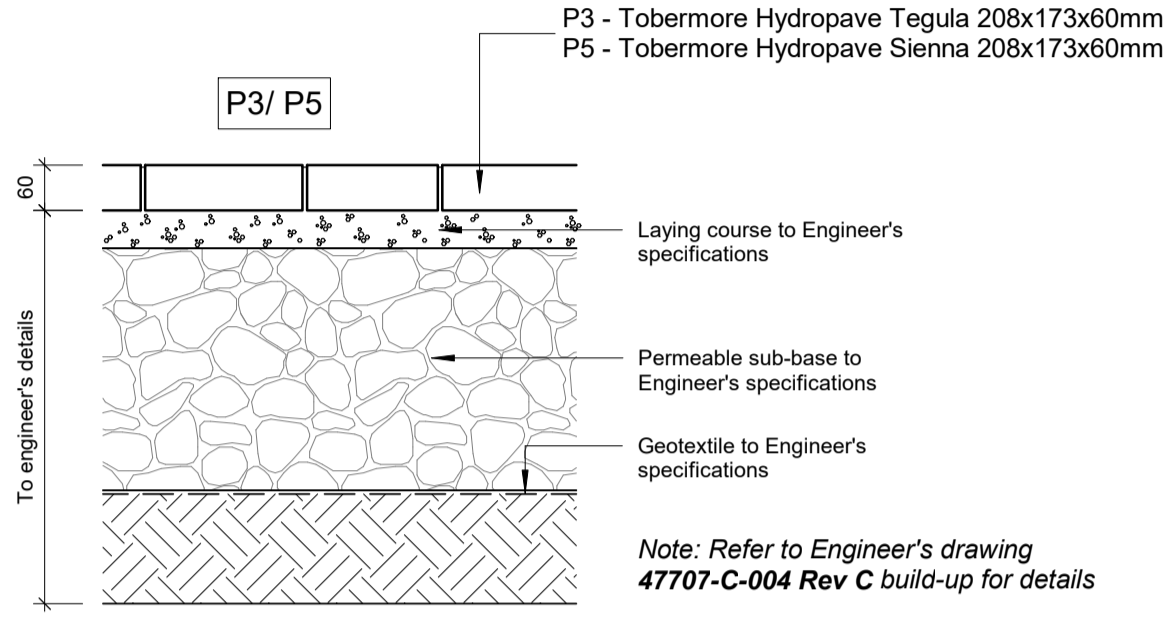

2 | P3 & P5 - Typical Detail  
1 : 10

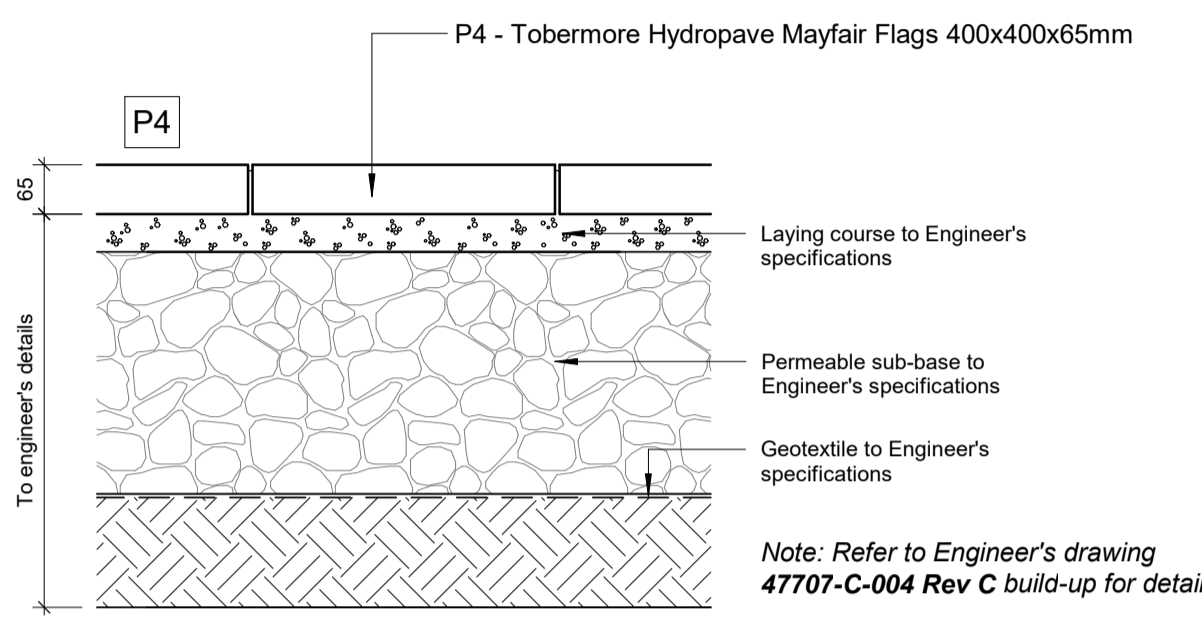

3 | P4 - Typical Detail  
1 : 10

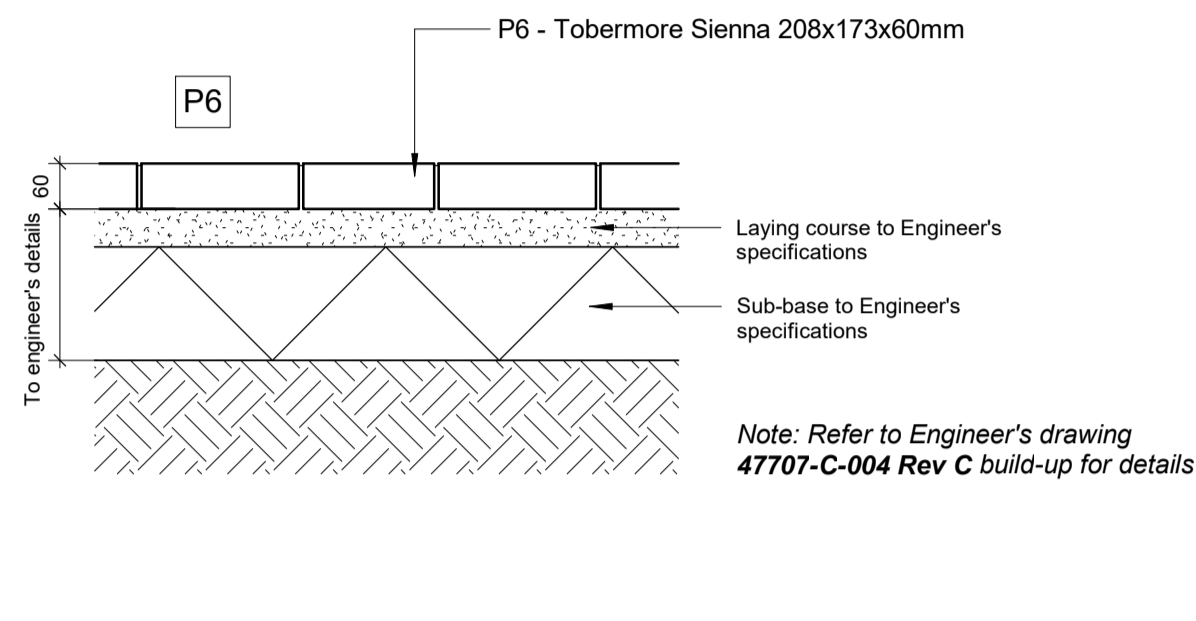

4 | P6 - Typical Detail  
1 : 10

The contractor is responsible for checking dimensions, tolerances and references. Any discrepancy to be verified with the Architect before proceeding with the works. Where an item is covered by drawings to different scales the larger scale drawing is to be worked to.

Do not scale drawing. Figured dimensions to be worked to in all cases.

CDM REGULATIONS 2015. All current drawings and specifications for the project must be read in conjunction with the Designer's Hazard and Environment Assessment Record

All intellectual property rights reserved.

- GENERAL NOTES**
- This drawing is to be read in conjunction with the written specification, if provided and all relevant contract documentation from the design team, with any conflicting information to be brought to the attention of PRP in writing before commencing on site.
  - The contractor is to check and verify all levels and dimensions before construction. Any discrepancies are to be brought to the attention of PRP in writing before commencing on site.
  - All bases, sub bases and all foundations to Engineers design. Information given here is indicative only.
  - Waterproofing of any element to be specified by others, unless specifically noted.
  - All proprietary products shall be installed in accordance with manufacturers written instructions.
  - Plant numbers are an indication only and plants should be ordered to suit site areas in accordance with scheduled plant densities.
  - Any proposed plant substitution shall be agreed with the Landscape Architect prior to ordering.
  - Samples of all exterior metal work to be approved by Landscape Architect.
  - All drainage inspection chambers to Engineers requirements.
  - All dimensions in mm unless otherwise stated.
  - Do not scale from this drawing.
  - All levels to suit site conditions and to accord with engineer's drawings.
  - Lighting to Engineers layout and detail.
  - Water points to Engineer's detail.

- NOTE:**
- All sub-base and concrete design to Engineer's details and specifications. Refer to Richard Jackson's drawing '47707-C-004' Rev C for details
  - All levels to suit site conditions and to accord with Richard Jackson drawings.
  - The engineer to design all foundation details.
  - Refer to GA Plan AL4796C - 3101 & 3102 for paving type location.
  - Refer to Planting Plan AL4796C - 3201 & 3202 for planting details.
  - Refer to Arboricultural Method Statement for works around existing trees.

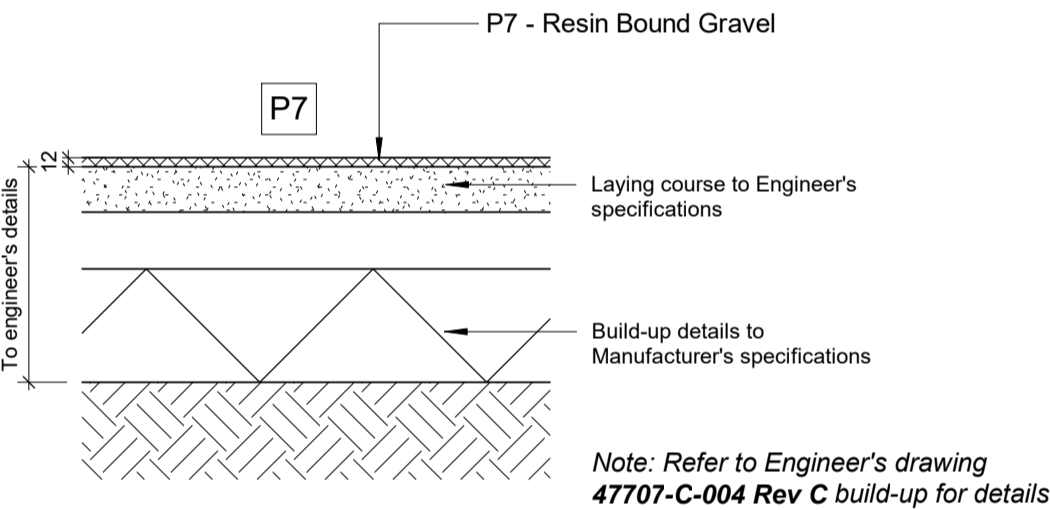

5 | P7 - Paving Detail  
1 : 10

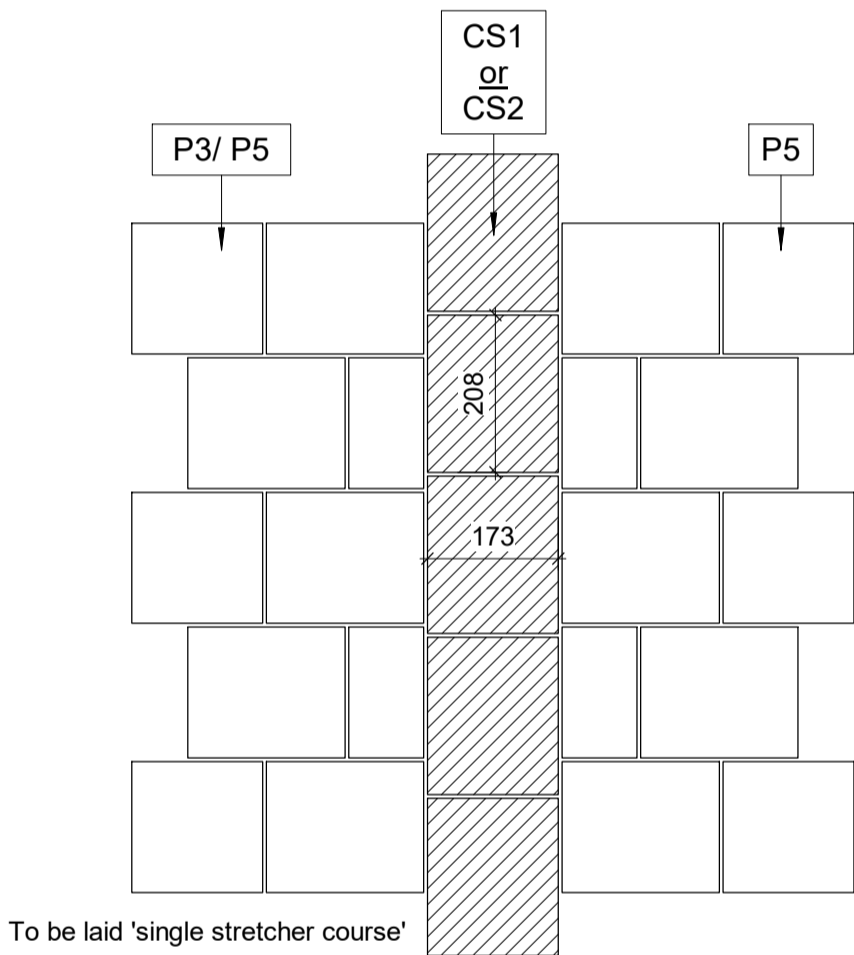

P3/CS1/P5 & P5/CS2/P5 - Interface detail  
1 : 10

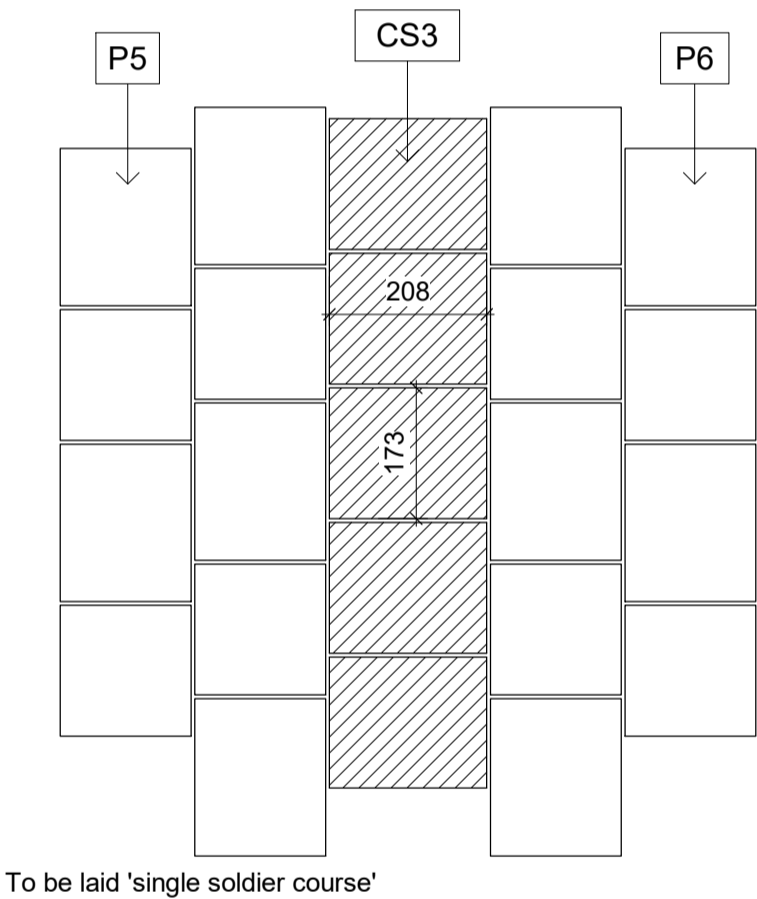

P5/CS3/P6 - Interface detail  
1 : 10

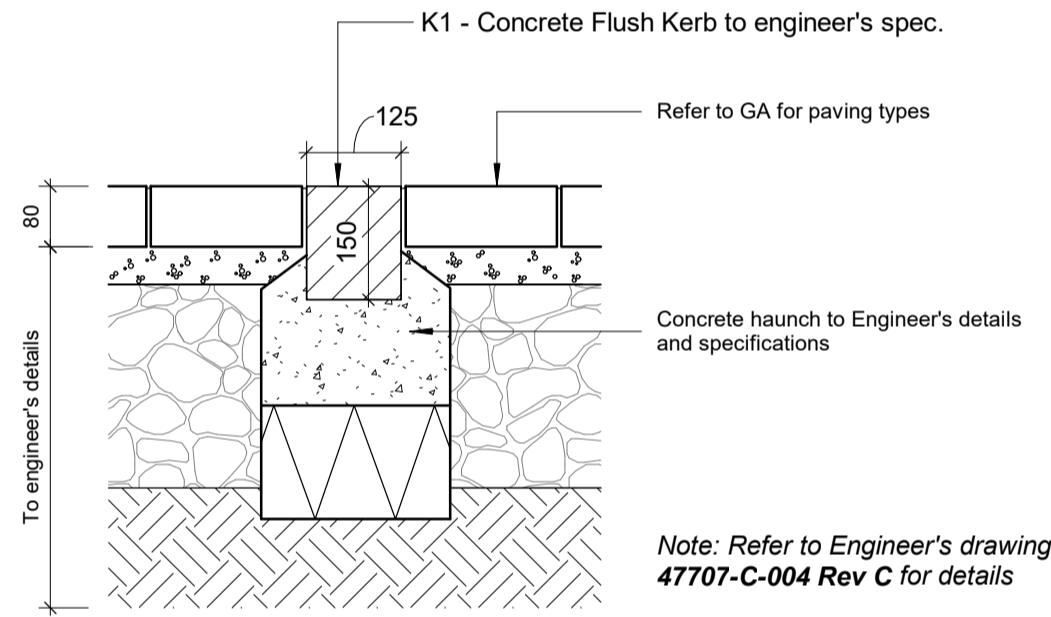

9 | K1 - Typical Kerb Detail  
1 : 10

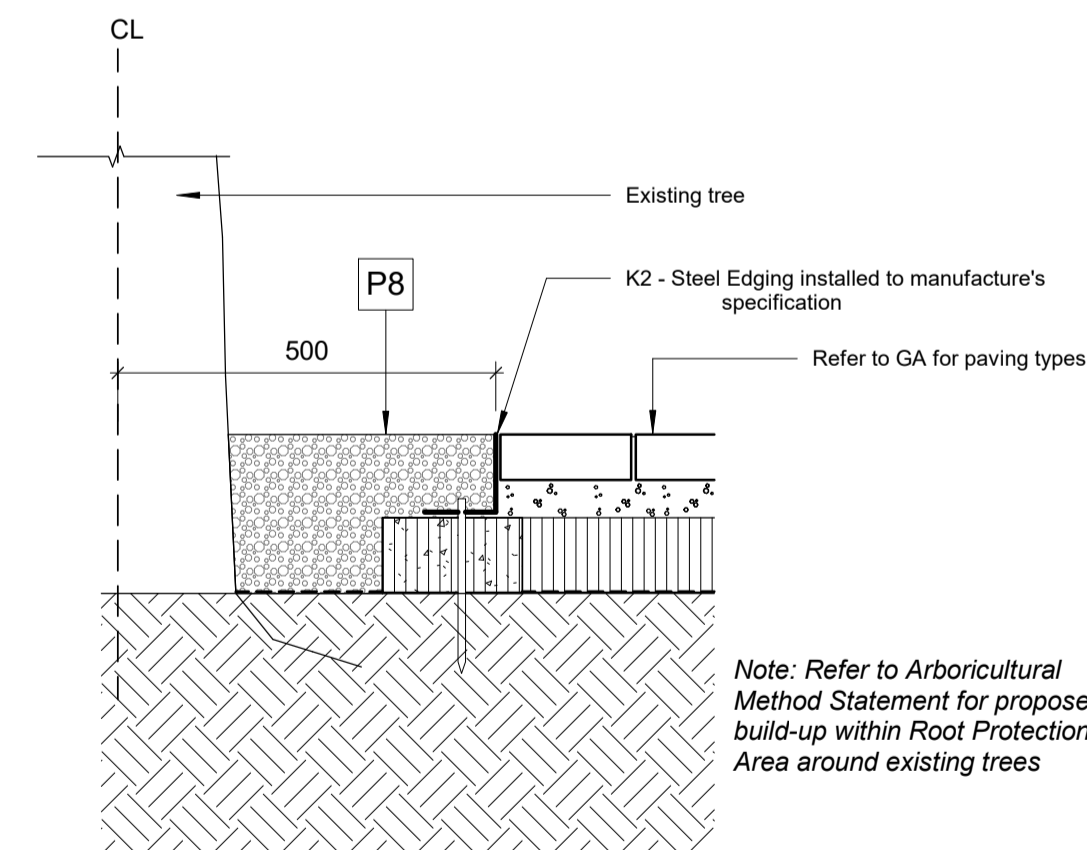

6 | No-Dig Tree Surround (Existing Trees)  
1 : 10

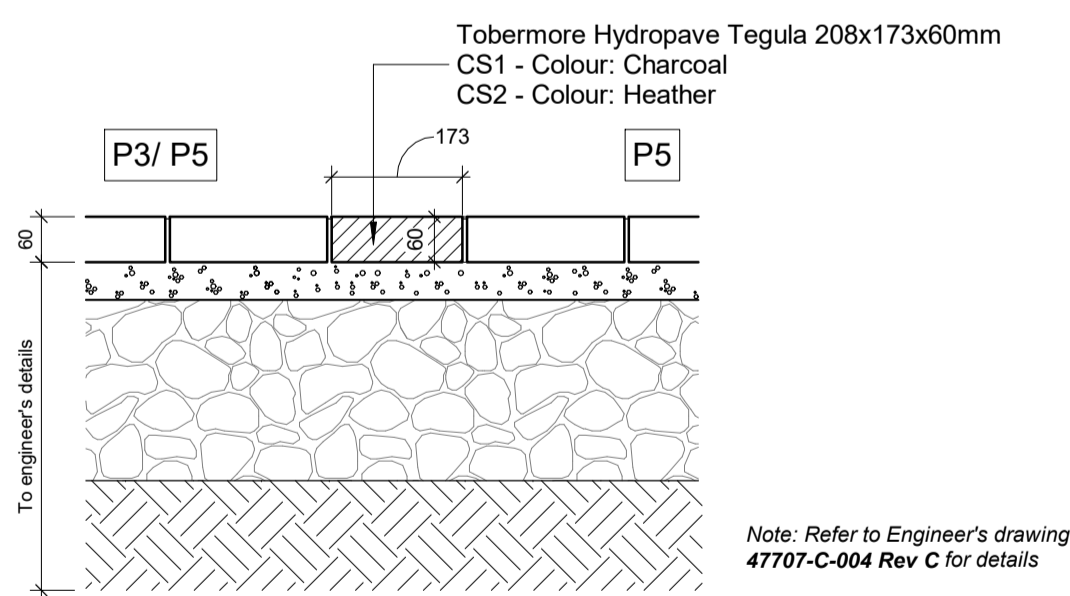

7 | CS1 & CS2 - Typical Edging Detail  
1 : 10

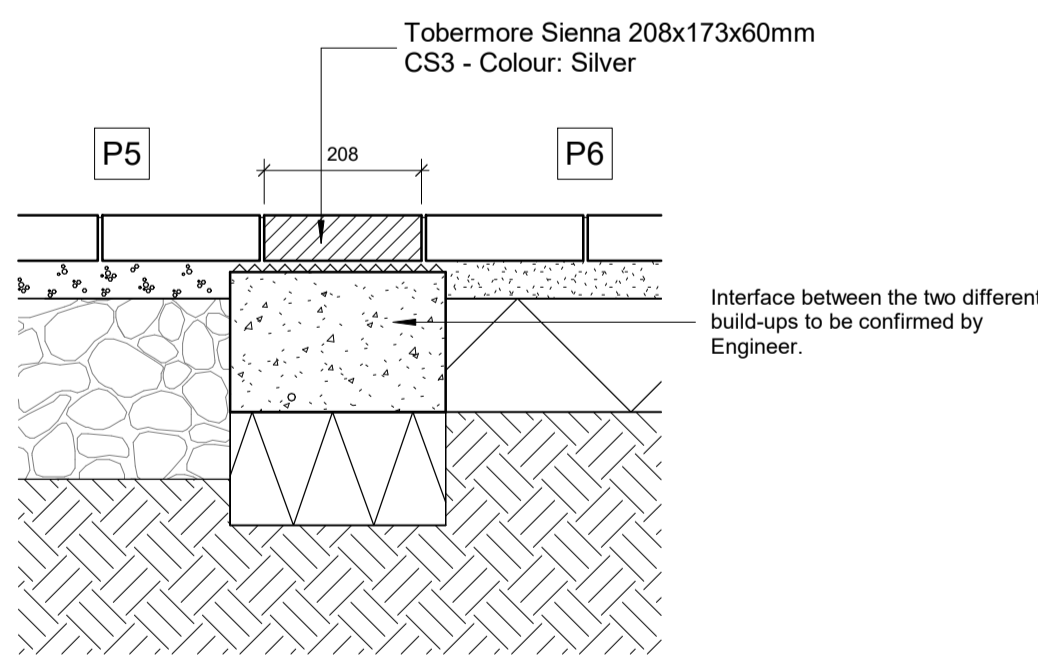

8 | CS3 - Typical Edging Detail  
1 : 10

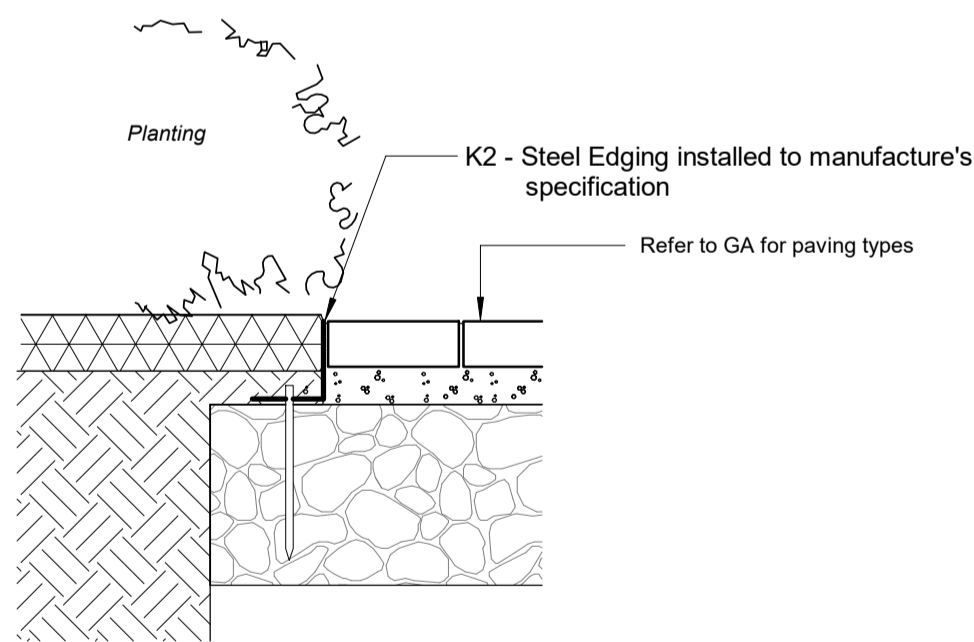

10 | K2 - Typical Kerb Detail  
1 : 10

Rev	Date	Description	ZE	BS	Dwn	Ckd
-----	------	-------------	----	----	-----	-----

**CHARLIE RATCHFORD**  
Typical Paving Interface Details

**AL4796C-3401** **REV -**

Preliminary Construction

Drawn ZE Checked BS Date 12/10/19 Scale @ A1 1 : 10

**PRP**  
prp-co.uk  
London  
020 7653 1200