

Simon Pryce Arboriculture

Client:
Afsaneh Knight

Site:
40A Primrose Gardens, London,
NW3 4TP

Title:
Tree survey - existing site

Date: 3 December 2019

Ref: 19/092

Rev:

Scale: 1:100 at A4

CP House,
Otterspool Way,
Watford,
WD25 8HP
tel 01923 467600
info@simonpryce.co.uk
www.simonpryce.co.uk

Original drawing:
Kris Bela

Root protection areas [RPAs] are colour coded according to retention category from BS5837:2012, Trees in relation to demolition, design and construction:

A = green

B = blue

C = grey

U = red - dashed - also used to denote dead trees with no RPA

Tree protection = mid blue

Crown spreads = mid green

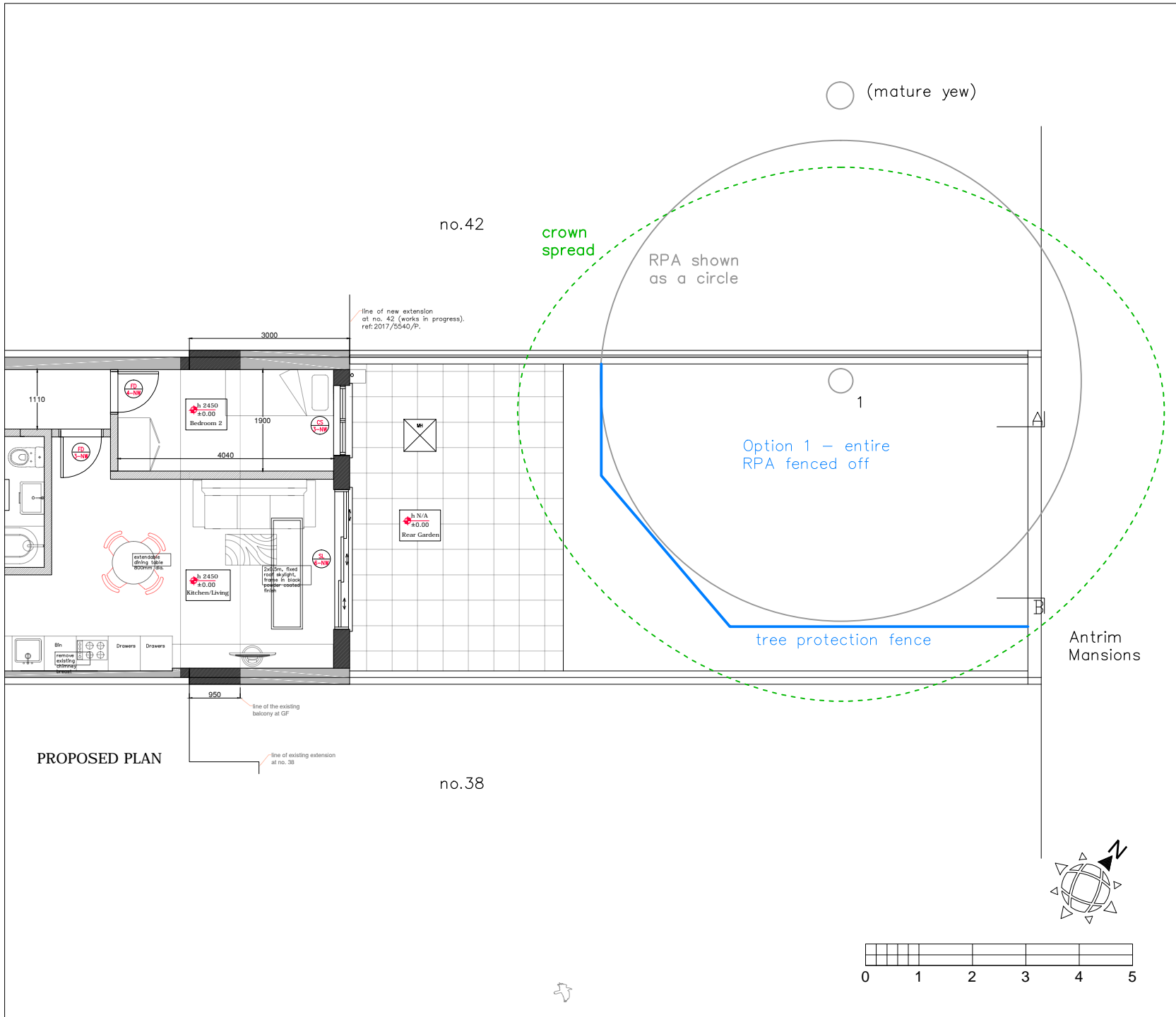

Simon Pryce Arboriculture	
Client: Afsaneh Knight	
Site: 40A Primrose Gardens, London, NW3 4TP	
Title: Tree survey - proposed site and tree protection plan (TPP)	
Date: 3 December 2019	
Ref: 19/092	Rev:
Scale: 1:100 at A4	
CP House, Otterspool Way, Watford, WD25 8HP tel 01923 467600 info@simonpryce.co.uk www.simonpryce.co.uk	
Original drawing: Kris Bela	
Root protection areas [RPAs] are colour coded according to retention category from BS5837:2012, Trees in relation to demolition, design and construction:	
A = green	
B = blue	
C = grey	
U = red - dashed - also used to denote dead trees with no RPA	
Tree protection = mid blue	
Crown spreads = mid green	

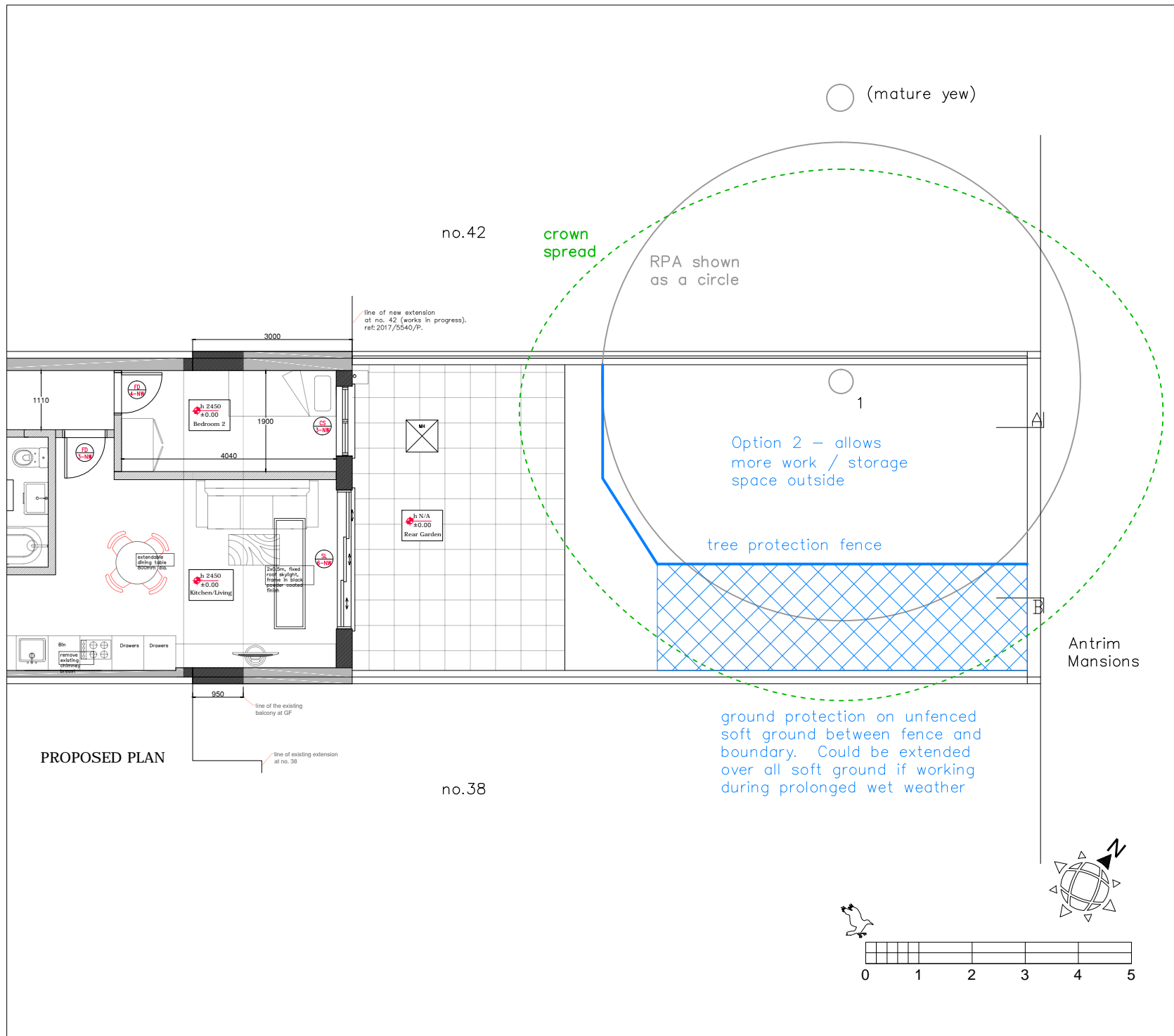

Simon Pryce Arboriculture

Client:
Afsaneh Knight

Site:
40A Primrose Gardens, London,
NW3 4TP

Title:
Tree survey - proposed site and
tree protection plan 2 (TPP2)

Date: 3 December 2019

Ref: 19/092

Rev:

Scale: 1:100 at A4

CP House,
Otterspool Way,
Watford,
WD25 8HP
tel 01923 467600
info@simonpryce.co.uk
www.simonpryce.co.uk

Original drawing:
Kris Bela

Root protection areas [RPAs] are colour coded according to retention category from BS5837:2012, Trees in relation to demolition, design and construction:

- A = green
- B = blue
- C = grey
- U = red - dashed - also used to denote dead trees with no RPA
- Tree protection = mid blue
- Crown spreads = mid green