

BS 5837: TREE CATEGORY GUIDE

Category U: Unsuitable for retention, trees with less than 10 years life expectancy.

Category A: high quality trees, able to make a substantial contribution for at least 40 years, normally retained unless there is an over-riding reason for removal and appropriate mitigation.

Category B: moderate quality trees, able to make a significant contribution for at least 20 years, normally retained.

Category B/C: an intermediate category between categories B and C (not specifically described in BS5837). Trees, which should be retained wherever possible, providing retention does not significantly constrain the layout.

Category C: low quality, in adequate condition to remain for at least 10 years, or young trees <150mm stem diameter. Trees which can be removed to allow the desired layout or new planting.

APPENDIX A

Key

- Category U
- Category A
- Category B
- Category C
- Crown spread: retained trees
- Trees For Removal
- Root Protection Area
- BS 5837 Shade Area
- No Dig Construction

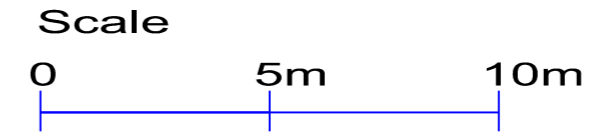
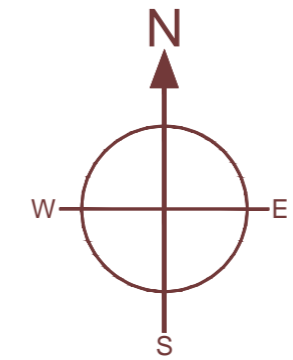

If T1 is retained, will need No-Dig construction in this area. New build will cover 17% of the RPA which is less than the 20% max recommended

BS58837 Shade Area - area in which shading of living accommodation may affect sustainability of trees ie. need to justify why future owners would not pressurise to remove/reduce the tree.

Proposed new build (in orange)

Existing shed (in grey)

1.6m brick boundary wall- foundations will be restricting root growth, so have offset RPAs by 20% away from wall

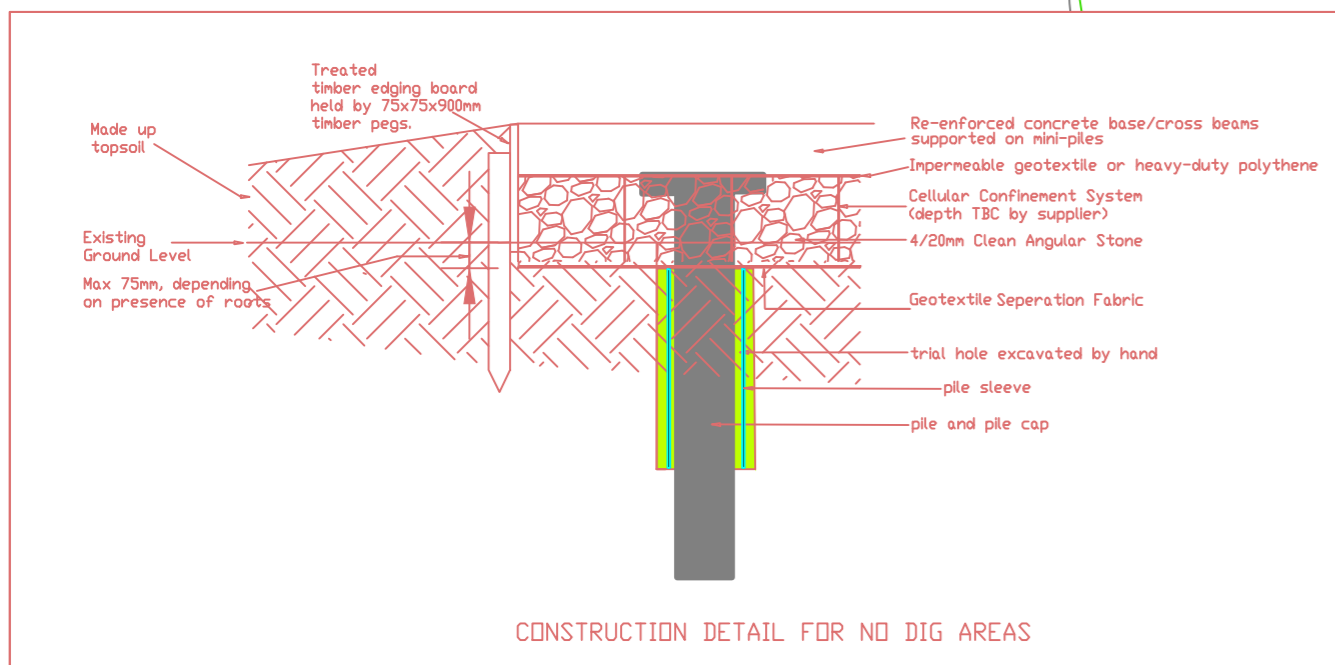

SJ Stephens Associates
 Savernake Barn, Stokke Common
 Great Bedwyn
 Marlborough
 Wiltshire SN8 3LL
 01672 871862
 www.sjstephens.co.uk

JOB TITLE
 109a ISLIP ROAD

DRAWING TITLE
 TREE CONSTRAINTS PLAN

DRAWING NUMBER 1380-01	REV
---------------------------	-----

REVISIONS

SCALE 1:150 at A2	DATE JUL 19	DRAWN BY sjss
----------------------	----------------	------------------