

8011-05,
Plan Details
Scale: 1:2

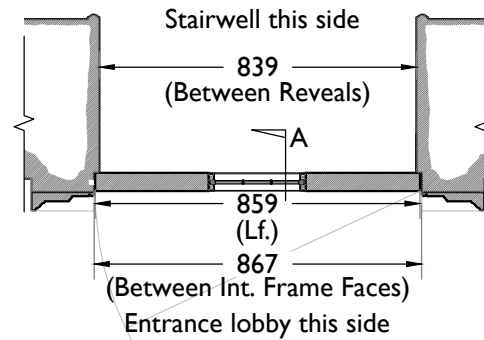

8011-01, Plan, Scale 1:20

8011-06,
Section AA Details
Scale: 1:2

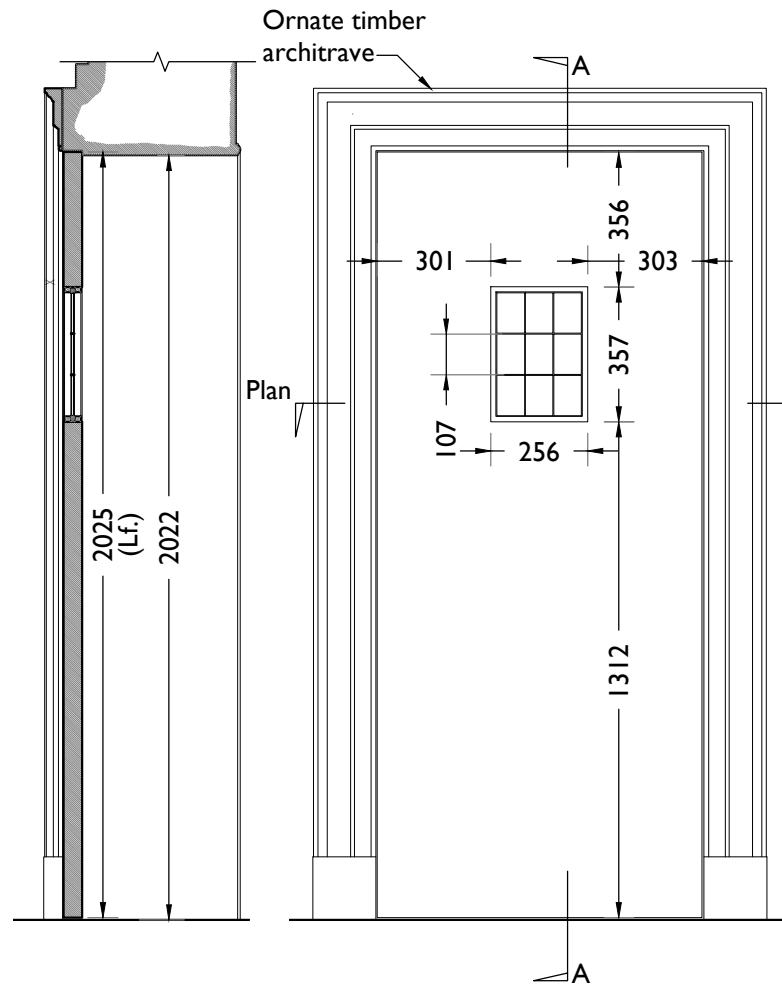
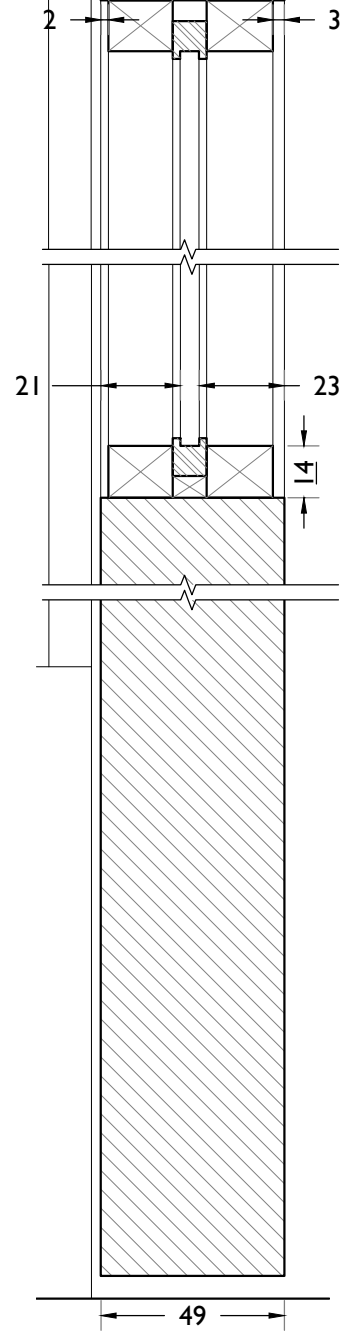

8011-02,
Section AA
Scale: 1:20

8011-03,
Elevation viewed from lobby side
Scale: 1:20

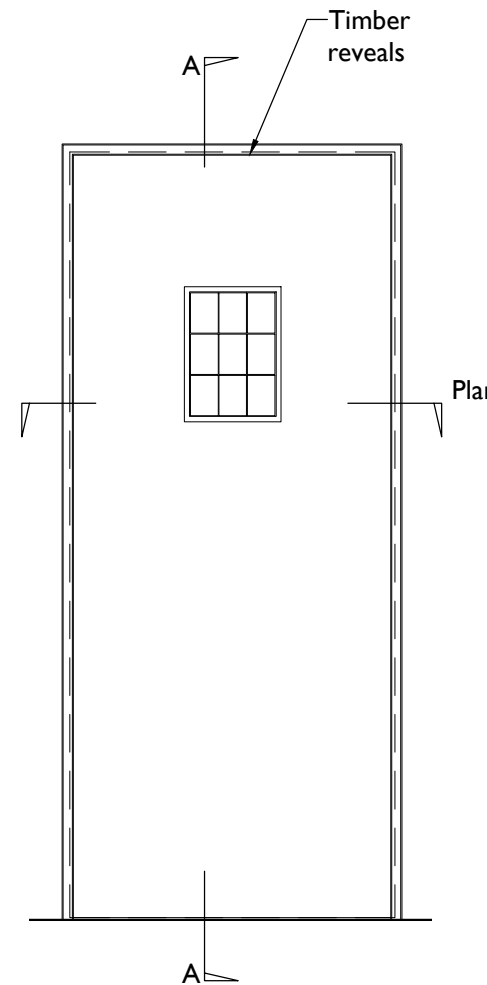

8011-04,
Elevation viewed from stairwell side
Scale: 1:20

E09 Specification Notes

This drawing must be read in conjunction with the general notes on drawing 8040.

These notes are for the construction of replica doors that have no fire requirement. If door has fire requirement see 8040 notes. Generally replicate the existing door after surveying it on site. This drawing indicates the general details of the existing door type but must not be used as a fabrication drawing. The contractor must use its expertise to produce accurate shop drawings.

Material: To match existing

Finish: To match existing colour and texture as closely as possible. Allow for 6 samples of 200mm x 200mm Oak panel to be stained and varnished to enable colour and texture of existing to be matched. In the first instance, produce two samples and notify the architect when complete to arrange inspection. After inspection further samples may be required to achieve the closest match possible.

Glazing: Use salvaged copper framed, 9 pane glazing unit from existing doors where they are available.

Provide alternative price for a new replica copper light. This is available to order from specialist manufacturers such as Cheam Leaded Lights Limited. New units should use safety glass in accordance with BS 6262: Part 4: 1994 but with consideration of the historic nature of the building with regard to dispensation for visible markings. (<https://www.cheamleadedlights.com/copper-lights/>)

Action: Door opens in one direction only.

Door Handle: to match original brass pull handle. Refurbish existing and reuse if possible. In the event of salvage being impossible a replica will be required.

Lock: Provisionally allow for supply and installation of high security five lever mortice deadlock case and escutcheons in polished brass finish.

Hinges: 3x Polished brass butt hinge - double phosphor bronze washered to mach size of existing hinges.

Electronic Security: Please see the *Hoare Lea* security design package for electronic locking requirements and specifications for each door. Please note that these requirements are also outlined on the door schedule. However, the door schedule should not be relied upon on its own as the security design package contains the key design and specification information describing the required installation.

Closer (not fire rated): Please see door schedule to establish which doors require a closer. Where a closer is required on a non fire rated door it will be the Abloy DC330 (Brass finish) and associated items required for full installation.

| <p>Notes:</p> <p>Drawings are based on survey data and may not accurately represent what is physically present.</p> <p>Do not scale from this drawing. All dimensions are to be verified on site before proceeding with the work.</p> <p>All dimensions are in millimeters unless noted otherwise.</p> <p>Purcell shall be notified in writing of any discrepancies.</p> | - | <p>P00 18 Dec 2019</p> | <p>CLIENT Lendlease</p> | <p>DRAWING TITLE Details of Existing Door Type E09 This existing door is DEG.01-9</p> | <p>JOB NUMBER 238664</p> | | | | | | | | | |
|---|------|---|--|--|--|---------|-------------|--|--|--|--|--|---|----------------------------|
| | | <p>First Issue 27 Sep 2019 RH RH</p> | <p>PROJECT Camden Town Hall</p> | <p>SIZE & SCALE A3L As Noted</p> | <p>DRAWING NO. CTH-PUR-XXX-DR-31-A-8011</p> | | | | | | | | | |
| | | <table border="1"> <thead> <tr> <th>ISSUE</th> <th>DATE</th> <th>DRAWN</th> <th>CHECKED</th> <th>DESCRIPTION</th> </tr> </thead> <tbody> <tr> <td></td> <td></td> <td></td> <td></td> <td></td> </tr> </tbody> </table> | ISSUE | DATE | DRAWN | CHECKED | DESCRIPTION | | | | | | <p>DRAWING STATUS ISSUED FOR LBC</p> | <p>REVISION P00</p> |
| ISSUE | DATE | DRAWN | CHECKED | DESCRIPTION | | | | | | | | | | |
| | | | | | | | | | | | | | | |

