

NOTES:

- 1) ALL PIPEWORK TO BE PRESSURE TESTED AND FLUSHED IN ACCORDANCE WITH CIBSE COMMISSIONING CODES, BS7448 AND OTHER INDUSTRY STANDARDS AND REGULATIONS APPLICABLE.
- 2) ADEQUATE FLUSHING AND CHLORINATION POINTS TO BE INSTALLED AS REQUIRED BY THE WATER TREATMENT COMPANY.
- 3) ALL PIPEWORK TO BE LABELLED & INSULATED IN MINERAL WOOL INSULATION. THE THERMAL PROPERTIES OF THE INSULATION SHOULD AT LEAST COMPLY WITH THE REQUIREMENTS OF THE BUILDING REGULATIONS. PIPEWORK SHALL BE LABELLED IN LINE WITH BS 5970.
- 4) DRAIN COCKS ARE TO BE INSTALLED AT SYSTEM LOW POINTS.
- 5) AIR VENTS ARE TO BE INSTALLED AT SYSTEM HIGH POINTS.
- 6) PIPEWORK SERVICES PENETRATING THROUGH FIRE WALL, TO BE ADEQUATELY SLEEVED & FIRE STOPPED TO ENSURE THE INTEGRITY OF THE COMPARTMENT. FIRE WALLS ARE AS DENOTED ON ARCHITECTS DRAWINGS.
- 7) ACCESS PANELS TO BE INSTALLED NEAR ANY VALVES TO ALLOW FUTURE MAINTENANCE.
- 8) THIS DRAWING TO BE ROUTED AS SHOWN AND BE READ IN CONJUNCTION WITH ALL RELEVANT ARCHITECT / INTERIOR DESIGNER / STRUCTURAL / MECHANICAL & ELECTRICAL ENGINEERS DRAWINGS & SPECIFICATIONS.

LEGEND

CS	COMMISSIONING STATION
IV	ISOLATION VALVE
STR	STRAINER
DC	DRAIN COCK
4-FV	4-PORT VALVE
IV (N/C)	ISOLATION VALVE (NORMALLY CLOSED)

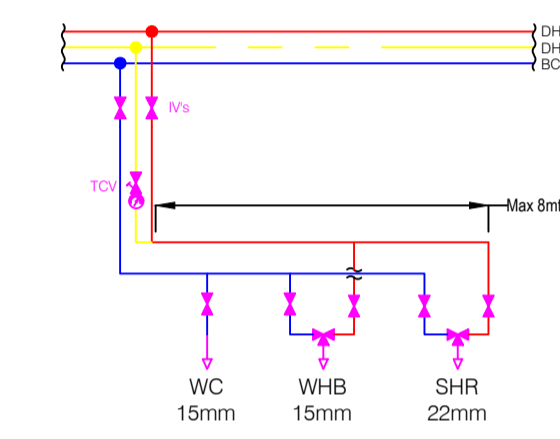

DETAIL 'A'
CONNECTION TO BATHROOM SERVICES
REFER TO INTERIOR / ARCHITECT LAYOUT

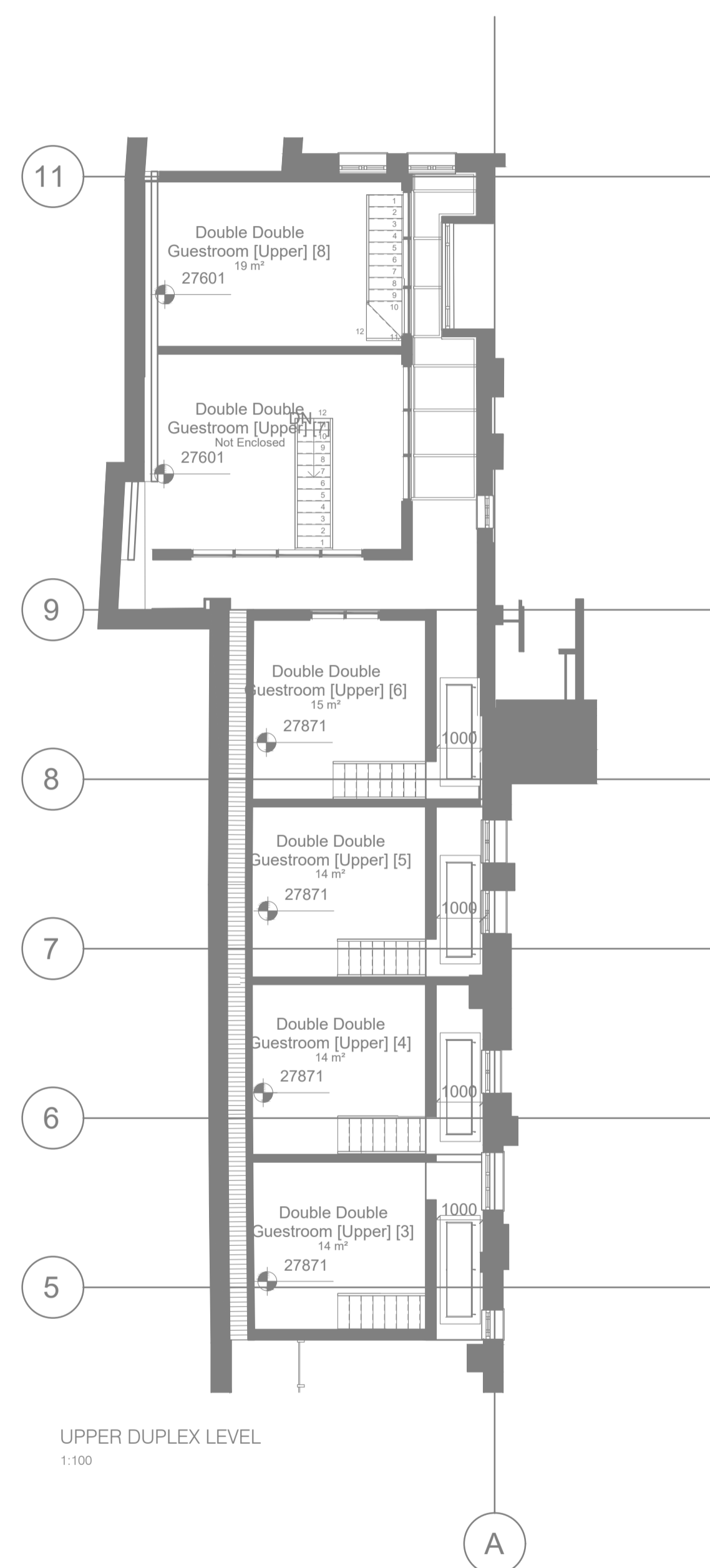

NEW MAINS DOMESTIC HOT, RETURN AND BOOSTED COLD WATER CONNECTION TAKEN FROM BASEMENT PLANTROOM.

REV	DATE	COMMENTS
DRAWING STATUS		
PLANNING		
PROJECT		
DOUBLETREE BY HILTON LONDON, WEST END		
CLIENT		
CRIMSON HOTELS		
IN ASSOCIATION WITH		
MORRISON DESIGN		
DRAWING TITLE		
PHASE 4 GROUND FLOOR DOMESTIC SERVICES LAYOUT		
HBS HOCKLEY BUILDING SERVICES LIMITED		
Holly House, 9-11 Holly Lane, Marston Green, Birmingham B37 7AP 0121 685 4545 0121 685 4546 admin@hockley-ltd.com		
DRAWN BY	CHECKED BY	APPROVED BY
JB	TM	TM
START DATE	SCALE	DRAWING SIZE
13.12.19	1:100	A1
JOB No.	DRAWING No.	REVISION
5097	M16-L00-01	-

Plan View
Scale 1:100