

MATERIALS SPECIFICATION

EXISTING BUILDING REPAIRS

1. GENERALLY, ALL REPAIRS TO USE TRADITIONAL MATERIALS AND DETAILS TO MATCH EXISTING ELEMENTS
2. RETAINED FACADES ARE TO BE REPAIRED.
 - BROKEN/DAMAGED BRICKS AND
 - BROKEN AND DAMAGED TERRACOTTA/FAIENCE AND STONEMORY TO BE REPLACED
 - MASONRY TO BE CLEANED AND WHERE NECESSARY, REPOINTED
 - LEAD FLASHINGS TO BE REPLACE
 - REMOVAL OF ALL NON ORIGINAL CABLING AND SERVICES
 - RAINWATER GOODS TO BE REPLACED WITH NEW CAST IRON PIPES AND HOPPERS
3. EXISTING ROOF FINISHES TO BE REPLACED WITH NATURAL WELSH SLATE AND LEAD WEATHERINGS
4. EXISTING WINDOWS AND FRENCH DOORS TO BE REPLACED WITH PAINTED HARDWOOD CASEMENT WINDOWS WITH SLIMLINE SEALED DOUBLE GLAZED UNITS
5. DORMER WINDOWS TO BE REPAIRED AND REDECORATED

EXISTING BUILDING ALTERATIONS AND ADDITIONS

1. ALL ALTERATIONS AND ADDITIONS TO USE TRADITIONAL MATERIALS AND DETAILS TO MATCH EXISTING ELEMENTS
2. FACADES TO BE IN HANDMADE RED-MULTI FACING BRICKWORK LAID IN FLEMISH BOND USING LIME MORTAR.
3. ARCHITECTURAL FEATURES TO BE IN TERRACOTTA / FAIENCE AND STONE (DEPENDING ON LOCATION) TO MATCH EXISTING
4. CAST IRON RAINWATER PIPES AND HOPPER HEADS
5. PAINTED HARDWOOD DORMER WINDOWS TO MATCH EXISTING
6. ROOF FINISH - NATURAL WELSH SLATE WITH LEAD WEATHERINGS
7. PAINTED HARDWOOD CASEMENT WINDOWS AND FRENCH DOORS WITH SLIMLINE SEALED DOUBLE GLAZED UNITS

NEW BUILDINGS

1. FACADES TO BE IN HANDMADE RED-MULTI FACING BRICKWORK LAID IN FLEMISH BOND USING LIME MORTAR.
3. ARCHITECTURAL FEATURES TO BE IN RECONSTITUTED STONE OR NATURAL STONE
4. CAST IRON RAINWATER PIPES AND HOPPER HEADS
5. HARDWOOD DORMER WINDOWS
6. ROOF FINISHES - GENERALLY HANDMADE CLAY ROOF TILES WITH LEAD TOP AND WEATHERINGS. ROOF FINISH TO FUEL SOUTH EASTERN BUILDING TO BE NATURAL WELSH SLATE WITH LEAD WEATHERINGS
7. WINDOWS TO BE SLIM STEEL FRAMED DOUBLE GLAZED UNITS, SUCH AS CRITALL OR SIMILAR
8. PAINTED HARDWOOD FRENCH DOORS WITH SLIMLINE SEALED DOUBLE GLAZED UNITS



1 PROPOSED EAST ELEVATION - GATE HOUSE
 PL-24 Scale: 1:100



2 PROPOSED NORTH ELEVATION
 PL-24 Scale: 1:100

- ACL 135.25
- 4FL 132.55
- 3FL 129.35
- 2FL 126.15
- 1FL 122.95
- GFL 119.75
- BFL 116.55



3 PROPOSED EAST ELEVATION
 PL-24 Scale: 1:100



4 PROPOSED NORTH - WEST ELEVATION
 PL-24 Scale: 1:100

- ACL 135.25
- 4FL 132.55
- 3FL 129.35
- 2FL 126.15
- 1FL 122.95
- GFL 119.75
- BFL 116.55

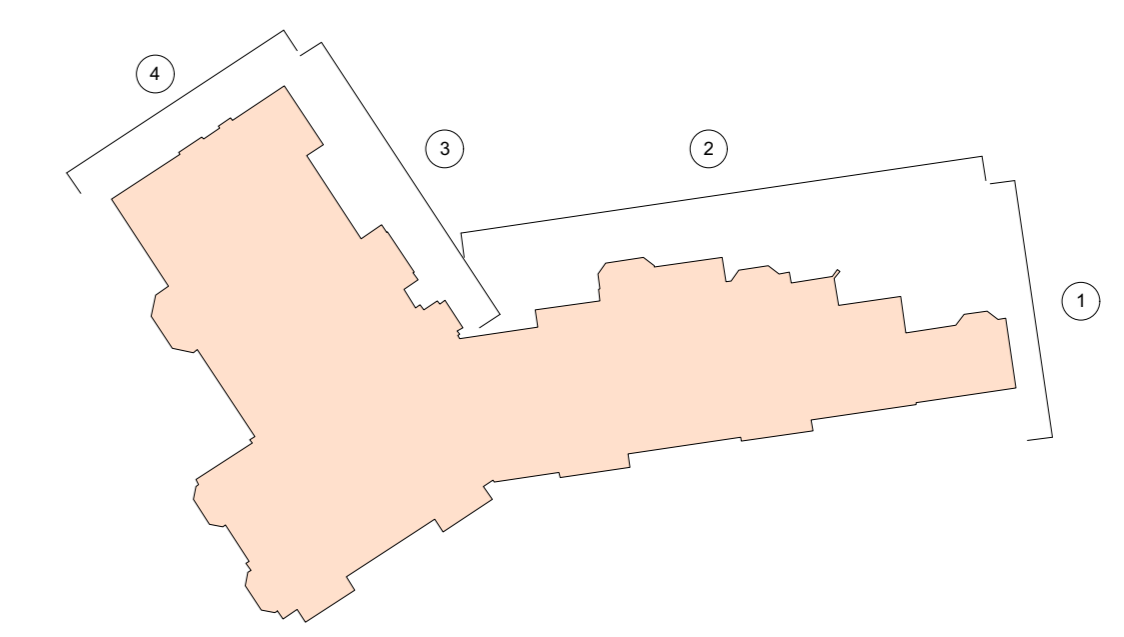

REV.	DATE	DESCRIPTION
------	------	-------------

**BRANCH HILL HOUSE
 LONDON**

PROPOSED EAST, NORTH AND
 NORTH - WEST ELEVATIONS

DRNG No	SCALE	DATE
PL-24	1:100 @ A0 1:200 @ A2	DEC 2019



5 ST JAMES'S SQUARE
 LONDON SW1Y 4JU
 T 020 7451 0955 mail@stanhopegate.co.uk
 www.stanhopegatearchitecture.com