

Detail A 1:2 @A1

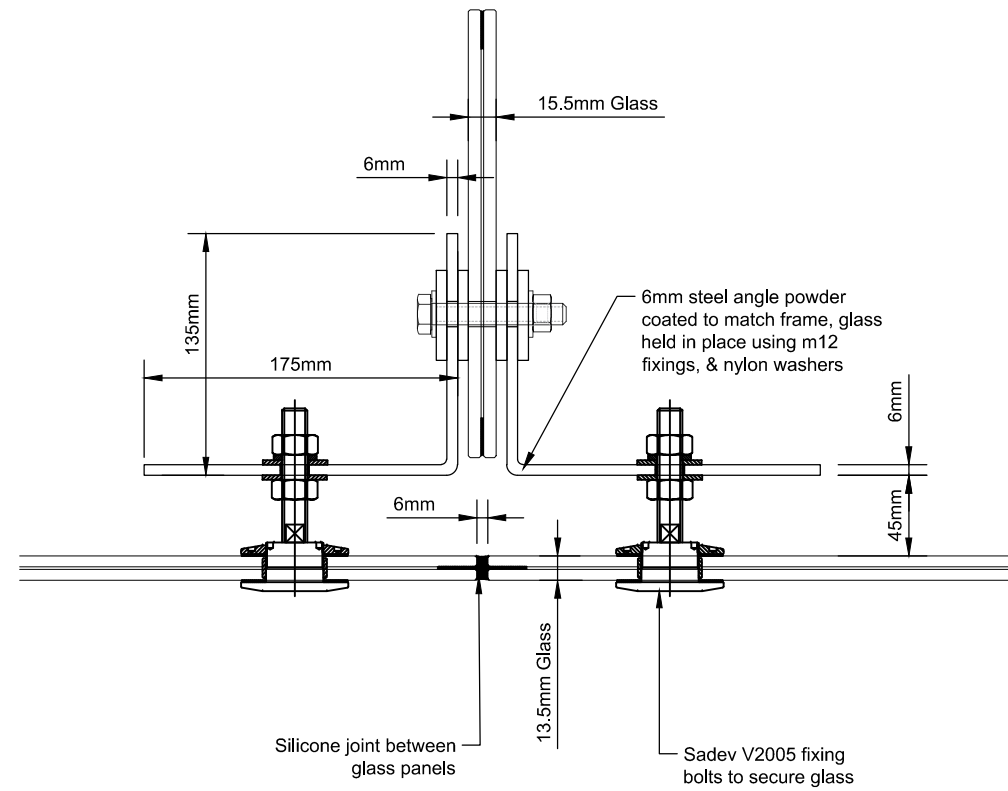

Detail B 1:2 @A1

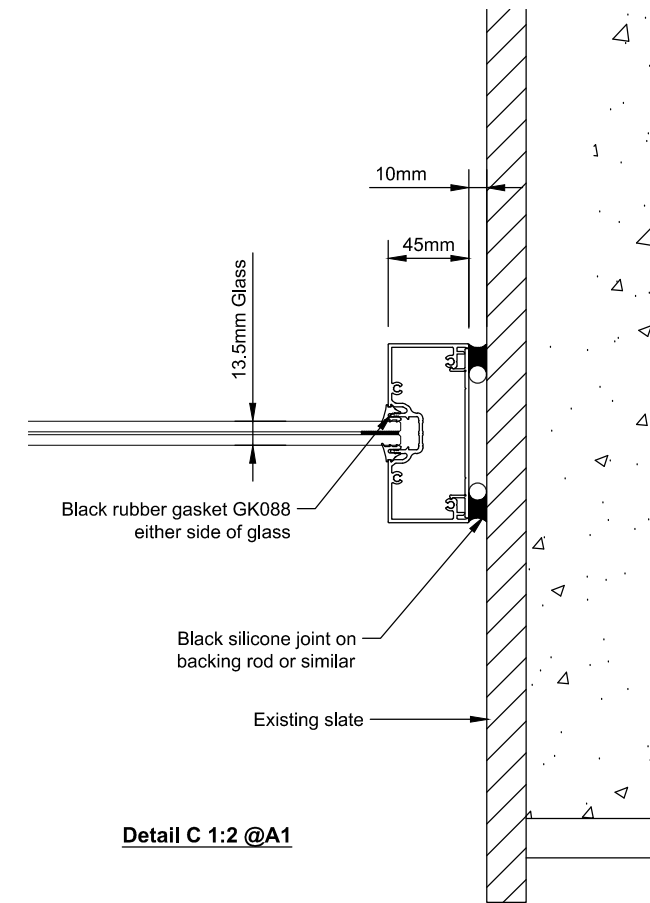

Detail C 1:2 @A1

- Notes:**
1. DIMENSIONS ALWAYS TAKE PRIORITY OVER SCALE
 2. ELEVATIONS VIEWED EXTERNALLY UNLESS STATED
 3. ALL DETAILS ARE SUBJECT TO FULL SITE SURVEYS AND/OR EXPLORATORY WORKS
 4. ALL DIMENSIONS TO BE VERIFIED ON SITE PRIOR TO MANUFACTURE. CANNON GLASS ACCEPTS NO RESPONSIBILITY FOR OTHER TRADE WORKS.

Specification:

Index: **Revision:** **Date:**

Approval

Main Contractor:
Pontsarn Investments Limited

Architect:

Site Address: 184 Tottenham Court Road
London W1T 7PD

Site Contact:
Michael Brearley

Cannon Glass
Design + Install

9 Mulberry Court, Bourne Industrial Estate, Crayford, Kent, DA1 4BF
Tel: 01322 522 382 Fax: 01322 559 868
Email: Sales@CannonGlass.com

Title/ Description:
Details A-C

Scale: 1:2 @A1 **Drawn By:** Sean Howell **Date:** 22/11/2019

Drawing No: 16996-002 **Revision:** 00