

7th

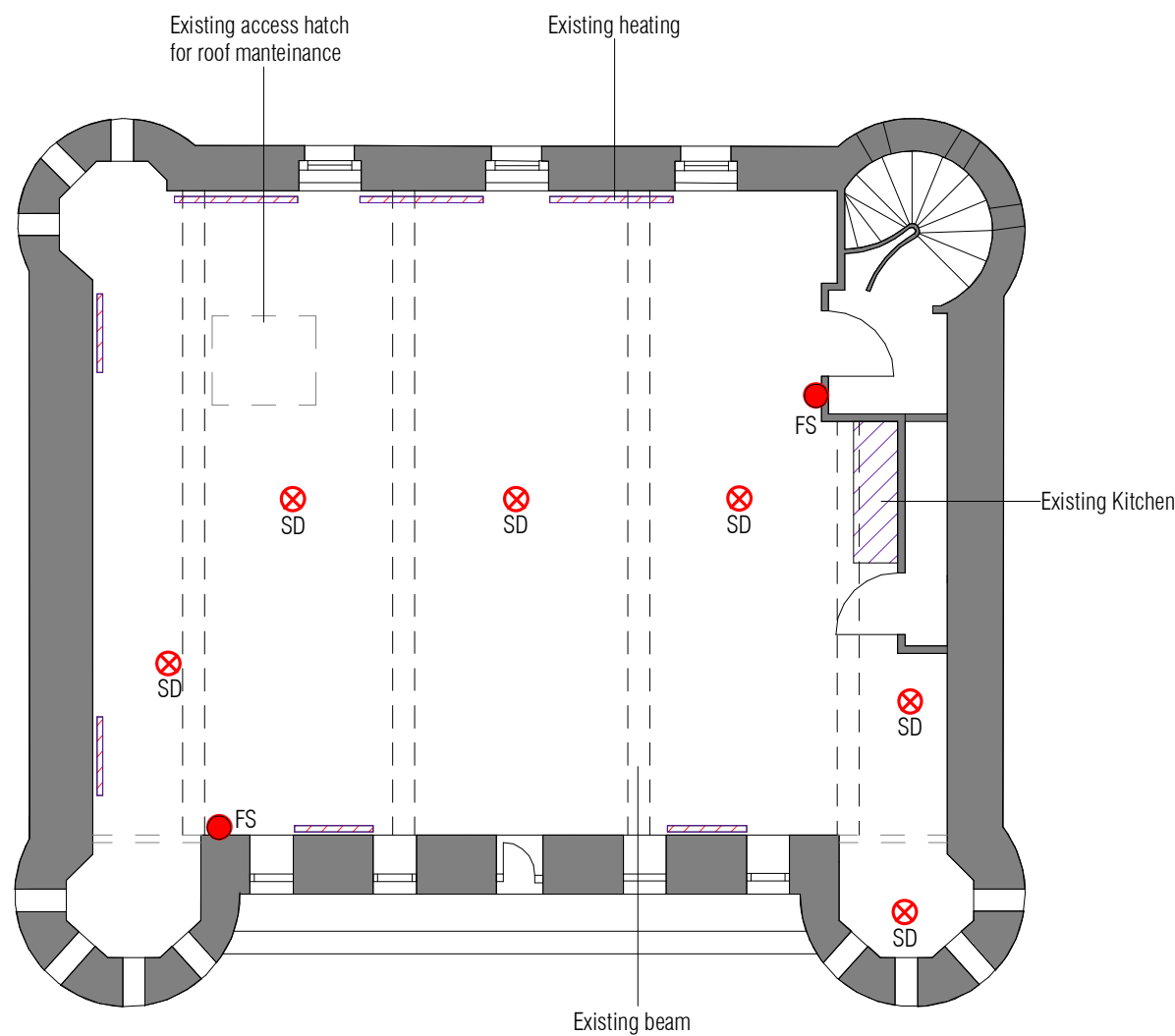

NOTES: This drawing is the exclusive Copyright of Ltb and may not be copied or handed to any Third parties without prior consent. All dimensions must be checked on site and not scaled from the drawing. All drawings and proposals are subject to approvals by statutory authorities.

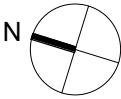
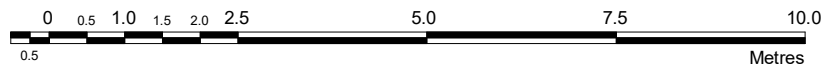

Rev	Descriptive Amendments	Drawn By	Date
Pre-Design - Construction - As Built			
CONSTRUCTION			
Client			
WeWork			
Client Contact			
Project Name			
LONDON 1 Waterhouse Sq Project 2			
Drawing Title			
7TH FLOOR - EXISTING CONDITIONS			
Arch. Technician / Senior Tech. Coordinator/ Project Manager			
GS	TB	Kristin Hoogenboom	
Scale @ A1	Drawn By	First Drawing Date	
1 : 100	GS	4/12/19	
Contract Number	Floor	Detail	Revision
1265	7th		
ltb.		WeWork, 8th Floor 10 York Road London SE1 7ND UK	