

Proposed Front Elevation

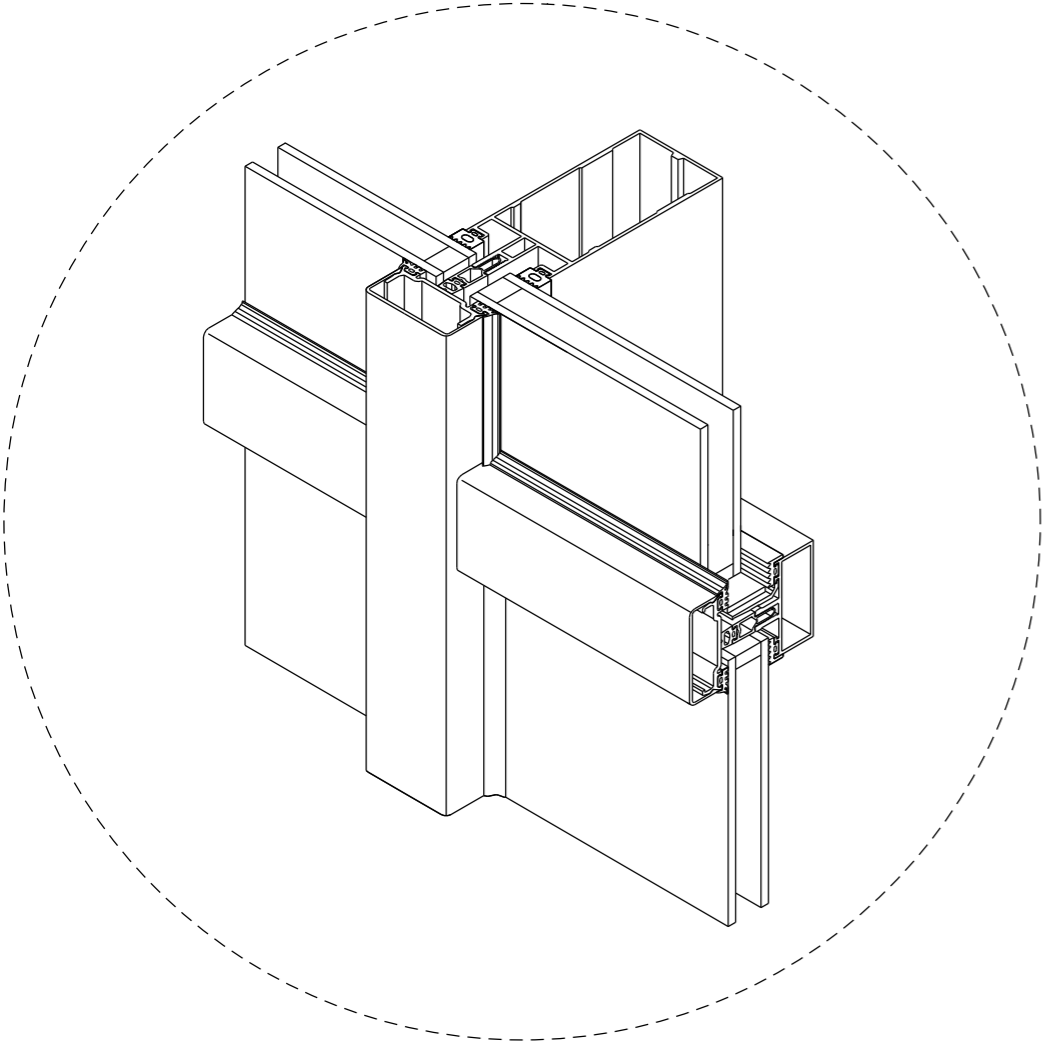

Proposed Aluminium Transom and Mullion framework

1:2

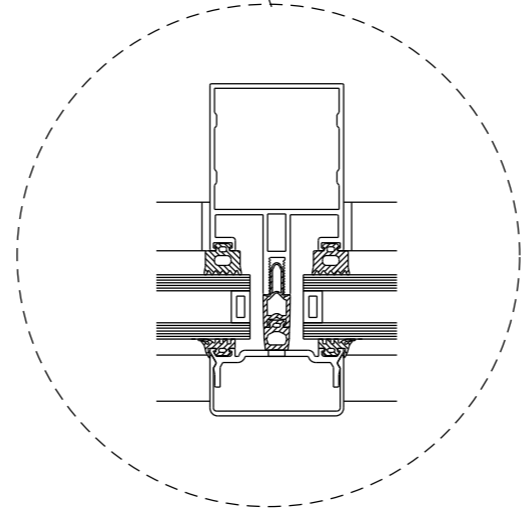

Proposed Aluminium Mullion framework

1:2

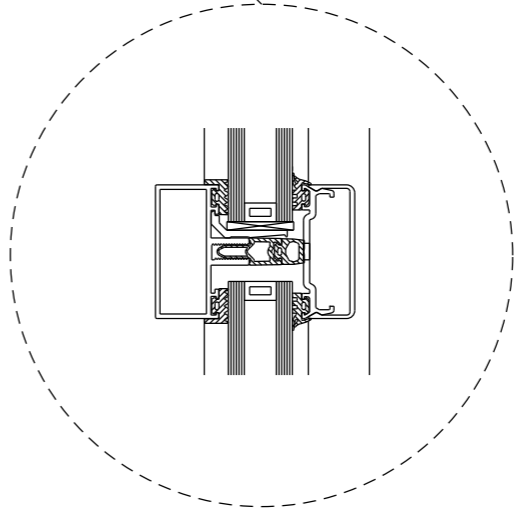

Proposed Aluminium Transom framework

1:2

Project No.	206/003		
Client	Kingsway London		
Date	Nov 2019	Scale	50@A3
Project	Hend House 233 Shaftesbury Ave London WC2H 8EE		
Drawing Title	PROPOSED Front Elevation Details		
Drawing No.	206_A100_003	Rev.	-

Copyright Studio Ag Ltd  
No implied license exists. This drawing should not be used to calculate areas for the purposes of valuation.  
All dimensions to be checked on site by the contractor and such dimensions to be their responsibility.  
All measurements have been taken as a designer's survey only. Do not scale off drawings for construction purposes.  
All setting out and measurements are subject to the constraints of permitted development or planning permission.  
All work must comply with relevant British Standards and Building Regulations requirements. Drawing errors and omissions to be reported to the architect.

Planning + Listed Building ISSUE



NORTH

15 Alexandra Road  
Windsor SL4 1JH  
01753 869122  
07876 260670  
angela@studioag.co.uk

studioag.co.uk