

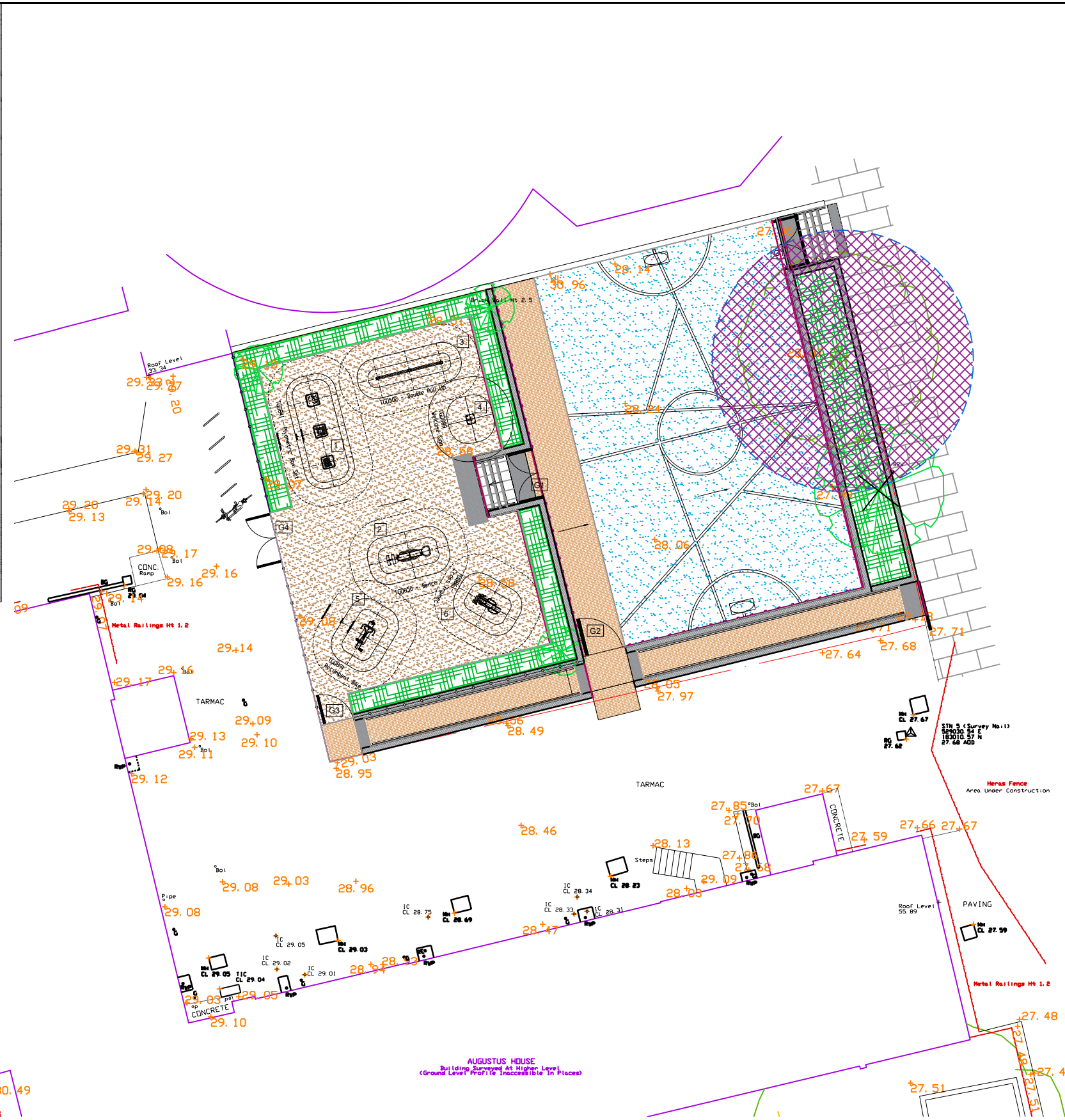



Location Plan







KEY

Existing:

-  Root protection areas
-  Hand-dig only area
-  Tree to be removed

Proposed:

-  New shrub and perennial planting in raised planters. Topsoil to BS 3882:2015 to finished levels as required.
-  New surface to MUGA: new macadam ball court surfacing with non-slip heavy duty acrylic coating and acrylic line markings.
-  Resin bound gravel to the outdoor gym area and the ramp.
-  Light buff coloured tarmac by Ullicolour or similar approved.

Notes:

- A removal of one existing tree is proposed
- Existing trees to be protected in accordance with BS 5837: 2012, Trees In Relation to Design, Demolition and Construction.
- Work within the Root Protection Area to be supervised by the landscape architect or arboriculturalist.

Rev	Description	Drawn	Check	Appr	Date

**Groundwork London**  
 12 Baron Street  
 London N1 9LL  
 Tel: 020 7239 1280  
 Fax: 020 7278 1515  
 www.groundwork.org.uk/London



Project: **HS2 Improvements**

Client: **LB Camden**

Drawing Title  
**TPP**

Drawn: MF    Check: LC    Appr: AP    Date: 05/12/2019    Scale at A3: 1:200

Status: **PLANNING**

Drawing No: **CA030\_P\_01AHM\_012**    Revision: -

NOTE: All work in the Root Protection Area of the existing retained trees to be conducted in accordance with BS 5837:2012 "Trees in relation to design, demolition and construction. Recommendations". RPAs are to be measured and marked on site as a circle with a diameter 12 times the girth, as per BS 5837: 2012. Markers to be retained at all times, and not to be entered at any time except when necessary for construction.

- No materials to be stored in RPA;
- All work within RPAs to be completed by hand, or by machines positioned outside RPA;
- No chemicals, fuel, contaminated water or other toxic substance is to enter or be allowed to seep into any RPA;
- No damage to be caused to bark or visible parts of trees;
- No roots over 25mm diameter to be cut. Any cuts to be clean, saw cuts to minimize exposed area. No damage to be caused to root bark, including any roots outside RPA.

In the event of any unforeseen difficulty associated with tree roots the Contract Administrator (CA) must be contacted immediately. The CA will contact an arboriculturalist for advice as required. Trees to be monitored by London Borough of Camden for any future work.

