

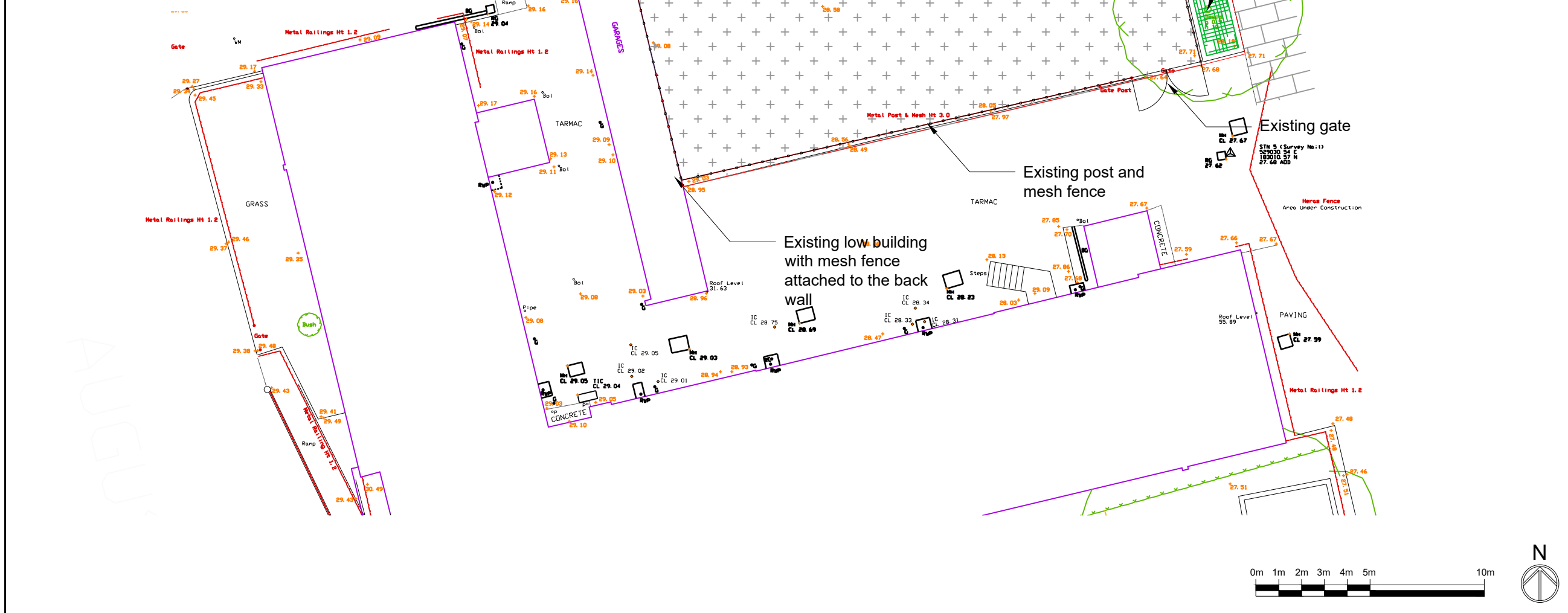







Location Plan



KEY

-  Site boundary
-  Building
-  Asphalt surfacing
-  Concrete paving slabs
-  Planting
-  Level 4.27
-  Fence

Rev	Description	Drawn	Check	Appr	Date

Groundwork London
 12 Baron Street
 London N1 9LL
 Tel: 020 7239 1280
 Fax: 020 7278 1515
 www.groundwork.org.uk/London



Project: HS2 Improvements

Client: LB Camden

Drawing Title
EXISTING SITE

Drawn: MF Check: LC Appr: AP Date: 05/12/2019 Scale at A3: 1:200
 Status: **PLANNING**

Drawing No: CA030_P_01AHM_002 Revision: -