

Design and Access Statement
Augustus House Ball Court
Regents Park Estate NW1 3TB

November 2019



1. Introduction

Augustus House Ball Court site is located between Augustus Street and Stanhope Street, North of Augustus House at the Regents Park Estate in London.

Groundwork London has been contracted to design and upgrade the quality of the existing MUGA court, on behalf of the LB Camden, as part of the HS2 improvements.

This Design and Access Statement is in support of the planning application to carry out the proposed changes.

2. Layout

The site is currently occupied by a MUGA. There is a significant level difference (over 1m) across the site, which means that the existing ball court is sloping and as a result is under used.

It is proposed to address the level difference by dividing the site into two level areas - a smaller kickabout area on the lower level and an outdoor gym on a higher level. New brick walls will be introduced to retain level terraces.

3. Boundary treatment

Currently the entire ball court is fenced off with an overall boundary height of 3m: a metal post and mesh fence along the Southern and Eastern boundary, a brick wall with a fence panel mounted on top along the Northern boundary and a rear brick wall of a shed building with a fence panel along the Western boundary.

The Northern boundary wall and fence panel will be retained and the remaining fence will be replaced as follows: a 3m high Zaun Duo fence matching existing for the ball court (powder coated dark blue) and a 1.2 m high flat bar railing for the outdoor gym (powder coated black).

4. Access

The existing ball court is fenced off with a single access gate in the South-Eastern corner.

The proposal includes a PartM compliant ramped access to the ballcourt and the outdoor gym, as well as separate access points via stairs - one set of stairs from the Stanhope Street into the ball court and one between the ball court and the outdoor gym.

5. Appearance

The hard landscaping will use a palette of buff coloured asphalt for the ramp, the outdoor gym and the path along the top side of the ball court. The surface of the MUGA ball court will be new macadam surfacing with non-slip heavy duty acrylic coating and acrylic line markings.

Stairs will be built with natural coloured concrete slabs with inserted contrasting visibility strips.

New brick retaining walls are proposed to retain level surface for the ball court and the outdoor gym; brick colour to match existing walls. Timber planters are proposed around the perimeter of the outdoor gym.

Outdoor gym equipment, including pull up bars, cross trainer and a recumbent bike is proposed on the upper level.

5. Planting

The planting will be low maintenance naturalistic mix, designed for a year-round performance, with shrubs, grasses, herbaceous perennials and bulbs. Species attractive to pollinators are included in the planting mix. New tree (*Sorbus huphensis*) is proposed to replace the existing one in the planter along the Stanhope Street.

Design and access statement: Concept plan and visualisations

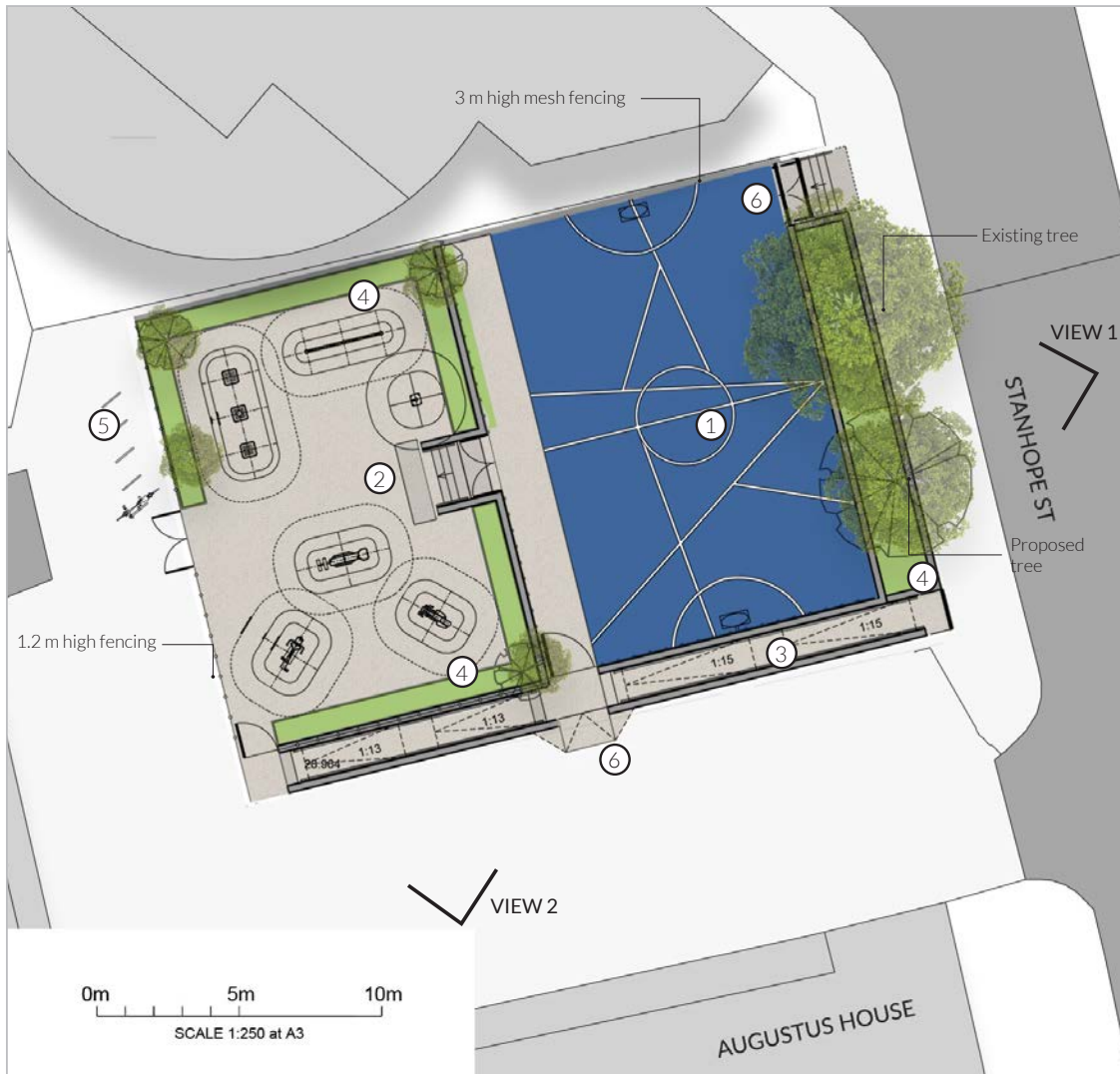

It is proposed to divide existing sloping ball court into two level areas with a lower and upper level. The lower level along Stanhope Street will be retained as a ball court and the upper area as an outdoor gym.

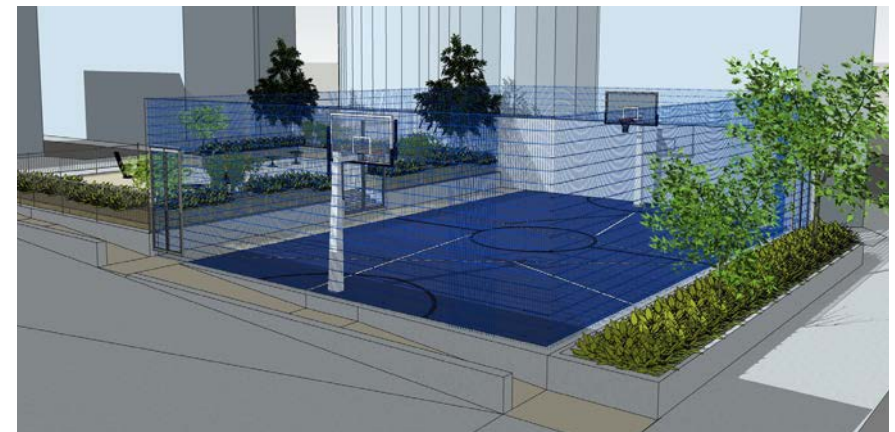

- ① New kick-about/Ball court area
- ② Outdoor Calisthenics gym
- ③ Proposed ramped access
- ④ Soft landscaping
- ⑤ Proposed cycle parking
- ⑥ Ball court access gates

Design and access statement: Materials



Blue sports macadam



Flat top metal railing to the outdoor gym



Buff colour macadam to the ramp and the outdoor gym



Zaun Duo8 ball court fence



Example of the outdoor gym equipment



Concrete slab stairs

Design and access statement: planting palette

Planting to include low maintenance, drought tolerant species chosen to provide year-round interest and attract pollinators. A rich selection of bulbs will be added for a colourful spring display.

A new tree (*Sorbus huphensis*) is proposed in the re-built raised planter on Stanhope Street, to replace the existing.



Narcissus 'Actaea'



Allium sphaerocephalon



Galanthus nivalis



Anemanthele lessoniana



Anemone x hybrida 'Whirlwind'



Helleborus orientalis



Symphotrichum 'Little Carlow'



Polystichum setiferum



Gaura lindheimerii



Liriope muscari



Dryopteris erythrosora



Salvia 'Caradonna'



Molinia caerulea ssp. arundinacea