

NOTES
 1 The Contractor must check and confirm dimensions.
 2 All discrepancies are to be reported to and resolved by the Architects before works are commenced.
 3 This drawing is not to be scaled.
 4 All work and materials to be in accordance with the London Building Acts and the London Constructional Bylaws or the Building Regulations and to comply with all relevant codes of practice and British Standards.

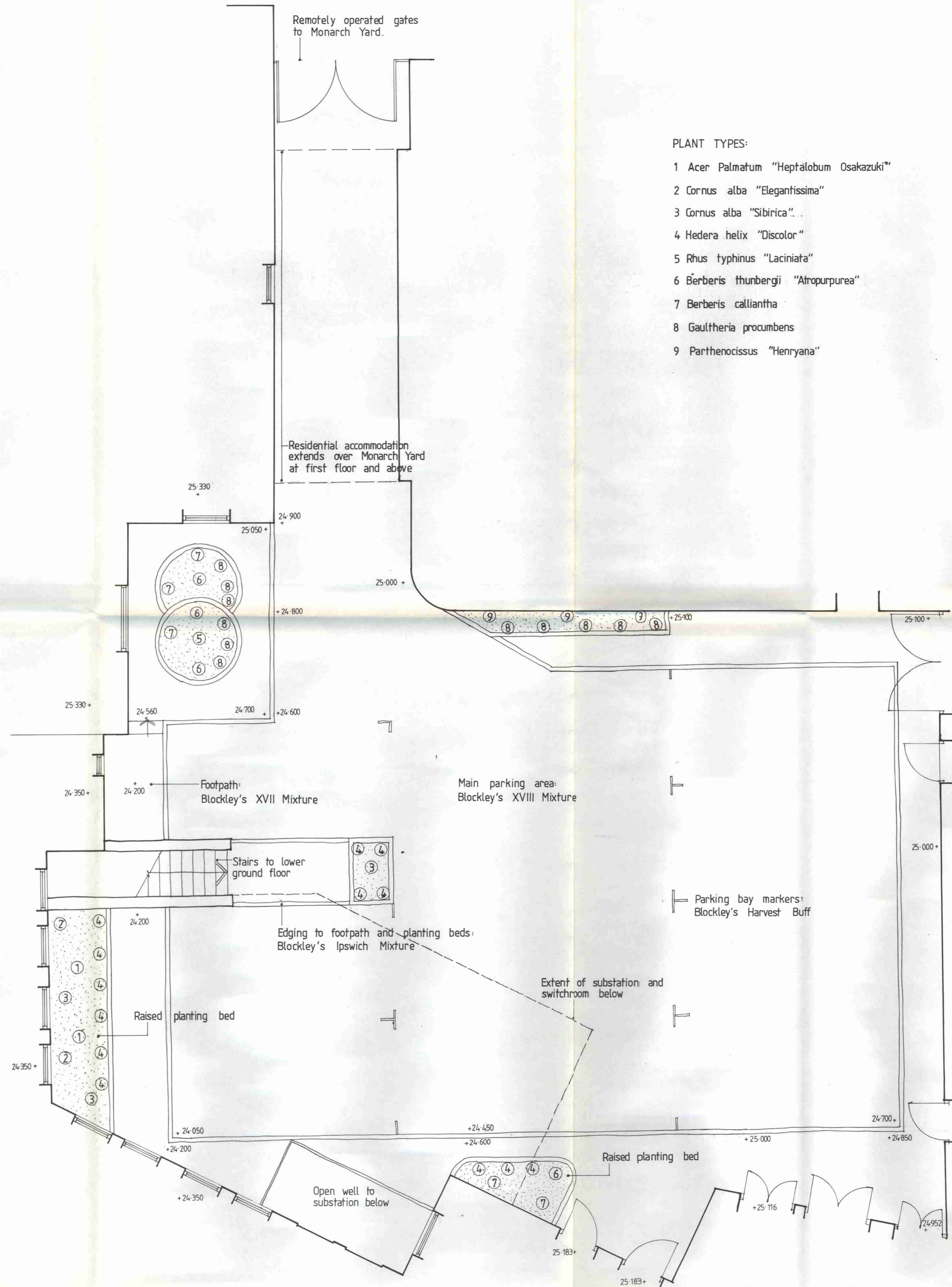

- PLANT TYPES:
- 1 Acer Palmatum "Heptalobum Osakazuki"
 - 2 Cornus alba "Elegantissima"
 - 3 Cornus alba "Sibirica"
 - 4 Hedera helix "Discolor"
 - 5 Rhus typhinus "Laciniata"
 - 6 Berberis thunbergii "Atropurpurea"
 - 7 Berberis calliantha
 - 8 Gaultheria procumbens
 - 9 Parthenocissus "Henryana"

RECEIVED
 11 JAN 1989
 PLANNING AND TRANSPORT DEPARTMENT

LONDON BOROUGH OF CROMWELL
 PLANNING AND TRANSPORT DEPARTMENT
 11 JAN 1989
 RECEIVED

PL 8900102
 HB 8970006

Revision _____ Date _____



ROLFE JUDD
 planning architecture interiors

Old Church Court, Claylands Road, London SW8 1NZ Telephone 01-582 7070

Client _____

THE HAMMERSON GROUP

Project _____

133-136 HIGH HOLBORN / BARTER ST.

Drawing _____

MONARCH YARD
 LANDSCAPING AND EXTERNAL WORKS

Scale	Date	Drawn	Checked
1:50	JAN 89	SCB	SCB

Drawing No. _____ Revision _____

A1 / 1484 / W002