

NOTES  
 Fletcher Priest Architects is a Limited Liability Partnership registered in England and Wales (OC336568) at the below address. = this drawing is to be read in conjunction with the design risk assessment prepared by fpa. = this drawing is to be read in conjunction with other drawings and specification produced by fpa and other members of the design team. = all dimensions are in millimeters unless otherwise stated. = do not scale this drawing. = any discrepancies in dimensions are to be reported to the architect. = all information subject to detail site survey.

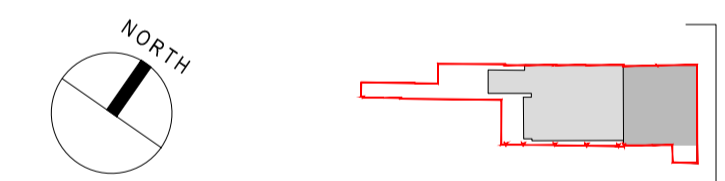

REV	DESCRIPTION	TH	NW	161219
-	Issued for planning	TH	NW	161219

**FOR PLANNING**



Aviva Investors Pensions Ltd  
 31-37 Whitfield Street

11 Existing GA Elevations  
 Existing Whitfield Street  
 Elevation (Illustrative)

DRAWING NUMBER / REVISION  
**A 1496 GA 1150 -**

SCALE  
 1:50 @A1 1:100 @A3

DATE / DRAWN BY / CHECKED BY  
 26.11.2019 TH / NW

**fletcher priest architects**  
 london + köln + riga

middlesex house  
 34/42 cleveland st  
 london W1T 4JE  
 t +44 [0]20 7034 2200  
 f +44 [0]20 7637 5347  
 www.fletcherpriest.com

