

Scala Street

NOTES
Fletcher Priest Architects is a Limited Liability Partnership registered in England and Wales (OC336568) at the below address. = this drawing is to be read in conjunction with the design risk assessment prepared by fpa. = this drawing is to be read in conjunction with other drawings and specification produced by fpa and other members of the design team. = all dimensions are in millimeters unless otherwise stated. = do not scale this drawing. = any discrepancies in dimensions are to be reported to the architect. = all information subject to detail site survey.



Whitfield Street

Goodge Street

REV	DESCRIPTION	TH	NW	161219
-	Issued for planning	TH	NW	161219

FOR PLANNING

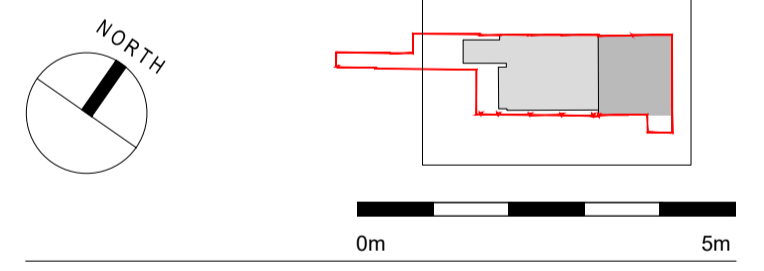

Aviva Investors Pensions Ltd
31-37 Whitfield Street

10 GA Existing Plans
Existing Third Floor Plan

DRAWING NUMBER / REVISION
A 1496 GA 1003 -

SCALE
1:100 @A1 1:200 @A3

DATE / DRAWN BY / CHECKED BY
22.05.2019 TH / RN

fletcher priest architects
london + köln + riga
middlesex house
34/42 cleveland st
london W1T 4JE
t +44 [0]20 7034 2200
f +44 [0]20 7637 5347
www.fletcherpriest.com