

Existing temporary extension to Council Chamber benches to be removed

Alterations proposed to Dais in order to provide full accessibility. For details of alterations refer to drawing CTH-PUR-MB-01-DR-A-98020

Existing temporary extension to Council Chamber benches to be removed

Local alterations made to existing benches for integration of new microphone / voting system. For details of alterations refer to detail drawing CTH-PUR-MB-01-DR-A-98021

Notes:
 Drawings are based on survey data and may not accurately represent what is physically present.
 Do not scale from this drawing. All dimensions are to be verified on site before proceeding with the work.
 All dimensions are in millimeters unless noted otherwise.
 Purcell shall be notified in writing of any discrepancies.

Key Plan
 not to scale

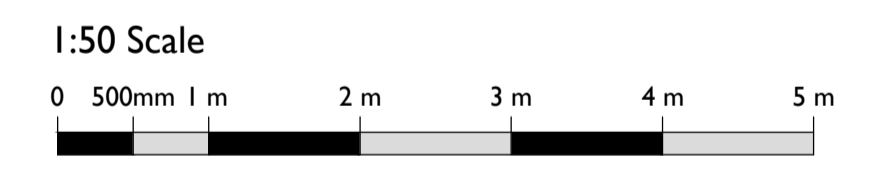
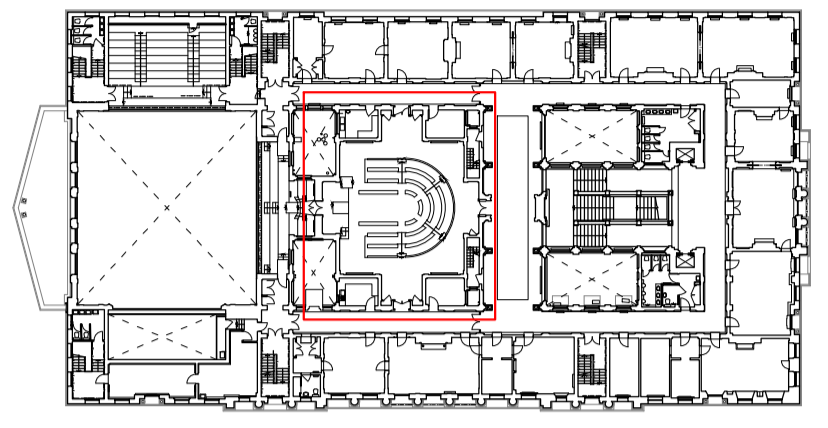

P01	10 Dec 2019	EH	NS
P00	05 Dec 2019	oliverbeddard	

First Issue 05 Dec 2019 oliverbeddard NS

ISSUE	DATE	DRAWN	CHECKED	DESCRIPTION
DRAWING TITLE	COUNCIL CHAMBER EXISTING PLAN SHOWING ALTERATIONS - FIRST FLOOR			
DRAWING NO.	CTH-PUR-MB-01-DR-A-98000			
REVISION	P01			
SIZE & SCALE	A1L 1:50			
DRAWING STATUS	ISSUED FOR LBC			

CLIENT	Lendlease	
PROJECT	Camden Town Hall	
JOB NUMBER	238664	

I 98000 **E1.34 Existing Council Chamber Room Plan - First Floor**
 1:50 @ A1