

Notes: Do not scale from this drawing. Contractor to take and check all dimensions on site before work commences. Discrepancies to be reported to architect. Subcontractors to verify all dimensions on site before making shop drawings or commencing manufacture. This drawing is copyright.

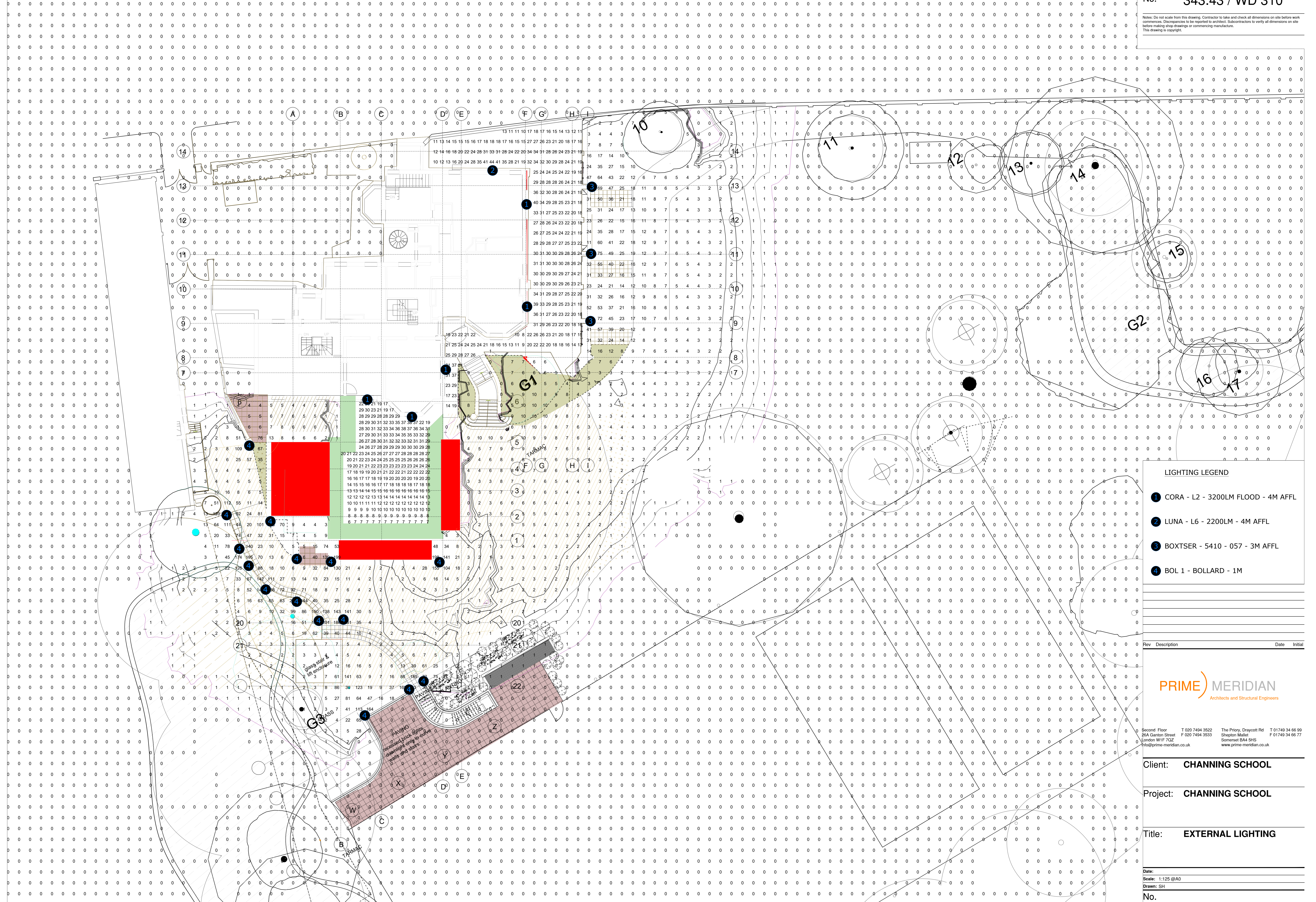

LIGHTING LEGEND

- 1 CORA - L2 - 3200LM FLOOD - 4M AFFL
- 2 LUNA - L6 - 2200LM - 4M AFFL
- 3 BOXTSER - 5410 - 057 - 3M AFFL
- 4 BOL 1 - BOLLARD - 1M

Rev	Description	Date	Initial



Second Floor T 020 7494 3522 The Priory, Draycott Rd T 01749 34 66 99
 264 Canton Street F 020 7494 3533 Shapton Mallet F 01749 34 66 77
 London W1F 7DZ info@prime-meridian.co.uk Somerset BA4 5HS www.prime-meridian.co.uk

Client: CHANNING SCHOOL

Project: CHANNING SCHOOL

Title: EXTERNAL LIGHTING

Date: _____
 Scale: 1:125 @A0
 Drawn: SH
 No. _____

