

KEY :

- Existing Walls
- Existing modern suspended ceiling system
- Extent of existing historic coffered ceiling with asbestos material identified.
- Extent of existing historic coffered ceiling
- Not in scope

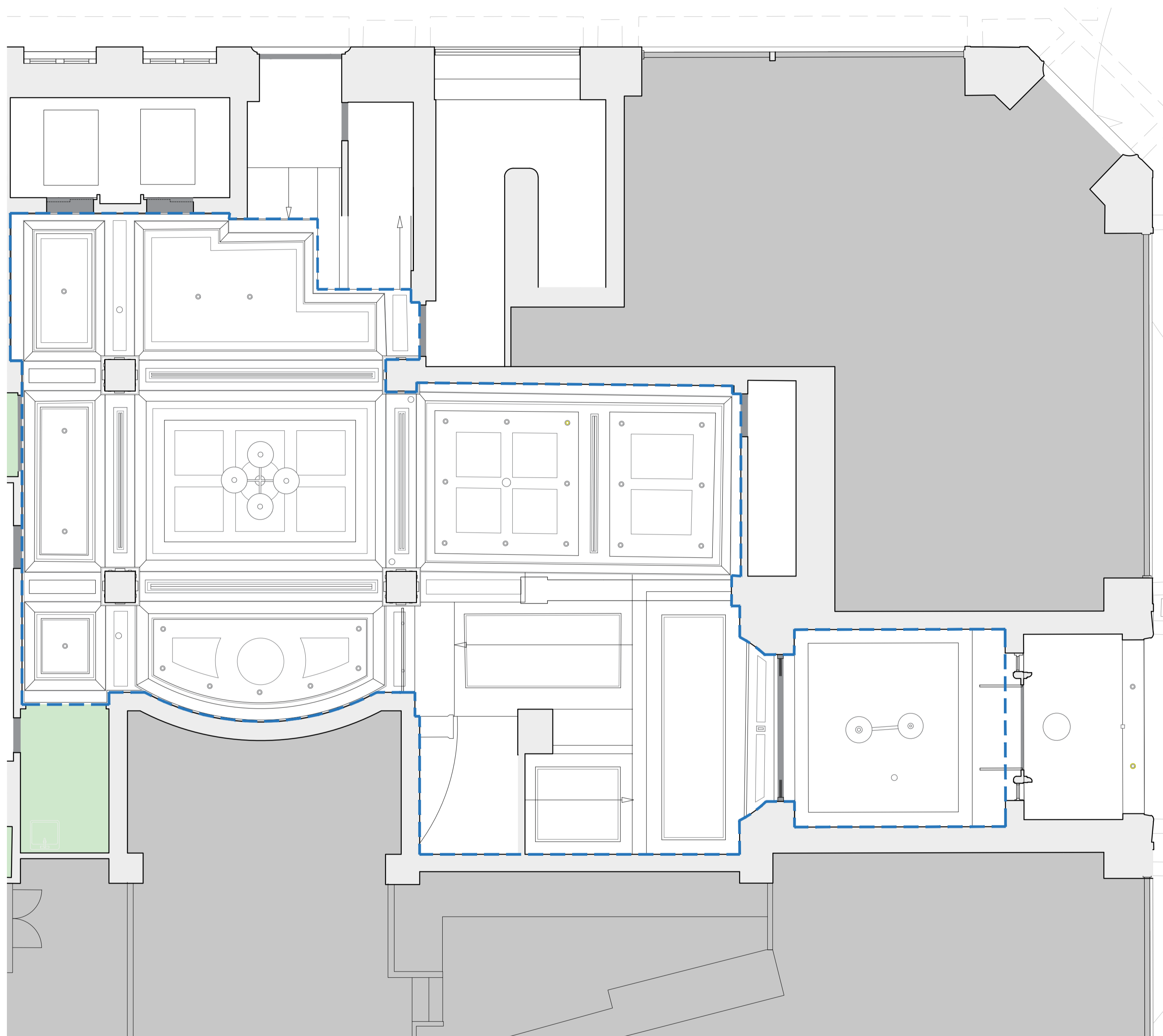

01 Existing Ground Floor Ceiling Plan Detail  
10.252 1:50@A1, 1:100@A3

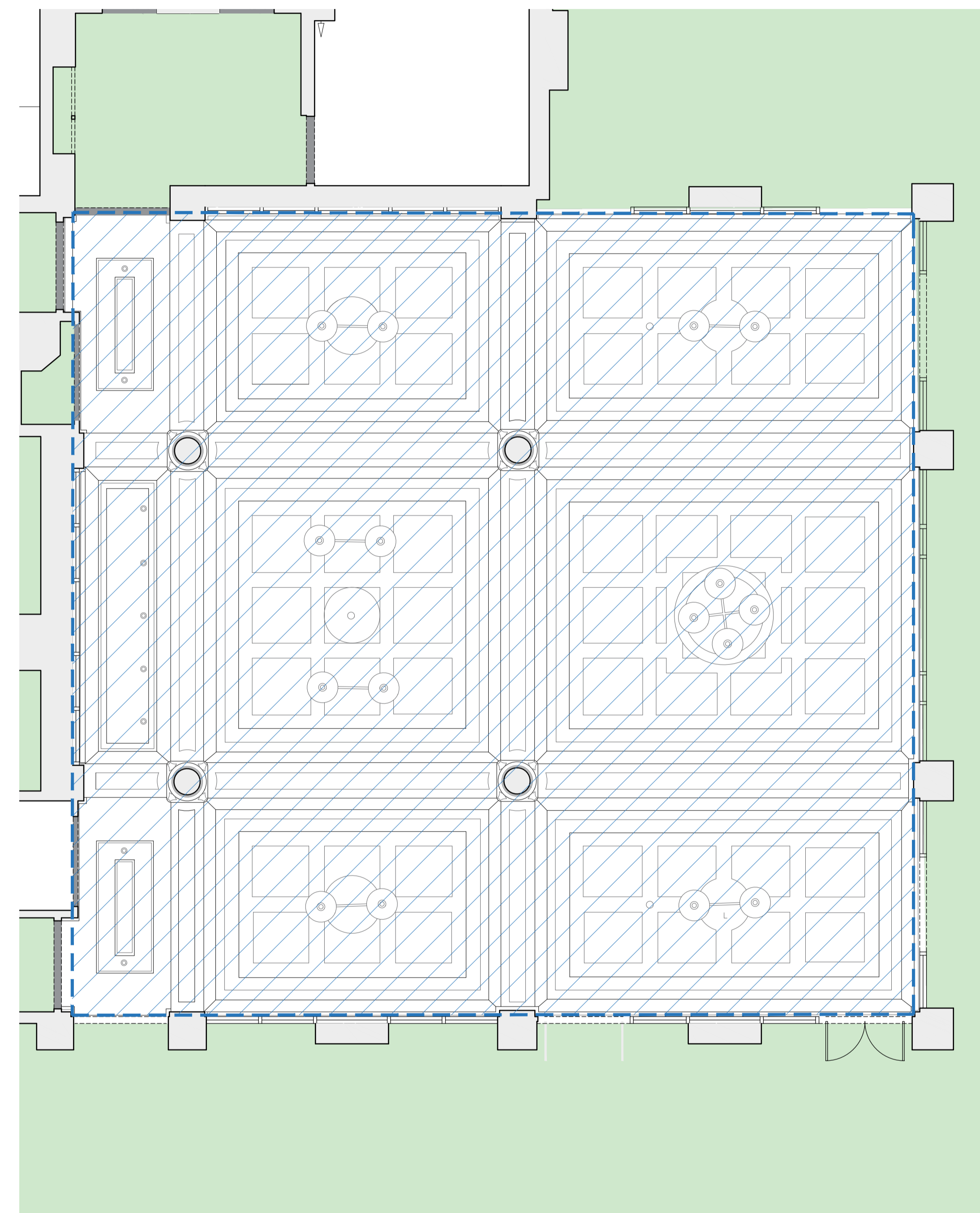

02 Existing First Floor Ceiling Plan Detail  
10.252 1:50@A1, 1:100@A3

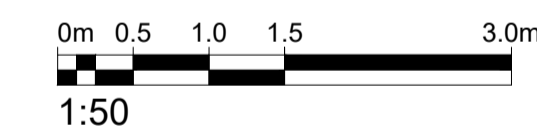

Rev.	Description.	By	Date
P4	Issued for Planning	AC	28.11.19

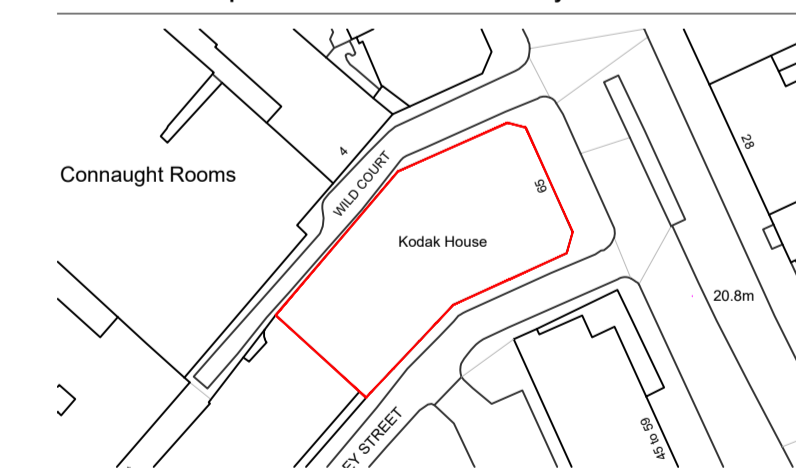

Client  
Kings Keeley Limited C/o Clearbell Capital LLP

Project  
65 Kingsway - Base Scheme

Title  
Existing Historic Ceiling Detail

Status	Purpose of issue	RIBA stage
S2	For Planning	2

Project No.	Drawn	Checked	Scale	Rev.
1914	FB	TJ	1:50 @ A1 1:100 @ A3	P4

Drawing No.  
**1914-BG-01-ZZ-DR-A-10.370**

Do not scale from this drawing. The Contractor is to take and check all dimensions on site before work commences. Discrepancies must be reported to the Architect. Subcontractors must verify all dimensions on site before making a shop drawing or commencing manufacturing. This drawing is copyright. ©

© Copyright Barr Gazetas Ltd.  
A 10 Heddon Street, London, W1B 4BG  
T 0207 638 5081  
W www.barrgazetas.com